

SUNHILL MARKETPLACE

Anchor Pad and Shop Space Available

10401-10521 Sunland Blvd., Sunland, CA 91040 & 8756-8846 Foothill Blvd., Sunland, CA 91040



NEWMARK | PACIFIC

Center Recently
Remodeled

SUNHILL MARKETPLACE

10001 S. Sunland Blvd., Sunland, CA 91040
8756 S. Sunhill Blvd., Sunland, CA 91040

New To Be Built Pads
and Junior Anchor
Space Available
1,500 - 24,000 SF

FOR MORE INFORMATION,
PLEASE CONTACT:

BRYAN NORCOTT

Executive Managing Director
bryan.norcott@nmrk.com
t 213-298-3595
CA RE Lic. #01200077

BILL BAUMAN

Vice Chairman
bill.bauman@nmrk.com
t 213-298-3593
CA RE Lic.#00969493

NEWMARK | PACIFIC

555 S. Flower St. • Suite 3500
Los Angeles, CA 90071
Corporate License #01796698



PROPERTY FEATURES

- Anchored by Ralphs for over 50 years
- 2024 Openings: Ross and Jump Club Arena
- 2025 Openings: AltaMed, Denny's, and Fight Club Martial Arts.
- Outstanding and irreplaceable freeway access with on/off ramps to/from Sunland Blvd.
- Center recently fully remodeled
- Prime freeway visibility with a new pylon sign

2024 DEMOGRAPHICS



Population

11,882

1 Mile

52,467

3 Miles

185,703

5 Miles



Household Income

\$112,843

1 Mile

\$113,126

3 Miles

\$115,706

5 Miles





FOOTHILL BLVD.

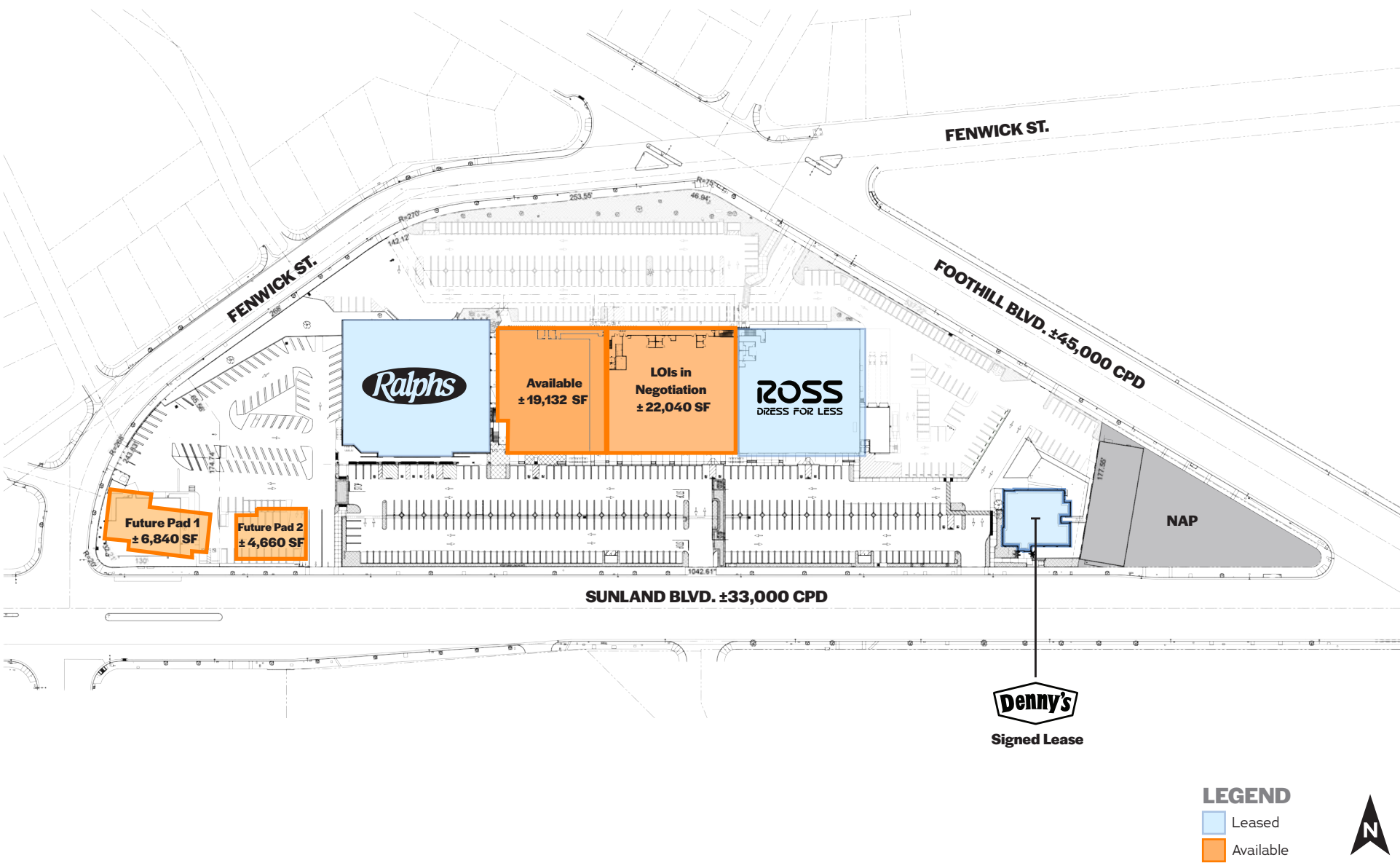

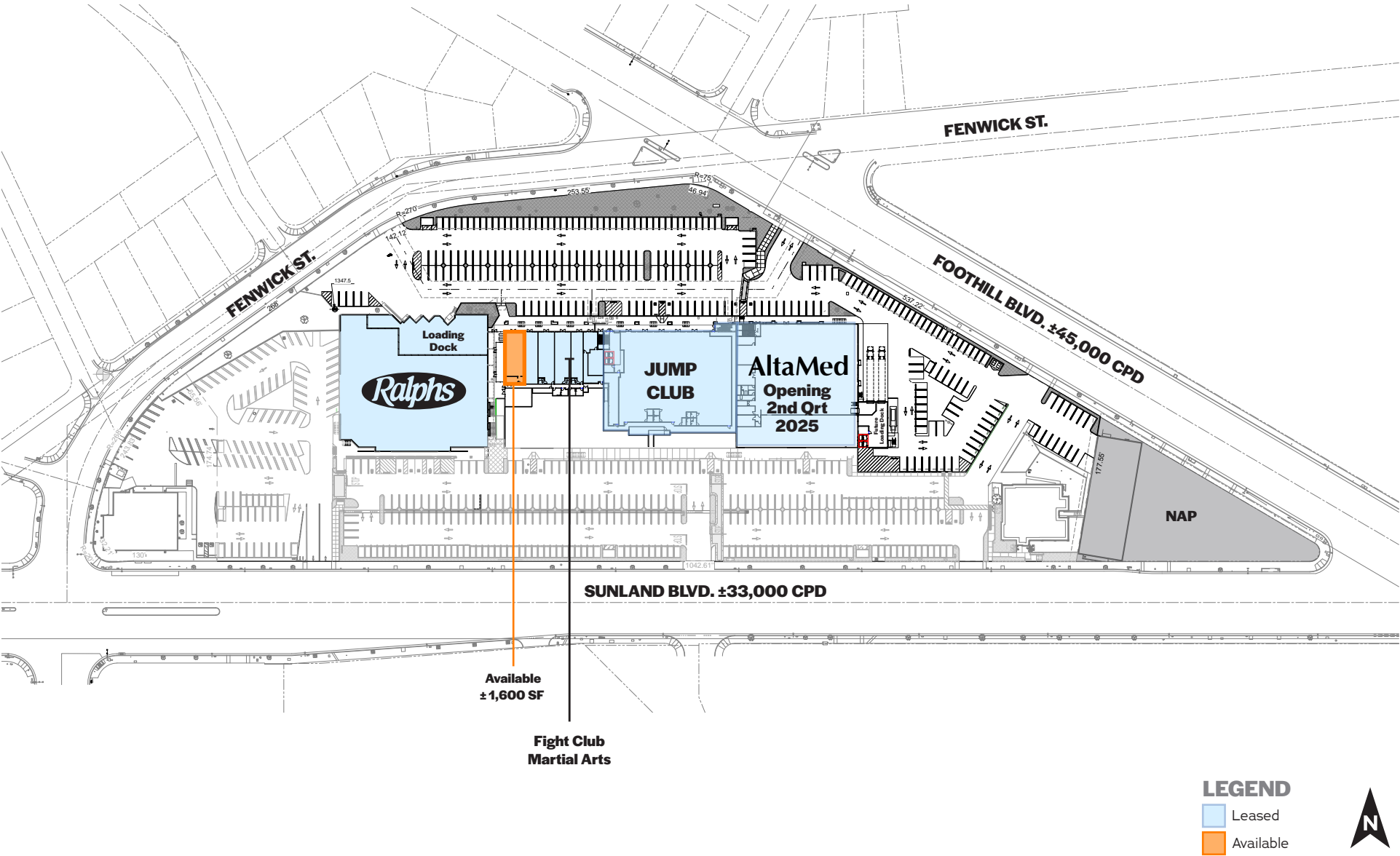

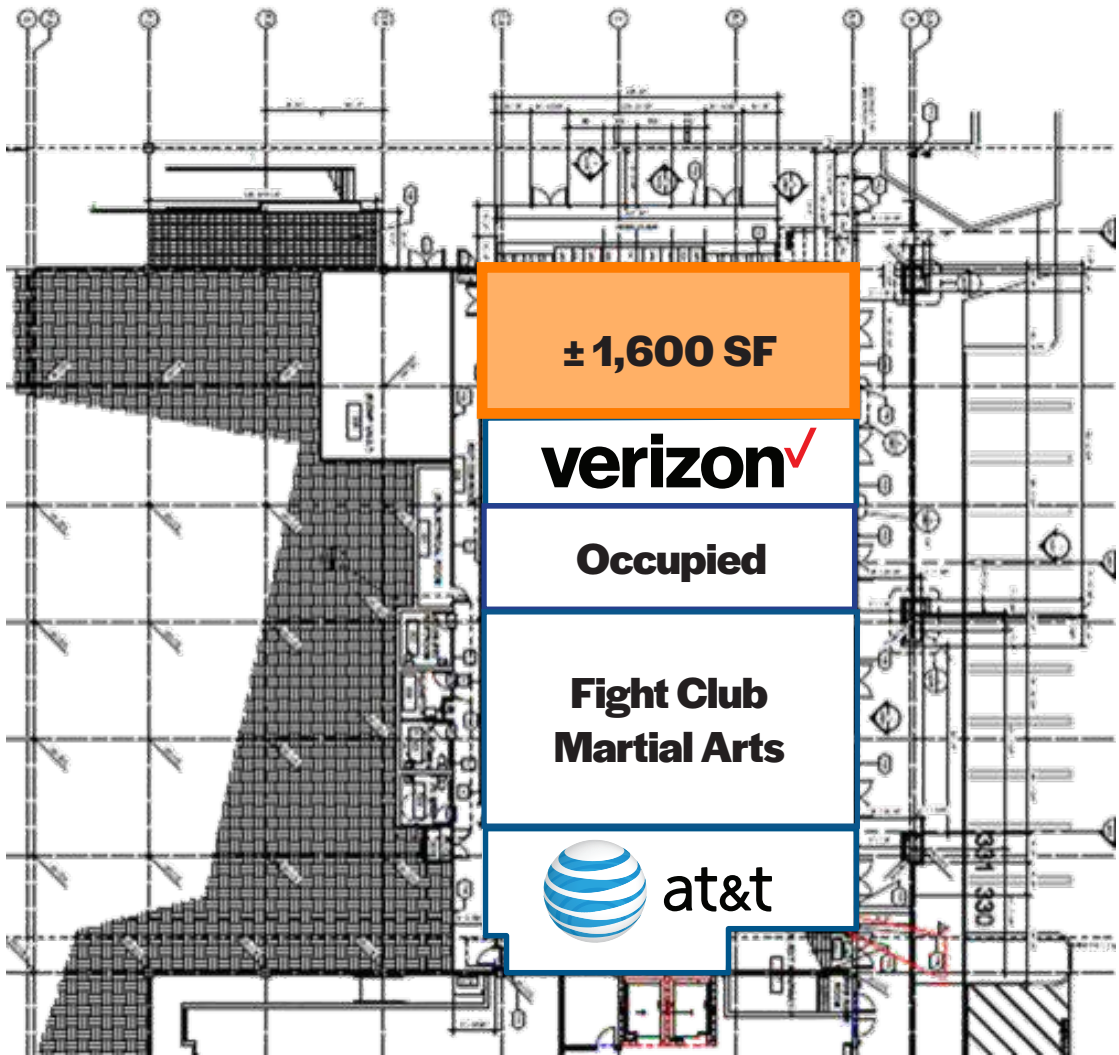

LEGEND

- Leased
- Available





- The only Nicklaus Design golf course in Los Angeles County
- Features an 18-hole, par 72 championship golf course

“Ranked as One of the Top 30 Best New Courses Worldwide and One of the Top Ten Best New Public/Resort courses in the U.S.”

-Travel + Leisure Golf magazine

VERDUGO HILLS
HIGH SCHOOL
(1,650+ Enrolled Students)

Site



SHERMAN OAKS

VILLAGE CHRISTIAN SCHOOL
(1,100 Enrolled Students)
One of the Largest K-12 Private Schools in the U.S.

SUN VALLEY

ARLETA

SHADOW HILLS

LAKEVIEW TERRACE

Angeles National
GOLF CLUB

Site

