

MEDICAL OFFICE SPACE FOR LEASE

Printers Park Medical Plaza

175 S UNION BLVD., COLORADO SPRINGS, CO 80910

EXISTING SURGERY CENTER AVAILABLE!



PRINTERS PARK MEDICAL PLAZA is a three-story, Class A medical office building located just a few minutes away from Memorial Hospital's main campus. Memorial Hospital services currently occupy approximately 45% of the building.

Services provided at Printers Park Medical Plaza include audiology, breast care, disease and wellness, pathology lab, radiology, wound care center, orthopedics, obstetrics/gynecology, neurology, vascular surgery, orthotics/prosthetics and internal medicine. In addition, Printers Park Medical Plaza has a surgery center as well as several rehabilitation facilities including therapeutic pools.

- **Existing surgery center available with (6) Operating Rooms, (2) Procedure Rooms, Pre-Op & Post-Op rooms**
- **Landlord will deliver surgery center to 2018 FGI guidelines**
- Competitive lease rates and Generous TI Package
- Exterior building signage available
- Balanced Mix of Healthcare Providers
- 24/7 on-call maintenance available
- Ample Surface Parking
- Convenient Central Location – easy access to I-25
- On-Site Management Staff
- On-Site Security from 5:00am to 7:30pm
- On-Site Storage available for Lease

TOTAL RSF AVAILABLE:	81,374 RSF
SUITE 100:	37,129 SF <i>Existing Surgery Center</i>
SUITE 115:	974 SF
SUITE 200-A:	22,856 SF
SUITE 240:	1,733 SF
SUITE 255-B	3,348 SF
SUITE 345:	2,326 SF
SUITE 370:	3,942 SF
SUITE 025:	7,753 SF
FORMER DELI:	1,313 SF
LEASE RATE:	\$21.00 / SF NNN
NNN EXPENSES (2025 Est.):	\$13.99 / SF
BUILDING SIZE:	226,448 SF
ZONING:	PBC
TOTAL PARKING:	823 Spaces (3.65:1,000 SF)



ALEX DUMAS | Broker
adumas@olivereg.com
C: 719-659-1095

PAUL RUBLEY | Healthcare Advisory
paulrubley@olivereg.com
C: 719-491-5349



FIRST FLOOR | PRINTERS PARK MEDICAL PLAZA

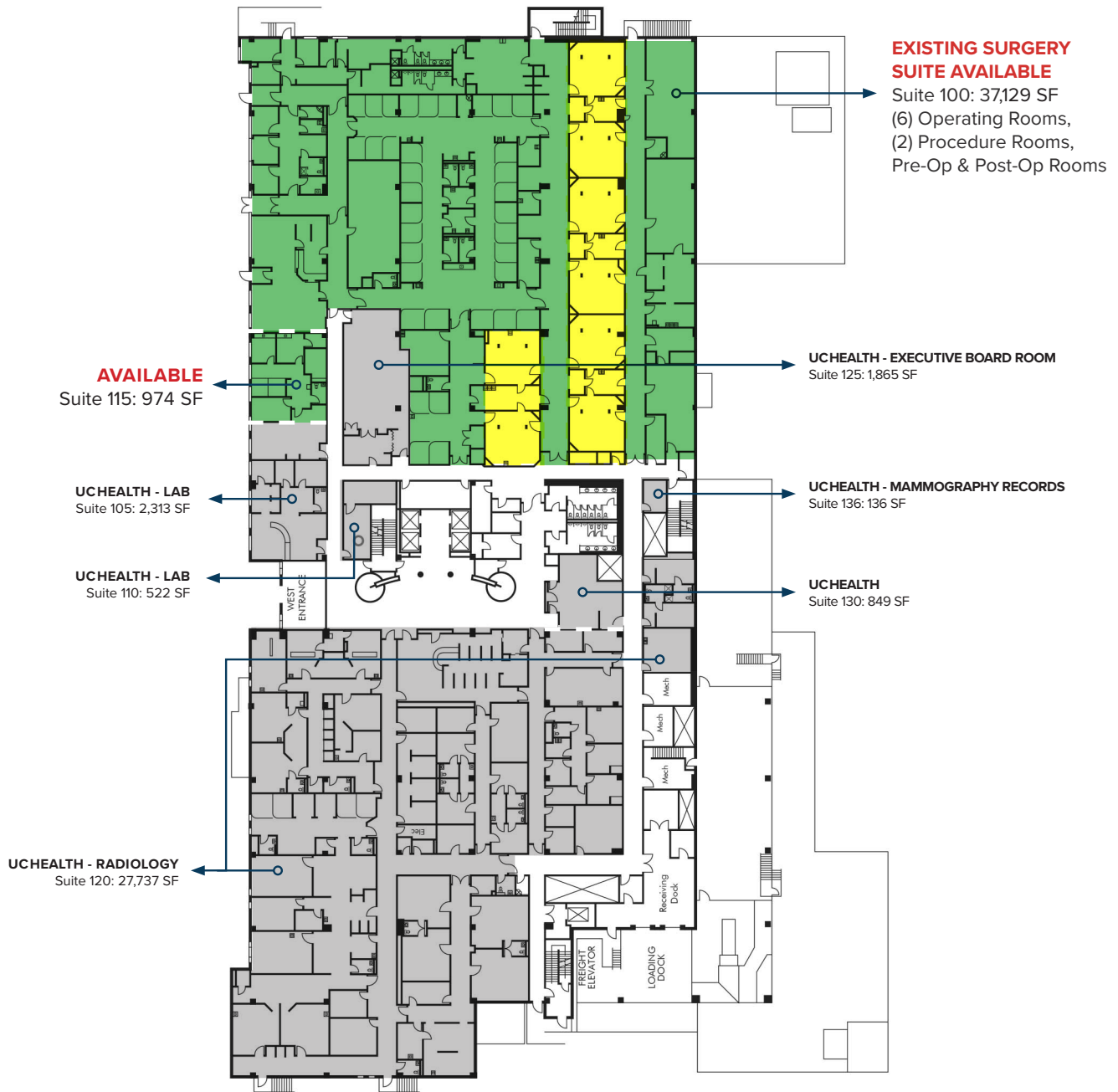

 **AVAILABLE SPACE**  **LEASED SPACE**  **AMBULATORY SURGERY CENTER**

MEDICAL OFFICE SPACE FOR LEASE

Printers Park Medical Plaza

175 S UNION BLVD., COLORADO SPRINGS, CO 80910

SECOND FLOOR | PRINTERS PARK MEDICAL PLAZA



AVAILABLE STORAGE

ALEX DUMAS | Broker
adumas@oliverreg.com
C: 719-659-1095

PAUL RUBLEY | Healthcare Advisory
paulrubley@oliverreg.com
C: 719-491-5349



THIRD FLOOR | PRINTERS PARK MEDICAL PLAZA

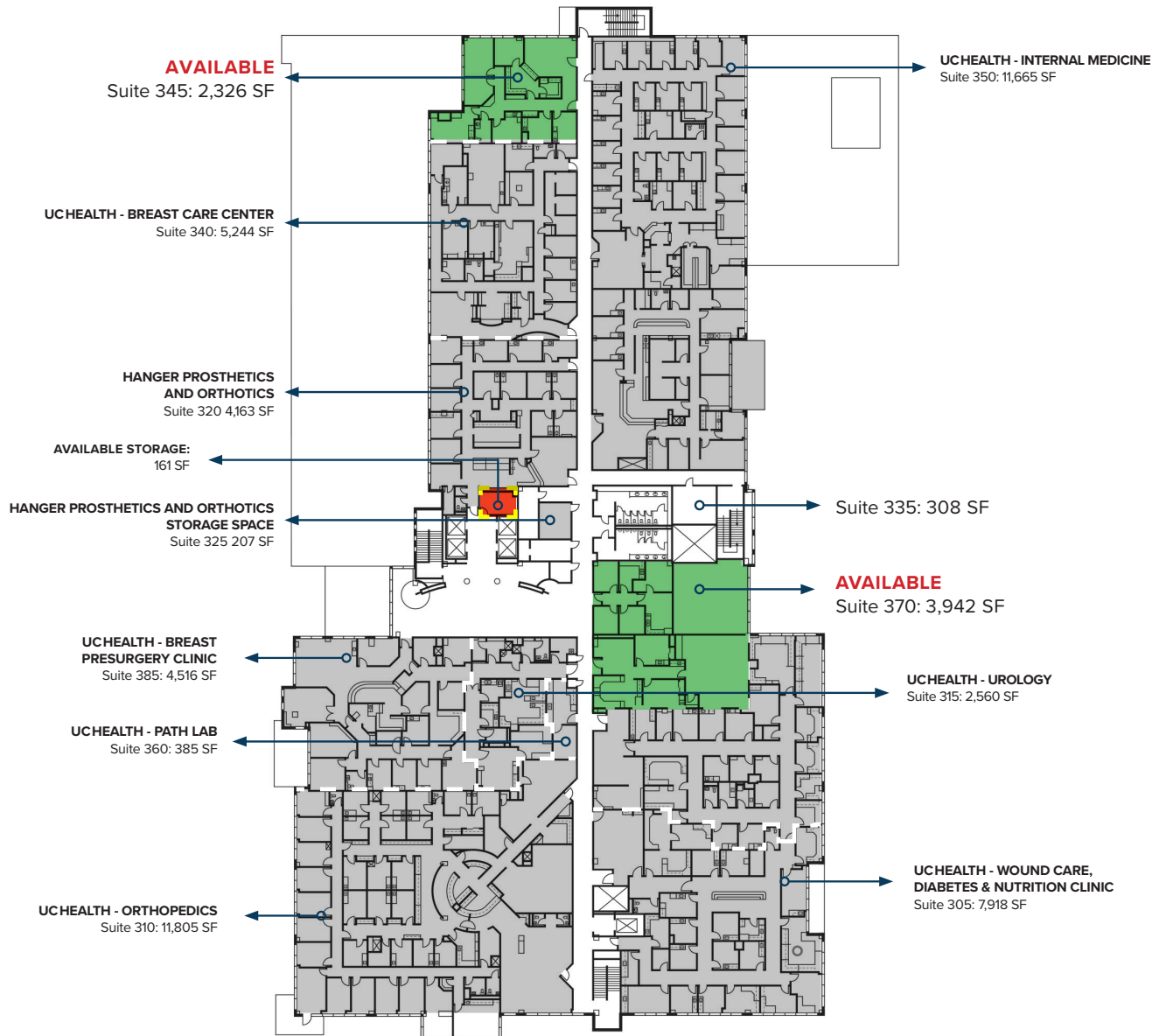

MEDICAL OFFICE SPACE FOR LEASE

Printers Park Medical Plaza

175 S UNION BLVD., COLORADO SPRINGS, CO 80910

BASEMENT FLOOR | PRINTERS PARK MEDICAL PLAZA

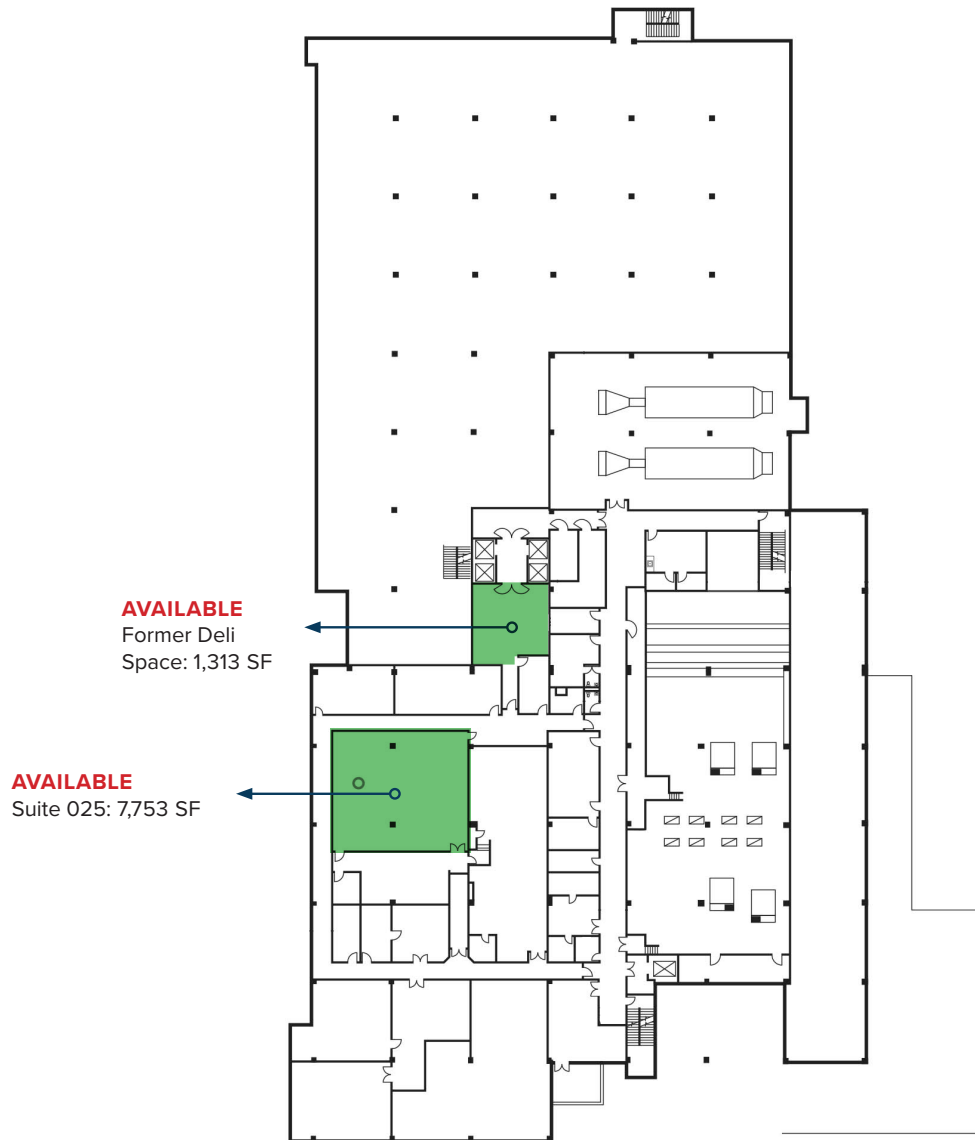

AVAILABLE STORAGE

ALEX DUMAS | Broker
adumas@oliverreg.com
C: 719-659-1095

PAUL RUBLEY | Healthcare Advisory
paulrubley@oliverreg.com
C: 719-491-5349



OLIVE
REAL ESTATE GROUP, INC.

Photos



102 N Cascade Ave, Suite 250, Colorado Springs, CO 80903 | t. 719.598.3000 www.olivereg.com

Olive Real Estate Group, Inc. Copyright 2025. Reproductions are legally prohibited without written consent.
Information contained herein, while not guaranteed, is from sources we believe to be reliable. Prices, terms and information subject to change.

MEDICAL OFFICE SPACE FOR LEASE
Printers Park Medical Plaza
175 S UNION BLVD., COLORADO SPRINGS, CO 80910



ALEX DUMAS | Broker
adumas@oliverreg.com
C: 719-659-1095

PAUL RUBLEY | Healthcare Advisory
paulrubley@oliverreg.com
C: 719-491-5349



OLIVE
REAL ESTATE GROUP, INC.

MEDICAL OFFICE SPACE FOR LEASE

Printers Park Medical Plaza

175 S UNION BLVD., COLORADO SPRINGS, CO 80910



HEALTHCARE DEMOGRAPHICS COLORADO SPRINGS



**ANNUAL
POPULATION
GROWTH RATE**

2010 to 2024
15.02%



**POPULATION,
COLORADO
SPRINGS**

2025 EST.
709,000



**COMMERCIALLY
INSURED**

92%
AGES 0-64



**AVERAGE
HOUSEHOLD
INCOME**

2024 EST.
\$71,957



**2025 ESTIMATED
SPENDING INCREASE**

2025 EST.
23.7%



**ANNUAL MEDICAL
EXPENDITURES**

43%
ABOVE NATL. AVG

SOURCE: eSite Analytics, 2019, 2020 US Census, All Rights Reserved, Alteryx, Inc.

102 N Cascade Ave, Suite 250, Colorado Springs, CO 80903 | t. 719.598.3000 www.olivereg.com

Olive Real Estate Group, Inc. Copyright 2025. Reproductions are legally prohibited without written consent.
Information contained herein, while not guaranteed, is from sources we believe to be reliable. Prices, terms and information subject to change.