



**McNulty Group**  
Incorporated

# FOR LEASE

481 Thorpe Rd  
Orlando, FL 32824



<b>Building Size:</b>	8,064 ± SF
<b>Office:</b>	2,000 ± SF
<b>Warehouse:</b>	6,064 ± SF
<b>Grade Doors:</b>	(3) 10' x 14' (1) 14' x 14'
<b>Ceiling Height:</b>	14'-16'
<b>Power:</b>	3 Phase, 600 Amps
<b>Orange Zoning:</b>	IND-2/IND-3
<b>Year Built:</b>	1983
<b>Lot Size:</b>	2.23 Acres
<b>Additional Features:</b>	• Fenced Lot



McNulty Group, Inc. is the agent of the Landlord or Seller of this property and will be paid by the Landlord or Seller. All information furnished with respect to the subject property has been obtained from sources deemed reliable. No representation as to accuracy thereof is made. This offering is subject to errors, omissions, prior sales or withdrawal without notice.

**Josiah Biddle**

Sales Associate

JosiahBiddle@icloud.com

(407) 625-3670 Direct

**McNulty Group Inc.**

2315 Lynx Lane, Suite 6

Orlando, Florida 32804

407-532-3441



# FOR LEASE

481 Thorpe Rd  
Orlando, FL 32824

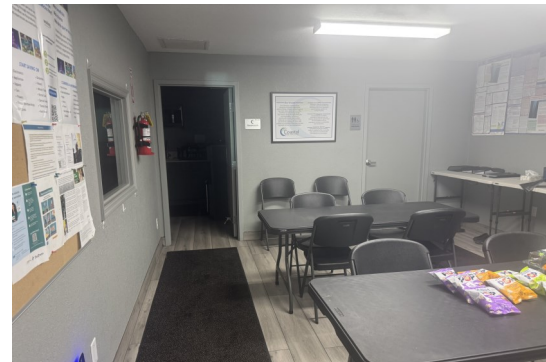
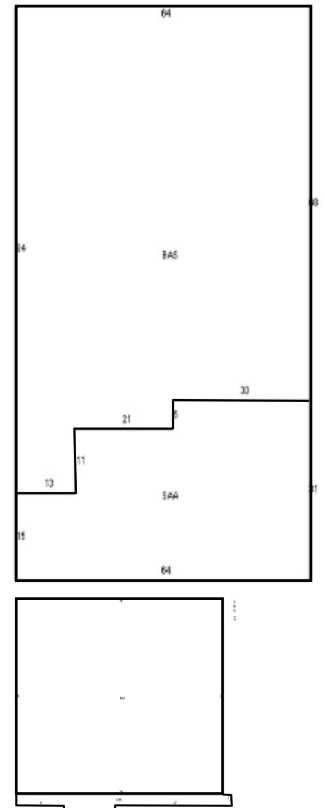

**Josiah Biddle**  
Sales Associate

JosiahBiddle@icloud.com  
(407) 625-3670 Direct

[mcnultygroupinc.com](http://mcnultygroupinc.com)

**McNulty Group Inc.**  
2315 Lynx Lane, Suite 6  
Orlando, Florida 32804  
407-532-3441