

FOR SALE  
**12,665 SF AVAILABLE**



333 EAST MAIN STREET  
**LOUISVILLE, KY 40202**



# PROPERTY HIGHLIGHTS

Class A office space available for purchase on the 1st floor of Preston Pointe, located on the corner of East Main Street and Preston Street. The property includes both surface parking and garage parking on site.

## Highlights:

- Suite features lots of natural light
- Opportunity for building signage
- Walking distance to Slugger Field, NuLu, Whiskey Row, and Yum! Center
- Easy access to I-64 and I-65

Building Size:	76,551 sf
----------------	-----------

Space Available:	12,665 sf
------------------	-----------

Zoning:	C-3
---------	-----

Class:	Class A
--------	---------

Year Built:	2004
-------------	------

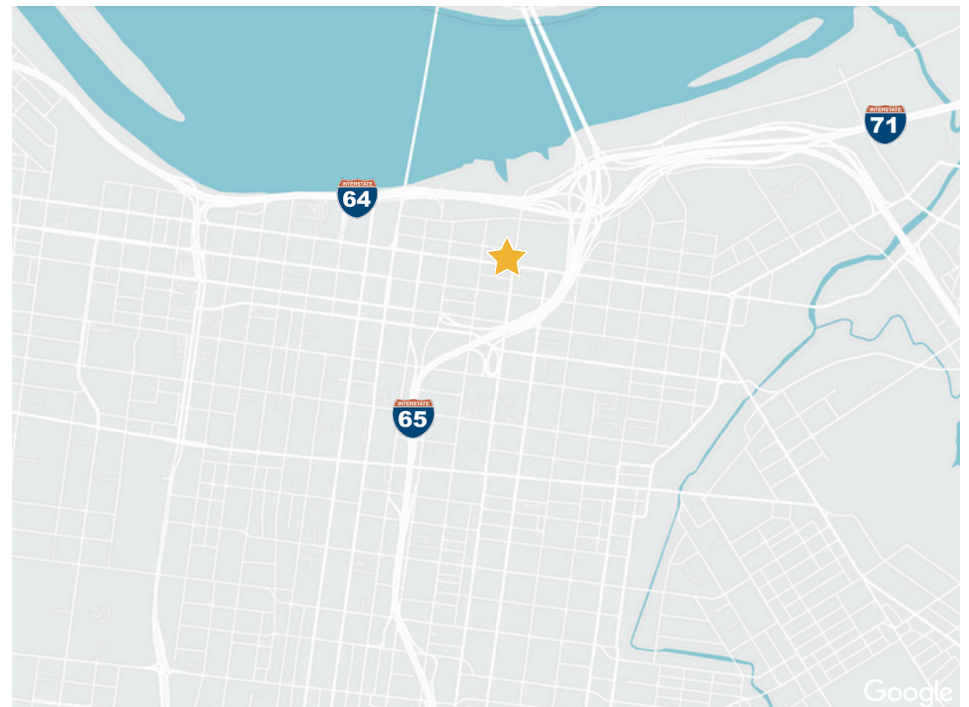

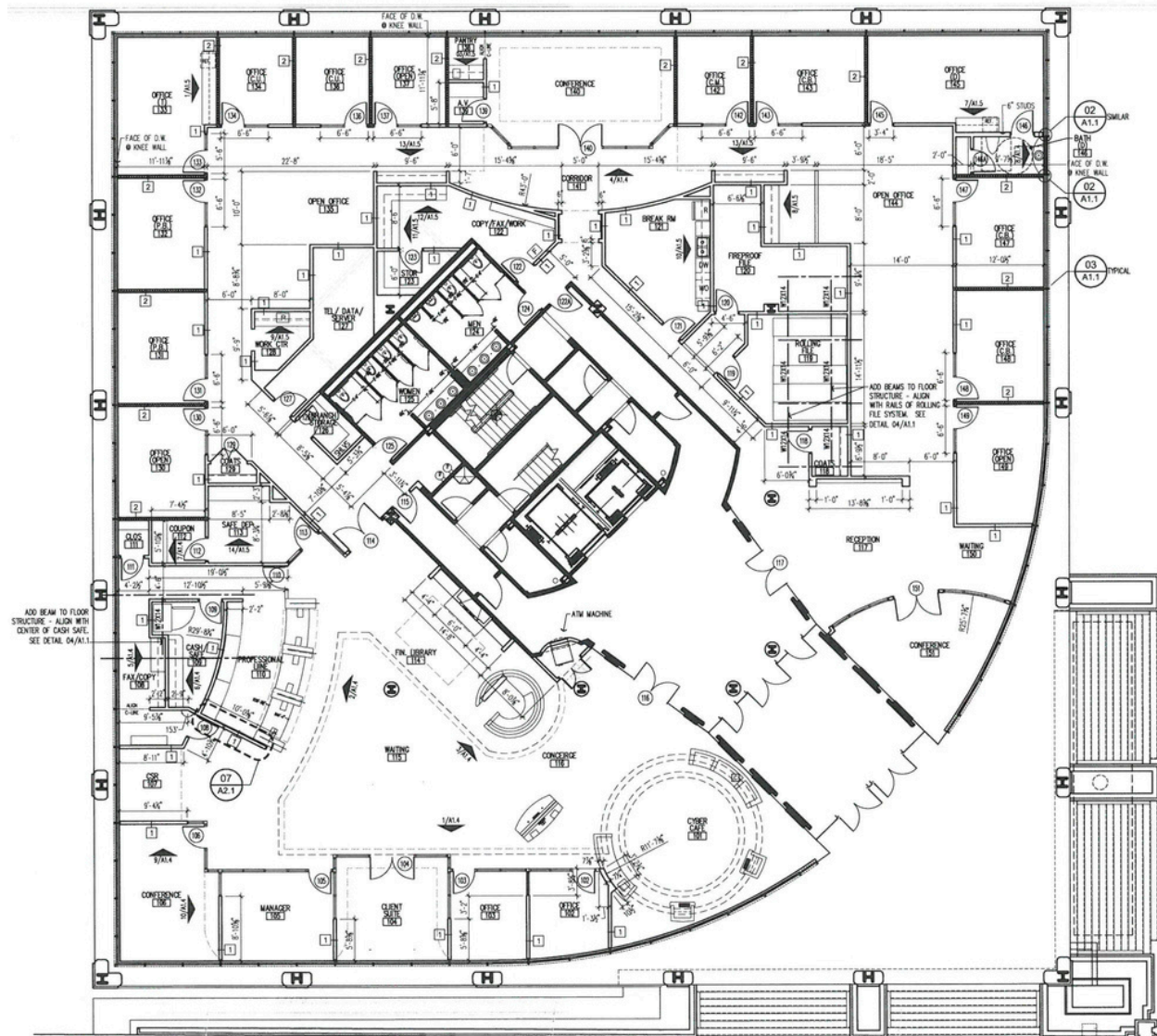

# 1ST FLOOR PLAN



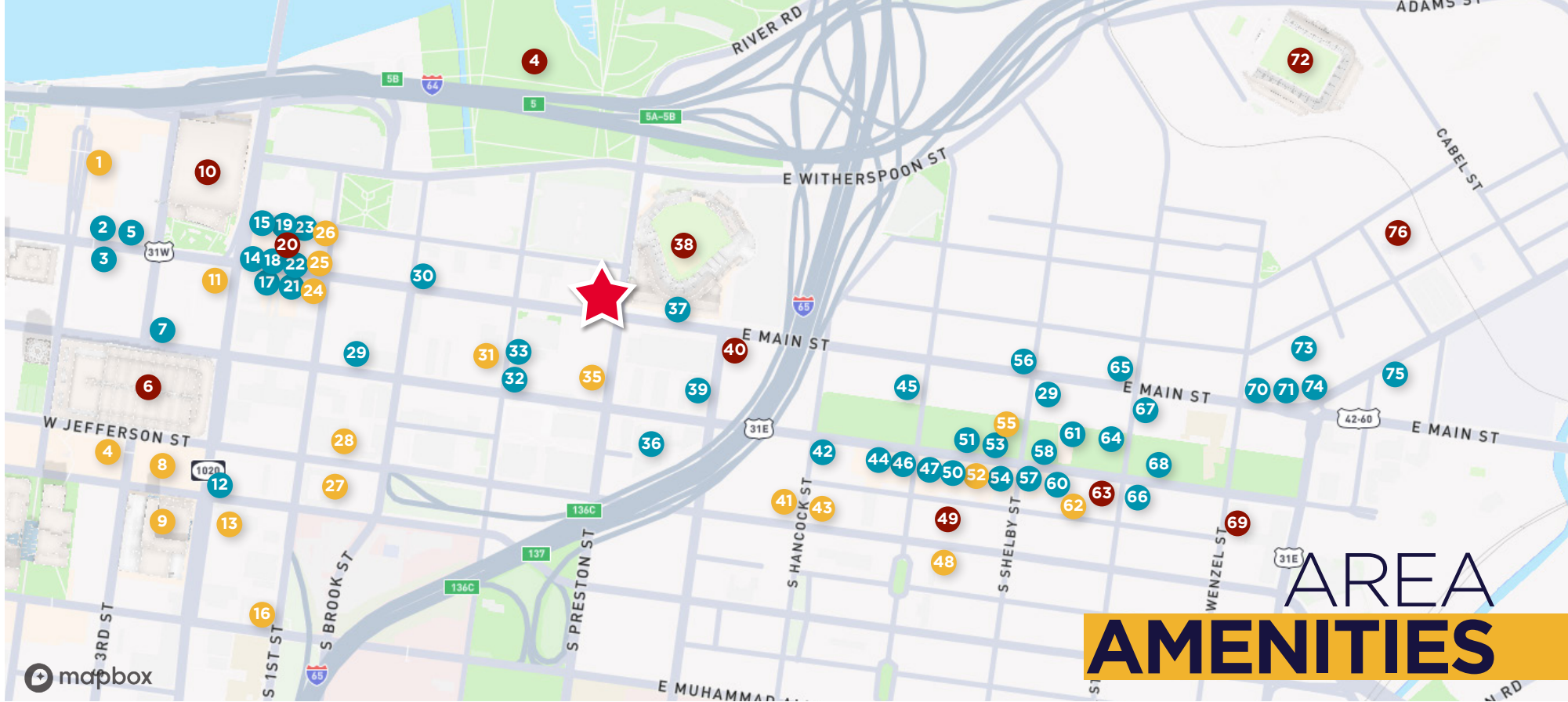

# AREA AMENITIES

## RESTAURANTS/BARS

- |                                |                                  |
|--------------------------------|----------------------------------|
| 2. Jeff Ruby's                 | 37. Against the Grain Brewery    |
| 3. InSeason Harvest Kitchen    | 39. Los Aztecas                  |
| 5. Down One Bourbon Bar        | 42. The Last Refuge              |
| 7. The Old Spaghetti Factory   | 44. Louisville Cream             |
| 12. Parlour Pizza              | 45. Goodwood Brewing             |
| 14. Monk's Road Boiler House   | 46. MeeshMeesh Mediterranean     |
| 15. Troll Pub Under the Bridge | 47. Garage Bar                   |
| 17. Merle's Whiskey Kitchen    | 48. Corridor Bar                 |
| 18. Doc Crow's                 | 51. La Bodeguita De Mima         |
| 19. Hell or High Water         | 53. bar Vetti                    |
| 21. Barrel Bar & Grill         | 54. Royals Hot Chicken           |
| 22. O'Shea's                   | 56. Butchertown Grocery Bakery   |
| 23. Nic & Norman's             | 57. Please & Thank You           |
| 29. White Castle               | 58. Mayan Cafe                   |
| 30. Ehrler's Ice Cream         | 59. Quills Coffee                |
| 32. Jimmy John's               | 60. Lou Lou on Market            |
| 33. Wild Eggs                  | 61. Nulu Market Place/West Sixth |
| 36. McDonald's                 | 64. Grind Burger Kitchen         |

## ATTRACTIONS

- |   |                               |
|---|-------------------------------|
| 6. Kentucky International Convention Center | 40. Angel's Envy Distillery   |
| 10. KFC Yum! Center                         | 49. Rabbit Hole Distillery    |
| 20. Old Forester Distillery                 | 63. Five Iron Golf            |
| 34. Waterfront Park Great Lawn              | 69. Climb NuLu                |
| 38. Louisville Slugger Field                | 72. Lynn Family Stadium       |
|   | 76. Copper & Kings Distillery |

## HOSPITALITY

- |                    |                            |
|--------------------|----------------------------|
| 1. The Galt House  | 27. Cambria Hotel          |
| 4. Hyatt Regency   | 28. Residence Inn          |
| 8. Marriott        | 31. Home2 Suites by Hilton |
| 9. Omni Louisville | 35. Hancock House          |
| 11. Courtyard      | 41. Tempo by Hilton        |
| 13. Econo Lodge    | 43. Hotel Genevieve        |
| 16. Holiday Inn    | 48. AC Hotel               |
| 24. Aloft          | 52. Stellar Suites         |
| 25. Hotel Distil   | 55. Springhill Suites      |
| 26. Moxy           | 62. Hampton Inn            |







# CONTACT INFORMATION

## **E.P. SCHERER**

**Senior Director**

[epscherer@commercialkentucky.com](mailto:epscherer@commercialkentucky.com)

+1 502 719 3234

## **SAM ENGLISH, CFA**

**Senior Director**

[senglish@commercialkentucky.com](mailto:senglish@commercialkentucky.com)

+1 502 719 3244



©2025 Cushman & Wakefield. All rights reserved. The information contained in this communication is strictly confidential. This information has been obtained from sources believed to be reliable but has not been verified. NO WARRANTY OR REPRESENTATION, EXPRESS OR IMPLIED, IS MADE AS TO THE CONDITION OF THE PROPERTY (OR PROPERTIES) REFERENCED HEREIN OR AS TO THE ACCURACY OR COMPLETENESS OF THE INFORMATION CONTAINED HEREIN, AND SAME IS SUBMITTED SUBJECT TO ERRORS, OMISSIONS, CHANGE OF PRICE, RENTAL OR OTHER CONDITIONS, WITHDRAWAL WITHOUT NOTICE, AND TO ANY SPECIAL LISTING CONDITIONS IMPOSED BY THE PROPERTY OWNER(S). ANY PROJECTIONS, OPINIONS OR ESTIMATES ARE SUBJECT TO UNCERTAINTY AND DO NOT SIGNIFY CURRENT OR FUTURE PROPERTY PERFORMANCE.

Independently Owned & Operated / A Member of the Cushman & Wakefield Alliance