

FOR LEASE



3402 N 36th St

Phoenix, AZ 85018



Michelle Pauley

480.442.2447

michelle.pauley@expcommercial.com
www.expcommercial.com

Sarah Purce

623.526.2971

sarah.purce@expcommercial.com
www.expcommercial.com

Section 1

Property Information



Property Summary

FOR LEASE



PROPERTY DESCRIPTION

Introducing a premier office space at 3402 N 36th St in Phoenix, AZ. This property offers an impressive array of amenities, including private offices and a conference room. With ample parking, 24/7 security, and a welcoming lobby, the property provides a secure and professional environment for businesses to thrive. The location's proximity to major transportation routes ensures easy access for employees and clients. Whether you're a startup looking for a contemporary workspace or an established firm seeking a strategic expansion, this property offers the perfect blend of functionality and sophistication for your business needs.

OFFERING SUMMARY

Lease Rate:	\$23.00 SF/yr (Full Service)
Available/Billable SF:	*1,488 SF
Lot Size:	0.33 Acres
Building Size:	2,852 SF
*See Floor Plan for SF Breakdown	

DEMOGRAPHICS	0.3 MILES	0.5 MILES	1 MILE
Total Households	818	2,737	10,738
Total Population	1,638	5,476	22,528
Average HH Income	\$94,364	\$100,573	\$105,576

Michelle Pauley

480.442.2447

michelle.pauley@expcommercial.com

Sarah Purce

623.526.2971

sarah.purce@expcommercial.com



eXp Commercial, LLC, its direct and indirect parents and their subsidiaries (together, "We") obtained the information above from sources believed to be reliable, however, We have not verified its accuracy and make no guarantee, warranty or representation, expressed or implied, about such information. The information contained above is submitted subject to the possibility of errors, omissions, price changes, rental or other conditions, prior sale, lease or financing, or withdrawal without notice. Any projections, opinions, assumptions or estimates of the information contained above or provided in connection therewith, either expressed or implied, are for example only, and they may not represent current or future performance of the subject property. You, together with your tax and legal advisors, should conduct your own thorough investigation of the subject property and potential investment.

Property Description

FOR LEASE



PROPERTY DESCRIPTION

Introducing a premier office space at 3402 N 36th St in Phoenix, AZ. This property offers an impressive array of amenities, including private offices and a conference room. With ample parking, 24/7 security, and a welcoming lobby, the property provides a secure and professional environment for businesses to thrive. The location's proximity to major transportation routes ensures easy access for employees and clients. Whether you're a startup looking for a contemporary workspace or an established firm seeking a strategic expansion, this property offers the perfect blend of functionality and sophistication for your business needs.

LOCATION DESCRIPTION

Nestled in the heart of Phoenix's vibrant Arcadia neighborhood, the office space at 3402 N 36th St offers a unique blend of functionality and charm. This ±992 sq ft suite features three private offices, a conference room, and a storage area, complemented by an additional ±121 sq ft space. Shared amenities include a breakroom, restrooms, and a welcoming reception area. Outside, a front courtyard and patio/garden areas provide a serene environment for breaks or informal meetings.

Located in the desirable Arcadia area, employees will appreciate the proximity to a variety of dining options, including Chelsea's Kitchen, Buck & Rider, and Nook Kitchen. For daily necessities, a nearby Safeway offers convenient grocery shopping.

This office space combines a professional setting with the comforts of a lively neighborhood, making it an ideal choice for businesses seeking both functionality and a vibrant location.

Michelle Pauley

480.442.2447

michelle.pauley@expcommercial.com

Sarah Purce

623.526.2971

sarah.purce@expcommercial.com



eXp Commercial, LLC, its direct and indirect parents and their subsidiaries (together, "We") obtained the information above from sources believed to be reliable, however, We have not verified its accuracy and make no guarantee, warranty or representation, expressed or implied, about such information. The information contained above is submitted subject to the possibility of errors, omissions, price changes, rental or other conditions, prior sale, lease or financing, or withdrawal without notice. Any projections, opinions, assumptions or estimates of the information contained above or provided in connection therewith, either expressed or implied, are for example only, and they may not represent current or future performance of the subject property. You, together with your tax and legal advisors, should conduct your own thorough investigation of the subject property and potential investment.

Additional Photos

FOR LEASE



Michelle Pauley

480.442.2447

michelle.pauley@expcommercial.com

Sarah Purce

623.526.2971

sarah.purce@expcommercial.com



eXp Commercial, LLC, its direct and indirect parents and their subsidiaries (together, "We") obtained the information above from sources believed to be reliable, however, We have not verified its accuracy and make no guarantee, warranty or representation, expressed or implied, about such information. The information contained above is submitted subject to the possibility of errors, omissions, price changes, rental or other conditions, prior sale, lease or financing, or withdrawal without notice. Any projections, opinions, assumptions or estimates of the information contained above or provided in connection therewith, either expressed or implied, are for example only, and they may not represent current or future performance of the subject property. You, together with your tax and legal advisors, should conduct your own thorough investigation of the subject property and potential investment.

Floor Plan

FOR LEASE

*Tenant Portion for
Common Area:
375 SQ/FT

**Total Rentable
SQ/FT: 1,113 SQ/FT**

**Total Billable
SQ/FT: 1,488 SQ/FT**

**Total SQ/FT for
Space 1: 992 SQ/FT**

**Total SQ/FT for Included
Office: 121 SQ/FT**

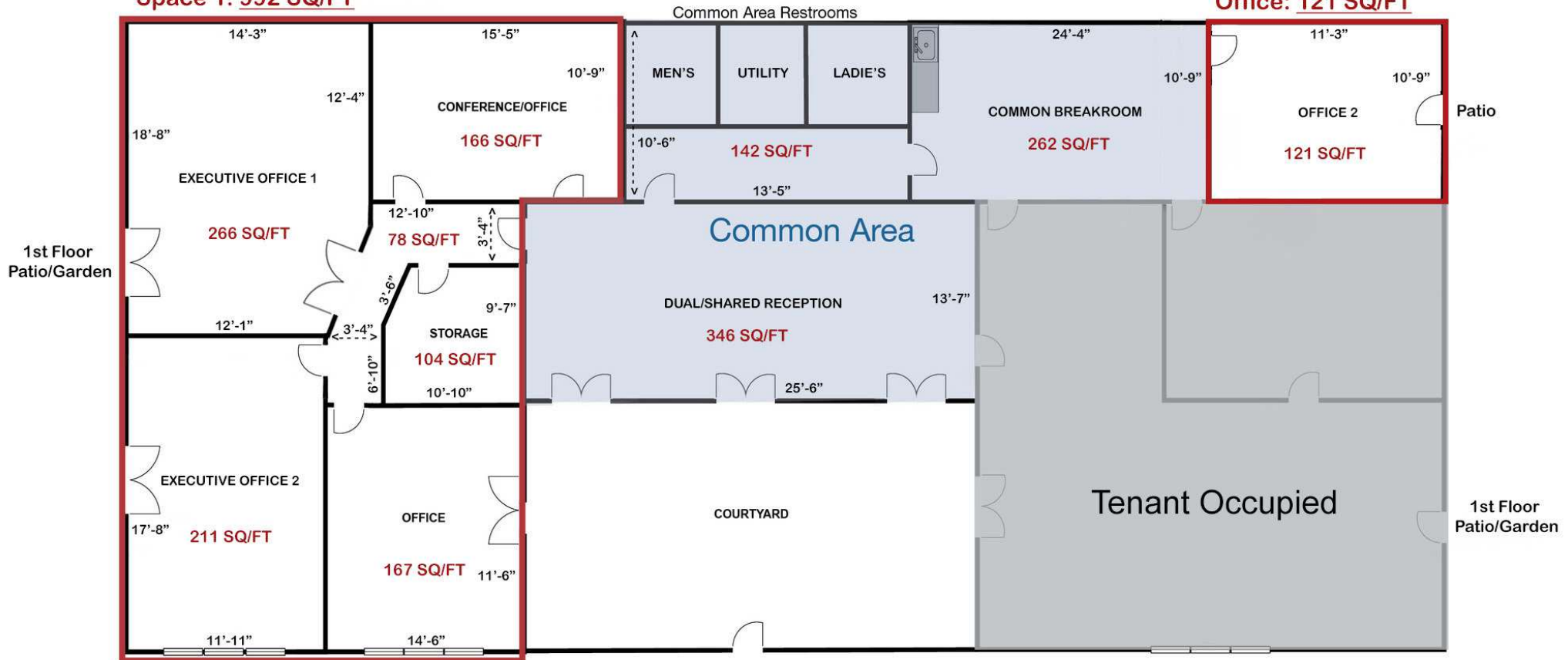

*Floor plan & dimensions are approximate

Michelle Pauley
480.442.2447
michelle.pauley@expcommercial.com

Sarah Purce
623.526.2971
sarah.purce@expcommercial.com



eXp Commercial, LLC, its direct and indirect parents and their subsidiaries (together, "We") obtained the information above from sources believed to be reliable, however, We have not verified its accuracy and make no guarantee, warranty or representation, expressed or implied, about such information. The information contained above is submitted subject to the possibility of errors, omissions, price changes, rental or other conditions, prior sale, lease or financing, or withdrawal without notice. Any projections, opinions, assumptions or estimates of the information contained above or provided in connection therewith, either expressed or implied, are for example only, and they may not represent current or future performance of the subject property. You, together with your tax and legal advisors, should conduct your own thorough investigation of the subject property and potential investment.

Section 2

Location Information



Location Map

FOR LEASE



Michelle Pauley

480.442.2447

michelle.pauley@expcommercial.com

Sarah Purce

623.526.2971

sarah.purce@expcommercial.com



eXp Commercial, LLC, its direct and indirect parents and their subsidiaries (together, "We") obtained the information above from sources believed to be reliable, however, We have not verified its accuracy and make no guarantee, warranty or representation, expressed or implied, about such information. The information contained above is submitted subject to the possibility of errors, omissions, price changes, rental or other conditions, prior sale, lease or financing, or withdrawal without notice. Any projections, opinions, assumptions or estimates of the information contained above or provided in connection therewith, either expressed or implied, are for example only, and they may not represent current or future performance of the subject property. You, together with your tax and legal advisors, should conduct your own thorough investigation of the subject property and potential investment.

Retailer Map

FOR LEASE



Michelle Pauley

480.442.2447

michelle.pauley@expcommercial.com

Sarah Purce

623.526.2971

sarah.purce@expcommercial.com



eXp Commercial, LLC, its direct and indirect parents and their subsidiaries (together, "We") obtained the information above from sources believed to be reliable, however, We have not verified its accuracy and make no guarantee, warranty or representation, expressed or implied, about such information. The information contained above is submitted subject to the possibility of errors, omissions, price changes, rental or other conditions, prior sale, lease or financing, or withdrawal without notice. Any projections, opinions, assumptions or estimates of the information contained above or provided in connection therewith, either expressed or implied, are for example only, and they may not represent current or future performance of the subject property. You, together with your tax and legal advisors, should conduct your own thorough investigation of the subject property and potential investment.

Section 3

Demographics



Demographics Map & Report

FOR LEASE

POPULATION	0.3 MILES	0.5 MILES	1 MILE
Total Population	1,638	5,476	22,528
Average Age	38	39	39
Average Age (Male)	38	38	39
Average Age (Female)	39	40	40

HOUSEHOLDS & INCOME	0.3 MILES	0.5 MILES	1 MILE
Total Households	818	2,737	10,738
# of Persons per HH	2	2	2.1
Average HH Income	\$94,364	\$100,573	\$105,576
Average House Value	\$602,504	\$631,201	\$627,487

TRAFFIC COUNTS

E Osborn Rd and 36th St /day

Demographics data derived from AlphaMap

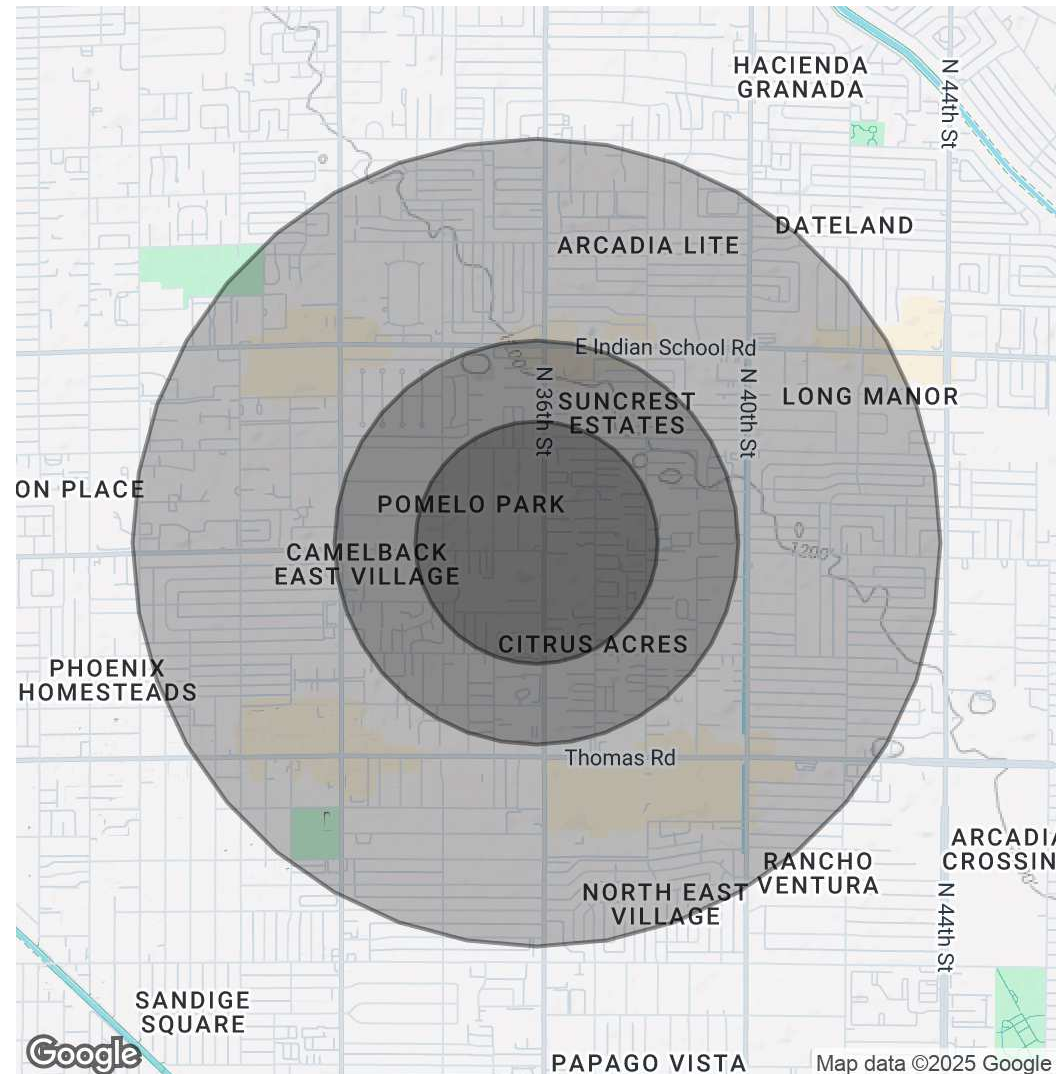

Michelle Pauley

480.442.2447

michelle.pauley@expcommercial.com

Sarah Purce

623.526.2971

sarah.purce@expcommercial.com



eXp Commercial, LLC, its direct and indirect parents and their subsidiaries (together, "We") obtained the information above from sources believed to be reliable, however, We have not verified its accuracy and make no guarantee, warranty or representation, expressed or implied, about such information. The information contained above is submitted subject to the possibility of errors, omissions, price changes, rental or other conditions, prior sale, lease or financing, or withdrawal without notice. Any projections, opinions, assumptions or estimates of the information contained above or provided in connection therewith, either expressed or implied, are for example only, and they may not represent current or future performance of the subject property. You, together with your tax and legal advisors, should conduct your own thorough investigation of the subject property and potential investment.