

# 6660 Excelsior Court

MISSISSAUGA, ON

FREESTANDING INDUSTRIAL BUILDING IN CLOSE PROXIMITY TO MAJOR HIGHWAYS



## Contact Us

**Drake LaFontaine**

Sales Representative

416 798 6224

[drake.lafontaine@cbre.com](mailto:drake.lafontaine@cbre.com)

**John LaFontaine\***

Vice Chairman

416 798 6229

[john.lafontaine@cbre.com](mailto:john.lafontaine@cbre.com)

\*Sales Representative



# Well-Maintained Freestand

## PROPERTY DETAILS

AVAILABLE SIZE 29,471 SQ. FT.

INDUSTRIAL AREA 26,471 SQ. FT.

OFFICE AREA 3,000 SQ. FT.

SHIPPING DOORS 3 Truck Level & 1 Drive-In

CLEAR HEIGHT 18.0'

BAY SIZE 33' X 34'

ZONING E2

HEAT TYPE Gas, forced air open

POWER TBC

POSSESSION TBD

ASKING RATE \$17.95 Net Per Sq. Ft.

T.M.I. (EST 2025) \$4.20 Per Sq. Ft.

### COMMENTS

- Lighting is all new energy efficient fluorescent bulbs
- All dock doors are equipped with levelers
- Zoning allows most industrial uses

ALL INFORMATION TO BE VERIFIED





# Superior Location

Excellent accessibility in close proximity to major highways, transit and many amenities.

## Transit Legend

- Route 17 - Hurontario
- Route 103 - Hurontario Express
- Route 18 - McLaughlin-Derry
- Route 66 - McLaughlin
- Route 42 - Derry
- Route 53 - Kennedy
- Route 57 - Courtneypark
- Route 29 - Britannia
- Route 51 - Tomken
- Route 70 - Keaton



## TRAVEL DISTANCES

**HIGHWAY 410**  
4 MIN • 1.9 KM

**HIGHWAY 401**  
5 MIN • 2.0 KM

**HIGHWAY 407**  
6 MIN • 2.6 KM

**HIGHWAY 427**  
9 MIN • 11.0 KM

**HIGHWAY 403**  
8 MIN • 4.5 KM

**PEARSON INTERNATIONAL AIRPORT**  
12 MIN • 3.2 KM

**BRAMPTON CN INTERMODAL**  
18 MIN • 13.8 KM

**HIGHWAY 427**  
11 MIN • 12.1 KM

**TORONTO DOWNTOWN**  
39 MIN • 33.9 KM

# Floor Plan

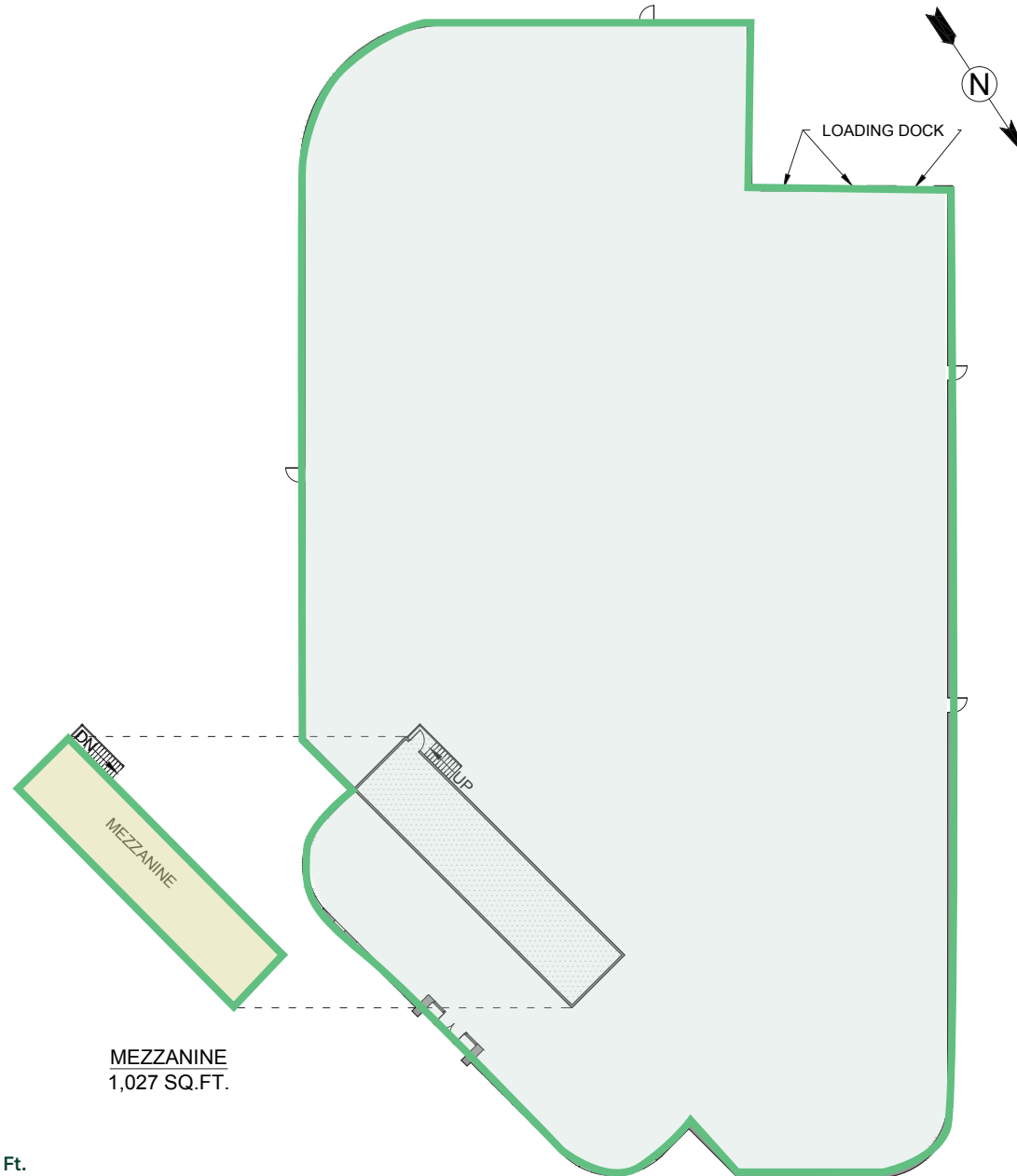



# Zoning Information • E2 Employment

## E2 Zone Permitted Uses

In the E2 zone, the following uses are permitted:

### OFFICE

- Medical Office
- Office

### BUSINESS ACTIVITIES

- Broadcasting/Communication Facility
- Manufacturing Facility
- Truck Terminal
- Warehouse/Distribution Facility
- Wholesaling Facility
- Waste Processing Station (¹)
- Waste Transfer Station (¹)
- Composting Facility (¹)
- Self Storage Facility
- Contractor Service Shop
- Medicinal Product Manufacturing Facility (¹)
- Medicinal Product Manufacturing Facility - Restricted
- Plant-Based Manufacturing Facility (¹)

### COMMERCIAL

- Restaurant
- Convenience Restaurant (¹³)
- Take-out Restaurant
- Commercial School
- Financial Institution (¹³)
- Veterinary Clinic
- Animal Care Establishment

### MOTOR VEHICLE SERVICE

- Motor Vehicle Repair Facility - Restricted
- Motor Vehicle Rental Facility
- Motor Vehicle Rental Facility - Restricted

- Gas Bar (¹)(²)(¹³)
- Motor Vehicle Rental Facility
- Motor Vehicle Service Station (¹³)
- Motor Vehicle Sales, Leasing and/or Rental Facility - Commercial Motor Vehicles (¹)

### HOSPITALITY

- Banquet Hall/Conference Centre/Convention Centre
- Night Club (¹) (³)
- Overnight Accommodation

### OTHER

- Adult Video Store (¹)
- Adult Entertainment Establishment (¹)
- Animal Boarding Establishment (¹)
- Active Recreational Use
- Body-Rub Establishment (¹)
- Truck Fuel Dispensing Facility
- Entertainment Establishment
- Recreational Establishment
- Funeral Establishment (⁴)
- Private Club
- Repair Establishment
- Parking Lot
- University/College
- Courier/Messenger Service

\*Not an exhaustive list. Tenant to verify that intended use complies with zoning.

Source: City of Mississauga Website

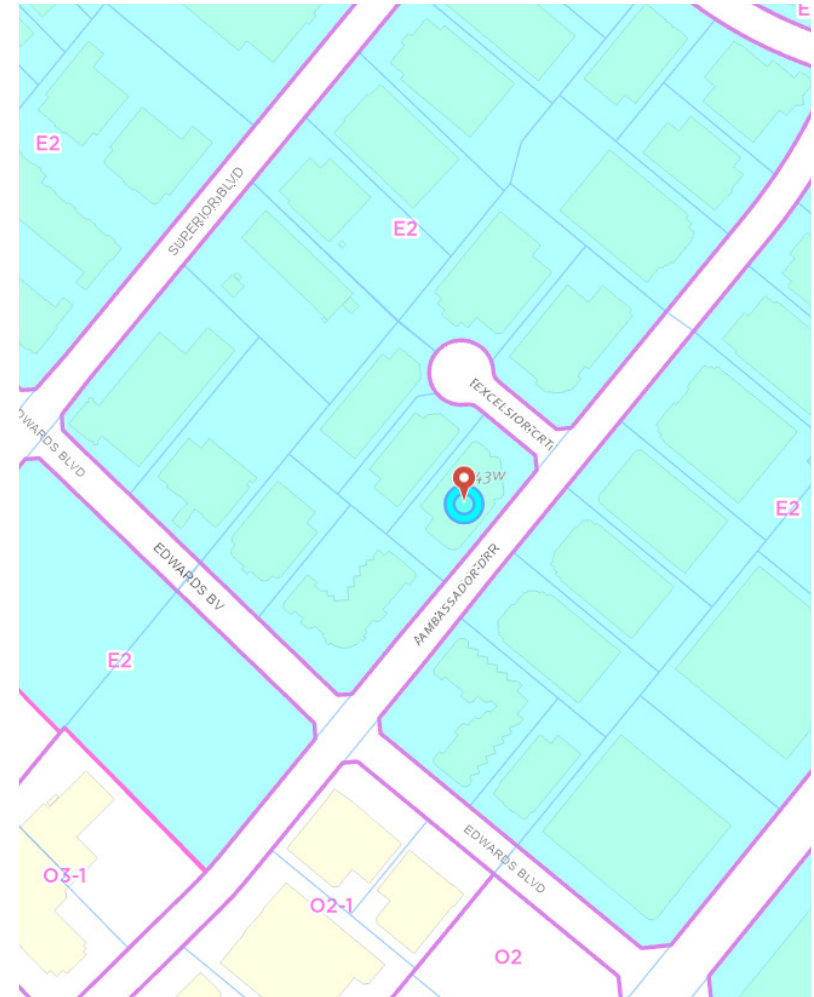

ZONING WEBSITE

## DEMOGRAPHICS & LABOUR

	TOTAL POPULATION	TOTAL LABOUR FORCE
<b>5 KM</b>	143,098	80,444
<b>10 KM</b>	846,746	458,177
<b>15 KM</b>	1,790,178	968,257

## MISSISSAUGA



786,789  
Population (2024)



670,512  
Labour Force



\$137,007  
Avg. Household Income



38.1  
Median Age

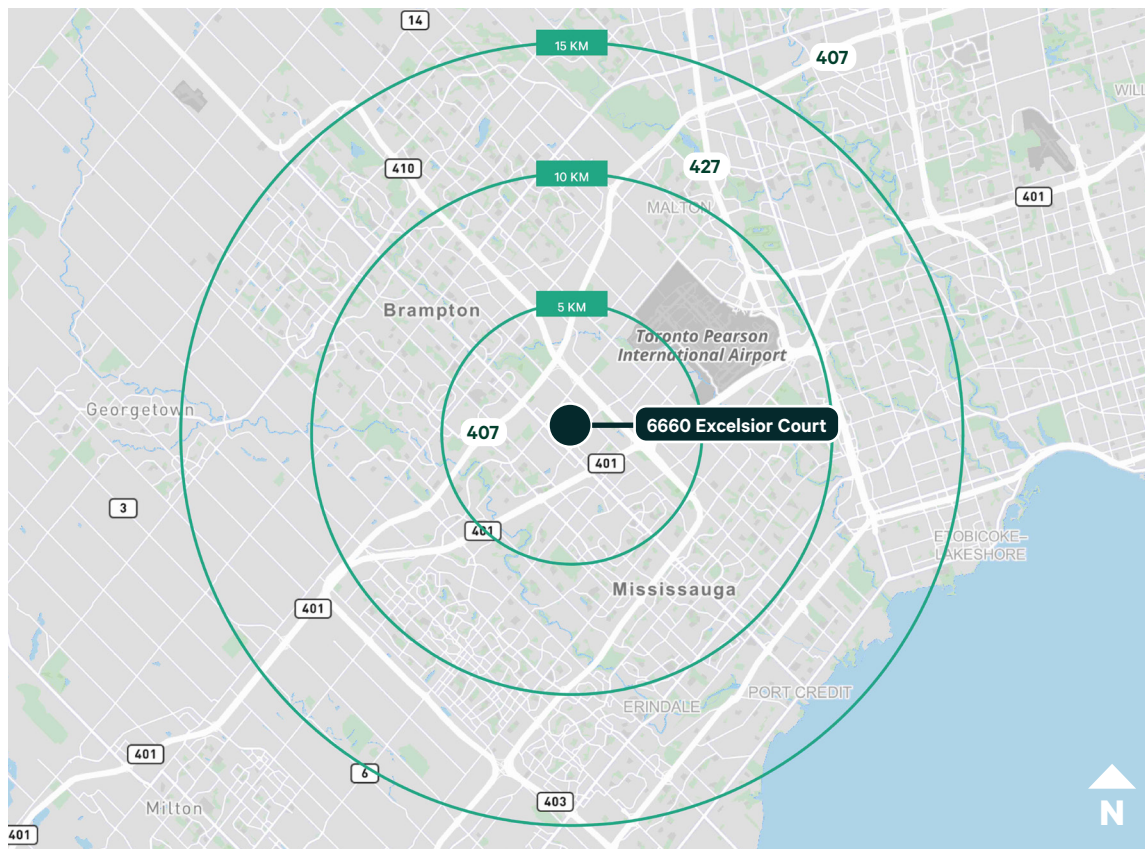

## Contact Us

**Drake LaFontaine**  
Sales Representative  
416 798 6224  
drake.lafontaine@cbre.com

**JOHN LAFONTAINE\***  
Vice Chairman  
416 798 6229  
john.lafontaine@cbre.com

\*Sales Representative



This disclaimer shall apply to CBRE Limited, Real Estate Brokerage, and to all other divisions of the Corporation ("CBRE"). The information set out herein, including, without limitation, any projections, images, opinions, assumptions and estimates obtained from third parties (the "Information") has not been verified by CBRE, and CBRE does not represent, warrant or guarantee the accuracy, correctness and completeness of the Information. CBRE does not accept or assume any responsibility or liability, direct or consequential, for the Information or the recipient's reliance upon the Information. The recipient of the Information should take such steps as the recipient may deem necessary to verify the Information prior to placing any reliance upon the Information. The Information may change and any property described in the Information may be withdrawn from the market at any time without notice or obligation to the recipient from CBRE. CBRE and the CBRE logo are the service marks of CBRE Limited and/or its affiliated or related companies in other countries. All other marks displayed on this document are the property of their respective owners. All Rights Reserved. Mapping Sources: Canadian Mapping Services canadamapping@cbre.com; DMTI Spatial, Environics Analytics, Microsoft Bing, Google Earth