

500 Willow Walk Cir Ne, Plainfield, MI

https://app.regrid.com/us/mi/kent/plainfield/579350

Regrid

By Loveland Technologies · Oct 31, 2025

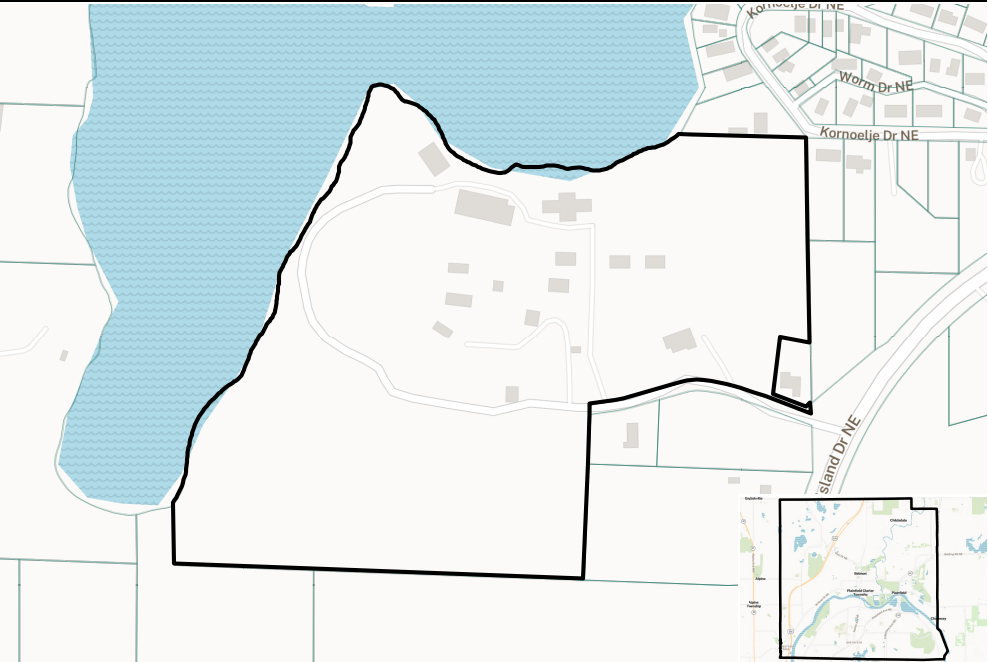

Lat/Long: 43.08886, -85.65497

In: 49321, Census Tract 111.01, Plainfield, Kent County, Michigan

Parcel Data Fields

Parcel ID:	411007451003	Median Household Income (current year):	88037.0
Owner Name:	SALVATION ARMY	Distance to Transmission line:	526.0
Parcel Address:	500 WILLOW WALK CIR NE	Roughness Rating:	4.0
Parcel Address City:	COMSTOCK PARK	Highest Parcel Elevation:	248.39
Parcel Address Zip Code:	49321-9616	Lowest Parcel Elevation:	227.82
Parcel Use Code:	201	Zoning Code:	PUD
Zoning Type:	Planned	Zoning Description:	Planned Unit Development
Zoning Subtype:	Planned	Parcel Value Type:	SEV
Zoning Code Link:	https://www.zoneomics.com/code/plainfield-charter-township-MI	Total Parcel Value:	0.0
Zoning Area ID:	11346719	Mailing Address:	PO BOX 2603
Regrid	1	Mailing Address City:	GRAND RAPIDS
Calculated Total Address Count:		Mailing Address State:	MI
FEMA Flood Zone:	X	Mailing Address ZIP Code:	49501-2603
FEMA Flood Zone Subtype:	AREA OF MINIMAL FLOOD HAZARD	Original Mailing Address:	{"mailadd":"PO BOX 2603", "mail_city":"GRAND RAPIDS", "mail_state2":"MI", "mail_zip":"49501 "}
FEMA Flood Zone Raw Data:	[{"zone":"X","subtype":"AREA OF MINIMAL FLOOD HAZARD","percent":100}]	Parcel Address Number:	500
FEMA Flood Zone Data Date:	2023-10-17	Parcel Address Street Name:	WILLOW WALK
FEMA NRI Risk Rating:	Very Low	5 Digit Parcel Zip Code:	49321
Census Provided Unified School District:	Comstock Park Public Schools	Latitude:	43.088858
Regrid	59239	Longitude:	-85.654966
Calculated Building Footprint Square Feet:			
Regrid	21		
Calculated Building Count:			

Cropland Data Layer Raw Values: [[141, 45.5], [190, 19.7], [121, 13.5], [122, 10.1], [123, 2.2], [143, 2.2], [68, 1.7], [66, 1.1], [195, 1.1], [111, 1.1], [36, 0.6], [37, 0.6], [176, 0.6]]
Cropland Data Layer Majority Category: Deciduous Forest
Cropland Data Layer Majority Percent: 45.5
Cropland Data Layer Date: 2023
Precisely ID: P0000BZPFTWJ
Placekey: 222@5s5-p4p-47q
USPS Delivery Point Validation: V
Delivery Point Validation Codes: YNNNN
Delivery Point Validation Notes: AABB
Delivery Point Match Type: S
CASS Error Codes: A1
Residential Delivery Indicator: Y
USPS Vacancy Indicator: N
USPS Vacancy Indicator Date: 2025-10-01
Land Use Code: 2000.0
Activity: Shopping, business, or trade
Land Use Code Description: Activity:
Land Use Code: 2000.0
Function: General sales or services
Land Use Code Description: Function:
Land Use Code: 2000.0
Structure: Commercial buildings and other specialized structures
Land Use Code Description: Structure:
Land Use Code: 6000.0
Site: Developed site with buildings
Land Use Code Description: Site:
Land Use Code: 6300.0
Ownership: Nonprofit religious
Land Use Code Description: Ownership:
Housing Affordability Index: 109.0
Population Density: 570.9
Population Growth (CAGR) past 5 years: -0.28
Population Growth (CAGR) next 5 years: -0.34
Housing Units Growth (CAGR) past 5 years: -0.08

Census 2020 Tract: 26081011101
Census 2020 Block: 260810111012007
Census 2020 Blockgroup: 260810111012
Census Zip Code Tabulation Area: 49321
County-Provided Acres: 39.65209764
PLSS Township: 008N
PLSS Section: Section 07
PLSS Range: 011W
Ppn Text: 411007451003
Ppn: 411007451003.0
Tax Parcel Flag: Yes
In ROW Flag: No
Governmental Unit: 26
School District: 41080
Taxable Tribunal 1: 0.0
SEV Tribunal 2: 0.0
Taxable Tribunal 2: 0.0
Summary Total Acreage: 43.69
Condo Flag: No
Hydro Flag: No
Railroad ROW Flag: No
Common Element Flag: No
Ewho: KC_DOM/ajberkom
Edate: 1392202659000
Doc Link: 1.0
Parcel Number: 41-10-07-451-003
PPN F: 41-10-07-451-003
Regrid UUID: 90a5271f-b5e3-401c-9753-d9d42edb72b3
Calculated Acres: 39.63775
Calculated Parcel Sq Ft: 1726656
Federal Qualified Opportunity Zone: No

Housing Units Growth (CAGR) next 5 years:	0.0
Median Household Income Growth (CAGR) next 5 years:	2.2