

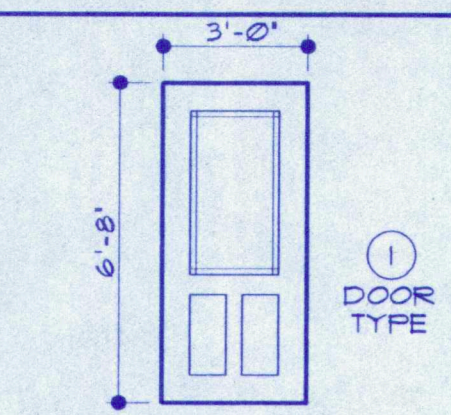
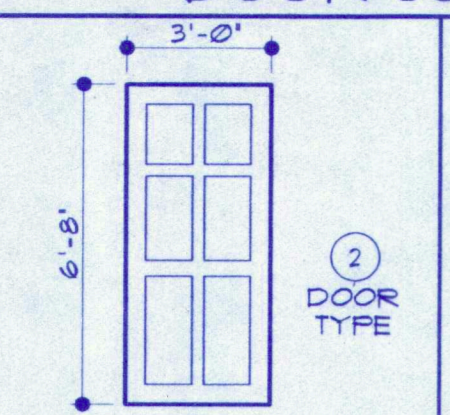
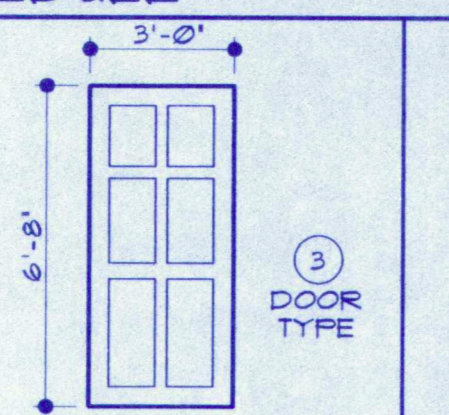
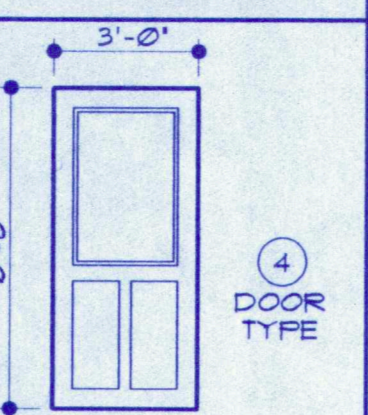
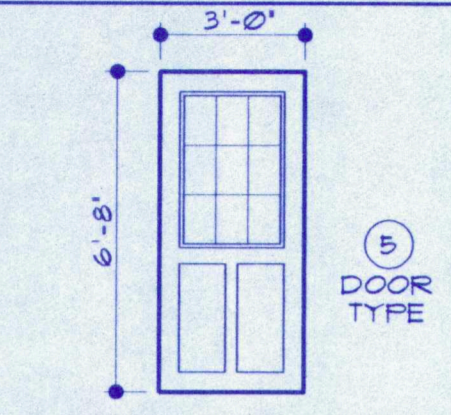
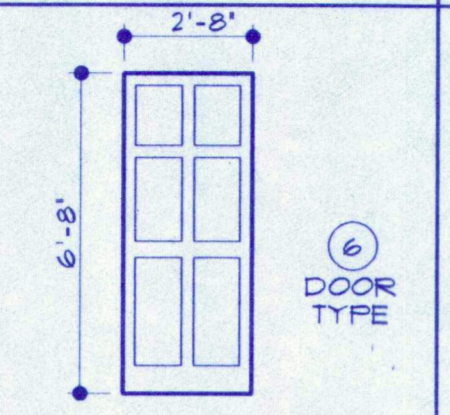
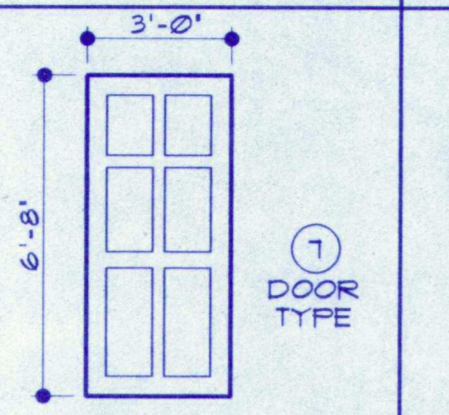
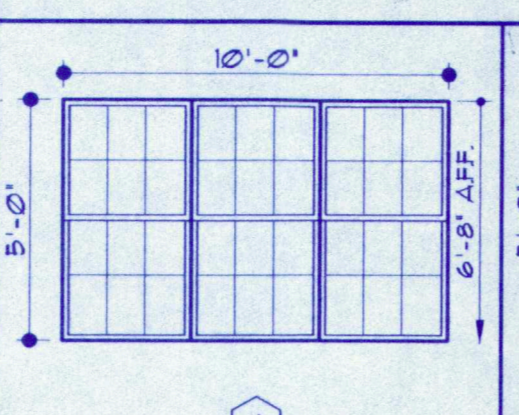
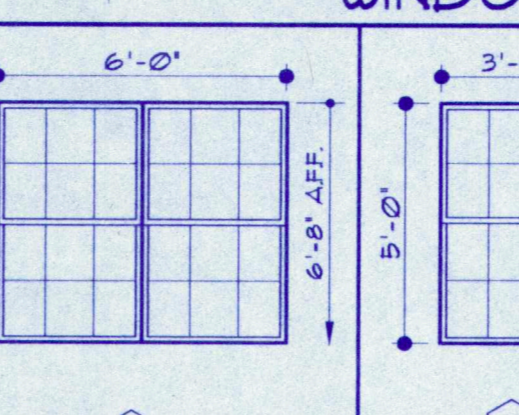
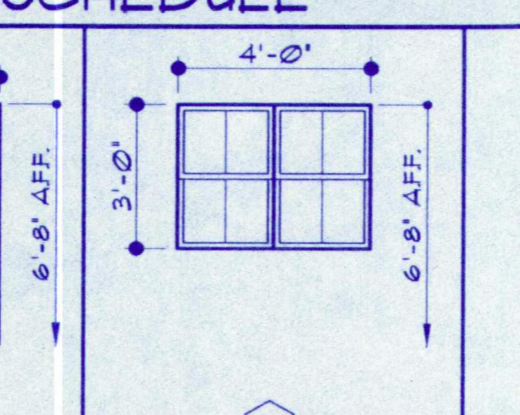
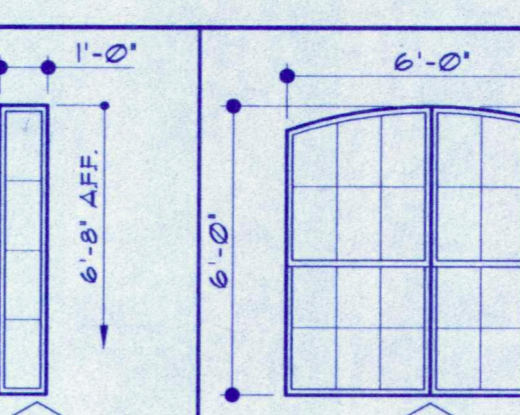
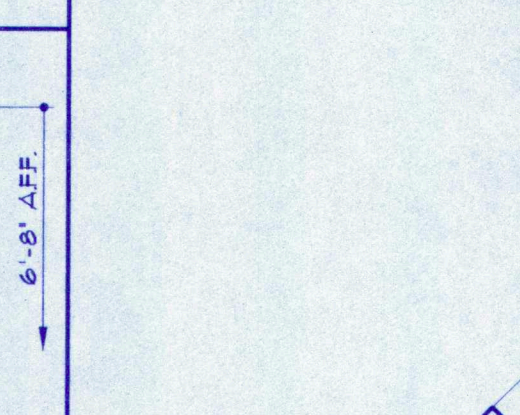

DOOR SCHEDULE

 <p>① DOOR TYPE 1-3/4' RAISED PANEL WITH VISION GLASS SELF-CLOSING W/ PANIC HARDWARE & WEATHERSTRIP</p>	 <p>② DOOR TYPE 1-3/4' R.C. RAISED PANEL SELF-CLOSING</p>	 <p>③ DOOR TYPE 1-3/4' R.C. RAISED PANEL WITH VISION GLASS SELF-CLOSING W/ PANIC HARDWARE & WEATHERSTRIP</p>	 <p>④ DOOR TYPE 1-3/4' R.C. RAISED PANEL W/ D.L. VISION GLASS INSERT</p>
 <p>⑤ DOOR TYPE 1-3/4' R.C. RAISED PANEL W/ D.L. VISION GLASS INSERT, PANIC HARDWARE & WEATHERSTRIP</p>	 <p>⑥ DOOR TYPE 1-3/8' RAISED PANEL SELF-CLOSING</p>	 <p>⑦ DOOR TYPE 1-3/8' RAISED PANEL</p>	

WINDOW SCHEDULE

 <p>① TRIPLE S.H. D.L. W/ SCREEN & OPERABLE SASH</p>	 <p>② TWIN S.H. D.L. W/ SCREEN & OPERABLE SASH</p>	 <p>③ S.H. D.L. W/ SCREEN & OPERABLE SASH</p>	 <p>④ TWIN S.H. D.L. W/ SCREEN & OPERABLE SASH</p>	 <p>⑤ FIXED TEMP. D.L. IN ALUMINUM FRAME</p>	 <p>⑥ TWIN S.H. D.L. W/ SCREEN & OPERABLE SASH (SEMI-ARCH)</p>
 <p>⑦ FIXED ALUM. D.L.</p>	 <p>⑧ FIXED ALUM. D.L. TRANSCOM</p>	 <p>⑨ FIXED ALUM. D.L. W/ TRAN. TEMP. GLASS</p>	 <p>⑩ 24\" data-bbox="615 170 690 260"/> </p>	 <p>⑪ FIXED ALUM. D.L. (HALF ROUND)</p>	 <p>⑫ FIXED TEMP. IN ALUM. FRAME (INTERIOR)</p>

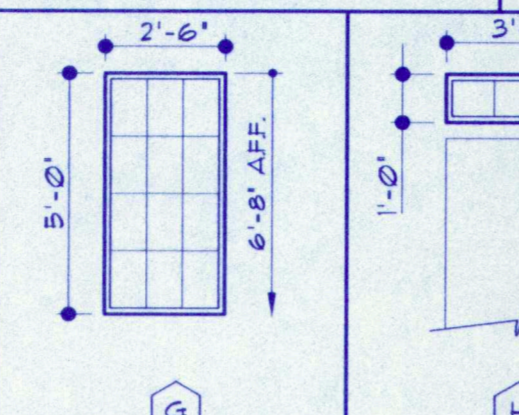
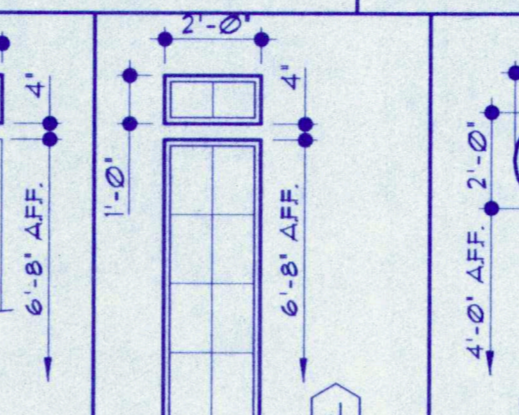
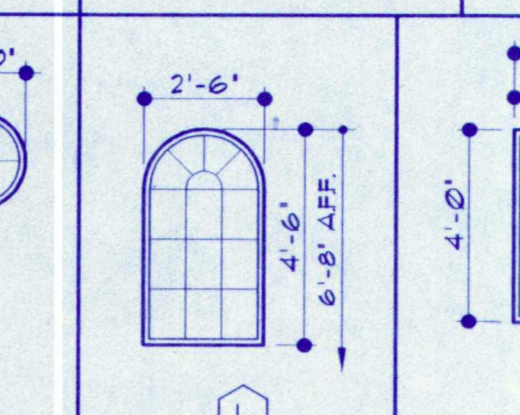
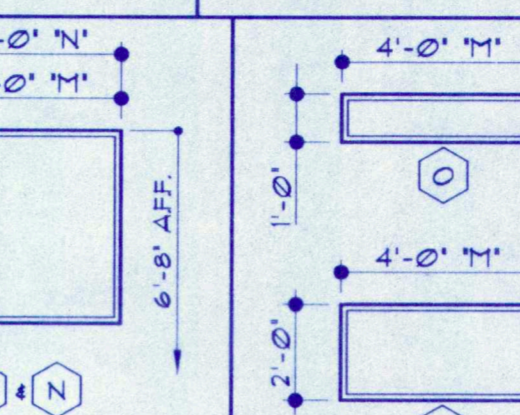
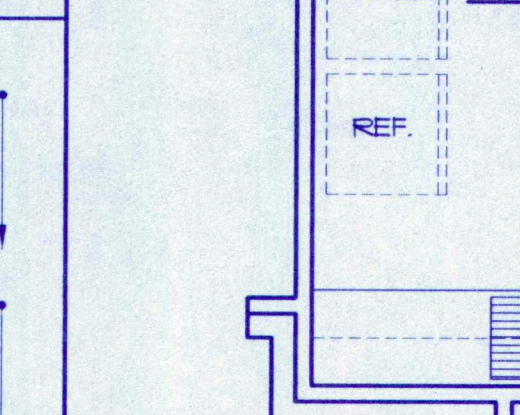
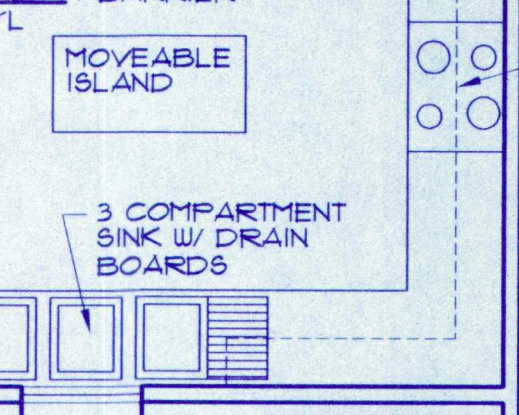
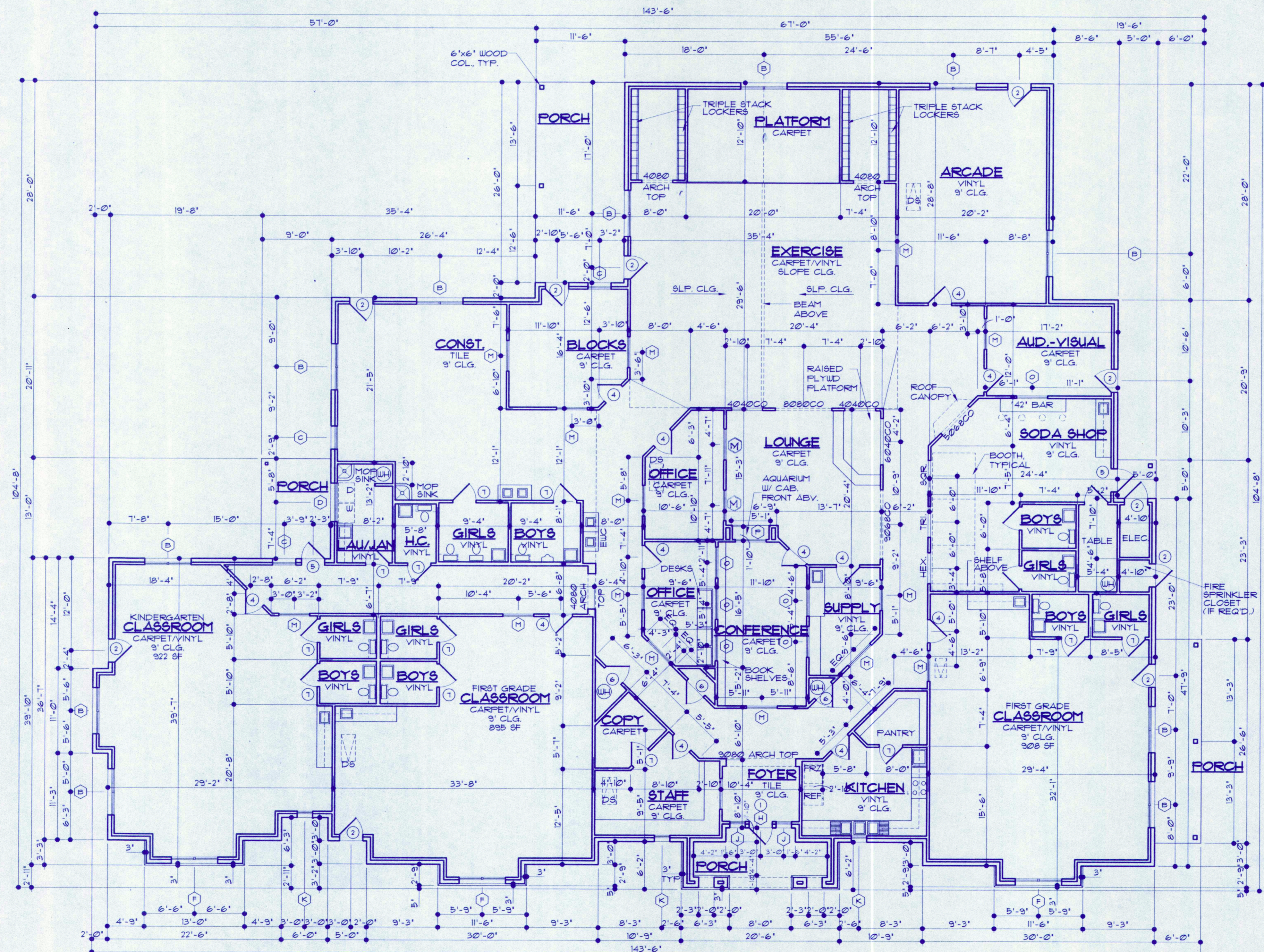
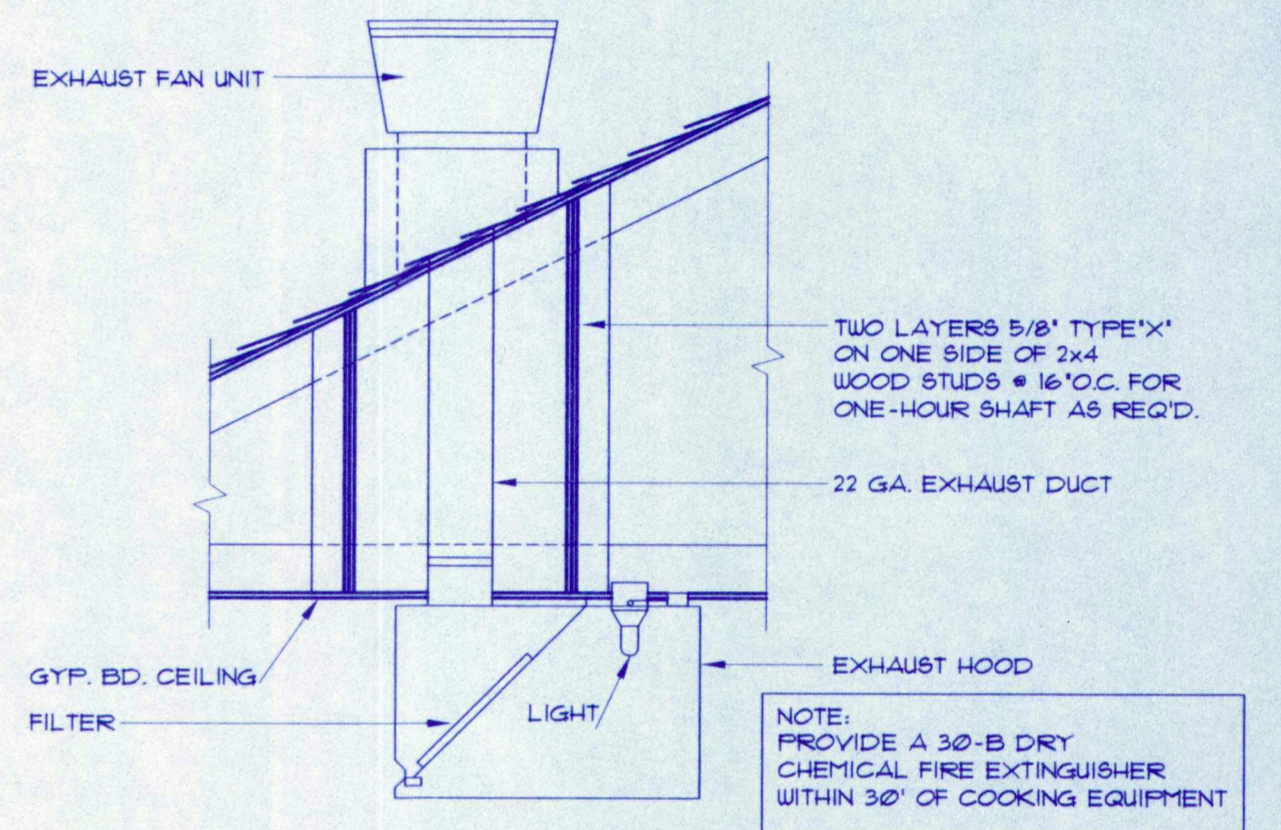
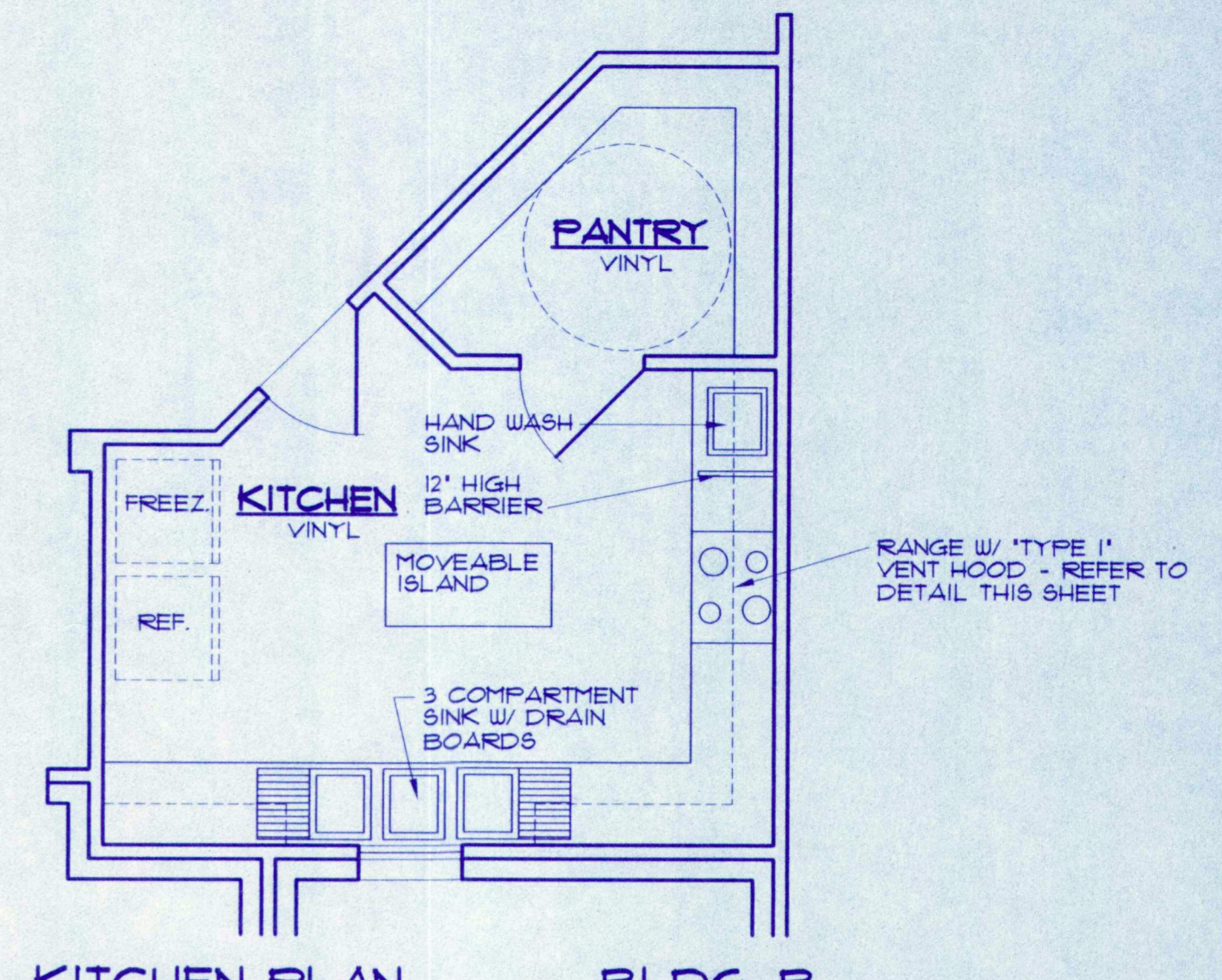

- KITCHEN & PANTRY FINISH NOTES:**
- FLOOR: 12x12 vinyl tile - Armstrong
AL - 80 L.T. Berry Blossom
Alternate AL - 11 Pearl White
 - BASE: Vinyl, Nafco - 'Lilac Grey', CB - 31
AL Nafco - 'Pearl White', CB - 10
 - WALLS & CEILING: 'Off-White' semi-gloss epoxy or enamel paint on smooth, un-textured drywall.
 - CABINETS: All surfaces, interior and exterior, to be smooth, easily cleanable, non-absorbent & light colored. Light stained finish with clear lacquer finish. Any surface not stained to have epoxy or enamel paint finish.
 - COUNTERTOP: Plastic laminate, light colored, smooth, non-absorbent and easily cleanable. Epoxy or enamel paint underside and all exposed surfaces.
Floors: 'Winter White', 50536 B - Swede
Floors: 'Wild Orchid', 50440 - Swede
 - PANTRY: All storage shelves must be smooth & washable, with laminate contact surfaces (tops), epoxy or enamel paint all other surfaces. Floors, walls and ceilings to be smooth, easily cleanable and non-absorbent.
 - HANDSINK: Provide non-absorbent splash guard to side of sink. Match countertop.

- GENERAL NOTES:**
- CEILINGS TO BE 9'-0" AFF. UNLESS NOTED OTHERWISE.
 - PROVIDE AN APPROVED FIRE ALARM SYSTEM.
 - HALLWAYS ARE NON-RATED PER 1994 UBC, SECTION 1017.5, EXCEPTION.
 - DOORS MAY SWING INTO CLASSROOMS PER 1994 UBC, SECTION 1004.2 (W/ OCCUPANT LOAD LESS THAN 50).
 - PANIC HARDWARE REQUIRED ON EXIT DOORS FROM HALLWAYS, BUT NOT EXIT DOORS FROM CLASSROOMS, (W/ OCCUPANT LOAD LESS THAN 50) PER 1994 UBC, SECTION 1017.11.
 - PROVIDE PORTABLE FIRE EXTINGUISHERS WITHIN 75 FEET TRAVEL DISTANCE FROM ANY POINT IN THE BUILDING.

FIXTURE COUNT/ 192 KIDS

	REQUIRED	PROVIDED
TOILETS/ URINALS	12	12
SINKS	12	20

AREAS: BUILDING B

AREA	AREA	AREA
A/C AREA	10262 SF	
ELECTRICAL CLOSET	31 SF	
PORCHES	732 SF	
TOTAL UNDER ROOF	11025 SF	

REVISIONS

NO.	DATE	BY
1	10/3/00	GW

The Children's Courtyard
COPPELL, TEXAS
COPPELL, TEXAS



806 1/2 Ham...
address...
76010
817/548-8714
fax: 817/261-2302

wood - stovall
architects / designers

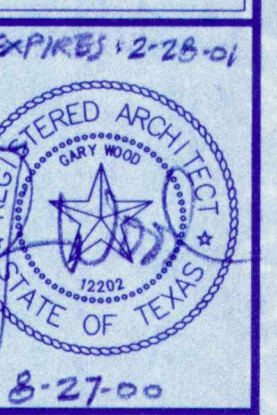

DATE: 01/21/00
DRAWN:
JOB: Ccl999/990205
SHEET: A201
OF 2 sheets