

# ORCHARD OFFICE PARK

410 S. ORCHARD STREET SUITE 116, BOISE, ID



**FOR SALE/LEASE** | Office Condo

## KARENA GILBERT

Vice President  
+1 208 861 4940  
karena.gilbert@cbre.com

## HIGHLIGHTS

- Bright and spacious two-story office condo
- Open workspace and private offices and conference room
- Centrally located on the Boise Bench
- 4 Miles to Downtown Boise and Boise Airport

## PROPERTY INFORMATION

<b>Building Type</b>	Office Condo
<b>Available SF</b>	±3,006
<b>Purchase Price</b>	\$599,000
<b>Lease Rate</b>	\$17 sqft/yr
<b>Lease Type</b>	FSEJ



# PROPERTY GALLERY

FOR SALE/LEASE  
OFFICE CONDO

410 S. Orchard St., Ste. 116, Boise, ID



# LOCATION

410 S. Orchard, Suite 116 is a two-story office condo situated on the Boise Bench. Quick interstate access and a commute under 10 minutes to the Downtown Boise and Boise Airport. The bright, spacious workspace features a professional conference room, and private restrooms. Benefit from the flexibility of having both an open workspace and private offices, complemented by a dedicated printer workspace.

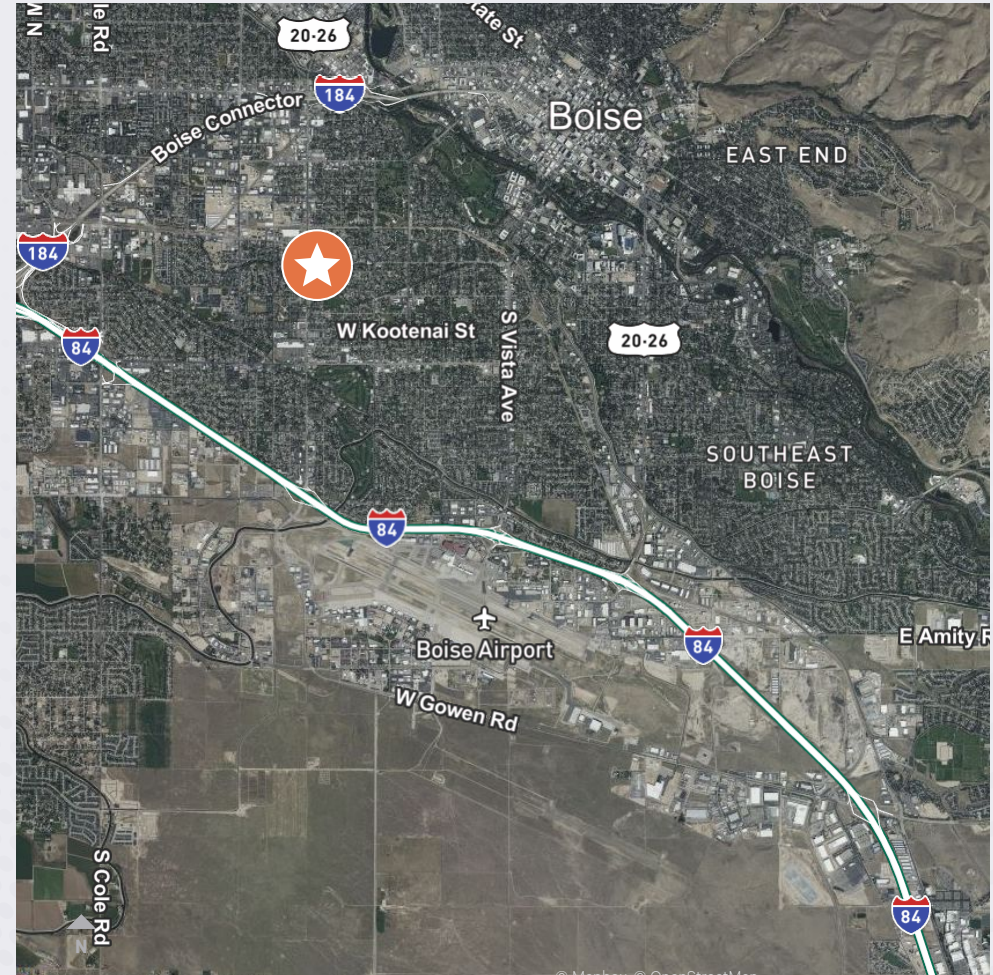
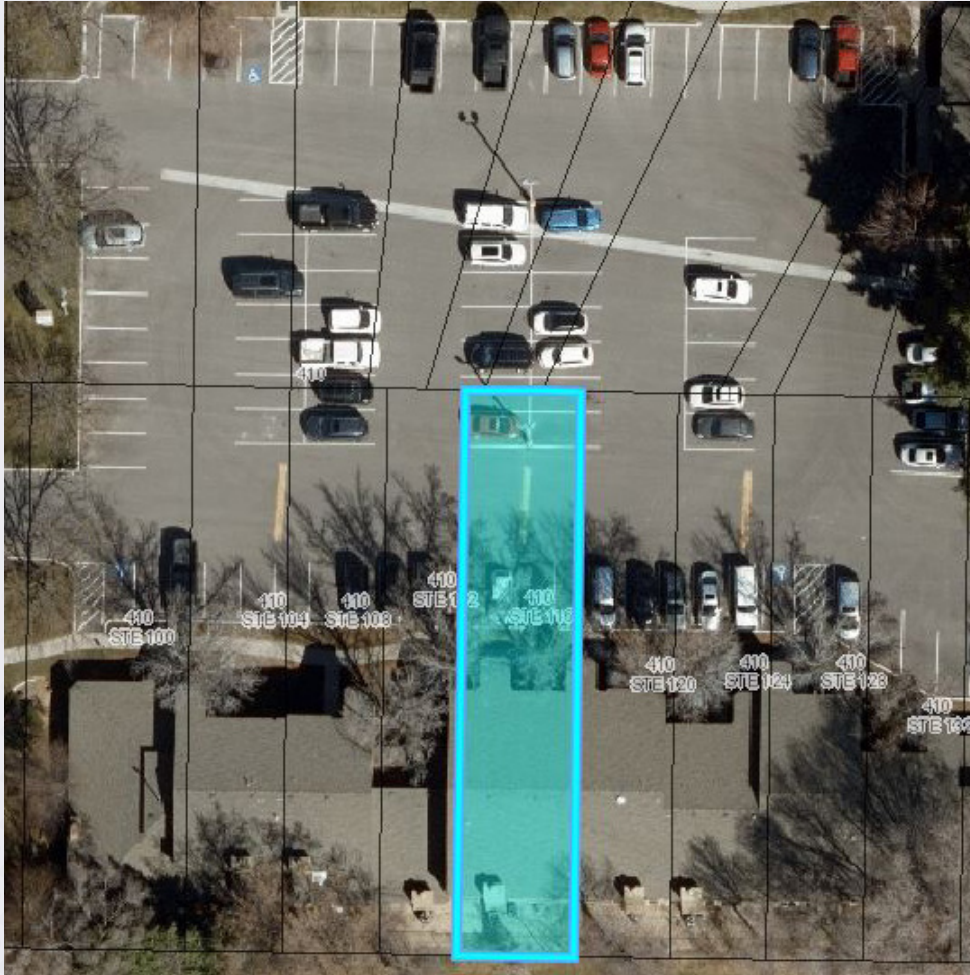

## KARENA GILBERT

Vice President

+1 208 861 4940

karena.gilbert@cbre.com



# ORCHARD OFFICE PARK

410 S. ORCHARD STREET, SUITE 116, BOISE, ID



Suite  
116

FOR SALE/LEASE | OFFICE CONDO

**KARENA GILBERT**

Vice President

+1 208 861 4940

karena.gilbert@cbre.com

**CBRE**

© 2024 CBRE, Inc. All rights reserved. This information has been obtained from sources believed reliable but has not been verified for accuracy or completeness. CBRE, Inc. makes no guarantee, representation or warranty and accepts no responsibility or liability as to the accuracy, completeness, or reliability of the information contained herein. You should conduct a careful, independent investigation of the property and verify all information. Any reliance on this information is solely at your own risk. CBRE and the CBRE logo are service marks of CBRE, Inc. All other marks displayed on this document are the property of their respective owners, and the use of such marks does not imply any affiliation with or endorsement of CBRE. Photos herein are the property of their respective owners. Use of these images without the express written consent of the owner is prohibited.