



Sisemore Weisz & Associates, Inc.

Engineering • Land Surveying  
Land Planning • 3D Scanning • UAV Mapping

6111 E. 32<sup>nd</sup> Place Tulsa, OK. 74135 (918)-665-3600

### LEGAL DESCRIPTION

A TRACT OF LAND THAT IS PART OF THE NORTHEAST QUARTER OF THE SOUTHEAST QUARTER (NE/4 SE/4) OF SECTION TWENTY-THREE (23), TOWNSHIP EIGHTEEN (18) NORTH, RANGE TWELVE (12) EAST OF THE INDIAN BASE AND MERIDIAN, TULSA COUNTY, STATE OF OKLAHOMA, ACCORDING TO THE UNITED STATES GOVERNMENT SURVEY THEREOF, BEING MORE PARTICULARLY DESCRIBED AS FOLLOWS:

**BEGINNING** AT THE NORTHEAST CORNER OF SAID NE/4 SE/4; THENCE SOUTH 0°58'18" EAST ALONG THE EASTERLY LINE OF SAID SECTION 23 FOR 266.06 FEET TO A POINT THAT IS 15 FEET NORTHERLY OF THE NORTHERLY EDGE OF THE JENKS LEVEE; THENCE NORTH 27°41'47" WEST PARALLEL WITH AND 15 FEET NORTHERLY OF THE NORTHERLY LINE OF SAID JENKS LEVEE FOR 83.00 FEET TO A POINT OF CURVE; THENCE ALONG A CURVE TO THE LEFT PARALLEL WITH AND 15 FEET NORTHERLY OF THE NORTHERLY LINE OF SAID JENKS LEVEE, WITH A RADIUS OF 45.00 FEET, A CENTRAL ANGLE OF 63°25'29", A CHORD BEARING OF NORTH 59°24'32" WEST, A CHORD DISTANCE OF 47.31 FEET FOR AN ARC LENGTH OF 49.81 FEET TO A POINT OF TANGENCY; THENCE SOUTH 88°52'44" WEST PARALLEL WITH AND 15 FEET NORTHERLY OF THE NORTHERLY LINE OF SAID JENKS LEVEE FOR 245.76 FEET; THENCE SOUTH 84°51'22" WEST PARALLEL WITH AND 15 FEET NORTHERLY OF THE NORTHERLY LINE OF SAID JENKS LEVEE FOR 70.01 FEET; THENCE SOUTH 88°59'55" WEST PARALLEL WITH AND 15 FEET NORTHERLY OF THE NORTHERLY LINE OF SAID JENKS LEVEE FOR 168.61 FEET TO A POINT OF CURVE; THENCE ALONG A CURVE TO THE RIGHT, PARALLEL WITH AND 15 FEET NORTHERLY OF THE NORTHERLY LINE OF SAID JENKS LEVEE, WITH A RADIUS OF 525.00 FEET, A CENTRAL ANGLE OF 33°10'53", A CHORD BEARING OF NORTH 74°24'38" WEST, A CHORD DISTANCE OF 299.81 FEET FOR AN ARC LENGTH OF 304.04 FEET TO A POINT OF TANGENCY; THENCE NORTH 57°49'12" WEST PARALLEL WITH AND 15 FEET NORTHERLY OF THE NORTHERLY LINE OF SAID JENKS LEVEE FOR 158.66 FEET TO A POINT ON THE NORTHERLY LINE OF SAID NE/4 SE/4; THENCE NORTH 88°59'02" EAST ALONG SAID NORTHERLY LINE FOR 982.04 FEET TO THE POINT OF BEGINNING OF SAID TRACT OF LAND.

SAID TRACT OF LAND CONTAINING 3.331 ACRES OR 145,094 SQUARE FEET, MORE OF LESS.

### LEGAL DESCRIPTION CERTIFICATION

I, SHAWN A. COLLINS, OF SISEMORE WEISZ & ASSOCIATES, CERTIFY THAT THE ATTACHED LEGAL DESCRIPTION CLOSES IN ACCORD WITH EXISTING RECORDS, IS A TRUE REPRESENTATION OF THE LEGAL DESCRIPTION AS DESCRIBED, AND MEETS THE MINIMUM TECHNICAL STANDARDS FOR LEGAL DESCRIPTIONS FOR THE STATE OF OKLAHOMA.

01.08.2019

DATE

SISEMORE WEISZ & ASSOCIATES, INC.  
BY SHAWN A. COLLINS

SHAWN A. COLLINS

PLS No. 1788, STATE OF OKLAHOMA

C. A. NO. 2421

EXPIRES: 01/08/2019

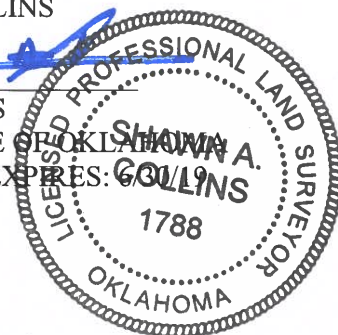

# Exhibit

## Part of the NE/4 of the SE/4 of Section 23, T-18-N, R-12-E

### West 96th Street South

NORTH LINE NE/4 SE/4  
982.04'  
N 88°59'02" E

**3.331 Acres**

N57°49'12" W  
158.66'  
L=304.04'  
R=525.00'  
CA=33°10'53"  
CB=N 74°24'38" W  
CD=299.81'

S 88°59'55" W 168.61'  
S 84°51'22" W 70.01'  
S 88°52'44" W 245.76'

L=49.81'  
R=45.00'  
CA=63°25'29"  
CB=N 59°24'32" W  
CD=47.31'

NORTH EDGE OF JENKS LEVEE

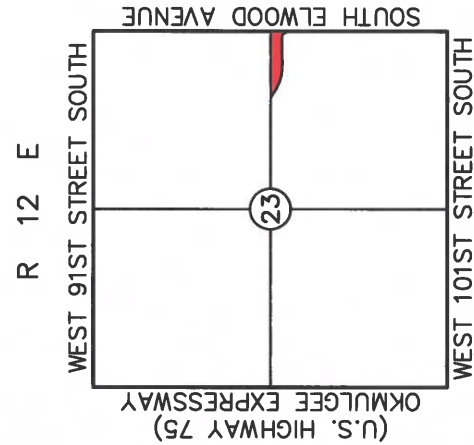

Not to Scale

NE CORNER  
NE/4 SE/4  
SECTION 23  
POINT OF BEGINNING

EAST LINE SECTION 23  
266.06' S 0°58'18" E  
South Elwood Avenue

N 27°41'47" W  
83.00'



**Sisemore Welsz & Associates, Inc.**

6111 EAST 32nd PLACE  
TULSA, OKLAHOMA 74135  
C.A. NO. 2421  
W.O. NO. 18248  
PHONE (918) 685-9800  
FAX (918) 685-8888  
EXP. DATE 8/30/19  
FILE NO. 19122300

**Location Map**  
NOT TO SCALE

## Parcel Map Check Report

Segment# 1: Line

Course: S0° 58' 18"E

Length: 266.06'

Segment# 2: Line

Course: N27° 41' 47"W

Length: 83.00'

Segment# 3: Curve

Length: 49.81'

Radius: 45.00'

Delta: 63.4246 (d)

Tangent: 27.81'

Chord: 47.31'

Course: N59° 24' 32"W

Course In: S62° 18' 13"W

Course Out: N1° 07' 16"W

Segment# 4: Line

Course: S88° 52' 44"W

Length: 245.76'

Segment# 5: Line

Course: S84° 51' 22"W

Length: 70.01'

Segment# 6: Line

Course: S88° 59' 55"W

Length: 168.61'

Segment# 7: Curve

Length: 304.04'

Radius: 525.00'

Delta: 33.1813 (d)

Tangent: 156.42'

Chord: 299.81'

Course: N74° 24' 38"W

Course In: N1° 00' 05"W

Course Out: S32° 10' 48"W

Segment# 8: Line

Course: N57° 49' 12"W

Length: 158.66'

Segment# 9: Line

Course: N88° 59' 02"E

Length: 982.04'

Perimeter: 2,327.99'

Area: 145,093.57 Sq. Ft.

Error Closure: 0.0011

Course: S69° 39' 39"E

Error North : -0.00037

East: 0.00099

Precision 1: 2,116,351.818