



NORTHWEST CROSSING - BUILDING 3
9329 HIGHWAY 6 N
HOUSTON, TX 77095

±108,186 SF
Sublease Available



SITE FEATURES

TOTAL:

±108,186 SF

OFFICE:

±6,357 SF

SPRINKLER SYSTEM:

ESFR

BUILDING DEPTH:

205'

CLEAR HEIGHT:

32'

COLUMN SPACING:

52' x 50'

LOADING DOCKS:

23 dock-high loading doors

OVERHEAD DOORS:

(2) 20' x 20' drive-in ramps

PARKING:

±100 -plus 4 ADA

SUBLEASE TERM THROUGH:

December 31, 2026



For Leasing Information, please contact:

Tyler Maner

tmaner@streamrealty.com
M 713.300.0321

Abraham Richardson

abraham.richardson@streamrealty.com
M 713.300.0329





NORTHWEST CROSSING - BUILDING 3
9329 HIGHWAY 6 N
HOUSTON, TX 77095

±108,186 SF
Sublease Available

SITE PLAN

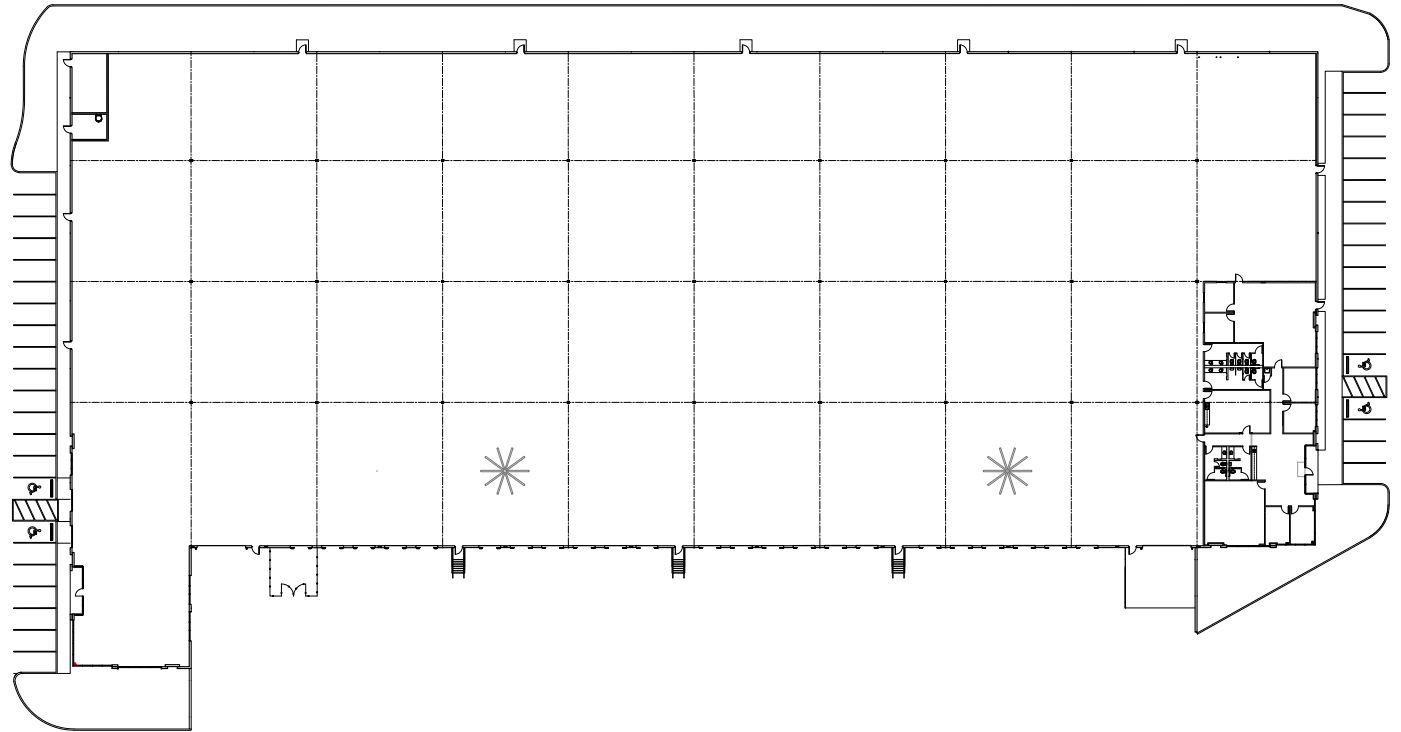

For Leasing Information, please contact:

Tyler Maner
tmaner@streamrealty.com
M 713.300.0321

Abraham Richardson
abraham.richardson@streamrealty.com
M 713.300.0329

STREAM