



REECE
COMMERCIAL REAL ESTATE
a Berkshire Hathaway Affili



LAND/BUILDING FOR SALE

102 W Lawrence St | Kearney MO 64060

Charles Small

816.407.5224

816.590.5910

charles@reececommercial.com



OVERVIEW

Prime commercial land located on major road in downtown Kearney. Property includes 1.74 acres (+/-) with an existing paved parking lot building with power and water. Property is currently zoned commercial, possible uses could include office, food service and retail. Excellent location for multi-family redevelopment.

HIGHLIGHTS

- Paved Parking Lot
- Office Building with Utilities
- 353 Tax Abatement Eligible
- Downtown Kearney

FOR SALE

\$390,000

1.74 Acres

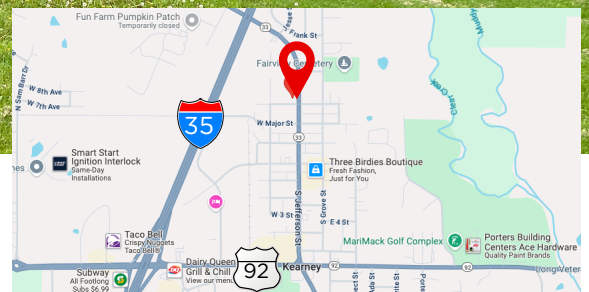
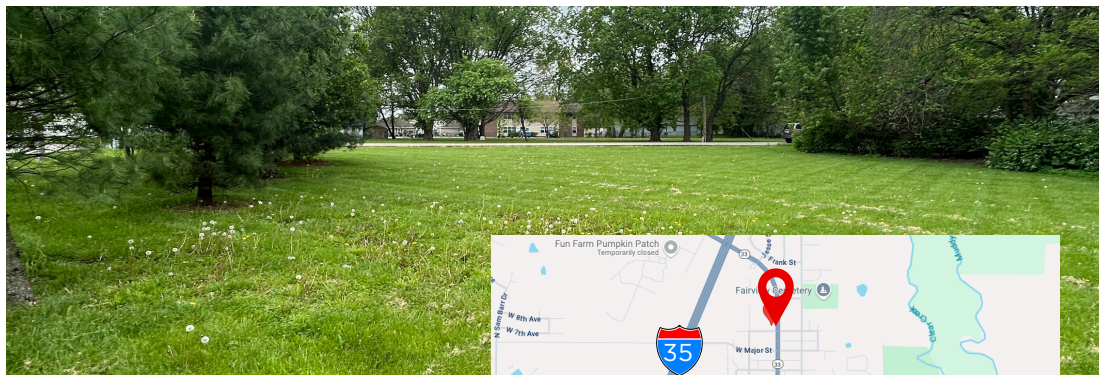



102 W Lawrence St
Kearney MO 64060

Building Exterior



Building Interior



Parking Lot & Land

