

Daytime Population
56,682

Year	Rooms
2017	450
2018	175
2019	140
2020	300

Residential Recent Future	
Year	Units
2013	68
2014	415
2015	26
2016	73
2017	334
2018	169
2019	951
2020	962
2021	1358
2022	

Available

- Ste#105 – 4,891 SF
- Ste#260 – 5,375 SF – Restaurant
- Ste#305 – 2,908 SF

Info

- In the heart of Boise's entertainment district.
- Great daytime to nighttime & after-hours crowds.
- Within walking distance to downtown business core & BSU.
- JUST LEASED – Ste#250 – 4,889 SF Restaurant +330 SF Patio – New concept coming soon.

Demographics 2023

Population	
1 Mile Radius	14,291
5 Mile Radius	166,808
10 Mile Radius	394,274
Total Daytime Population	
1 Mile Radius	36,678
Median Household Income	
1 Mile Radius	\$55,617
5 Mile Radius	\$83,138
10 Mile Radius	\$93,988

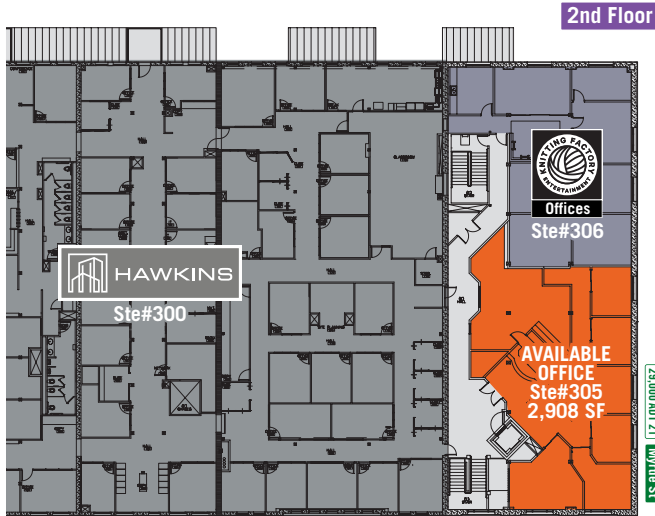

Ste#305 – 2,908 SF



Ste#260 – 5,375 SF – Restaurant

Ste#105 – 4,891 SF

