



Colliers

6985 Garden Road, West Palm Beach, FL 33404

Secure West Palm Beach Office Space with Ample Work Truck Parking

Now available for lease — ±5,078 SF of office space in a freestanding building located in the heart of West Palm Beach. Situated on just over an acre, the property includes a secure fenced yard and 20 dedicated parking spaces for work trucks. With direct access to I-95, the Port of Palm Beach, Palm Beach International Airport, and the Mangonia Tri-Rail Station, the site provides unmatched connectivity in a highly strategic location.



Prime Location
& Accessibility



Multi-Use
Facility

Scott Weprin

Executive Vice President
+1 561 239 9386
scott.weprin@colliers.com

Robert Dabrowski

Senior Associate
+1 561 722 8477
robert.dabrowski@colliers.com

Colliers

901 Northpoint Parkway, Suite 109
West Palm Beach, FL 33407
+1 561 478 6400



Salient Facts

Lot Size

1.0 Acres

Availability

5,078 SF

Building Size

13,339 SF

Grade Level Doors

1

Ceiling Height

17'

Year Built

1974

Zoning

Light Industrial

Fenced

Yes

Parking

20 Work Truck Spaces

Opportunity

Now available for lease — ±5,078 SF of office space in a prime West Palm Beach location. With a secure fenced yard, ample office and staging space, and a dedicated warehouse area with a 10' x 15' roll-up door, the property is designed for efficiency and functionality. Positioned along Garden Road with excellent visibility and direct connectivity to major transportation hubs, this is an ideal opportunity for businesses looking to expand or relocate with convenience and accessibility.



Riviera Beach

Riviera Beach, Florida, is a quintessential coastal paradise boasting pristine beaches, inviting waters, and a vibrant maritime culture. Along its Atlantic coast stretch, sun-seekers and water enthusiasts are drawn to its sandy shores for serene relaxation or thrilling water sports adventures. Beyond the coastline, Riviera Beach embraces a diverse community and rich cultural heritage, highlighted by the bustling Marina Village district and tranquil parks, offering a harmonious blend of lively activity and serene retreats.

As Riviera Beach evolves with ongoing revitalization efforts, it remains a beacon of opportunity on Florida's southeastern coast. Positioned as a gateway to the wider Palm Beaches region, it seamlessly combines upscale amenities, cultural attractions, and urban delights while retaining its distinct coastal charm. In essence, Riviera Beach encapsulates the essence of the Florida experience, where sun, sea, and culture converge to create an irresistible coastal haven.

Floor Plan

5,078 SF

Office Space

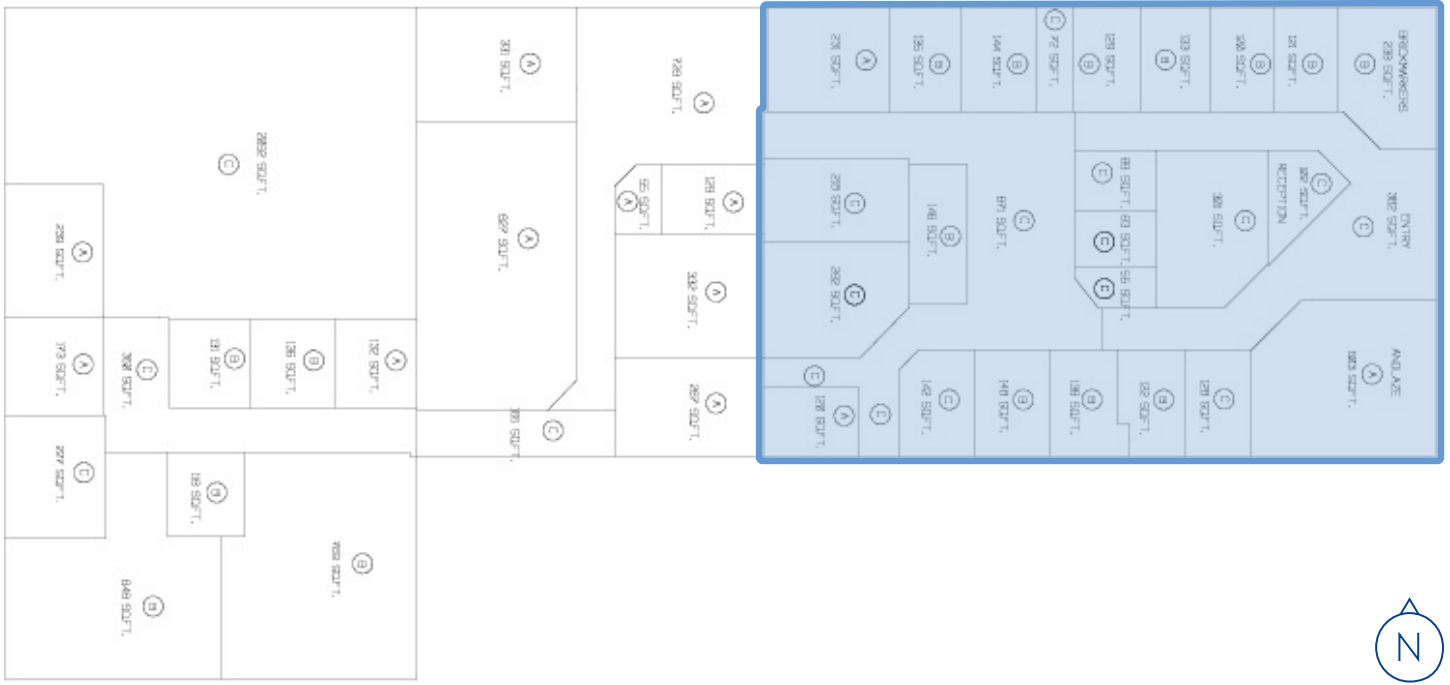



6985 Garden Road, West Palm Beach, FL 33404

Scott Weprin

Executive Vice President
+1 561 239 9386
scott.weprin@colliers.com

Robert Dabrowski

Senior Associate
+1 561 722 8477
robert.dabrowski@colliers.com

This document has been prepared by Colliers for advertising and general information only. Colliers makes no guarantees, representations or warranties of any kind, expressed or implied, regarding the information including, but not limited to, warranties of content, accuracy and reliability. Any interested party should undertake their own inquiries as to the accuracy of the information. Colliers excludes unequivocally all inferred or implied terms, conditions and warranties arising out of this document and excludes all liability for loss and damages arising there from. This publication is the copyrighted property of Colliers and/or its licensor(s). Copyright © 2025. All rights reserved. This communication is not intended to cause or induce breach of an existing listing agreement. Colliers International Florida, LLC.



colliers.com