

SHOPPES

WESTLAKE VILLAGE



JAY LUCHS
GAVIN KETCHUM

Executive Vice Chairman
Director

310-407-6585
310-407-6593

jay.luchs@nmrk.com
gavin.ketchum@nmrk.com

CA RE Lic. #01260345
CA RE Lic. #01929170

JAYLUCHS.COM
NEWMARK
PACIFIC

SHOPPES

WESTLAKE VILLAGE

The Shoppes at Westlake Village is a premier shopping destination in the heart of Westlake Village, anchored by a ±240,000-square-foot Target and complemented by over ±100,000 square feet of upscale retail and dining options. Ideally situated on Russell Ranch Road, the center offers exceptional visibility and accessibility from the 101 Freeway, which sees an impressive daily traffic count of approximately 171,000 vehicles. Positioned near one of Los Angeles County's busiest Costcos and the prestigious Four Seasons Hotel Westlake Village, this vibrant hub is a top choice for shopping, dining, and leisure.



JAY LUCHS

Executive Vice Chairman

310-407-6585

jay.luchs@nrmk.com

CA RE Lic. #01260345

GAVIN KETCHUM

Director

310-407-6593

gavin.ketchum@nrmk.com

CA RE Lic. #01929170

JAYLUCHS.COM
NEWMARK
PACIFIC



TENANTS



COMING SOON



JAY LUCHS
GAVIN KETCHUM

Executive Vice Chairman
Director

310-407-6585
310-407-6593

jay.luchs@nrmk.com
gavin.ketchum@nrmk.com

CA RE Lic. #01260345
CA RE Lic. #01929170

JAYLUCHS.COM
NEWMARK
PACIFIC

PRINCE STREET PIZZA NOW OPEN!

Prince Street Pizza is a renowned pizzeria located in the heart of New York City, celebrated for its iconic Sicilian-style, thick-crust pizzas. Established in Nolita, Manhattan, the eatery has

gained a loyal following for its signature spicy pepperoni “SoHo Square” slice, known for its crispy-yet-chewy crust and robust, zesty tomato sauce topped with curled, cup-like pepperoni slices. The pizzeria is popular with both locals and visitors, often drawing crowds for its late-night slices and authentic New York atmosphere. Praised for using high-quality ingredients and staying true to traditional pizza-making techniques, Prince Street Pizza is considered a must-visit destination for pizza enthusiasts seeking a classic NYC experience. Prince Street Pizza expanded its footprint by opening a new location in Westlake Village, bringing its famous slices and signature flavors to a broader audience on the West Coast.

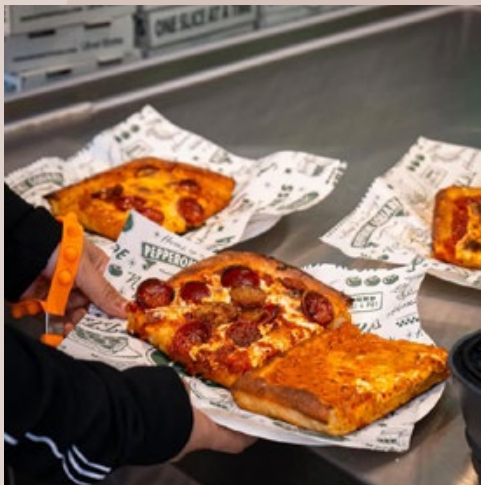

JAY LUCHS
GAVIN KETCHUM

Executive Vice Chairman
Director

310-407-6585
310-407-6593

jay.luchs@nrmk.com
gavin.ketchum@nrmk.com

CA RE Lic. #01260345
CA RE Lic. #01929170

JAYLUCHS.COM
NEWMARK
PACIFIC



ADDRESS

30768 Russell Ranch Road,
Building G, Suite B
Westlake Village, CA 91362

USE

Retail | Service

SIZE

±1,724 SF

RENT

Available upon Request

FORMER TENANT

Amazing Lash

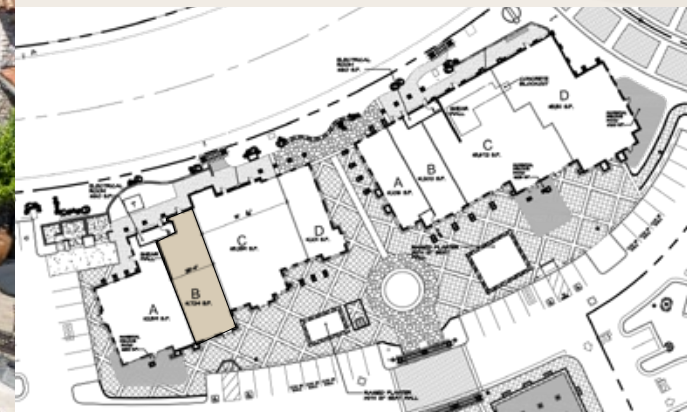

JAY LUCHS

GAVIN KETCHUM

Executive Vice Chairman

Director

310-407-6585

310-407-6593

jay.luchs@nrmk.com

gavin.ketchum@nrmk.com

CA RE Lic. #01260345

CA RE Lic. #01929170

JAYLUCHS.COM

NEWMARK
PACIFIC

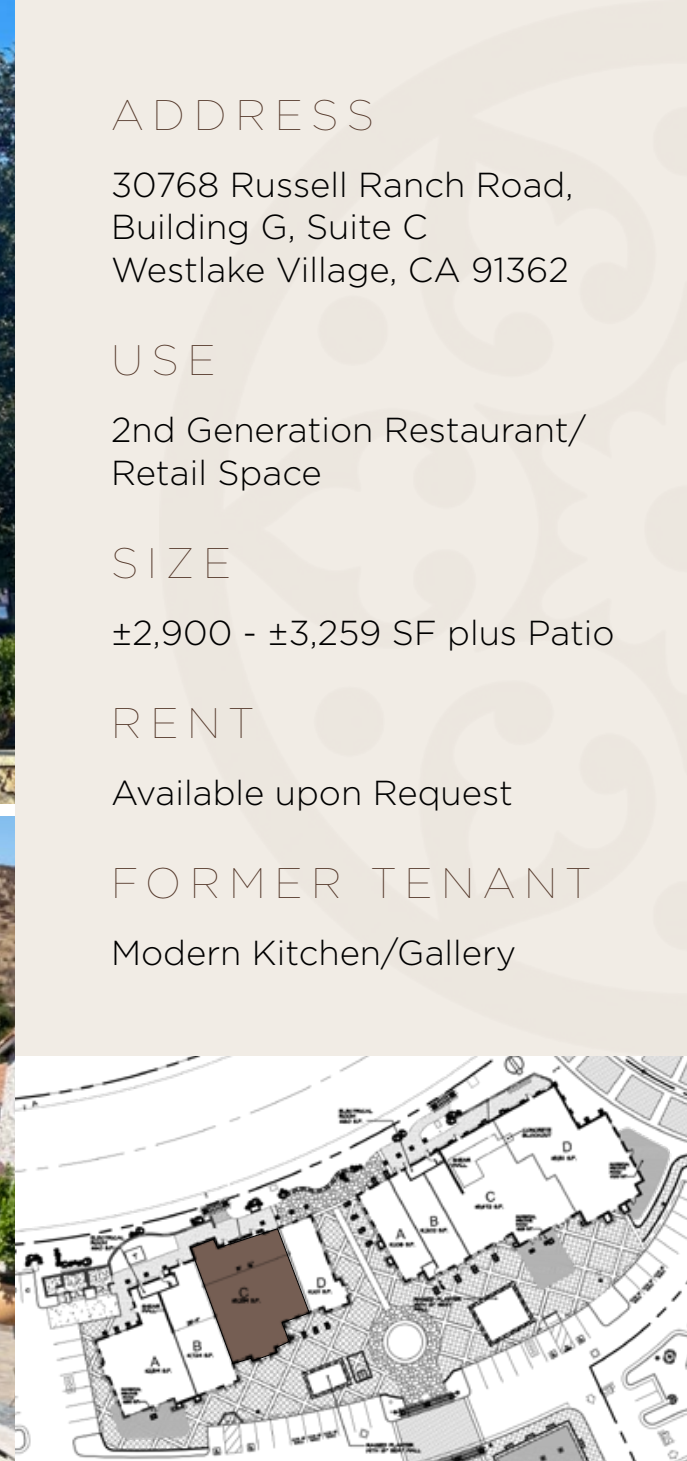
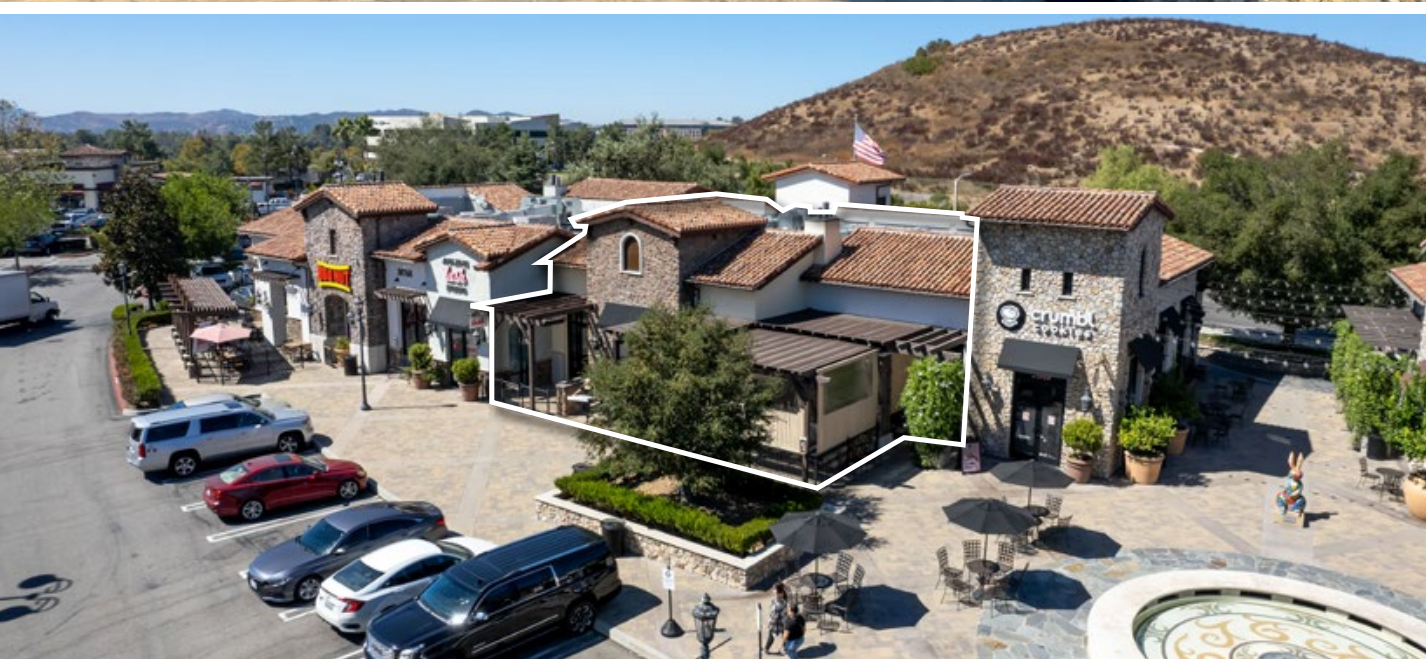

ADDRESS

30768 Russell Ranch Road,
Building G, Suite C
Westlake Village, CA 91362

USE

2nd Generation Restaurant/
Retail Space

SIZE

±2,900 - ±3,259 SF plus Patio

RENT

Available upon Request

FORMER TENANT

Modern Kitchen/Gallery

JAY LUCHS
GAVIN KETCHUM

Executive Vice Chairman
Director

310-407-6585
310-407-6593

jay.luchs@nrmk.com
gavin.ketchum@nrmk.com

CA RE Lic. #01260345
CA RE Lic. #01929170

JAYLUCHS.COM
NEWMARK
PACIFIC



ADDRESS

30760 Russell Ranch Road
Building F, Suite C
Westlake Village, CA 91362

USE

2nd Generation Restaurant/
Retail Space

SIZE

±3,672 SF plus Patio

RENT

Available upon Request

FORMER TENANT

Bamboo Room

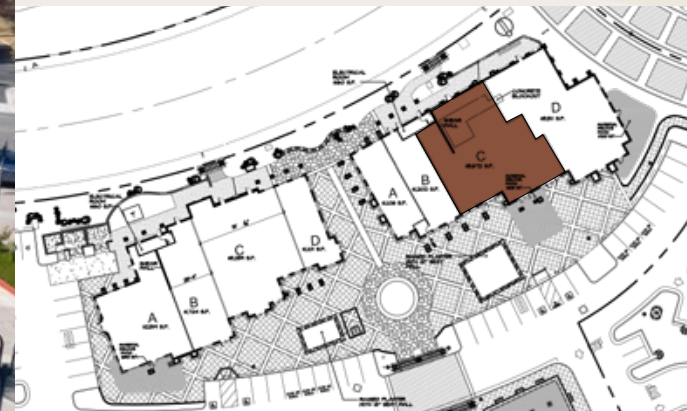

JAY LUCHS
GAVIN KETCHUM

Executive Vice Chairman
Director

310-407-6585
310-407-6593

jay.luchs@nrmk.com
gavin.ketchum@nrmk.com

CA RE Lic. #01260345
CA RE Lic. #01929170

JAYLUCHS.COM
NEWMARK
PACIFIC



ADDRESS

30750 Russell Ranch Road
Building C, Suite D
Westlake Village, CA 91362

USE

2nd Generation Salon Space

SIZE

±1,462 SF

RENT

Available upon Request

FORMER TENANT

The Cove at Lighthouse

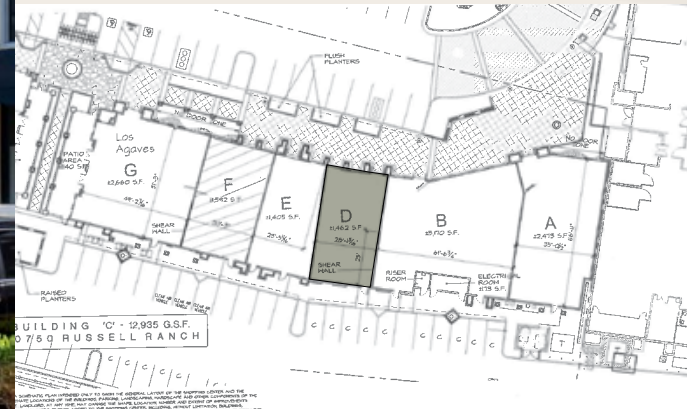

JAY LUCHS

GAVIN KETCHUM

Executive Vice Chairman

Director

310-407-6585

310-407-6593

jay.luchs@nrmk.com

gavin.ketchum@nrmk.com

CA RE Lic. #01260345

CA RE Lic. #01929170

JAYLUCHS.COM

NEWMARK
PACIFIC



ADDRESS

30730 Russell Ranch Road,
Building B, Suite H
Westlake Village, CA 91362

USE

Retail

SIZE

±9,066 SF

RENT

Available upon Request

AVAILABLE

June 1, 2026



JAY LUCHS

GAVIN KETCHUM

Executive Vice Chairman

Director

310-407-6585

310-407-6593

jay.luchs@nrmk.com

gavin.ketchum@nrmk.com

CA RE Lic. #01260345

CA RE Lic. #01929170

JAYLUCHS.COM

NEWMARK
PACIFIC

SITE PLAN

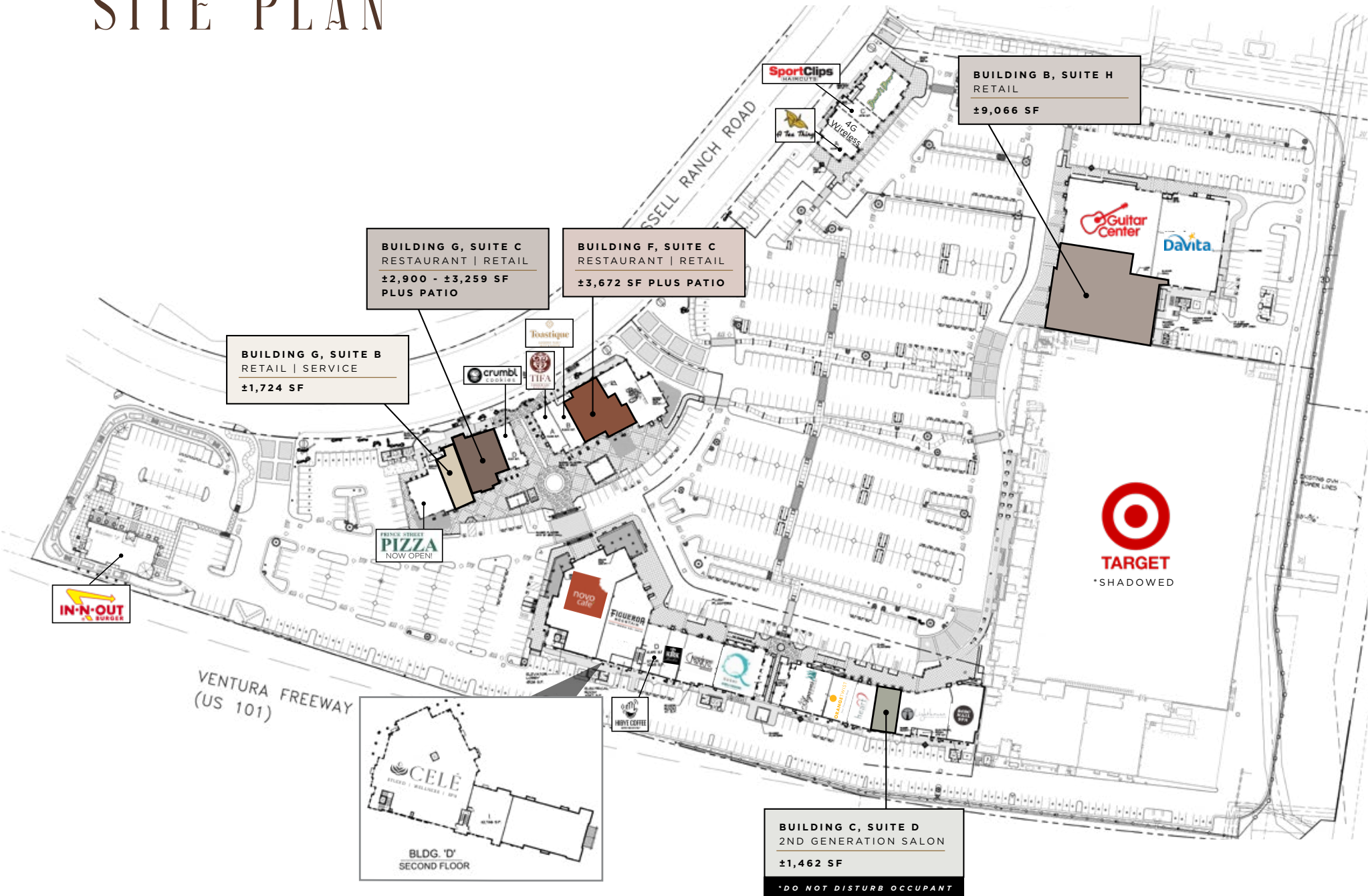

JAY LUCHS
GAVIN KETCHUM

Executive Vice Chairman
Director

310-407-6585
310-407-6593

jay.luchs@nrmk.com
gavin.ketchum@nrmk.com

CA RE Lic. #01260345
CA RE Lic. #01929170

JAYLUCHS.COM
NEWMARK
PACIFIC

DEMOGRAPHICS

TOTAL POPULATION

5,537

1 MILE

46,365

3 MILES

83,537

5 MILES

TOTAL DAYTIME POPULATION

19,832

1 MILE

82,877

3 MILES

118,972

5 MILES

HOUSEHOLDS

2,158

1 MILE

18,410

3 MILES

32,809

5 MILES

AVERAGE HOUSEHOLD INCOME

\$227,670

1 MILE

\$221,682

3 MILES

\$212,089

5 MILES

AVERAGE HOME VALUE

\$1,174,323

1 MILE

\$1,239,887

3 MILES

\$1,262,393

5 MILES

MEDIAN AGE

46.7

1 MILE

48.1

3 MILES

46.3

5 MILES

Demographics: Esri 2024
Visitor Report: Placer.ai 2025

JAY LUCHS

Executive Vice Chairman

310-407-6585

jay.luchs@nmrk.com

CA RE Lic. #01260345

GAVIN KETCHUM

Director

310-407-6593

gavin.ketchum@nmrk.com

CA RE Lic. #01929170

JAYLUCHS.COM
NEWMARK
PACIFIC



MAP



Traffic Count: TrafficMetrix, Costar 2025

JAY LUCHS

Executive Vice Chairman

310-407-6585

jay.luchs@nrmk.com

CA RE Lic. #01260345

GAVIN KETCHUM

Director

310-407-6593

gavin.ketchum@nrmk.com

CA RE Lic. #01929170

JAYLUCHS.COM
NEWMARK
PACIFIC



SHOPPES

WESTLAKE VILLAGE

Corporate RE Lic. #01796698

The information contained herein has been obtained from sources deemed reliable but has not been verified and no guarantee, warranty or representation, either express or implied, is made with respect to such information. Terms of sale or lease and availability are subject to change or withdrawal without notice.

JAY LUCHS

Executive Vice Chairman

310-407-6585

jay.luchs@nrmk.com

CA RE Lic. #01260345

GAVIN KETCHUM

Director

310-407-6593

gavin.ketchum@nrmk.com

CA RE Lic. #01929170

JAYLUCHS.COM
NEWMARK
PACIFIC