

For Sublease  
4,000 SF

# 12551 Jefferson Avenue

Newport News, Virginia 23602

Buff City Soap, Jefferson Commons

**CBRE**





# Overview

Jefferson Commons is a prominent regional power center located in the Patrick Henry retail corridor of Newport News. Spanning around 282,357 square feet, it features key anchors such as Kohl's, Trader Joe's, Total Wine, Old Navy, TJ Maxx, Ross, HomeGoods and Petco. The suite available for sublease is currently Buff City Soap.

- Excellent accessibility
- Convenient one-stop shopping
- A diverse selection of goods and services
- Ample and convenient parking available
- Open-air layout providing an improved shopping experience
- New Amtrak transportation center set to open on June 1st, 2025 off Bland Boulevard

## 4,000 SF

Available Space

## \$28.00

Pricing Per Square Foot

## \$6.33

NNN Per Square Foot

## 1.31.2027

Master Lease Expiration

## ±50,000

Jefferson Avenue (ADT)

## ±26,000

Bland Boulevard (ADT)



# Buff City Soap

## Floor Plan

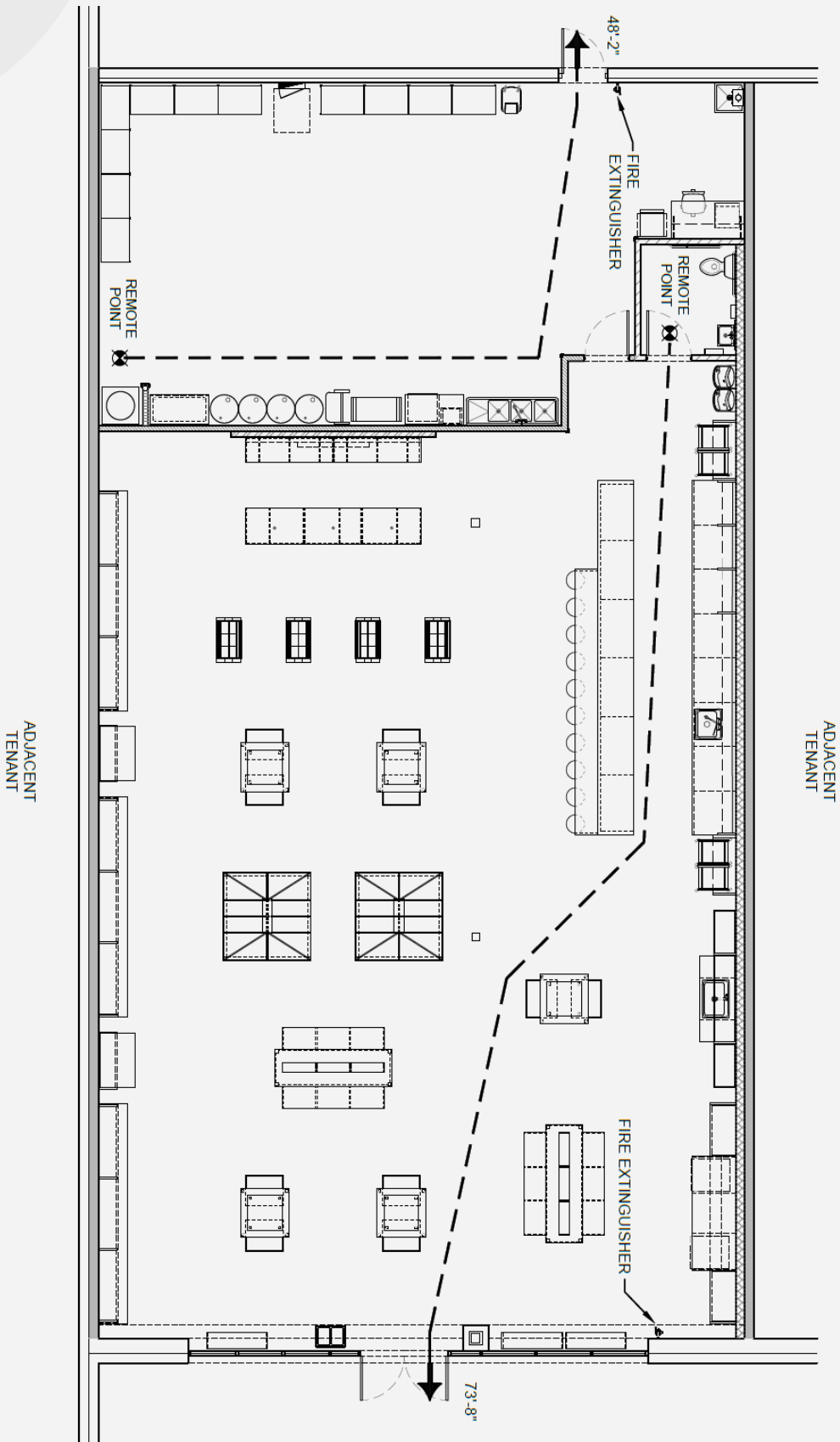



# Demographics

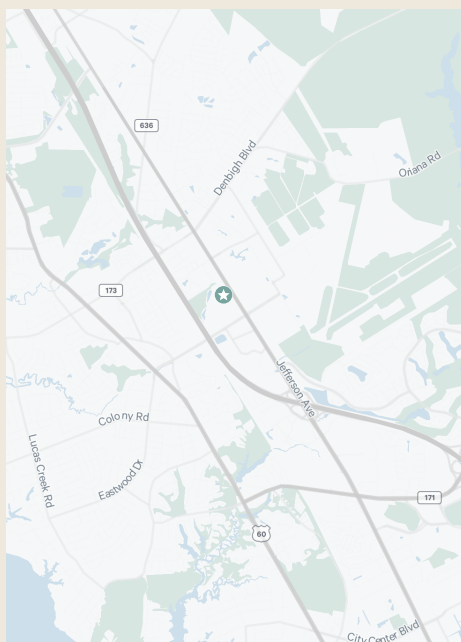
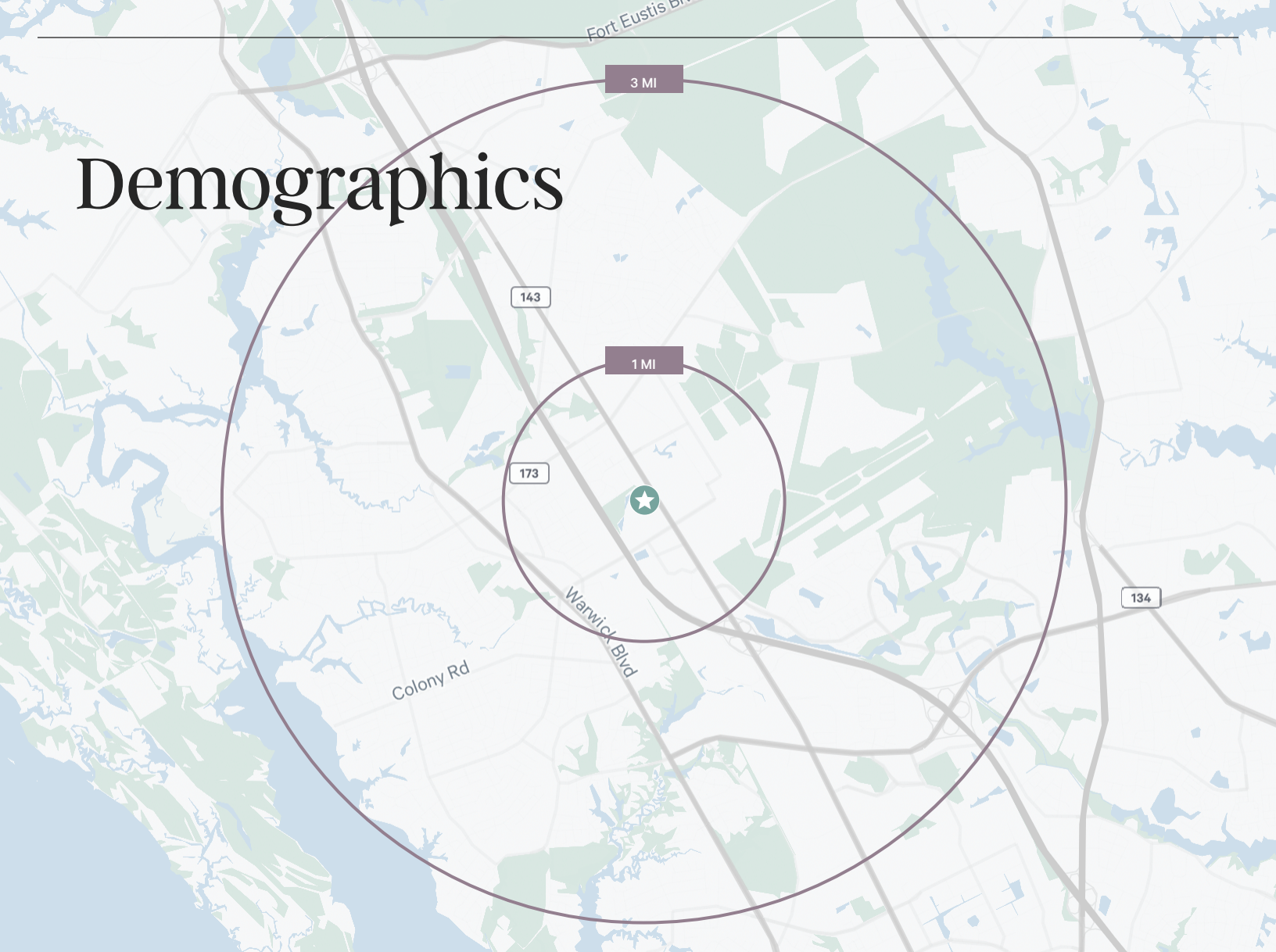

78,355

Population  
( $< 3$  Miles)

68,098

Daytime Population  
( $< 3$  Miles)

32,340

Households  
( $< 3$  Miles)

2,008

Businesses  
( $< 3$  Miles)

\$94,728

Average Household Income  
( $< 3$  Miles)

36.9

Median Age  
( $< 3$  Miles)



# Jefferson Commons

12551 Jefferson Avenue







# 12551 Jefferson Avenue

Pam Strieffler

Vice President

+1 804 201 2026

[pam.strieffler@cbre.com](mailto:pam.strieffler@cbre.com)

Ian Webster

Senior Associate

+1 804 201 2014

[ian.webster@cbre.com](mailto:ian.webster@cbre.com)

© 2025 CBRE, Inc. All rights reserved. This information has been obtained from sources believed reliable but has not been verified for accuracy or completeness. CBRE, Inc. makes no guarantee, representation or warranty and accepts no responsibility or liability as to the accuracy, completeness, or reliability of the information contained herein. You should conduct a careful, independent investigation of the property and verify all information. Any reliance on this information is solely at your own risk. CBRE and the CBRE logo are service marks of CBRE, Inc. All other marks displayed on this document are the property of their respective owners, and the use of such marks does not imply any affiliation with or endorsement of CBRE. Photos herein are the property of their respective owners. Use of these images without the express written consent of the owner is prohibited.

**CBRE**