

Goodman Commerce Center - Long Beach

10.61 Acres Available For Lease

(Adjacent to Brand New 504,810 SF Building Also For Lease)



**2401 E Wardlow Rd
Long Beach**
504,810 SF
Also Available
For Lease

Parcel A:
2200 36th St
Lakewood
± 7.47 Acres

Parcel B:
2131 E Wardlow Rd
Long Beach
± 3.14 Acres

18401 Von Karman Avenue Suite 150
Irvine, CA 92612
Corporate License #01355491

JEFF READ
Executive Managing Director
t 949-608-2029
jeff.read@nrmk.com
CA RE Lic. #01040265

JIM BIONDI
Executive Managing Director
t 310-491-2002
jim.biondi@nrmk.com
CA RE Lic. #00468745

TERRY REITZ
Executive Managing Director
t 310-491-2029
terry.reitz@nrmk.com
CA RE Lic. #00457222

NEWMARK

The information contained herein has been obtained from sources deemed reliable but has not been verified and no guarantee, warranty or representation, either express or implied, is made with respect to such information. Terms of sale or lease and availability are subject to change or withdrawal without notice.

Goodman Commerce Center - Long Beach

Parcel A: 2200 36th St, Lakewood, CA 90712

- ±7.47 Acres Available for Lease
- Contiguous to 3.14 acre site for potential total of 10.61 acres
- Available for storage of containers on chassis or chassis separately
- Immediate Access to 405 Freeway at Cherry Ave
- Close Proximity to Long Beach/LA ports

Parcel B: 2131 E Wardlow Rd, Long Beach, CA 90807

- ±3.14 Acres Available for Lease
- Contiguous to 7.47 acre site for potential total of 10.61 acres
- Available for storage of containers on chassis or chassis separately
- Immediate Access to 405 Freeway at Cherry Ave
- Close Proximity to Long Beach/LA ports

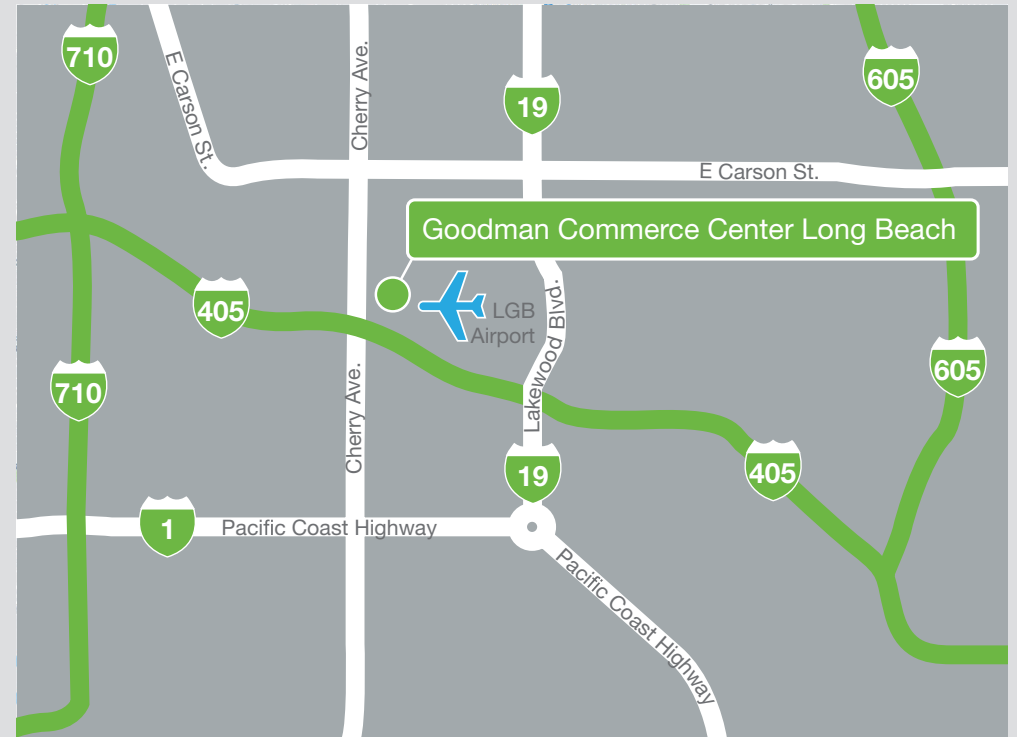

10.61 acres

18401 Von Karman Avenue Suite 150
Irvine, CA 92612
Corporate License #01355491

JEFF READ

Executive Managing Director
t 949-608-2029
jeff.read@nrmk.com
CA RE Lic. #01040265

JIM BIONDI

Executive Managing Director
t 310-491-2002
jim.biondi@nrmk.com
CA RE Lic. #00468745

TERRY REITZ

Executive Managing Director
t 310-491-2029
terry.reitz@nrmk.com
CA RE Lic. #00457222

NEWMARK

The information contained herein has been obtained from sources deemed reliable but has not been verified and no guarantee, warranty or representation, either express or implied, is made with respect to such information. Terms of sale or lease and availability are subject to change or withdrawal without notice.

Goodman Commerce Center - Long Beach

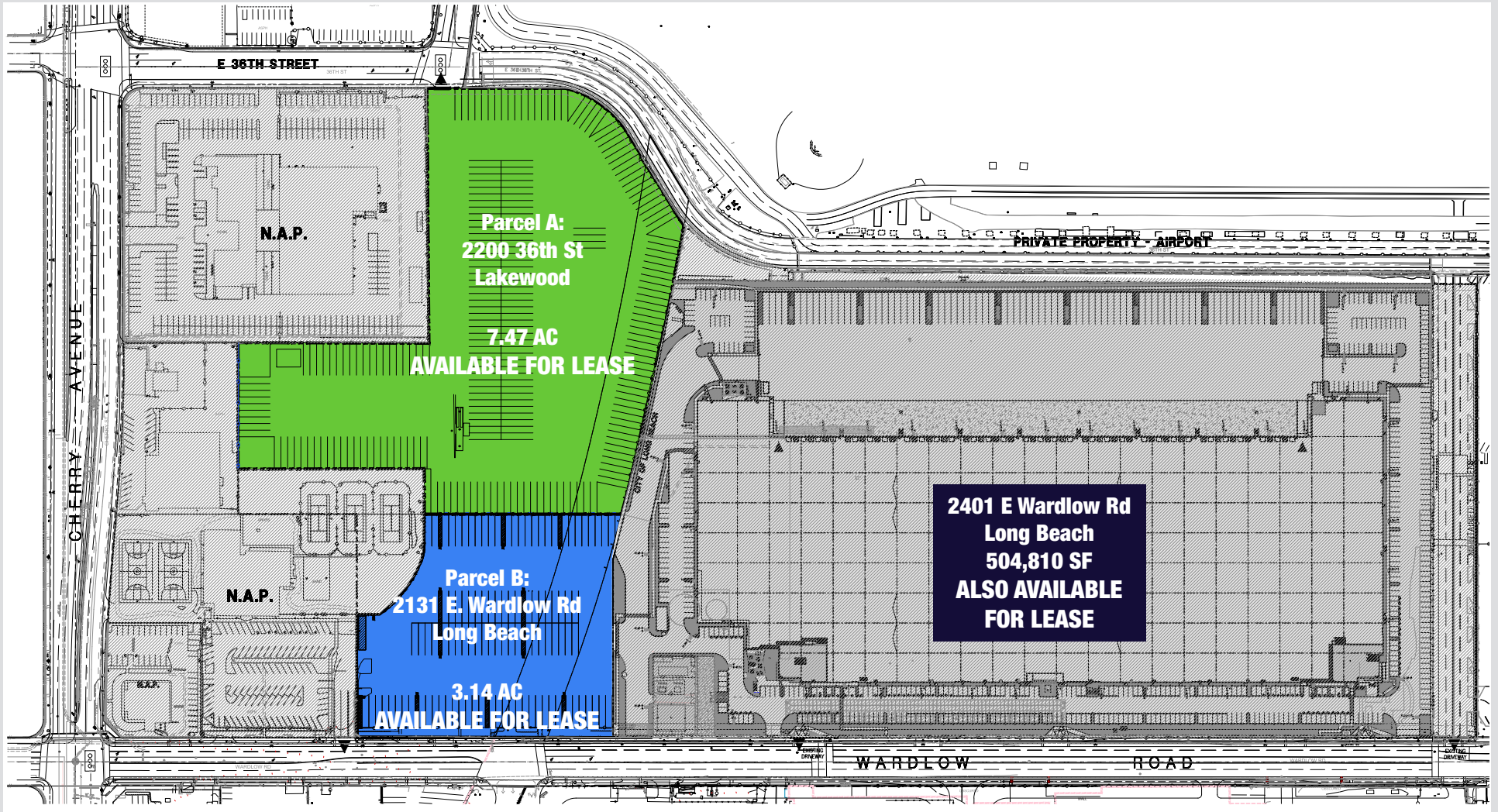

18401 Von Karman Avenue Suite 150
Irvine, CA 92612
Corporate License #01355491

JEFF READ

Executive Managing Director
t 949-608-2029
jeff.read@nrmk.com
CA RE Lic. #01040265

JIM BIONDI

Executive Managing Director
t 310-491-2002
jim.biondi@nrmk.com
CA RE Lic. #00468745

TERRY REITZ

Executive Managing Director
t 310-491-2029
terry.reitz@nrmk.com
CA RE Lic. #00457222

NEWMARK

The information contained herein has been obtained from sources deemed reliable but has not been verified and no guarantee, warranty or representation, either express or implied, is made with respect to such information. Terms of sale or lease and availability are subject to change or withdrawal without notice.