

Multi-tenant Industrial Warehouse in Airport Submarket

7712
Boeing
Drive

Greensboro, NC 27409



Building Overview

- + **Total Building:** ±42,400 SF
- + **Available Space:**
 - Suite C – ±10,000 SF (avail. 01/01/2026)
- + **Dock Doors:** 9 (8' x 10')
- + **Drive-in Door:** 1 (oversized)
- + **Ceiling Height:** 30'
- + **Asking Rate:** \$10.00/SF NNN
- + **Zoning:** Heavy Industrial (HI)
- + **Year Built:** 1979
- + Fenced in truck yard
- + Located in the Airport submarket minutes from I-40 and PTI Airport



7712 Boeing Drive
Greensboro, NC 27409

For Lease

Floor Plan

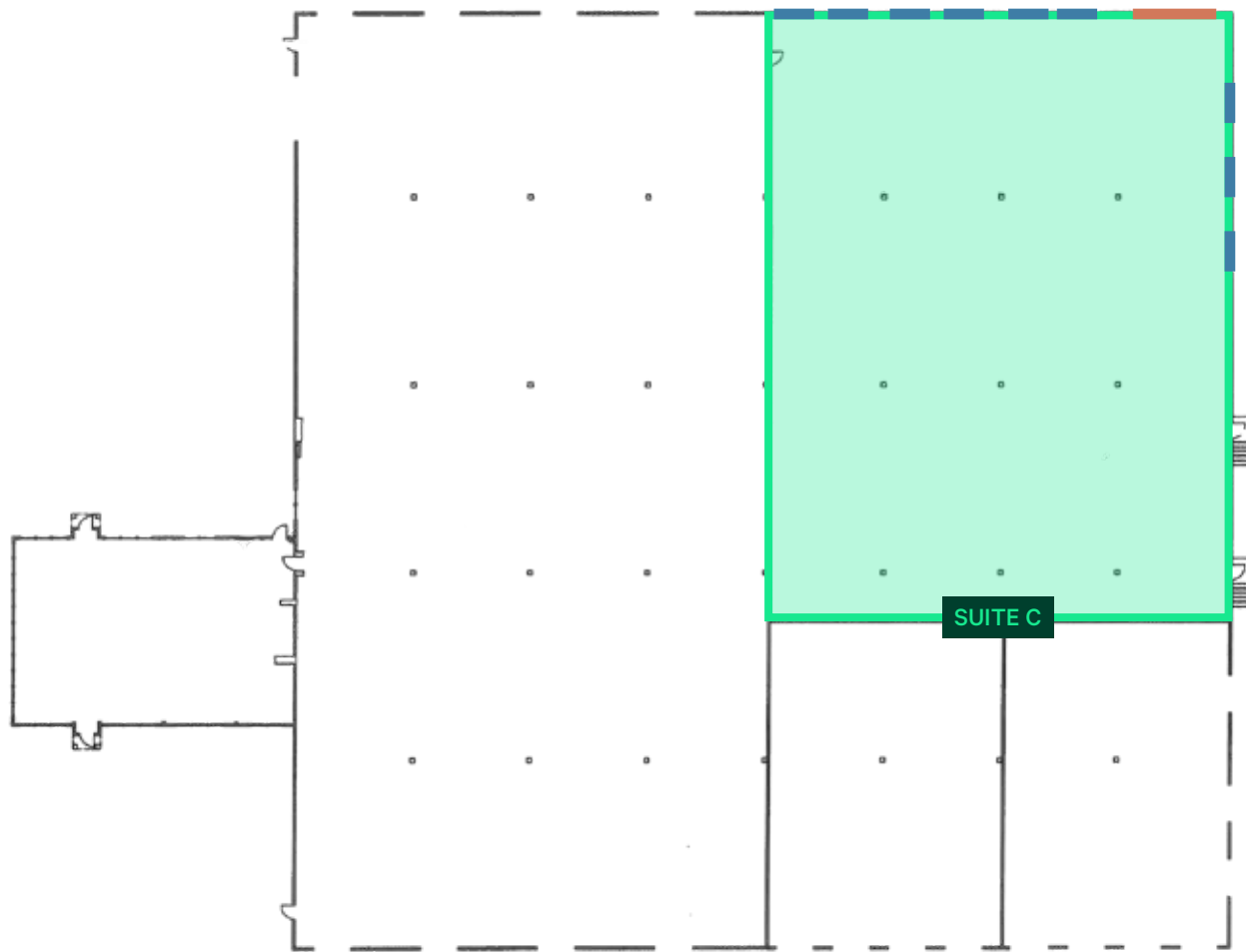

10K

SF Available

30'

Ceiling Height

9

Dock High Doors

1

Dock High Doors

7712 Boeing Drive
Greensboro, NC 27409

For Lease



LOCATION & ACCESSIBILITY	
Interstate 40	<1 Mile
NC Highway 68	<1 Mile
Interstate 840 (GSO Urban Loop)	2.5 Miles
Interstate 73	2.5 Miles
Piedmont Triad Int'l Airport	6.5 Miles
Interstate 74	6.3 Miles
Interstate 85	8.9 Miles

Contact Us

Richard Mossman*

Executive Vice President

+1 336 499 9956

richard.mossman@cbre.com

**It is specifically understood by the parties hereto that Richard Mossman is an employee of CBRE, Inc., a licensed real estate broker, and that he (or someone related by blood or marriage or someone with whom he has a special relationship) has a legal or beneficial interest in the property that is the subject of this transaction.*

© 2025 CBRE, Inc. All rights reserved. This information has been obtained from sources believed reliable, but has not been verified for accuracy or completeness. You should conduct a careful, independent investigation of the property and verify all information. Any reliance on this information is solely at your own risk. CBRE and the CBRE logo are service marks of CBRE, Inc. All other marks displayed on this document are the property of their respective owners, and the use of such logos does not imply any affiliation with or endorsement of CBRE. Photos herein are the property of their respective owners. Use of these images without the express written consent of the owner is prohibited.