



**COLDWELL
BANKER
COMMERCIAL**
BULLARD

FOR LEASE

CBCWORLDWIDE.COM

700 WESTPARK

700 Westpark Drive
Peachtree City, GA 30269

AVAILABLE SPACE
3,049 - 23,241 SF

LEASE RATE
\$19.00 - 22.00 SF/yr (Full Service)

FEATURES

- Full Service Lease
- \$19 - \$22/sf FS

AREA

Centrally located in Peachtree City's premier office park. Easy access to numerous dining, hospitality and shopping alternatives. Thirty minutes to Hartsfield Atlanta International Airport.



OFFICE

Tom Fulton
770 632 1774
tfulton@cbcbullard.net

©2022 Coldwell Banker. All Rights Reserved. Coldwell Banker and the Coldwell Banker Commercial logos are trademarks of Coldwell Banker Real Estate LLC. The Coldwell Banker® System is comprised of company owned offices which are owned by a subsidiary of Realogy Brokerage Group LLC and franchised offices which are independently owned and operated. The Coldwell Banker System fully supports the principles of the Equal Opportunity Act.

**COLDWELL BANKER COMMERCIAL
BULLARD**
201 Prime Point, Peachtree City, GA 30269
770.632.1774



700 WESTPARK

700 Westpark Drive, Peachtree City, GA 30269

LEASE



OFFERING SUMMARY

Available SF:	3,049 - 17,023 SF
Lease Rate:	\$19.00 - 22.00 SF/yr (Full Service)
Lot Size:	8.5 Acres
Year Built:	1999
Building Size:	91,609 SF
Renovated:	2012
Zoning:	C-LUC
Market:	South Atlanta
Submarket:	Fayette/Coweta

CBCWORLDWIDE.COM

Tom Fulton
770 632 1774
tfulton@cdbcbullard.net

PROPERTY OVERVIEW

Three suites available for lease immediately. Approximately 3,049 on L1. Two suites available on L2: 3,169 and 17,023 sf.

PROPERTY HIGHLIGHTS

- Full Service Lease
- \$19 - \$22/sf FS



700 WESTPARK

700 Westpark Drive, Peachtree City, GA 30269

LEASE



CBCWORLDWIDE.COM

Tom Fulton
770 632 1774
tfulton@cdbcbullard.net

 **COLDWELL
BANKER
COMMERCIAL
BULLARD**



700 WESTPARK

700 Westpark Drive, Peachtree City, GA 30269

LEASE

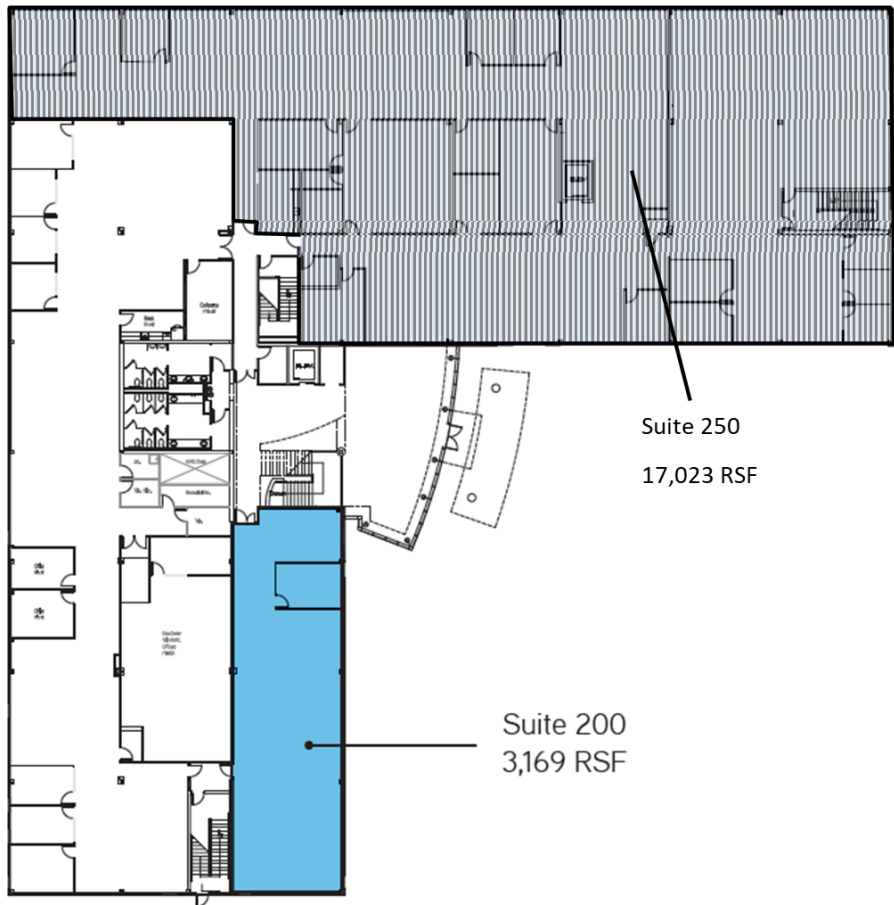

CBCWORLDWIDE.COM

Tom Fulton
770 632 1774
tfulton@cbcbullard.net

 **COLDWELL
BANKER
COMMERCIAL**
BULLARD



700 WESTPARK

700 Westpark Drive, Peachtree City, GA 30269

LEASE

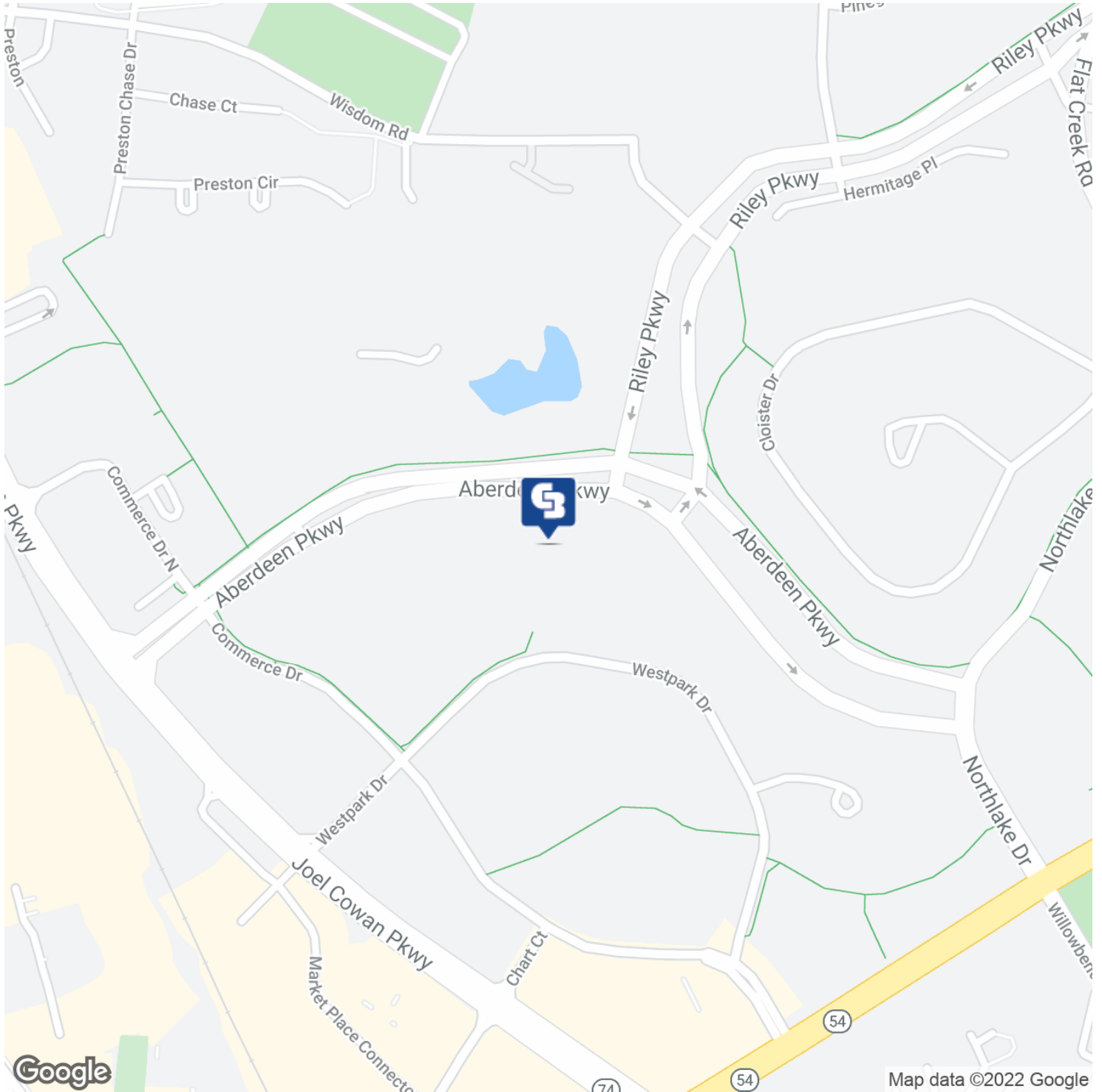

CBCWORLDWIDE.COM

Tom Fulton
770 632 1774
tfulton@cbcbullard.net

 **COLDWELL
BANKER
COMMERCIAL**
BULLARD



700 WESTPARK

700 Westpark Drive, Peachtree City, GA 30269

LEASE



TEXT HEADLINE

Add text here...



TEXT HEADLINE

Add text here...

CBCWORLDWIDE.COM

Tom Fulton
770 632 1774
tfulton@cdbcbullard.net



700 WESTPARK

700 Westpark Drive, Peachtree City, GA 30269

LEASE

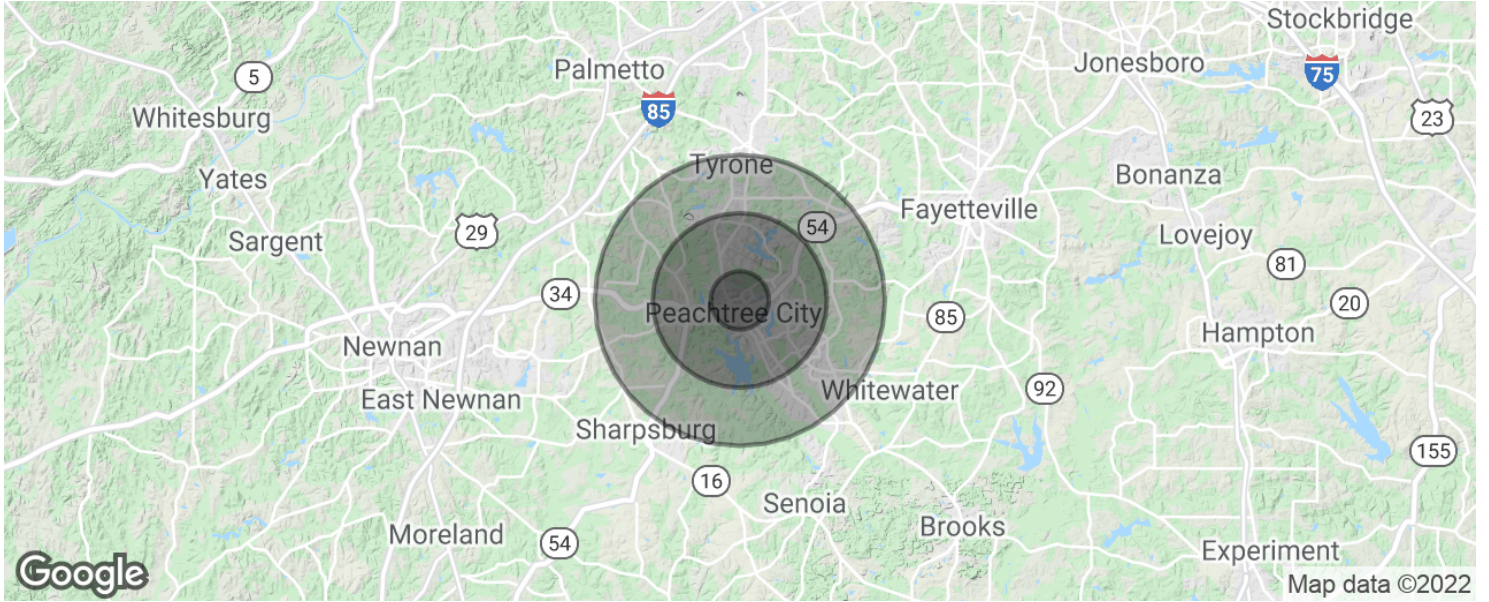

POPULATION

	1 MILE	3 MILES	5 MILES
Total population	3,539	25,319	56,701
Median age	39.1	41.1	40.8
Median age (Male)	38.1	40.4	39.9
Median age (Female)	40.6	41.7	41.4

HOUSEHOLDS & INCOME

	1 MILE	3 MILES	5 MILES
Total households	1,277	9,267	20,491
# of persons per HH	2.8	2.7	2.8
Average HH income	\$106,473	\$107,184	\$103,349
Average house value	\$267,105	\$336,271	\$344,295

* Demographic data derived from 2010 US Census

CBCWORLDWIDE.COM

Tom Fulton
770 632 1774
tfulton@cbbcullard.net

