

Stunning architecture throughout in these expansive spaces located in the highly desirable Railhead District in vibrant downtown Hoboken. Located directly across from the Downtown Hoboken Transit Hub with maximum exposure and foot traffic. Rare opportunity to be located in a Historic Bank Building, offering massive, light filled windows with valuable exterior signage opportunities. 15 Foot Ceilings, HWD Floors and custom work throughout make these spaces truly one of a kind...



Space Size: 1150 RSF FT
Rental Rates: Varies
Space Use:
Commercial Office & Retail

Spectacular Retail & Showroom Space
15' + Ceilings
Expansive Windows & Exterior Signage Opportunities
HWD Floors
Custom Light Fixtures & Moldings - Truly One of a Kind!
Directly Across from Downtown Hoboken Transit HUB & New Redevelopment Zone

SUITE 100



Space Size: 905 RSF FT
Rental Rates: Varies
Space Use:
Commercial Office & Retail

Spectacular Office Space - Custom Work Throughout
15+ Ceilings
Bonus Mezzanine Level
HWD Floors
Custom Built In Bar, Custom Light Fixtures & Moldings - Truly One of a Kind!
Expansive Windows
Directly Across from Downtown Hoboken Transit HUB & New Redevelopment Zone

SUITE 105



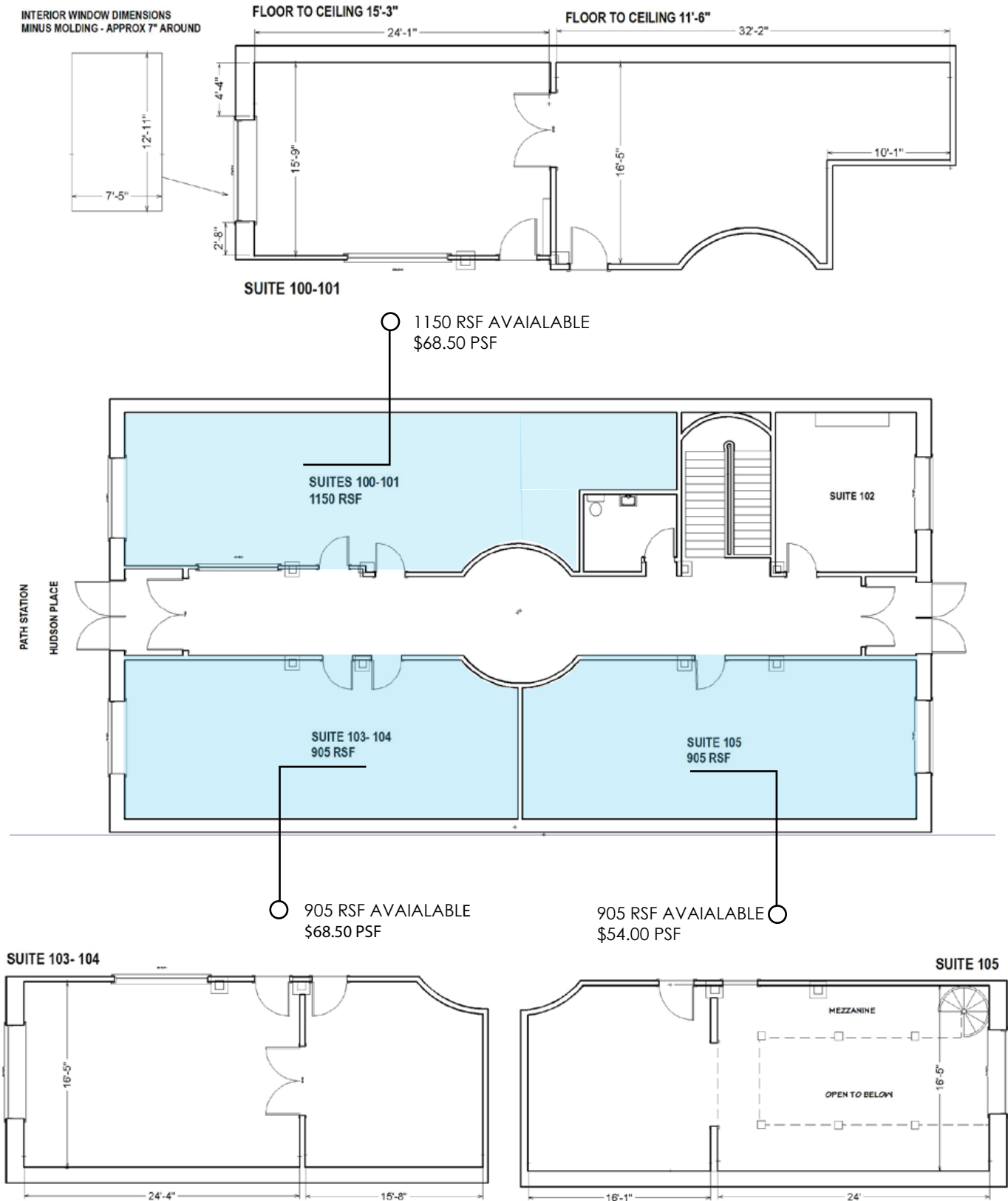

Space Available: 1-2 Private Office Suites
 Floor LL :172 RSF - 345 RSF
 Rental Rate: \$800.00 - \$1700.00
 Type: Modified Gross

Professional Private Office Suites Available - May be leased seperately or combined...
 Perfect for Therapist, Attorney, Accountant, Consultant or any Professional Satellite Office Use.
 Features include CAC, Common Kitchen Area, Common Waiting Area and Beautiful Entry/ Lobby.
 Located in Downtown Hoboken's desirable Railhead District, located directly across from Down-
 town Hoboken Transit Hub. The NJ Transit Redevelopment is transforming the area into a destination
 for shopping, dining and commercial office spaces.

