

EASTWOOD VILLAGE



Eastwood Village is a fully completed mixed use project in the heart of East Nashville, providing a gathering place for the community to shop, dine, live and work.

Hobson United Methodist Church built their first building on this property in 1853. In February of 1862, the federal army occupied Nashville and used the church as a hospital and horse stable. Later, the church was used as a school for boys.

The church expanded through the years with the chapel being constructed in 1868, the main sanctuary facing Greenwood in 1929, and a two-story education building in 1953 to connect the original church and sanctuary.

1700 Greenwood Ave & 1101 Chapel Ave
Nashville, TN 37206



Site Overview

0.5 Mile to
Publix
Starbucks
Orangetheory

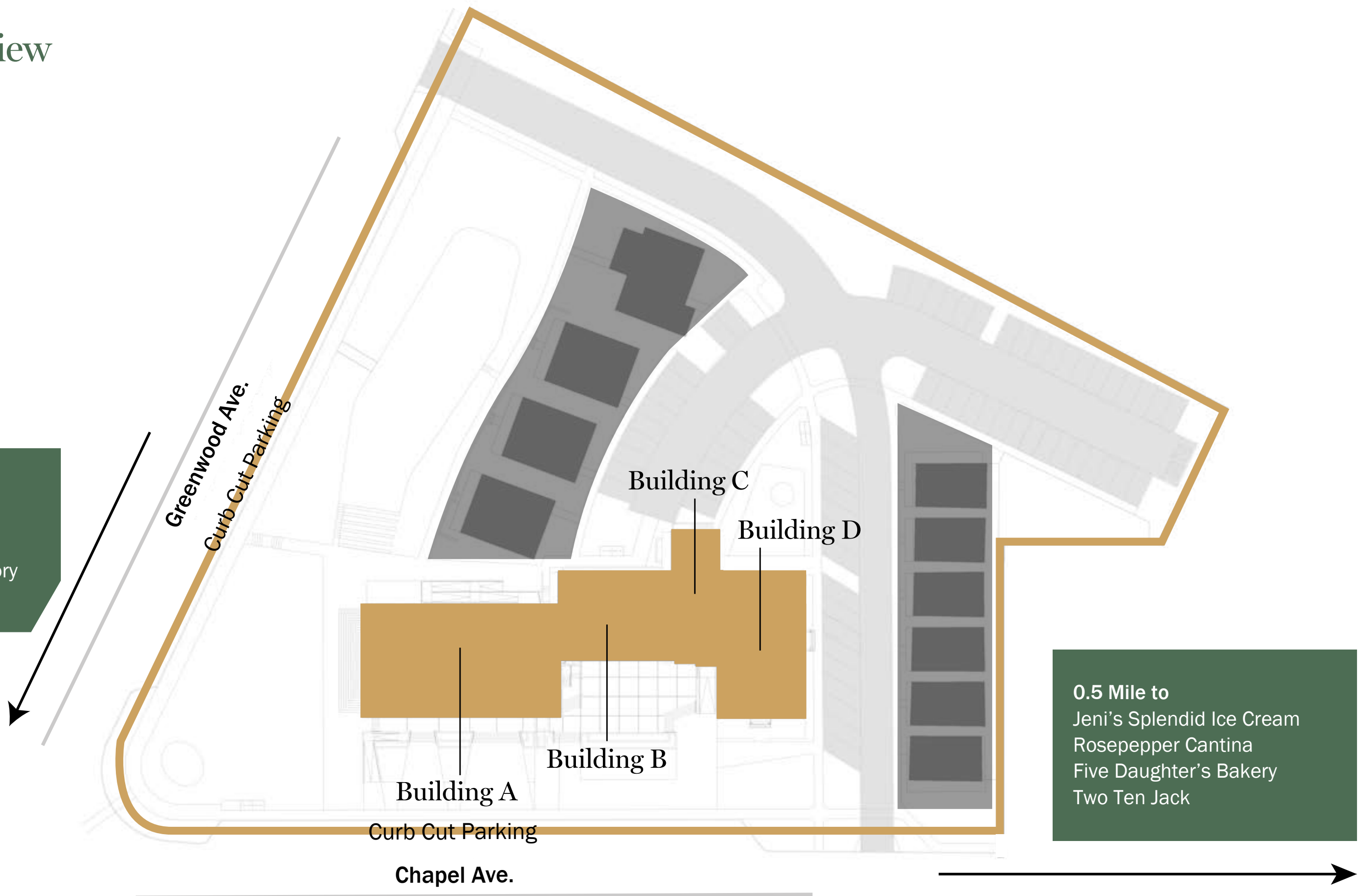

0.5 Mile to
Jeni's Splendid Ice Cream
Rosepepper Cantina
Five Daughter's Bakery
Two Ten Jack



Building Overview



A

B

C

D



Floor Plans

Courtyard Level

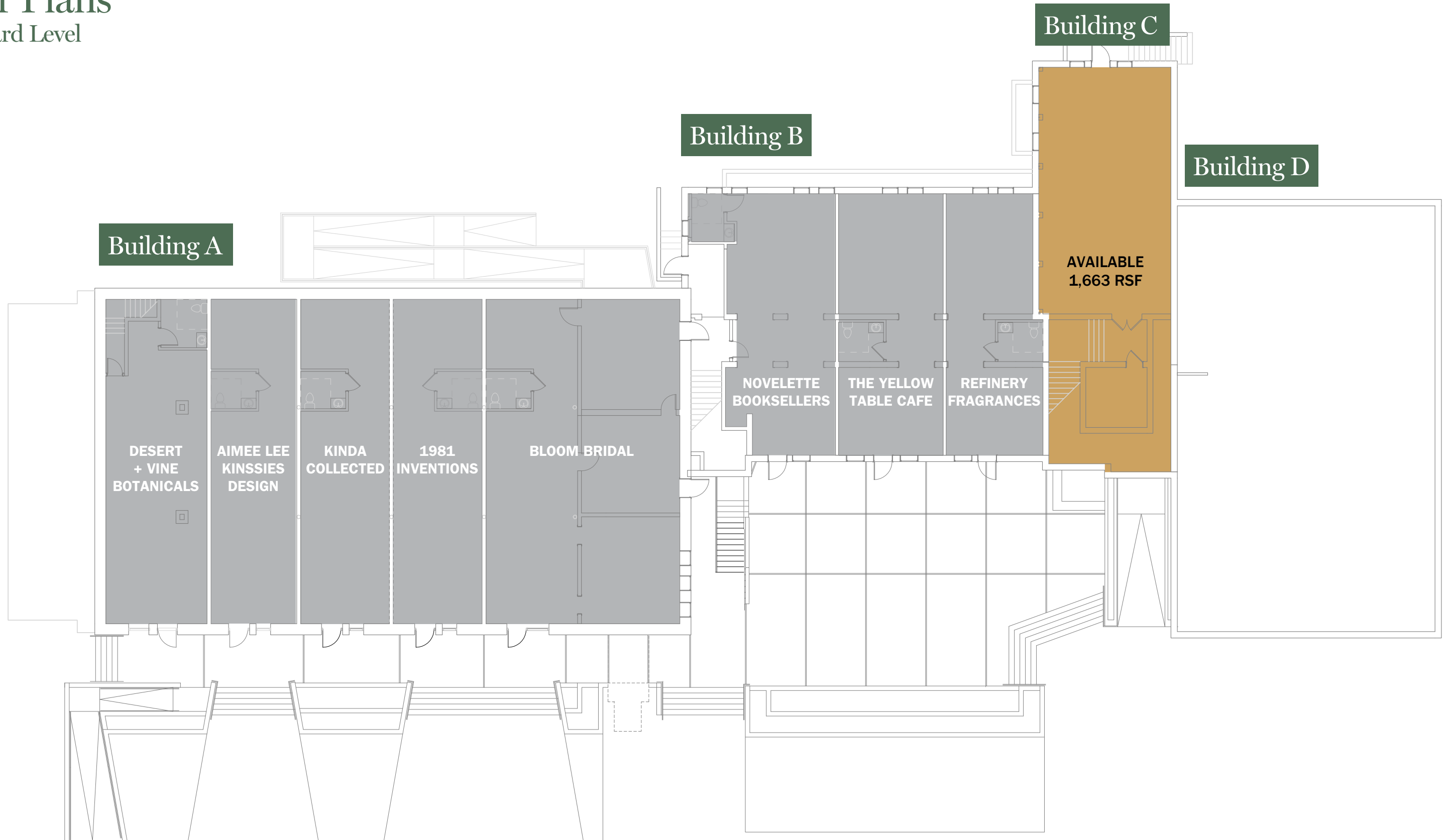

Floor Plans

First Floor

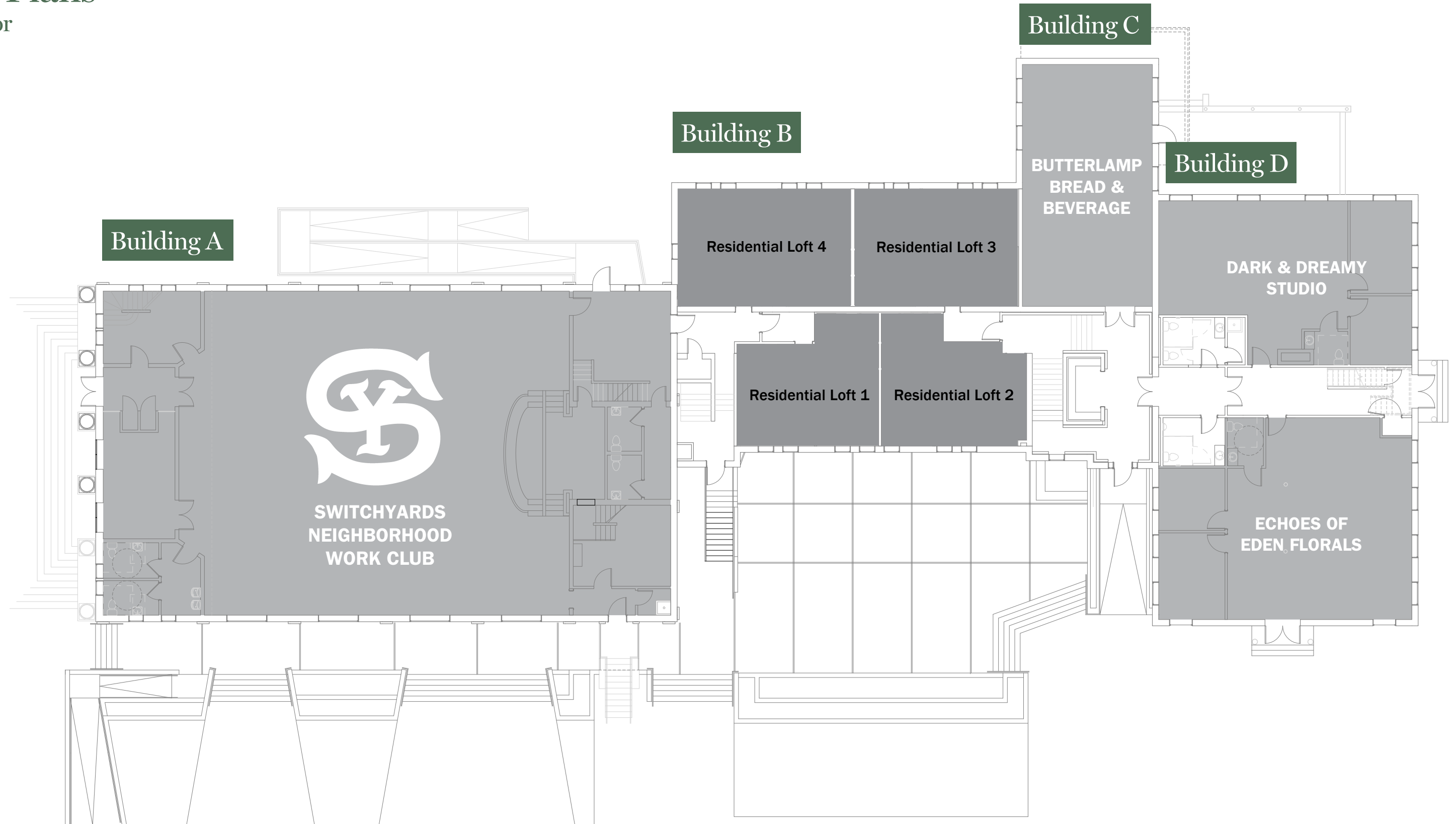

Floor Plans

Second Floor

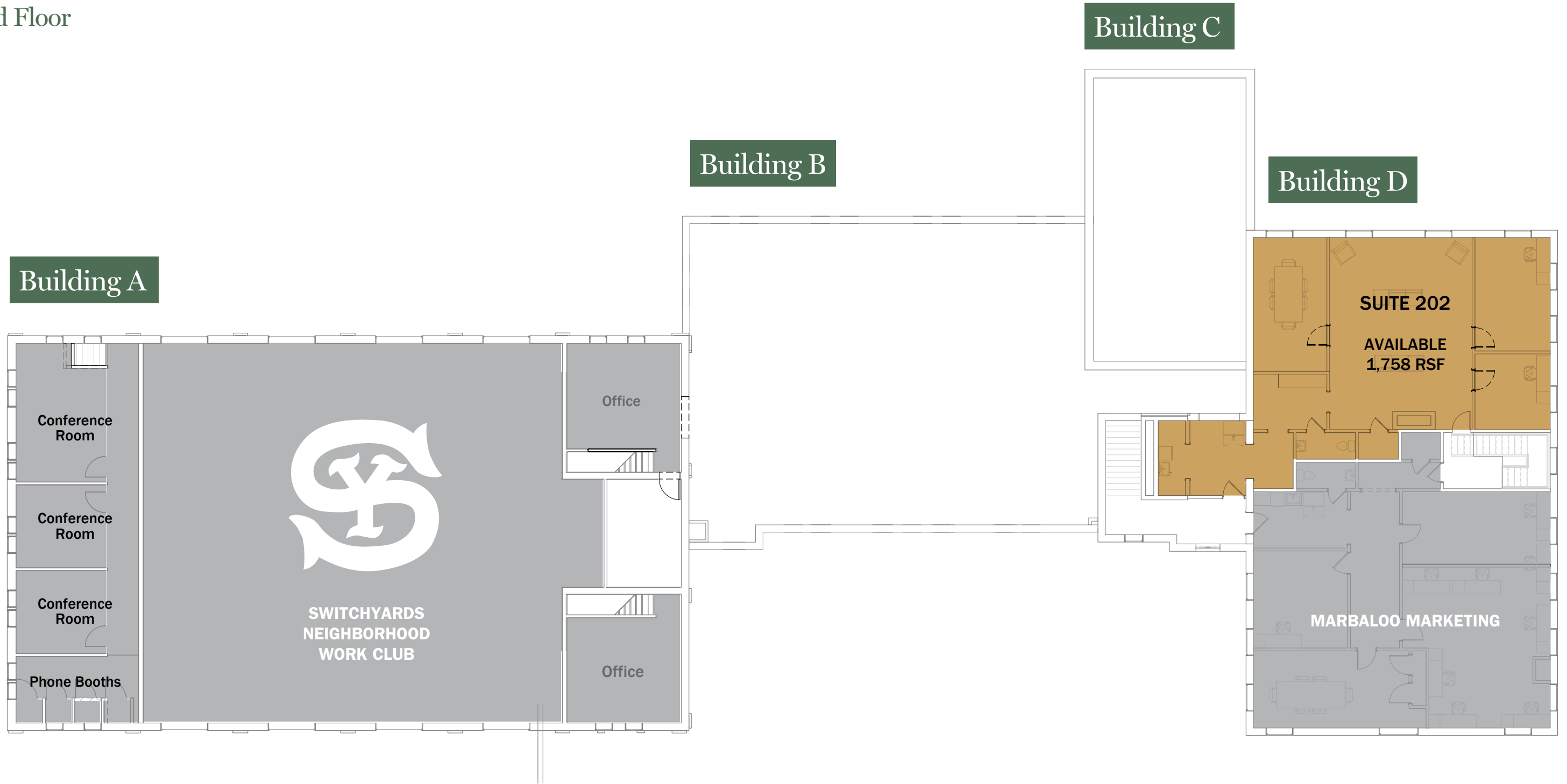

Tenant Mix



AIMEE LEE
KINSSIES
DESIGN



1981



Novelette



THE Yellow TABLE



BUTTERLAMP
BREAD & BEVERAGE
NASHVILLE, TENNESSEE



DARK & DREAMY STUDIO



Bloom

REFINERY
FRAGRANCES
LUXURY PERFUMERY



Echoes of Eden Florals



"...a casual but chic wine bar with dishes that reveal complex layers of flavor and technique below an unassuming surface."
ELLEN FORT for NEW YORK TIMES



Trent Yates

615.268.7724

tyates@sagemontre.com

Matt Cooper

615.319.0124

mcooper@sagemontre.com

Lanier Daniel Wagster

615.601.0630

ldaniel@sagemontre.com

Cameron Bice

205.335.0105

cbice@sagemontre.com

