

FOR LEASE

275 Flatbush Avenue Extension

Downtown Brooklyn

- Retail Opportunity 1,965 – 2,100 SF
- The Heart of Downtown Brooklyn
- At the Base of a 5-Tower 495-Unit Complex
- Unparalleled Visibility



SHLOMI BAGDADI
212.433.3355 x101
sb@tristatecr.com

FREDY HALABI
212.433.3355 x114
fredy.h@tristatecr.com

LEO BEDA
212.433.3355 x103
leo.b@tristatecr.com

TRI STATE COMMERCIAL®

PROPERTY SUMMARY

LOCATION

Located in the Downtown Brooklyn neighborhood of Brooklyn.

HIGHLIGHTS

- Premier New Development Opportunity
- In A Brand New 5-Tower Residential Complex with 495 Apartments
- Expansive Ground-Floor Wrap Around Frontage
- Exceptional Brand Visibility in a High Foot-Traffic Corridor
- Ideal for Flagship Retail, High-End Dining, or Boutique Fitness Concepts
- Summer 2026 Possession

SPACE DETAILS

- Soaring Ceiling Heights
- Modern Floor-to-Ceiling Glass Storefront
- Efficient, Open Layout Suitable for Multiple Uses
- Space A (Corner): 1,965 SF
- Space B (Inline): 2,100 SF

TRANSPORTATION

B D N Q R W Trains at DeKalb Avenue

N R W Trains at Jay Street – MetroTech

2 3 Trains at Hoyt Street

B54 B38 B26 B25 B52 B103 B67 B45 B41 Bus Lines

NEIGHBORS

Joe's, lululemon, Chase Bank, Mobil, Five Guys, Chipotle Mexican Grill, Gong Cha, KPOT Korean BBQ & Hot Pot, A Taste of Katz's, Pierogi Boys, The Brooklyn Hospital Center, Vine Bar, Botte Brooklyn, Compilation Coffee Roasters @ Ft. Greene, NAYA, University Towers – Fort Greene Brooklyn, and more!



FLOOR PLANS

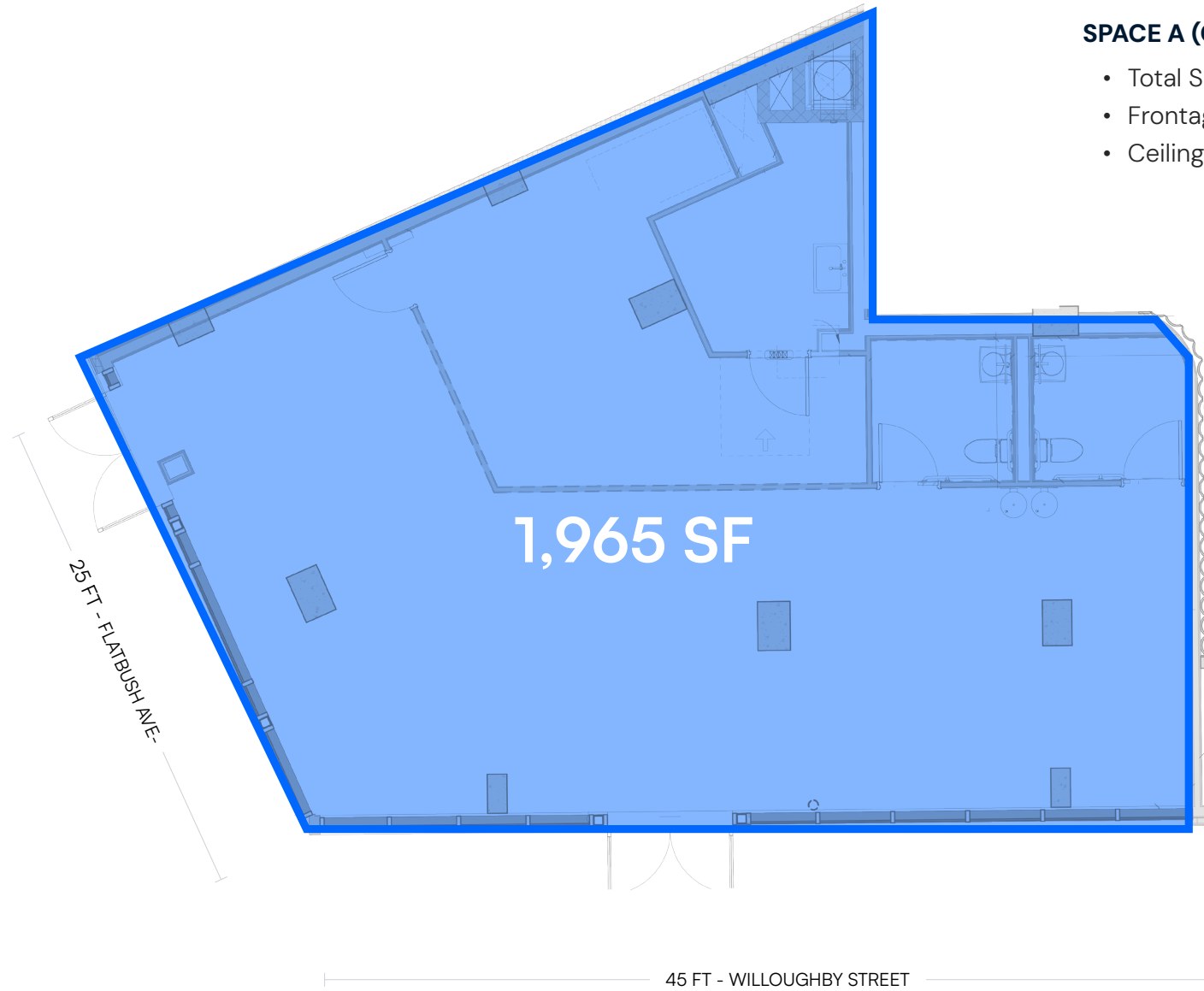

SPACE A (CORNER)

- Total Space: 1,965 SF
- Frontage: 70 FT
- Ceiling Height: 12 FT

All square footages are approximate

FLOOR PLANS



SPACE B (INLINE)

- Total Space: 2,100 SF
- Frontage: 45 FT
- Ceiling Height: 12 FT

All square footages are approximate

RETAIL MAP

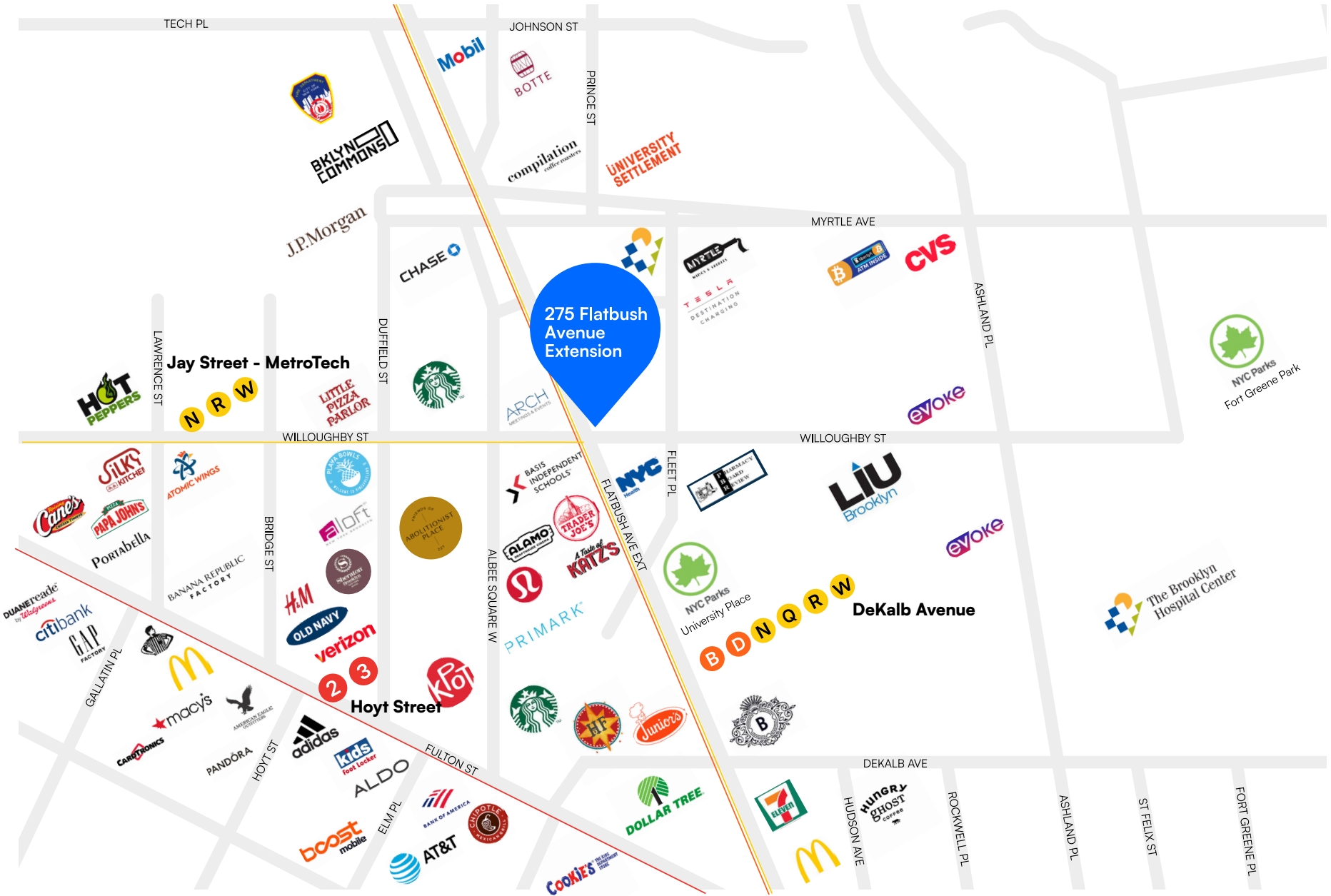

275 FLATBUSH AVENUE EXTENSION, BROOKLYN, NY 11201

1,965 – 2,100 SF PRIME VANILLA BOX RETAIL SPACE WITH WRAP AROUND FRONTAGE

Corner of Flatbush Avenue Extension & Willoughby Street

For Pricing Call: **212.433.3355**

SHLOMI BAGDADI
212.433.3355 x101
sb@tristatecr.com

FREDY HALABI
212.433.3355 x114
fredy.h@tristatecr.com

LEO BEDA
212.433.3355 x103
leo.b@tristatecr.com

TSC.