

CADILLAC RETAIL DEVELOPMENT

9200 E. 34 Road / Cadillac, MI



MID-AMERICA®
Real Estate-Michigan, Inc.

NEW DEVELOPMENT FOR LEASE



RETAIL OPPORTUNITY

CADILLAC RETAIL DEVELOPMENT



Address

9200 E. 34 Road
Cadillac, MI 49601

Availability

1,500 - 8,000 SF

Features

Planned new retail development, positioned along Cadillac's most active commercial corridors. Located on 34 Road, immediately west of US-131, the proposed development offers exceptional visibility and traffic. This area serves as a key gateway to the city, drawing both local residents and regional travelers. With strong frontage and convenient access, the site is well-suited for quick-service restaurants, convenience retail, automotive services, or a variety of retail categories seeking high exposure and consistent customer activity.

Area Tenants



Demographics (2025)

	1 MILE	3 MILES	5 MILES
POPULATION	3,757	13,201	18,461
HOUSEHOLDS	1,729	5,611	7,813
AVG HOUSEHOLD INCOME	\$62,528	\$74,520	\$85,162
DAYTIME POPULATION	5,558	21,619	25,339

CADILLAC RETAIL DEVELOPMENT

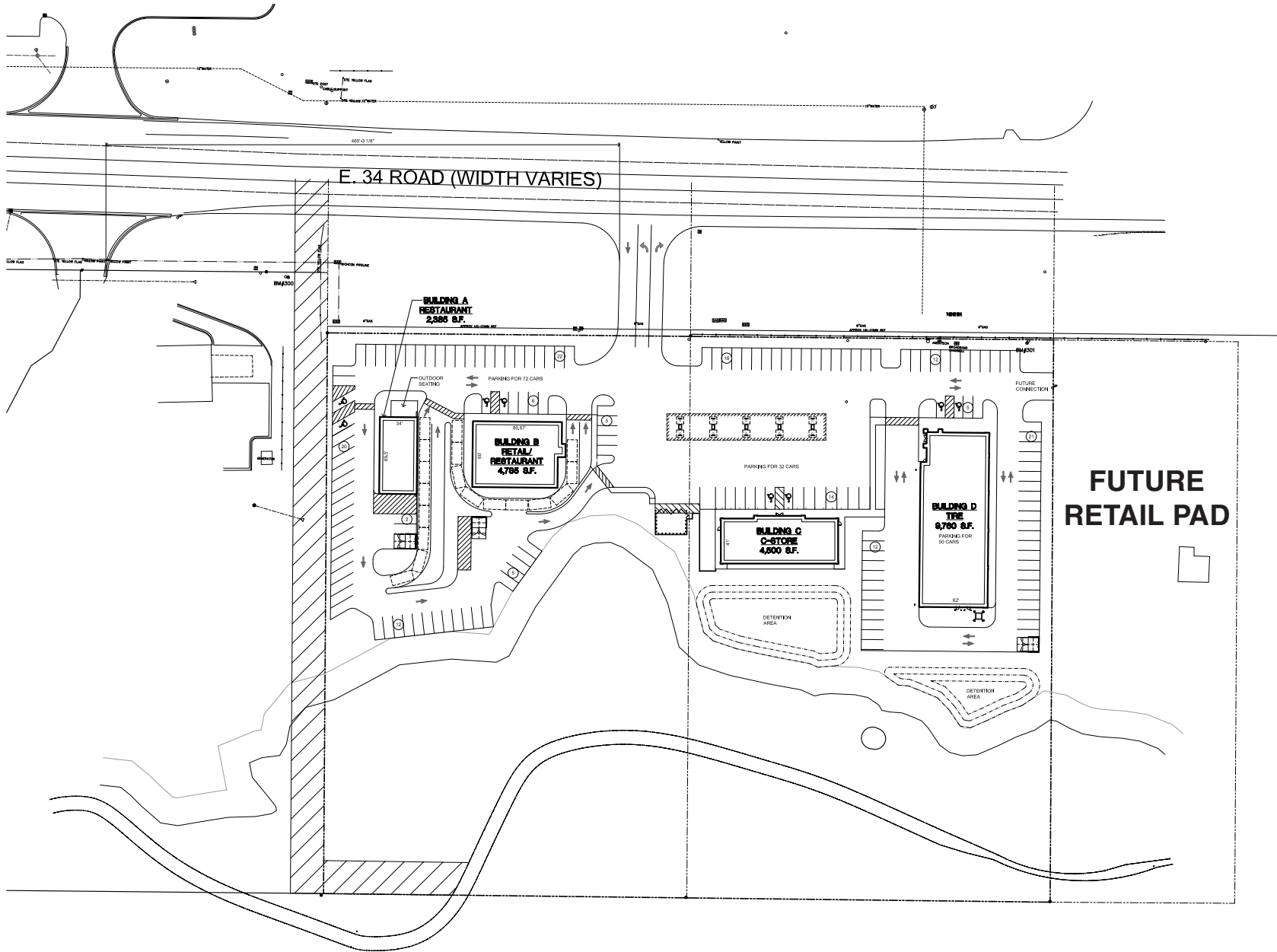

CADILLAC RETAIL DEVELOPMENT



CADILLAC RETAIL DEVELOPMENT



Tony
Schmitt

Mid-America Real Estate -
Michigan, Inc.
T: 248.855.6800
TSchmitt@MidAmericaGrp.com

Adam
Goodman

Mid-America Real Estate -
Michigan, Inc.
T: 248.855.6800
AGoodman@MidAmericaGrp.com



38500 Woodward Ave, Suite 100
Bloomfield Hills, Michigan 48304
248.855.6800
MidAmericaGrp.com