

7801
FOLSOM

7801 FOLSOM BOULEVARD
Sacramento, California 95826

FOR LEASE



NEWMARK

JACKSON
PROPERTIES

UP TO ±7,400 SF OF
CONTIGUOUS SPACE AVAILABLE

7801 FOLSOM



NEWMARK



NEWMARK

HIGHLIGHTS



SPEC SUITES AVAILABLE FOR IMMEDIATE OCCUPANCY



COMMON CONFERENCE ROOM



UPDATED BUILDING INTERIOR & EXTERIOR



CONTEMPORARY LOOK AND DESIGN TO CLASS A STANDARDS



MONTHLY LANDLORD HOSTED COFFEE CART



EASY ACCESS TO HIGHWAY 50, HOWE AVENUE AND CSUS



CONVENIENTLY LOCATED NEAR NUMEROUS SUBMARKETS INCLUDING DOWNTOWN, MIDTOWN, CAMPUS COMMONS AND HIGHWAY 50



AVAILABLE BUILDING-TOP SIGNAGE THAT FACES HIGHWAY 50



NEARBY AMENITIES INCLUDE STARBUCKS, DOS COYOTES, ONE SPEED AND SELLANDS MARKET-CAFE SUITE RENTABLE SF (±)





AVAILABILITIES

SUITE	RENTABLE SF (±)
104	2,246
200	3,431 (Divisible)
202	3,010
300	3,399 (Divisible)
315	1,100
365	1,880
370	5,488 (Divisible)
365 370	7,368 (Divisible)

0 - 2,000 SF	2,001 - 3,000 SF	3,001 SF +
--------------	------------------	------------



7801 FOLSOM

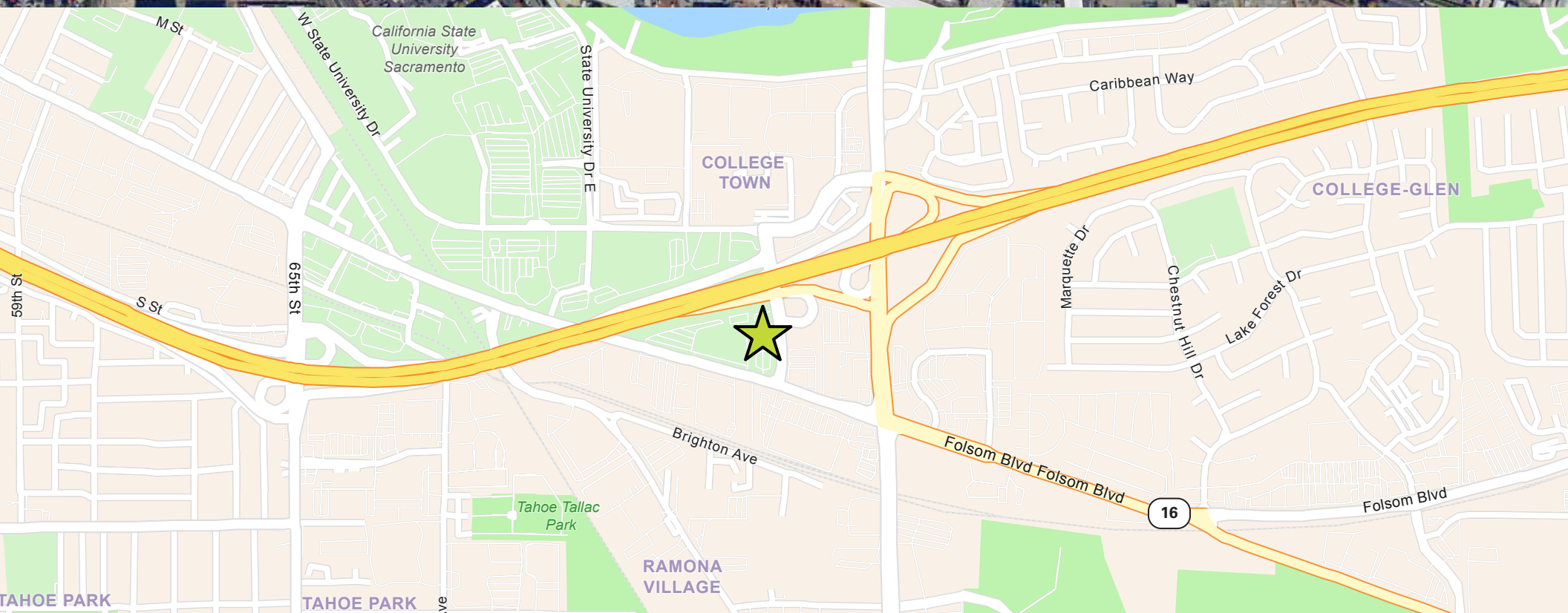
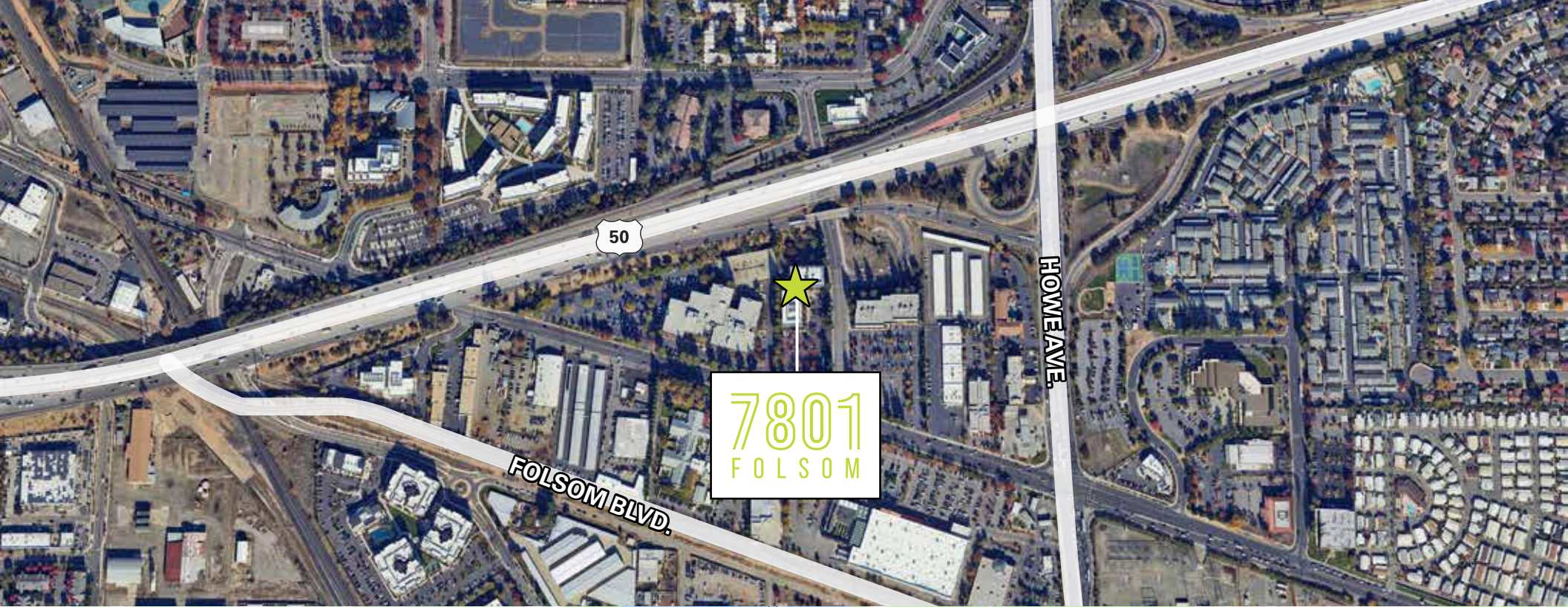

1ST FLOOR PLAN



AVAILABLE

Suite 104

2,246 RSF

2ND FLOOR PLAN

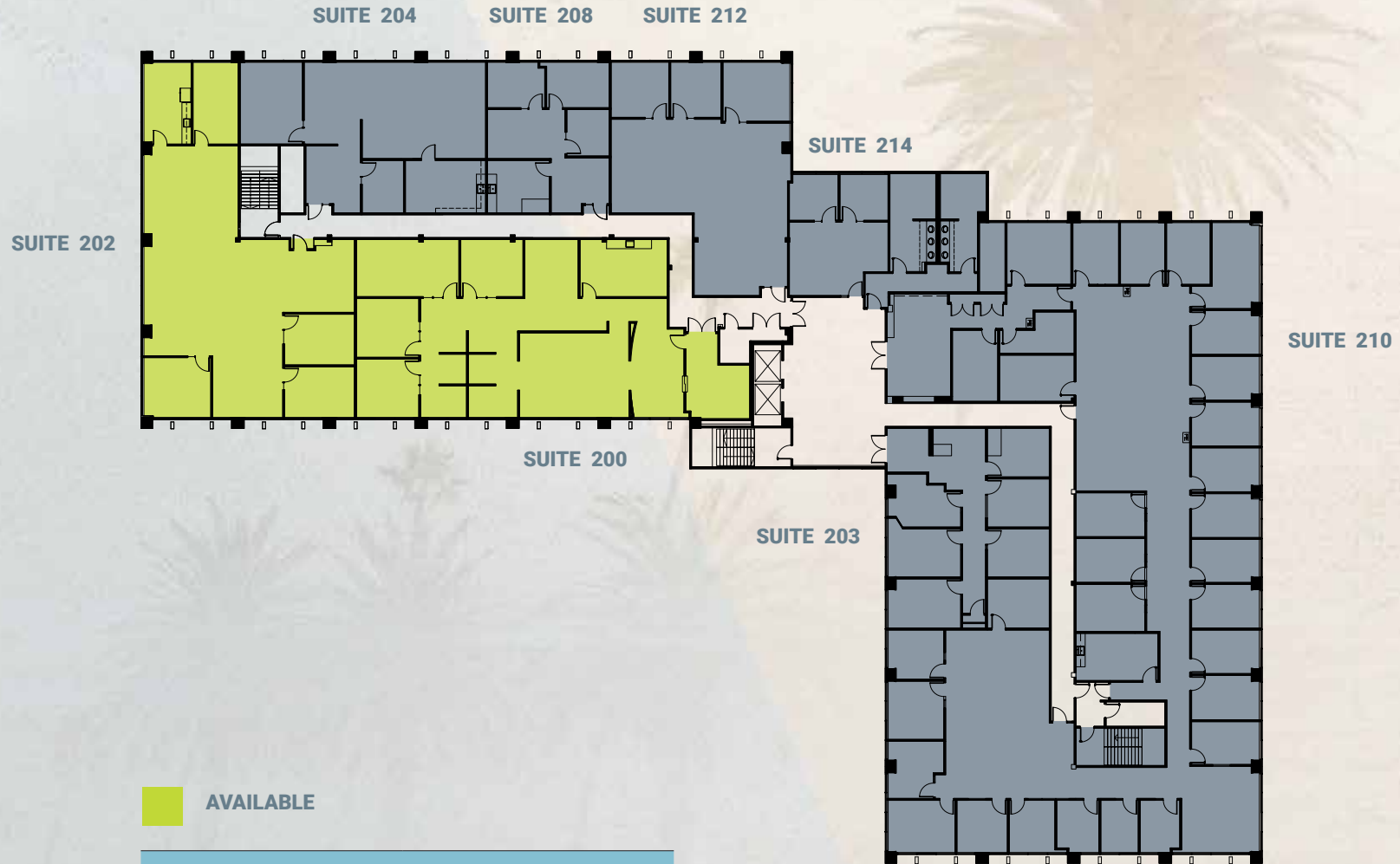

AVAILABLE

Suite 200	Suite 202
3,431 RSF (Divisible)	3,010 RSF

*Can be Combined (6,441 SF)

3RD FLOOR PLAN



FOLSOM
1108
7801

AVAILABLE

Suite 300	Suite 315	Suite 365	Suite 370
3,399 RSF (Divisible)	1,100 RSF	1,880 RSF	7,368 RSF (Divisible)

AMENITY MAP



Wildwood **PIATTI**
RUTH'S **CHRIS** STEAK HOUSE
CAFE **BERNARDO**



FAIR OAKS BLVD

SELLAND'S



JST

JST

ZÓCALO **SAFECO**
BUCKHORN **BENNETT'S**
Starbucks **PEARLS** **manchie's**

Save Mart **Jamba**
CHIPOTE **BEAUFORT** **NORR'S**
JACKS

HOME AVE

16



50

CAMELLIA CENTER

Great Clips **Save Mart**
CHIPOTE **BR BASKIN-ROBBINS**
ups **petco**

Pita Pit
Surgerpatch
BENTO BOX



50



FOLSOM BLVD

7801 FOLSOM



F O L S O M

7801

Jack Blackmon

Director

t 916-569-2372

m 916-494-2349

Jack.Blackmon@nmrk.com

CA RE LIC. #01999561

Jodie Robinson

Associate

t 916-569-2318

m 530-863-8379

Jodie.Robinson@nmrk.com

CA RE LIC. #02214357

Chris Lemmon

Executive Managing Director

t 916-367-6349

m 916-832-5640

Chris.Lemmon@nmrk.com

CA RE LIC. #01506816

nmrk.com

The information contained herein has been obtained from sources deemed reliable but has not been verified and no guarantee, warranty or representation, either express or implied, is made with respect to such information. Terms of sale or lease and availability are subject to change or withdrawal without notice. 3/2026

NEWMARK

JACKSON
PROPERTIES

7801 FOLSOM BOULEVARD
Sacramento, California 95826