



South Station

PRODUCTS SUITES | OFFICES | ACCESS | VIRTUAL

**711 Atlantic Avenue, 6th Floor
Boston, MA 02111**

Industrious South Station is located in the southern edge of downtown near Boston's Chinatown & the Leather District. Chinatown's dense mix of shops, restaurants, and housing in historic buildings creates an ever-bustling neighborhood. And the Leather District, a small neighborhood nestled between Dewey Square and Kneeland Street consists of nine distinct blocks. They are noted for their 19th century brick warehouse structures.

31K

Rentable Sqft

8

Conference Rooms

40

Offices

8

Suites



INCLUDED SERVICES

- | | |
|--------------------------|-----------------------------|
| Dedicated On-Site Staff | Wellness Room |
| Daily Breakfast & Snacks | Unlimited Color Printing |
| Craft Coffee & Tea | Fast, Secure Wi-Fi |
| Mail & Packaging | Office Supplies |
| Community Events | Professional-Grade Cleaning |
| Weekly Happy Hours | 24/7 Access |

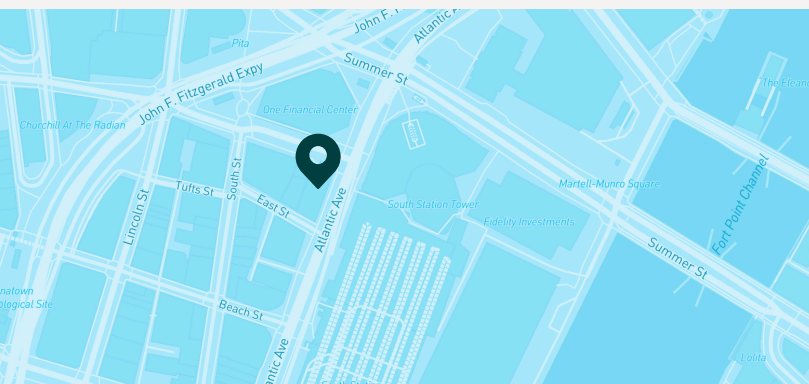

TRANSIT

South Station with MBTA Commuter Rail, Red Line, and major Bus Lines is a 2 minute walk away

LEGEND

- Access Office
- Small Office (1-2)
- Medium Office (3-4)
- Large Office (5-8)
- XLarge Office (9+)
- Executive Office

MEETING SPACES

Phone Booths	8
Focus Rooms	1
Conference Rooms	8

SUITE SPECS

Suite	LSF	Workstations*
501	1361	44
502	1425	45
503	1067	24
509	996	31
515	1172	44
619	1011	34
620	439	11
621	2710	55

*Max capacity, 48"x24" desk

PARKING INFO

No parking onsite, nearby options listed below:

- South Station Garage
- Two Financial Center Garage
- 125 Summer St Garage

#1 IN SATISFACTION

Industrious is the highest rated workplace for customer satisfaction in the industry – offering premium coworking, private offices, and conference facilities with flexible terms and all-inclusive pricing.

5TH FLOOR

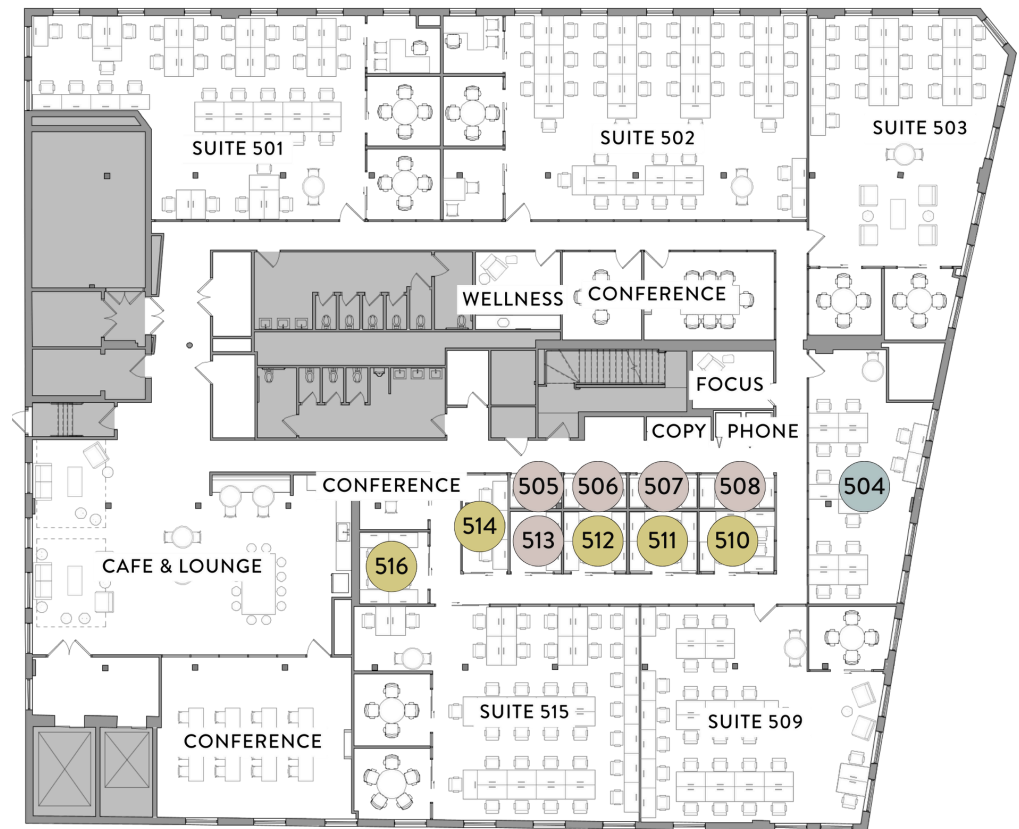

6TH FLOOR

