



For lease

Medical space available at
Mercy Medical Plaza

2,296 SF

Mercy Medical Plaza

411 Laurel Street
Des Moines, Iowa 50314

Property Overview

Availability: 2,296 SF (Suite 3170)

Lease rate: \$17.00/NNN

Building size: 49,728 SF

- Adjacent parking ramp providing onsite parking
- 2 restrooms in suite
- 6 private offices, reception desk
- Break room
- Former executive medical office

Justin Lossner, CCIM, SIOR

Senior Managing Director

justin.lossner@jll.com

+1 515 371 0846

Lucas Hedstrom

Vice President

lucas.hedstrom@jll.com

+1 515 564 9269

Thomas Edwards

Associate

thomas.edwards@jll.com

+1 515 802 4684



jll.com/des-moines

Jones Lang LaSalle Americas, Inc.

Images



Floor plan

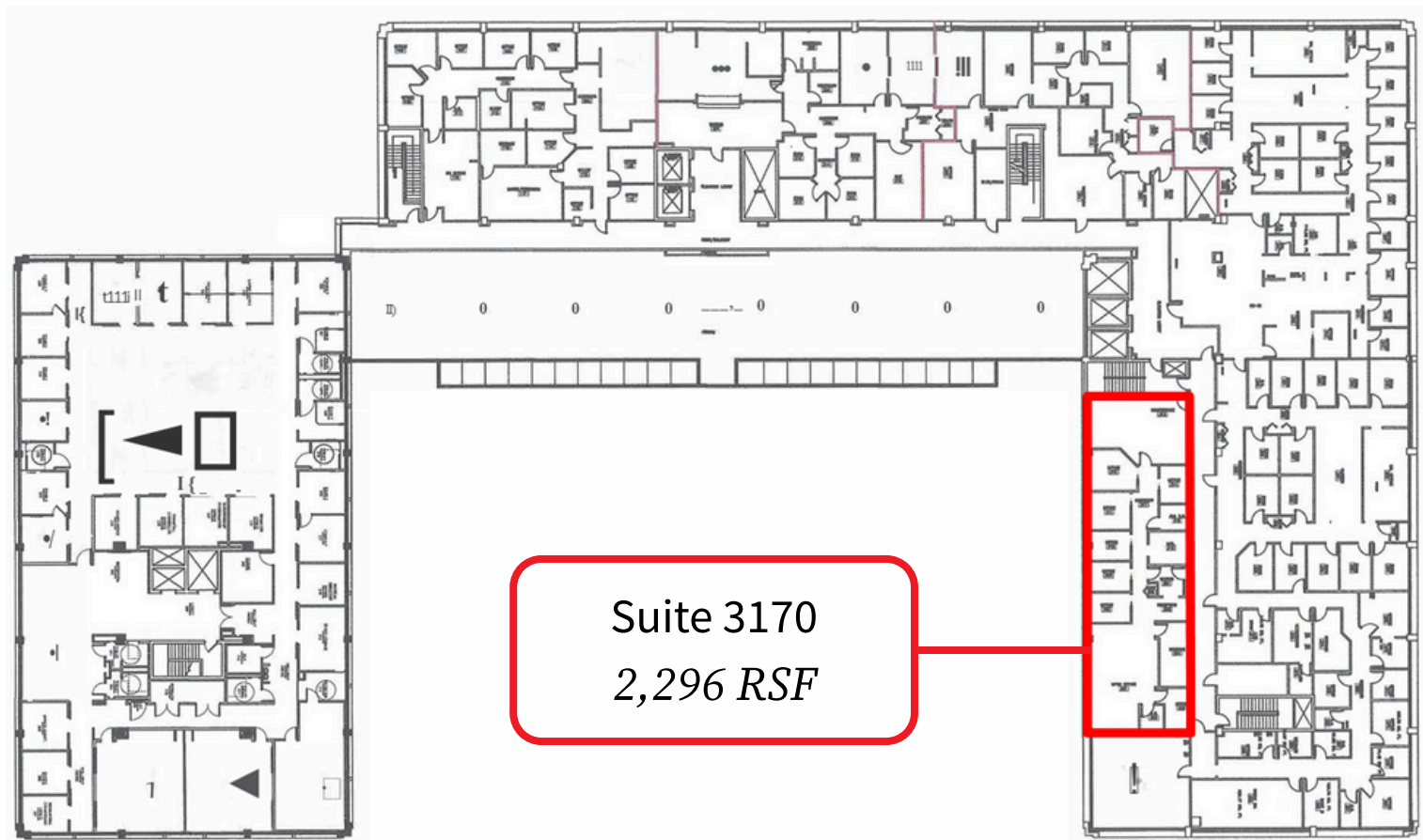

For lease

411 Laurel Street | Des Moines, Iowa 50314

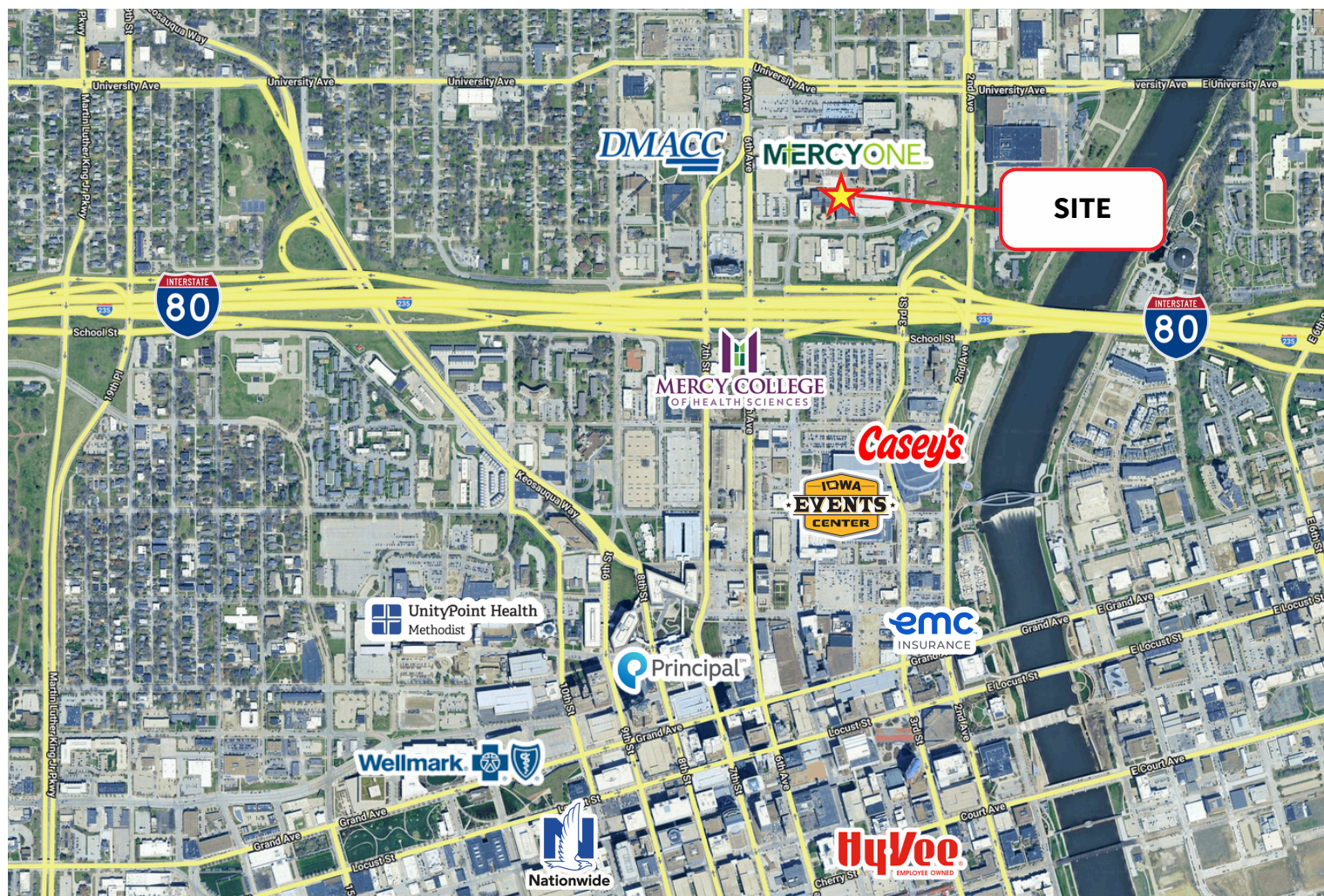

**Contact broker for
additional information**

jll.com/des-moines

Justin Lossner, CCIM, SIOR
Senior Managing Director
justin.lossner@jll.com
+1 515 371 0846

Lucas Hedstrom
Vice President
lucas.hedstrom@jll.com
+1 515 564 9269

Thomas Edwards
Associate
thomas.edwards@jll.com
+1 515 802 4684