

**FOR LEASE**

**Dock Served  
Warehouse | Distribution**

**5850  
District Blvd  
Suite 2**

**Bakersfield, CA**



**WOODMASTERS**  
WINDOWS - DOORS  
CABINETS - & MORE

**5850**



# Dock Served Warehouse | Distribution Available For Lease

## Property Information & Floor Plan

5850 District Blvd • Suite 2 • Bakersfield, CA

### Property Details

- Total Available 12,380 SF
- Warehouse 11,410 SF
- Office 970 SF
- Dock Doors (1) 9'x10'
- Ground Level Doors (1) 12'x14'
- Clear Height 20'-23'
- Bay Spacing 42'x21'
- Lighting LED
- District Blvd Monument Signage Available slot

### Utilities

- Water California Water Company  
City of Bakersfield
- Sewer City of Bakersfield
- Gas PG&E  
The Gas Company
- Electric Pacific Gas & Electric  
200 amps of 120/208 volt

### Lease Rate

- \$1.05 PSF IG

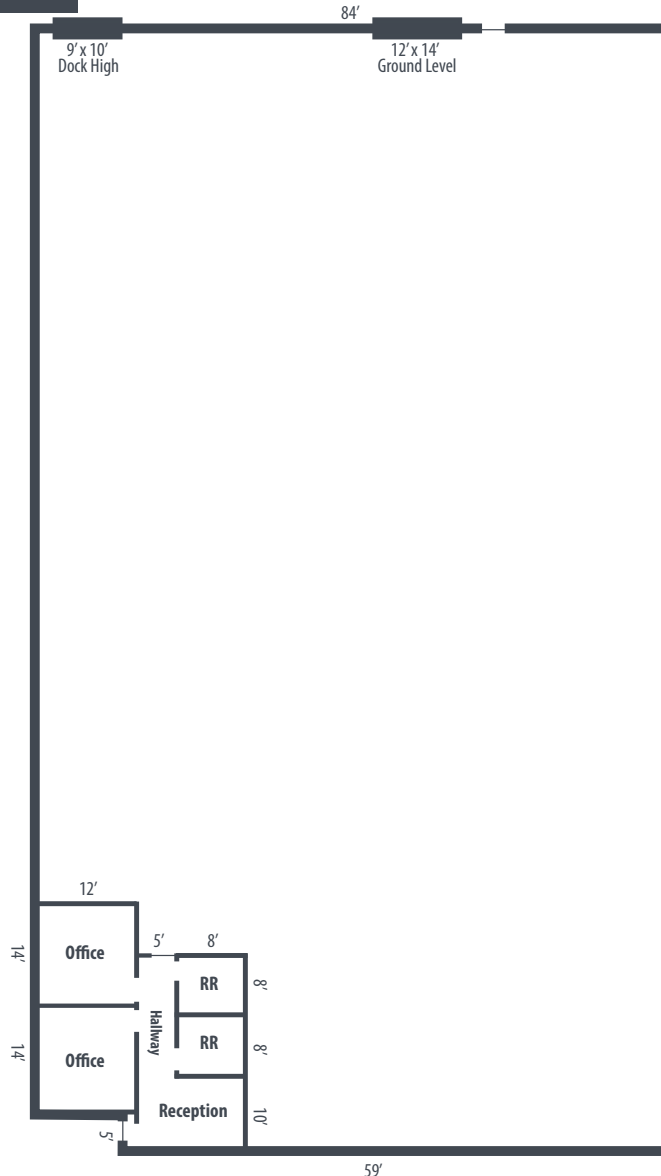

\*Plans deemed to be accurate, but not guaranteed. Plan not to scale.

### Monument Sign



# Dock Served Warehouse | Distribution Available For Lease

## Site Plan

5850 District Blvd - Suite 2 - Bakersfield, CA



\*Plans deemed to be accurate, but not guaranteed. Plan not to scale.



**Wesley M. McDonald** • Principal • 661 885 6950 • wesley.mcdonald@asuassociates.com • CA RE #01511739  
**Parker Reynolds** • Vice President • 661 885 6925 • parker@asuassociates.com • CA RE #02156913  
11601 Bolthouse Drive Suite 110 • Bakersfield, CA 93311 • 661 862 5454 main • 661 862 5444 fax

# Dock Served Warehouse | Distribution Available For Lease

## Property Photos

5850 District Blvd - Suite 2 - Bakersfield, CA



# Dock Served Warehouse | Distribution Available For Lease

## Aerial Photo

5850 District Blvd - Suite 2 - Bakersfield, CA

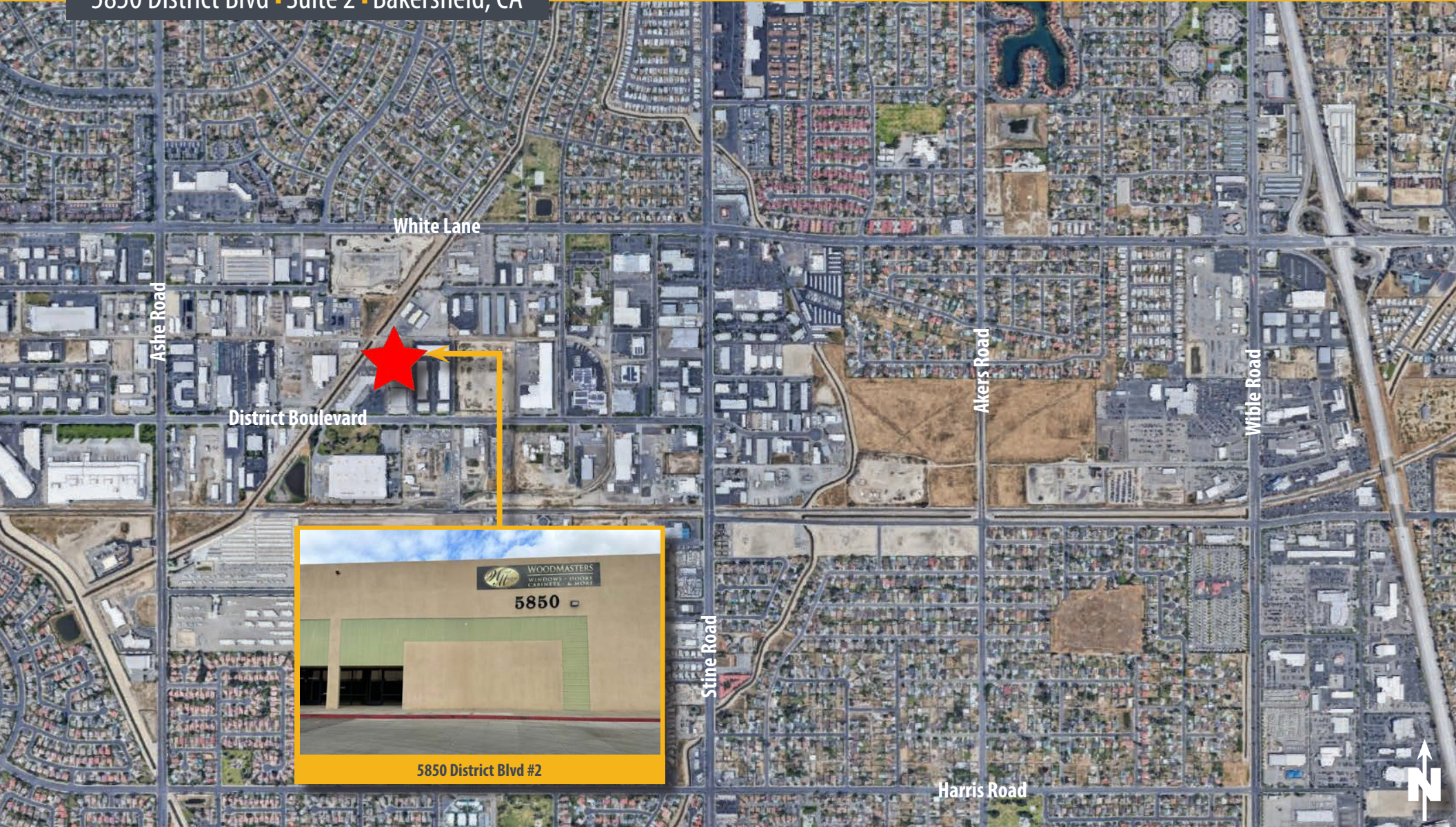

**Wesley M. McDonald** • Principal • 661 885 6950 • [wesley.mcdonald@asuassociates.com](mailto:wesley.mcdonald@asuassociates.com) • CA RE #01511739  
**Parker Reynolds** • Vice President • 661 885 6925 • [parker@asuassociates.com](mailto:parker@asuassociates.com) • CA RE #02156913  
11601 Bolthouse Drive Suite 110 • Bakersfield, CA 93311 • 661 862 5454 main • 661 862 5444 fax