

# Goodman Commerce Center - Long Beach

## 11.21 Acres Available For Lease

L.B./L.A. Ports



**Parcel B:**  
2131 E Wardlow Rd  
Long Beach  
± 3.74 Acres

**Parcel A:**  
2200 36th St  
Lakewood  
± 7.47 Acres

18401 Von Karman Avenue Suite 150  
Irvine, CA 92612  
Corporate License #01355491

**JEFF READ**  
*Executive Managing Director*  
t 949-608-2029  
jeff.read@nmrk.com  
CA RE Lic. #01040265

**JIM BIONDI**  
*Executive Managing Director*  
t 310-491-2002  
jim.biondi@nmrk.com  
CA RE Lic. #00468745

**TERRY REITZ**  
*Executive Managing Director*  
t 310-491-2029  
terry.reitz@nmrk.com  
CA RE Lic. #00457222



The information contained herein has been obtained from sources deemed reliable but has not been verified and no guarantee, warranty or representation, either express or implied, is made with respect to such information. Terms of sale or lease and availability are subject to change or withdrawal without notice.

# Goodman Commerce Center - Long Beach

## Parcel A: 2200 36th St, Lakewood, CA 90712

- ±7.47 Acres Available for Lease
- Contiguous to 3.74 acre site for potential total of 11.21 acres
- License term up to 11/3/27
- Available for storage of containers on chassis or chassis separately
- Immediate Access to 405 Freeway at Cherry Ave
- Close Proximity to Long Beach/LA ports

## Parcel B: 2131 E Wardlow Rd, Long Beach, CA 90807

- ±3.74 Acres Available for Lease
- Contiguous to 7.47 acre site for potential total of 11.21 acres
- License term up to 1/30/25
- Available for storage of containers on chassis or chassis separately
- Immediate Access to 405 Freeway at Cherry Ave
- Close Proximity to Long Beach/LA ports

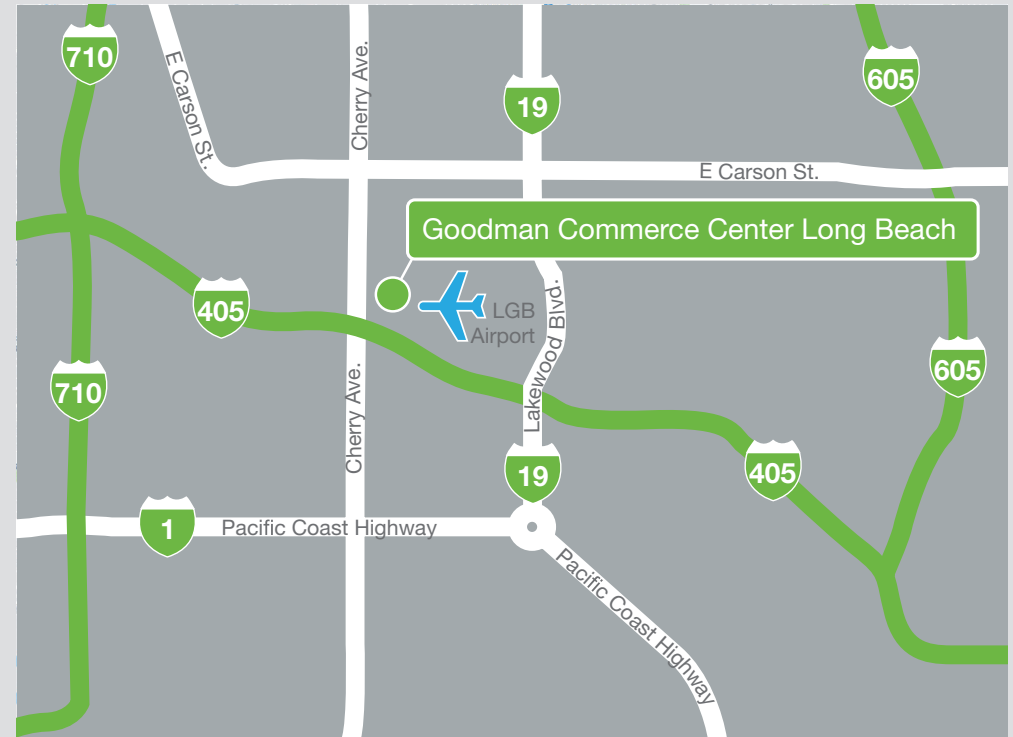

# 11.21 acres

18401 Von Karman Avenue Suite 150  
Irvine, CA 92612  
Corporate License #01355491

### JEFF READ

*Executive Managing Director*  
t 949-608-2029  
jeff.read@nmrk.com  
CA RE Lic. #01040265

### JIM BIONDI

*Executive Managing Director*  
t 310-491-2002  
jim.biondi@nmrk.com  
CA RE Lic. #00468745

### TERRY REITZ

*Executive Managing Director*  
t 310-491-2029  
terry.reitz@nmrk.com  
CA RE Lic. #00457222

## NEWMARK

The information contained herein has been obtained from sources deemed reliable but has not been verified and no guarantee, warranty or representation, either express or implied, is made with respect to such information. Terms of sale or lease and availability are subject to change or withdrawal without notice.

# Goodman Commerce Center - Long Beach

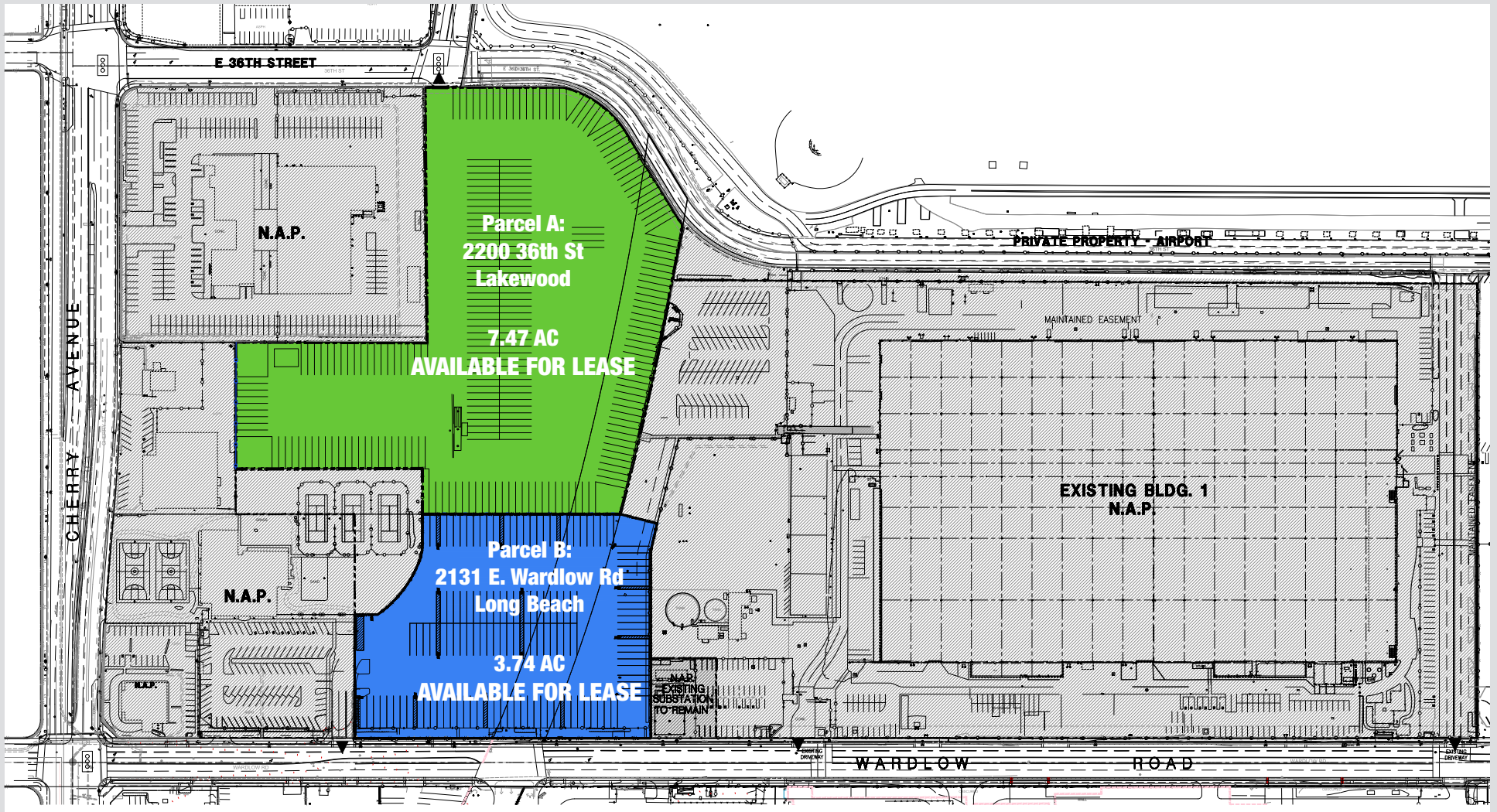

18401 Von Karman Avenue Suite 150  
Irvine, CA 92612  
Corporate License #01355491

## JEFF READ

*Executive Managing Director*

t 949-608-2029

jeff.read@nmrk.com

CA RE Lic. #01040265

## JIM BIONDI

*Executive Managing Director*

t 310-491-2002

jim.biondi@nmrk.com

CA RE Lic. #00468745

## TERRY REITZ

*Executive Managing Director*

t 310-491-2029

terry.reitz@nmrk.com

CA RE Lic. #00457222

# NEWMARK

The information contained herein has been obtained from sources deemed reliable but has not been verified and no guarantee, warranty or representation, either express or implied, is made with respect to such information. Terms of sale or lease and availability are subject to change or withdrawal without notice.