



For sublease

2412 Grenoble Road
Richmond, VA 23294



JLL

Chris Avellana

chris.avellana@jll.com

+1 (804) 200 6468



2412 Grenoble Rd
Richmond, VA 23294

Property highlights

- 16,232 SF office/warehouse available for immediate occupancy
- Sublease term through 11/30/2026
- +/- 7,500 SF warehouse with 16' ceiling clear and two (2) 12'x14' drive-in doors
- +/- 1,300 SF two bay mechanic repair shop
- +/- 3/4 acre of fenced, paved yard space
- M-1 zoning in Henrico County
- \$8.50/SF NNN

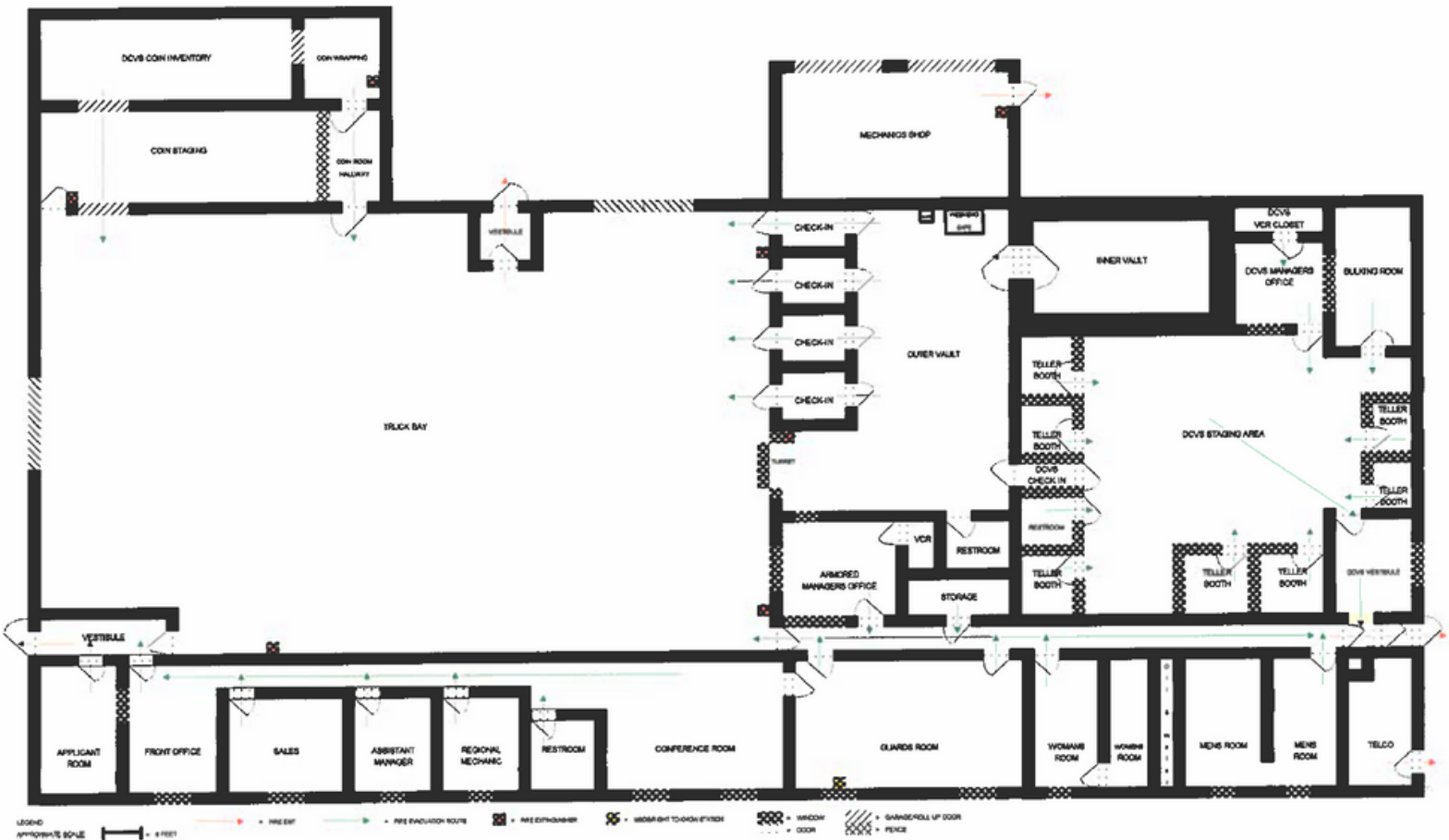



AMENITY MAP

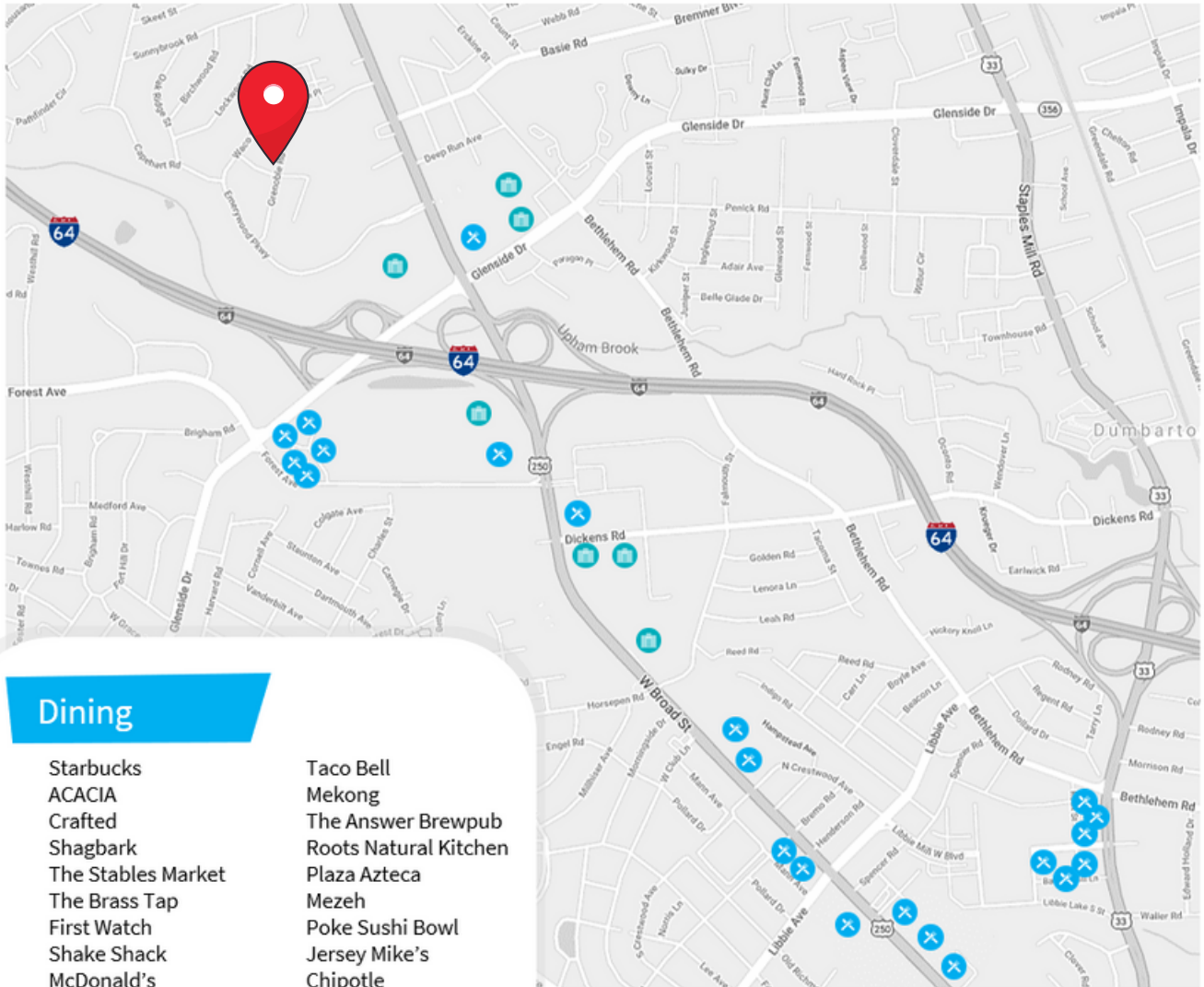

Dining

- Starbucks
- ACACIA
- Crafted
- Shagbark
- The Stables Market
- The Brass Tap
- First Watch
- Shake Shack
- McDonald's
- Einstein Bros Bagels
- Sonic Drive-In
- Taco Bell
- Mekong
- The Answer Brewpub
- Roots Natural Kitchen
- Plaza Azteca
- Mezeh
- Poke Sushi Bowl
- Jersey Mike's
- Chipotle
- Saladworks
- Mission BBQ

Lodging

- Courtyard by Marriott
- Residence Inn by Marriott
- Candlewood Suites
- The Westin
- Embassy Suites by Hilton
- Hampton Inn & Suites
- Residence Inn by Marriott

Traffic scores



Chris Avellana

chris.avellana@jll.com

+1 (804) 200 6468

jll.com

Jones Lang LaSalle Americas, Inc. License #: CO508577000