

Jack Fleming

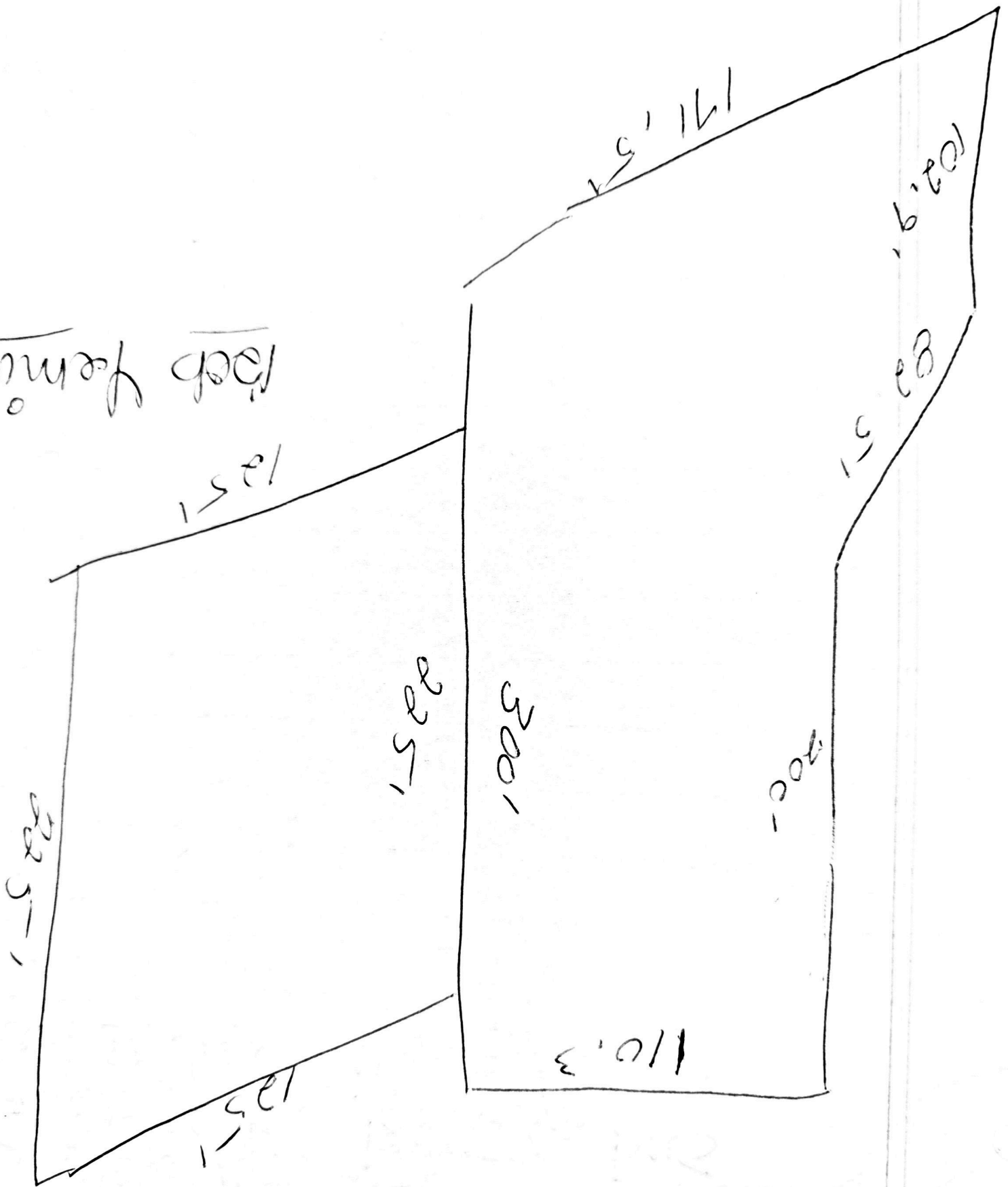

Then pay, in full

Township 51 North, Range 63 West, 6th P.M. Crook County, Wyoming,

Section 23: A tract of land situated in the SW1/4NE1/4 being more particularly described as follows:

Beginning at a point which N. 1°37' W., a distance of 1040.07 feet along the North-South centerline from the center of Section 23, Township 51 North, Range 63 West, and is 70 feet right of the centerline of U.S. Highway # 14, being on the right right-of-way line at Station 30 + 46.2; thence N. 59°24' E, a distance of 171.5 feet along the right-of-way line to a point; thence S. 01°03'37" E., a distance of 102.9 feet to a point; thence S. 27°34' W., a distance of 82.5 feet to a point; thence S. 01°37' E., a distance of 200 feet to a point, thence S. 84°13' W., a distance of 110.3 feet to a point on the North-South centerline of Section 23; and thence N. 01°37' W., a distance of 300 feet along the Section centerline to the point of beginning.

And

Township 51 North, Range 63 West, 6<sup>th</sup> P.M. Crook County, Wyoming

Section 23: A tract of land situated in the SW1/4NE1/4 being more particularly described as follows:

Beginning at a point where the North-South quarter line of Section 23 Township 51 North, Range 63 West, intersects the South right-of-way line U.S. Highway 14 on the West edge of the Town of Sundance; thence Southwesterly along the South right-of-way line of U.S. Highway 14 on a bearing of S. 59°37' E. for a distance of 125 feet; thence S. 1°37' E. for a distance of 225 feet; thence N. 59°24' E. for a distance of 125 feet; thence N. 1°37' E. for a distance of 225 feet along the quarter line to the point of beginning.