

PROPERTY FEATURES

FOR SALE

RACCOON AVE. ADELANTO, CA 92301



LOT SIZE:
±192,535 sq.ft. (±4.42 Acres)



PARCELS
APN'S: 0459-433-01-0000



ZONING
Light Manufacturing (LM)
per the City of Adelanto

PROPERTY HIGHLIGHTS

- Corner lot
- Flat Topography
- Close proximity to the US 395 Highway, and near the So Cal Logistics Airport and I-15 Freeway.



Rene Ramos, Jr.
909.980.6868
Rene.Ramos@kwcommercial.com
CalDRE Lic. #01836872

"Happy" Raj Singh
909.935.0931
Raj.Singh@kwcommercial.com
CalDRE Lic. #02199675



**INLAND
EMPIRE**

CAL DRE # 02120868

KW COMMERCIAL
3595-1 Inland Empire
Blvd. Suite 1250
Ontario, CA 91764
909.980.6868

WE OBTAINED THE INFORMATION ABOVE FROM SOURCES WE BELIEVE TO BE RELIABLE. HOWEVER, WE HAVE NOT VERIFIED ITS ACCURACY AND MAKE NO GUARANTEE, WARRANTY, OR REPRESENTATION ABOUT IT. IT IS SUBMITTED SUBJECT TO THE POSSIBILITY OF ERRORS, OMISSIONS, CHANGE OF PRICE, RENTAL OR OTHER CONDITIONS, PRIOR SALE, LEASE OR FINANCING, OR WITHDRAWAL WITHOUT NOTICE. WE INCLUDE PROJECTIONS, OPINIONS, ASSUMPTIONS OR ESTIMATES FOR EXAMPLE ONLY, AND THEY MAY NOT REPRESENT CURRENT OR FUTURE PERFORMANCE OF THE PROPERTY. YOU AND YOUR TAX AND LEGAL ADVISORS SHOULD CONDUCT YOUR OWN INVESTIGATION OF THE PROPERTY AND TRANSACTION.

AERIAL MAP



LOCAL MAP

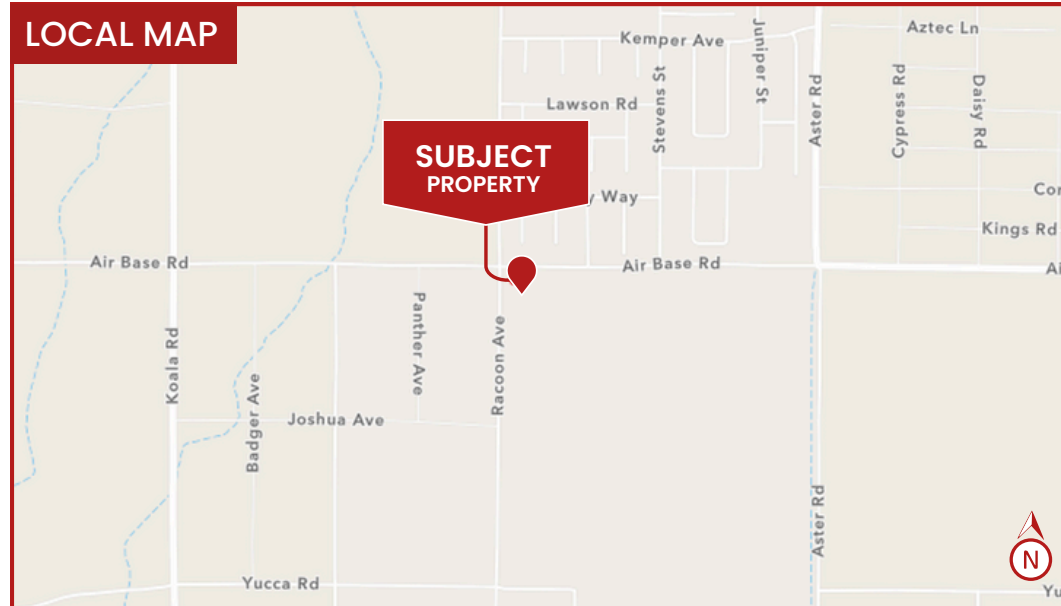

REGIONAL MAP

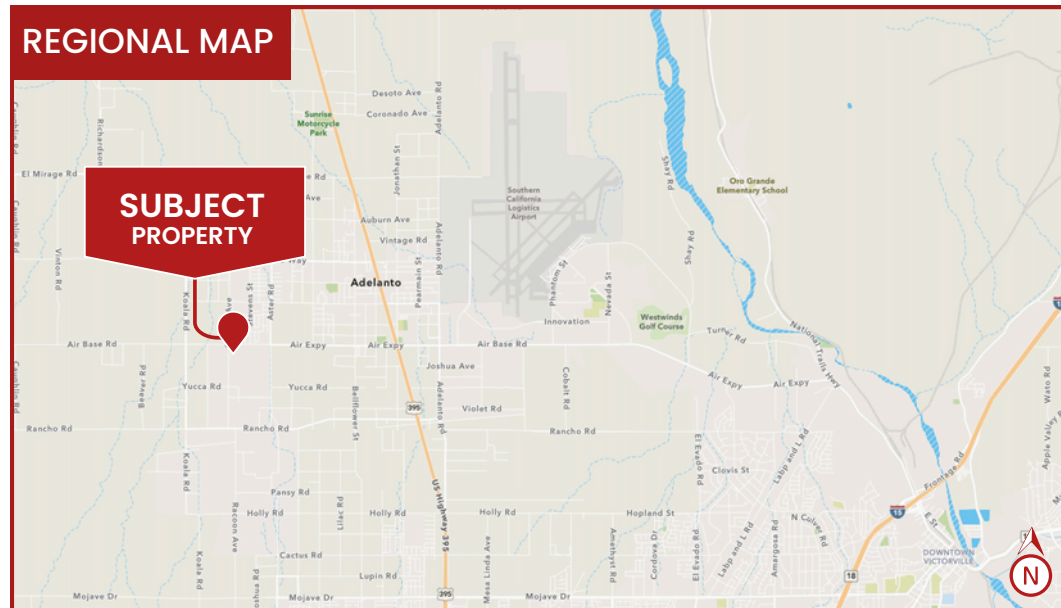

Rene Ramos, Jr.
909.980.6868
Rene.Ramos@kwcommercial.com
CalDRE Lic. #01836872

"Happy" Raj Singh
909.935.0931
raj.singh@wcommercial.com
CalDRE Lic. #02199675



CAL DRE # 02120868



Air Expressway.

Racoon Ave.

Rene Ramos, Jr.
909.980.6868
Rene.Ramos@kwcommercial.com
CalDRE Lic. #01836872

"Happy" Raj Singh
909.935.0931
raj.singh@wcommercial.com
CalDRE Lic. #02199675



INLAND
EMPIRE

CAL DRE # 02120868