

For Lease

Twain Swenson Plaza

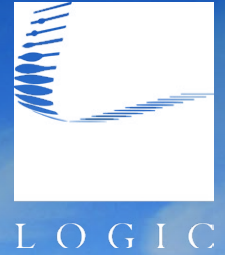

860 E. Twain Ave.
Las Vegas, NV 89169

Joanna Zirbes, CCIM
Vice President
702.954.4163
jzirbes@logicCRE.com
S.0184741

Brendan Leake
Senior Associate
702.954.4132
bleake@logicCRE.com
S.0178140

Listing Snapshot



Contact Broker
Lease Rate



± 1,227 - 6,715 SF
Available Square Footage

Property Highlights

- Signalized corner shopping center located on the NEC of Twain Avenue and University Center Drive
- Shopping center is anchored by one of the top performing Family Dollar locations in Nevada
- Conveniently located near The Strip, UNLV, the Las Vegas Convention Center, and Boulevard Mall
- Property features excellent exposure and pylon signage opportunities on E. Twain Ave. and University Center Dr.

Demographics

	1-mile	3-mile	5-mile
2024 Population	31,381	160,141	437,406
2024 Average Household Income	\$56,415	\$70,567	\$70,099
2024 Total Households	15,099	72,401	178,869





Site Plan

Available NAP

Suite	Tenant	SF
101	Palm Pizza	± 1,357
102	Lefty-J's Island	± 1,313
103-106	Balm of Gilead	± 5,492
107-108	Calvary Chapel	± 2,626
109	Leitos Wireless	± 663
110-111	Launderland	± 3,442
112	AVAILABLE	± 1,393
113	AVAILABLE	± 1,313
114-115	Collective Restaurant	± 2,716
116-120	AVAILABLE	± 6,715
121-122	Laos Thai St. Food	± 2,706
123-127	Family Dollar	± 10,651
128	AVAILABLE	± 1,364
129	Best Smoke	± 1,340
130	Church	± 1,420
131	Lucky's	± 2,760
133-134	Your Body	± 1,692
135	Envios Y Multiservices	± 1,027
136	Miki's Beauty Salon	± 1,102
137	AVAILABLE	± 1,227
138	Your Stop	± 5,040

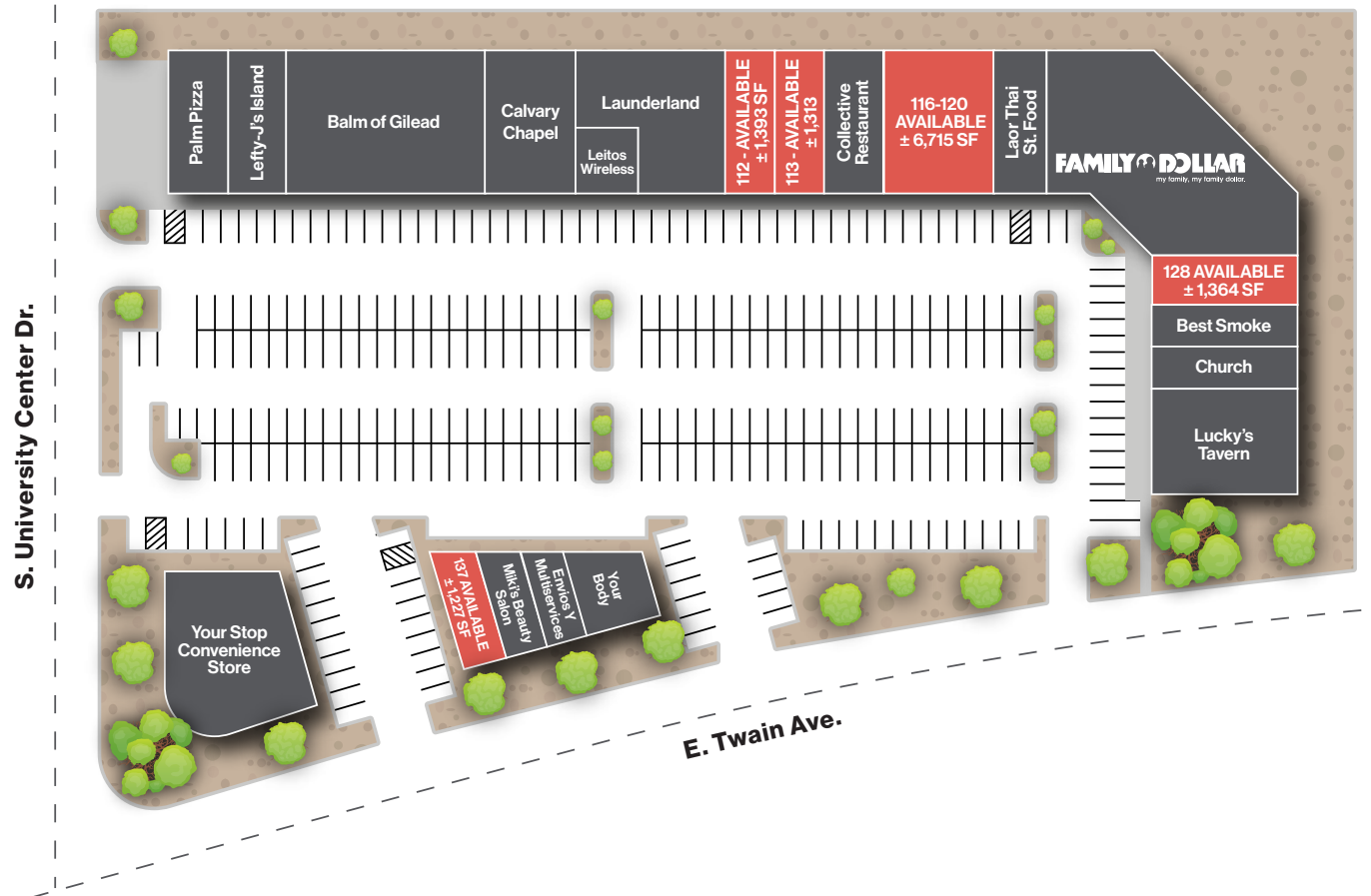

Floor Plan | Suite 116-120
± 6,715 SF

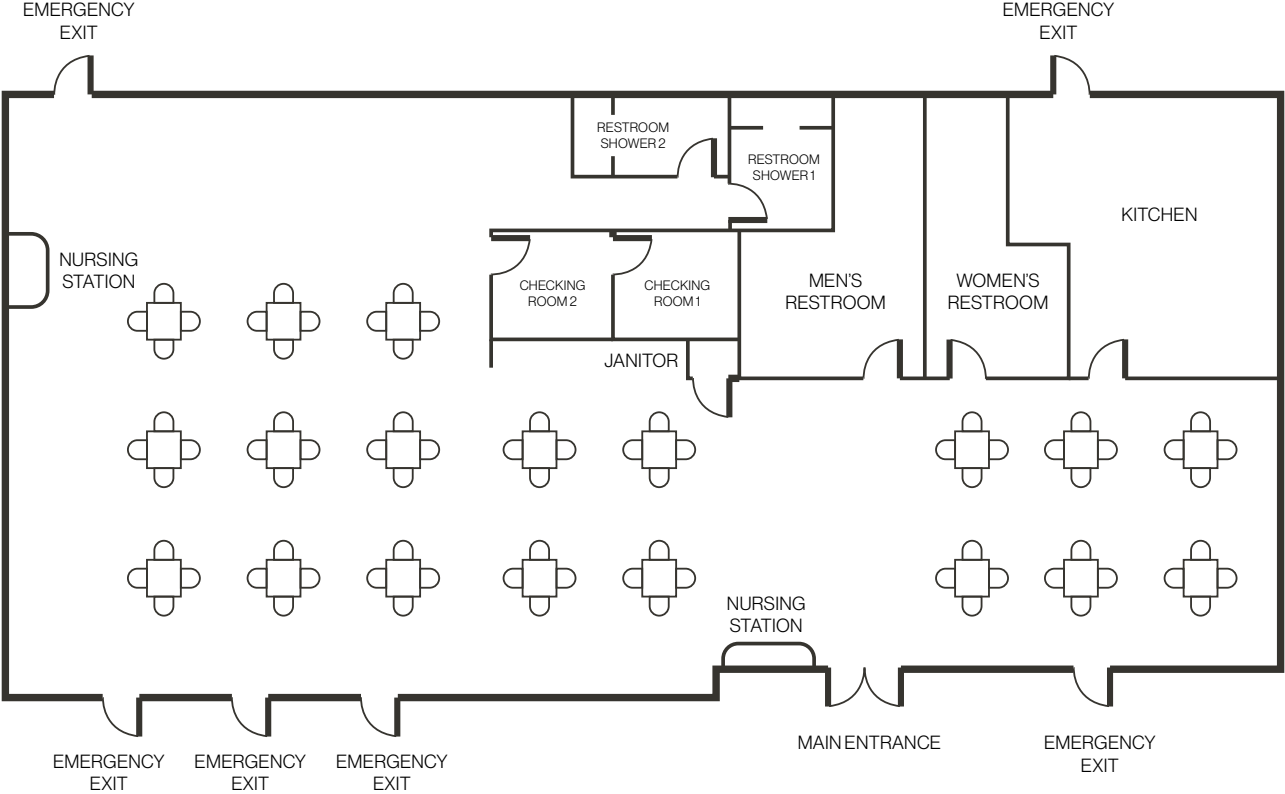

Property Photos



LOGIC Commercial Real Estate

Specializing in Brokerage and Receivership Services



Join our email list and
connect with us on LinkedIn

The information herein was obtained from sources deemed reliable; however LOGIC Commercial Real Estate makes no guarantees, warranties or representation as to the completeness or accuracy thereof.

For inquiries please reach out to our team.

Joanna Zirbes, CCIM
Vice President
702.954.4163
jzirbes@logicCRE.com
S.0184741

Brendan Leake
Senior Associate
702.954.4132
bleake@logicCRE.com
S.0178140