

MOUNTAIN INDUSTRIAL CENTER

LEASE  
RATE

*\$1.25 /SF/MONTH, NNN (\$0.30)*

# MOUNTAIN INDUSTRIAL CENTER

*Available Now For Lease: ±2,976 - 20,998 SF*

3411 90TH ST S, LAKEWOOD, WA 98499

MATT MCLENNAN, SIOR, CCIM  
253.722.1458  
matt.mclennan@kidder.com

LAURA FOX, CCIM  
253.722.1441  
laura.fox@kidder.com

KIDDER.COM

 **Kidder  
Mathews**

# MOUNTAIN INDUSTRIAL CENTER



## PROPERTY OVERVIEW

	±2,976 SF
BAY SIZES AVAILABLE	±3,059 SF (Can be combined for up to ±20,998 SF)
GRADE LEVEL DOORS	14' x 12'
CLEAR HEIGHT	21' - 26' (pitched roof)
OFFICE SPACE	Build-to-suit
BASE RENT (MONTHLY)	\$1.25 + NNN
NNN	Est. \$0.30/SF
ZONING	Industrial (AC-2) APZ-11 Overlay → LAND USE TABLE → ZONING CODE → ZONING CODE

KIDDER.COM

This information supplied herein is from sources we deem reliable. It is provided without any representation, warranty, or guarantee, expressed or implied as to its accuracy. Prospective Buyer or Tenant should conduct an independent investigation and verification of all matters deemed to be material, including, but not limited to, statements of income and expenses. Consult your attorney, accountant, or other professional advisor.



# MOUNTAIN INDUSTRIAL CENTER



*3 MIN*

TO I-5

*5 MIN*

TO SR-512

*15 MIN*

TO PORT OF TACOMA

*30 MIN*

TO SEATAC AIRPORT

84TH ST S

TO I-5

SUBJECT  
PROPERTY

S HOSMER ST

TACOMA

96TH ST S

LAKEVIEW AVE SW

S TACOMA WAY

TO HWY-512

LAKWOOD

512

5



[KIDDER.COM](http://KIDDER.COM)

This information supplied herein is from sources we deem reliable. It is provided without any representation, warranty, or guarantee, expressed or implied as to its accuracy. Prospective Buyer or Tenant should conduct an independent investigation and verification of all matters deemed to be material, including, but not limited to, statements of income and expenses. Consult your attorney, accountant, or other professional advisor.



# PROPOSED DIVISION 1

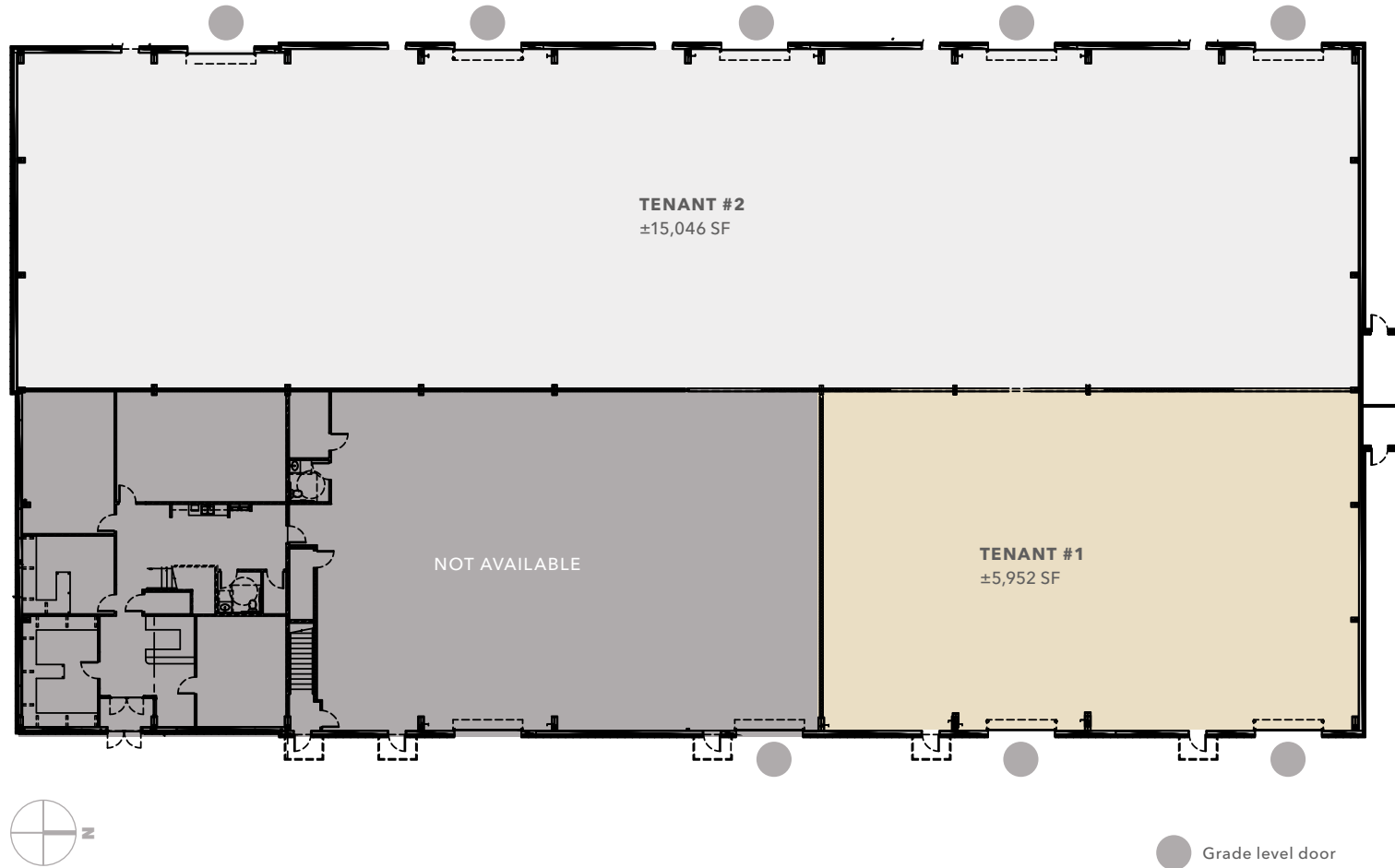

# PROPOSED DIVISION 2

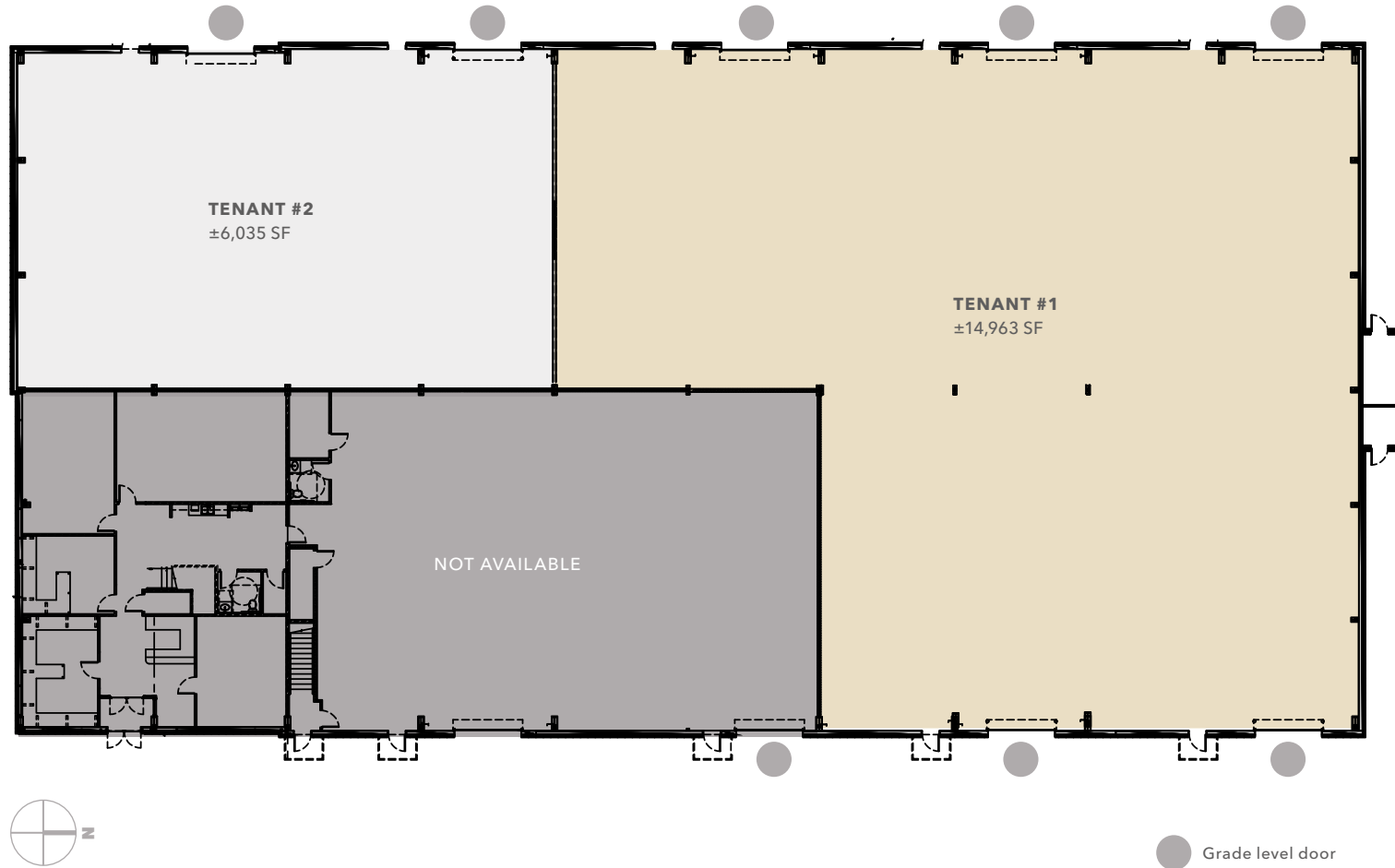

# PROPOSED DIVISION 3

