

11010 S. Tryon St., Charlotte, NC

Receiver Sale /Second Generation Dentist Office / For Sale



Property Highlights

- 6,225 Square Feet
- South Tryon Street Frontage
- Full Medical/ Dental Build-Out
- All Equipment, FF&E Available
 - Move in Ready
 - Abundant Parking
- Please Call for Sales Information

Contact:

The Liberty Solution, LLC
1464 Center Park Drive
Charlotte, NC 28217
Brian Gribble
704.301.4969
bgribble@lscarolinas.com



11010 S. Tryon St., Charlotte, NC

Second Generation Dentist Office / Condo



This dental space boasts 6,225 square feet previously occupied by a pediatric dentistry and orthodontics practice. The space is move-in ready and is also built out to easily accommodate two practices. Great opportunity for dentists or specialists interested in starting or expanding their existing dental practice.

Contact:
Brian Gribble- 704.301.4969
bgribble@lscarolinas.com



11010 S. Tryon St., Charlotte, NC

Dental Office Condo/ 6,250 sf For Sale/ Location Map

Steele Creek Business Park

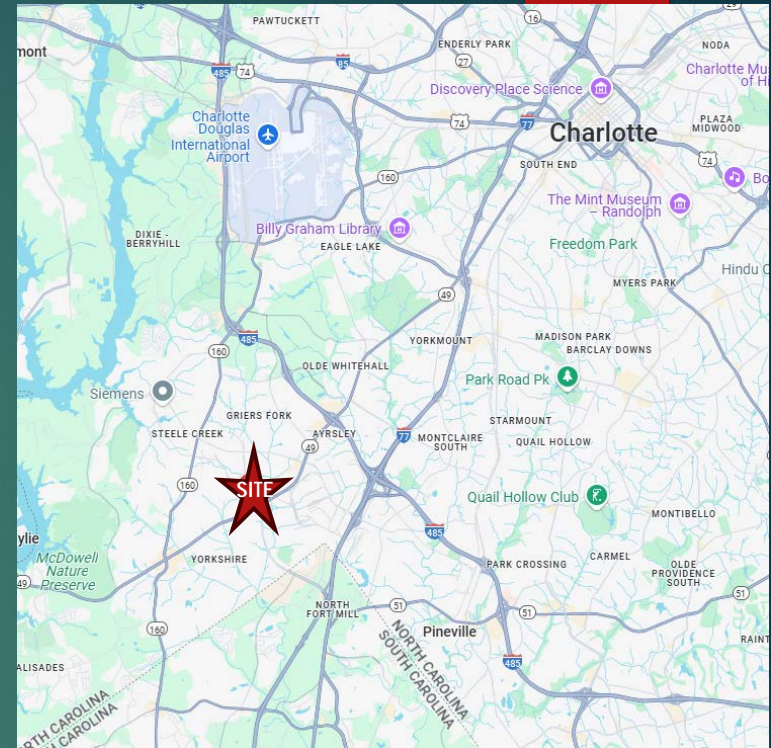

The Steele Creek Business Park is a professionally managed and maintained facility which provides a mix of business and healthcare specialties that serve Charlotte's Steele Creek submarket. The property is surrounded by retail /restaurants and has easy access to I-77 and I-485.

Contact:
Brian Gribble- 704.301.4969
bgribble@lscarolinas.com



Second Generation Dentist Office / Floorplan

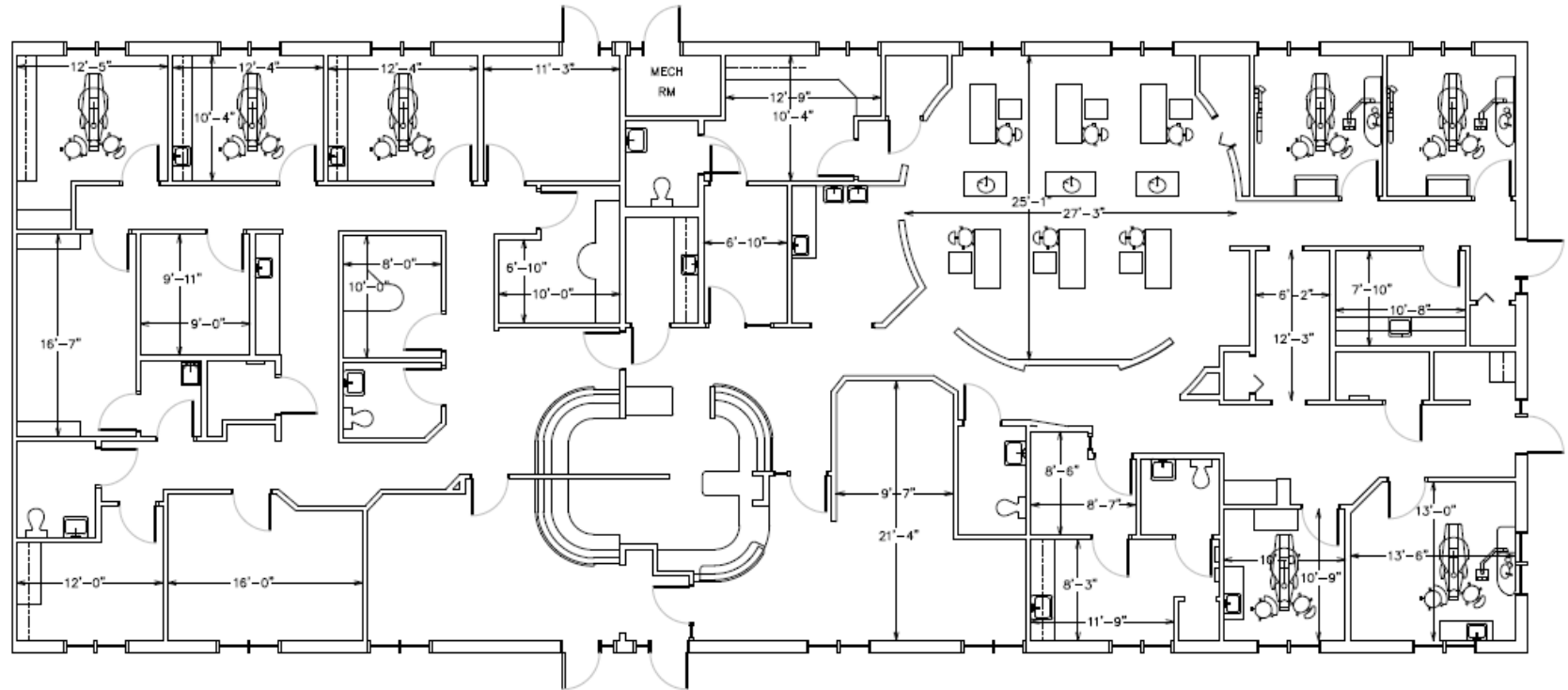

11010 S TRYON ST
SUITE 101, 102 AND 108
6,225 TOTAL GROSS SF