

Finished Square Footage

- 1st Floor:1787 Sq. Ft.

Unfinished Square Footage

- Bonus Room:326 Sq. Ft.
- Garage/Storage:521 Sq. Ft.
- Porch:397 Sq. Ft.
- Porch - Screened:181 Sq. Ft.

Additional Specs

- House Dimensions:66' 2" x 66' 8"
 - Great Room:14' 6" x 21' 2"
 - Master Bedroom:12' 4" x 15' 2"
 - Exterior Wall Construction:2x4
 - ** Foundation:Crawlspace
- ** Alternate foundations may be available for an additional charge. See "Plan Prices and Options" listed below.*

Room Information *width x depth x height*

- Foyer :7' 4" x 4' 8" x 8' 0"
- Dining Room (Tray):12' 8" x 12' 0" x 9' 7"
- Great Room (Cathedral):14' 6" x 21' 2" x 13' 10"
- Kitchen :10' 6" x 13' 6" x 8' 0"
- Breakfast Room :8' 6" x 9' 6" x 8' 0"
- Utility Room :8' 0" x 8' 10" x 8' 0"
- Bonus Room :14' 2" x 17' 10" x 8' 0"
- Garage :20' 4" x 24' 4" x 0' 0"
- Master Bedroom (Cathedral):12' 4" x 15' 2" x 13' 0"
- Bedroom / Study (Cathedral):11' 8" x 12' 0" x 11' 5"
- Bedroom #2 :10' 6" x 11' 4" x 8' 0"
- Porch - Front :26' 0" x 6' 4" x 0' 0"
- Porch - Left :6' 4" x 17' 6" x 0' 0"
- Porch - Screen :14' 0" x 12' 0" x 0' 0"

Floor Plans

FIRST

FLOOR PLAN
PLAN NO. 377

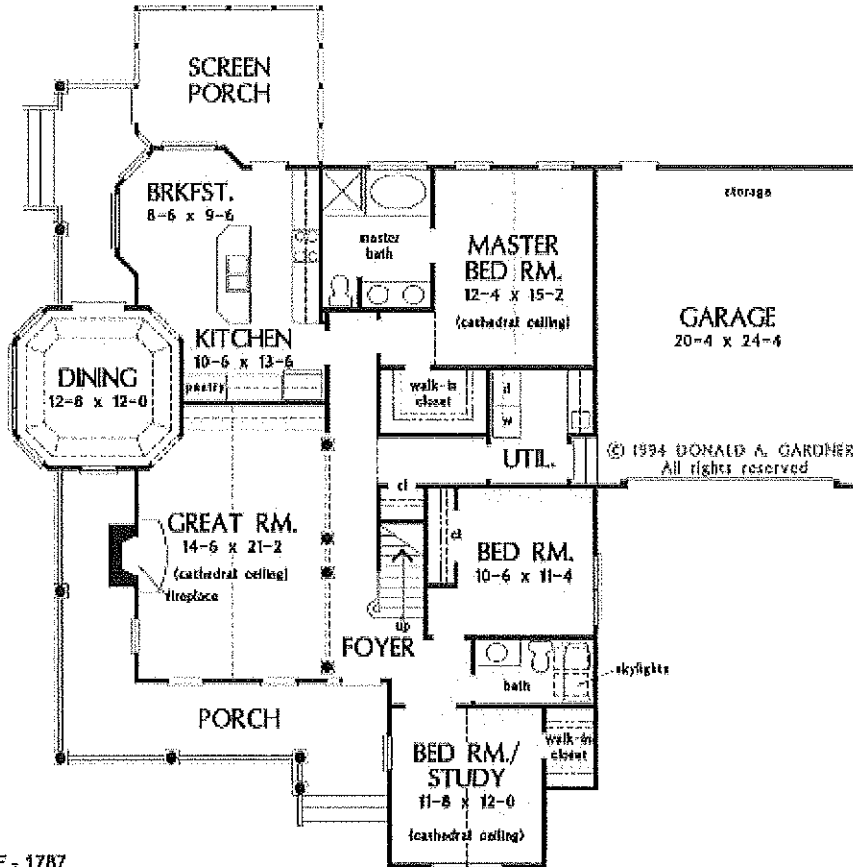

TOTAL SF - 1787
66'2" W X 66'8" D
MAIN LEVEL SF - 1787

BONUS

FLOOR PLAN
PLAN NO. 377

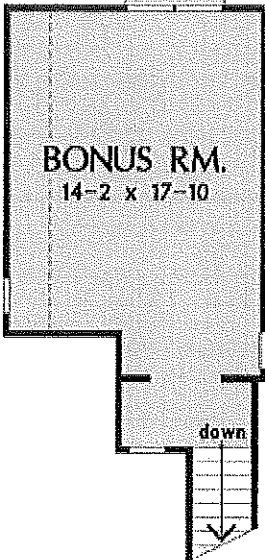

BONUS ROOM
OPTIONAL BONUS ROOM SF - 326