



Rendering

**205 THIRD AVENUE** – Northeast Corner of East 18th Street

GRAMERCY PARK RETAIL/MEDICAL SPACE FROM 1,820 SF TO 2,323 SF

LOCATED IN PROXIMITY OF UNION SQUARE, STUYTOWN & MAJOR HEALTHCARE FACILITIES

## Square Footage

Retail A (corner): 1,820 sf  
Retail B (inline): 503 sf  
Total: 2,323 sf

## Frontage on 3rd Avenue

Retail A: 26 ft.  
Retail B: 18 ft.

Possession: Immediate  
Rent: Upon request

## Comments

- All dry and non-vented food uses considered
- Ideal for medical/wellness, dental, hair/nail salon, boutique fitness, beauty/cosmetics
- Located in dense residential area at the base of 326-unit co-op building and two blocks from new 52-unit condominium currently under construction
- 8 Minute walk from the **N Q R W 4 5 6 L** trains at Union Square and 5 minute walk from 3rd Avenue **L** station at 14th Street
- Close proximity to NYU College of Dentistry, Memorial Sloan-Kettering, Stuyvesant Town/Peter Cooper Village, New York Eye & Ear, The Police Academy
- Area retail includes Chase Bank, Jetset Pilates, Gramercy Bagels, Cleo Nail Salon, Winsome Wines, MHMY Vision, Janovic Hardware, Westside Market, Starbucks, Gramercy Kitchen, Imagine Smile Design, Gramercy Pediatric Dentistry, Sunny's Wine & Spirits, Royal Window Treatments

## By the Numbers

Retail Businesses

**4,127**

1 Mile Radius

Households

**135,285**

2024 Estimate

Avg. Household Income

**\$148,415**

2024 Average

Subway Ridership

**21,527,757**

2023 Annual - Union Square Station



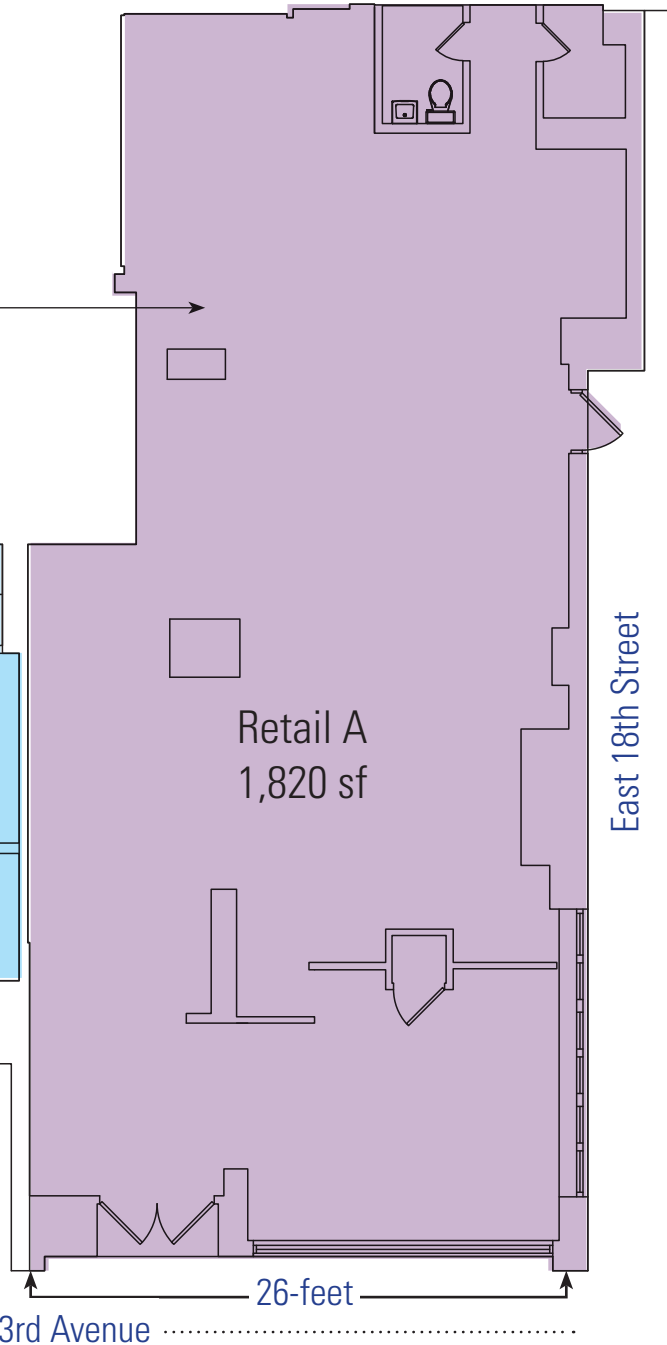
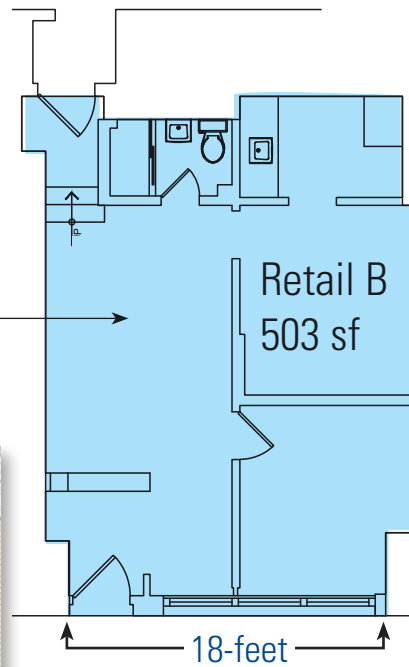

E 22nd Street



E 21st Street

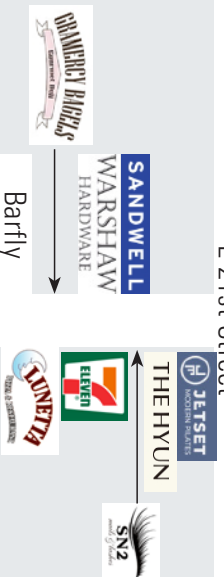

E 20th Street

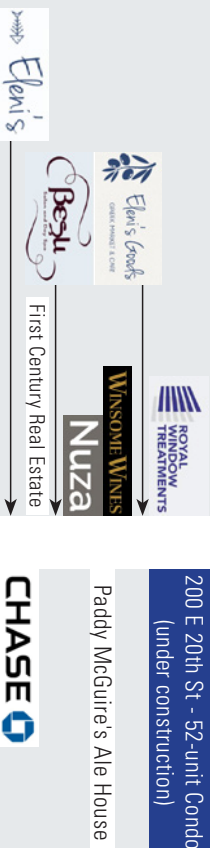

E 19th Street

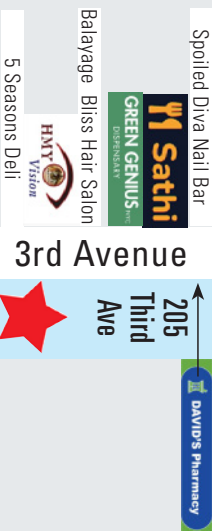

E 18th Street

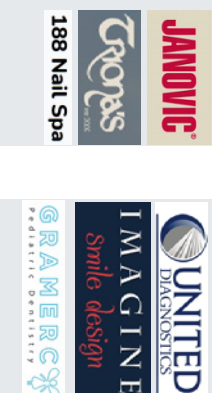

E 17th Street

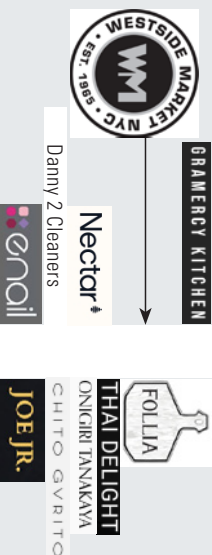

E 16th Street

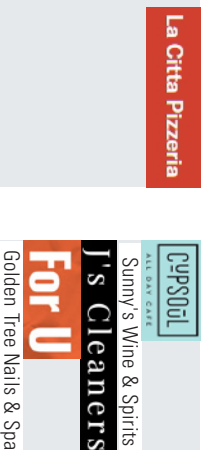

E 15th Street



E 14th Street





For further information and/or inspection contact exclusive broker:

**Mark Tergesen**

Partner

212.400.9528

mt@absre.com

**Cooper Katz**

Executive Director

646.439.2009

ckatz@absre.com

**Quinn Reavy**

Associate

212.400.6064

qreavy@absre.com

ABS Partners Real Estate • 200 Park Avenue South, 10th Floor, New York, NY 10003 • 212.400.6060 • [www.absre.com](http://www.absre.com)