

# 44,469 SF

Industrial Space For Lease



## Prologis Commerce Business Park



5564 E. 61st Street  
Commerce, CA 90040 USA

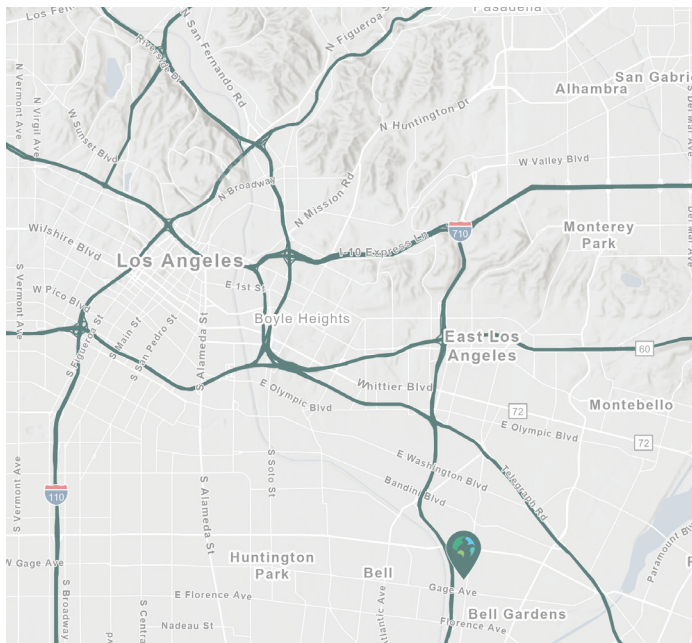

### LOCATION

- Excellent Central Los Angeles Location
- Close Proximity to 710 and 5 Freeways
- Approximately 8 miles to Downtown Los Angeles
- Approximately 20 Miles to Ports of Los Angeles & Long Beach

### FACILITY

- Class "A" Corporate Headquarters Facility
- 82,688 SF Building
- 44,469 SF Available
- 2,310 SF Corporate Offices  
2 Pods (1,155 SF & 1,155 SF)
- 30' Clearance
- 6 Dock High Positions
- ESFR Sprinklers
- 400 Amps, 277/480 Volts
- 22 Car Parking Stalls

### ADVANTAGES AND AMENITIES

- Prologis Park Environment

**Your single-source service for efficient move-in and operations: [prologisessentials.com](https://www.prologisessentials.com)**

# 44,469 SF

Industrial Space For Lease



## Prologis Commerce Business Park

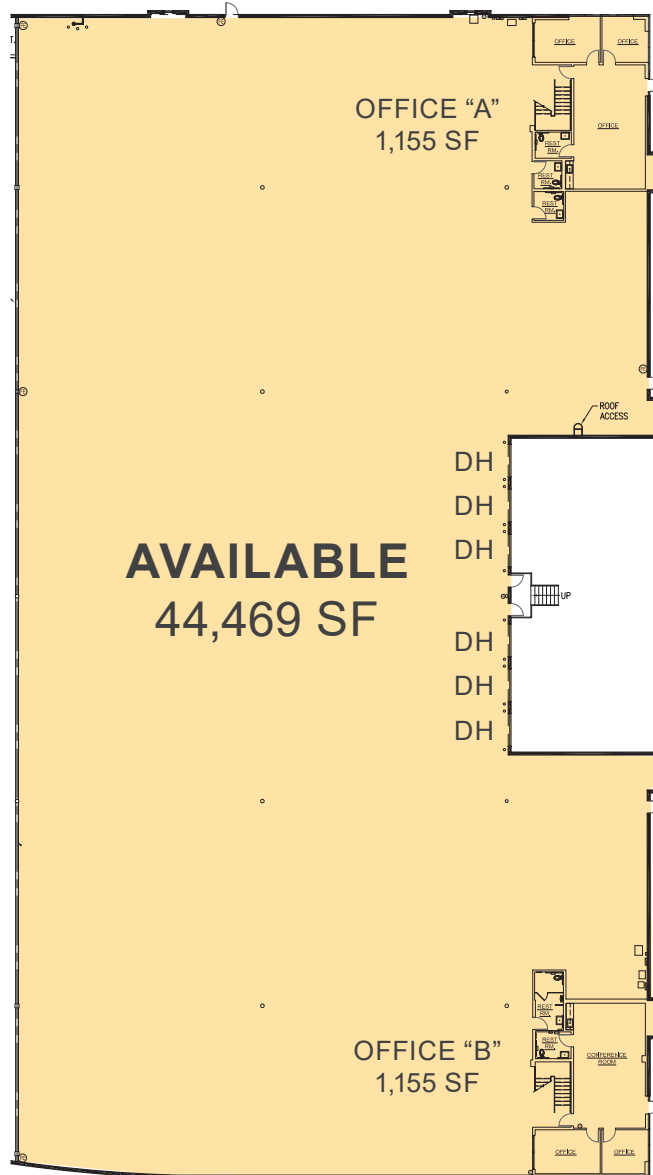

## NEWMARK

### Newmark

John McMillan  
john.mcmillan@nmrk.com  
CalDRE License #01103292  
ph +1 310 491 2048  
2301 Rosecrans Avenue  
Suite 4100  
El Segundo, CA 90245 USA

### Newmark

Jeff Sanita  
jeff.sanita@nmrk.com  
CalDRE License #01242202  
ph +1 310 491 2003  
2301 Rosecrans Avenue  
Suite 4100  
El Segundo, CA 90245 USA

### Newmark

Joey Farney  
joey.farney@nmrk.com  
CalDRE License #02218932  
ph +1 310 491 2007  
2301 Rosecrans Avenue  
Suite 4100  
El Segundo, CA 90245 USA

### Newmark

Andrew Conroy  
andrew.conroy@nmrk.com  
CalDRE License #02143325  
ph +1 310 491 2085  
2301 Rosecrans Avenue  
Suite 4100  
El Segundo, CA 90245 USA

### Prologis

Analise Guttman  
aguttmann@prologis.com  
CalDRE License #01966053  
ph +1 562 345 9239  
2141 Rosecrans Avenue  
Suite 1151  
El Segundo, CA 90245 USA

Corporate License #01355491

The distributor of this communication is performing acts for which a real estate license is required. The information contained herein has been obtained from sources deemed reliable but has not been verified and no guarantee, warranty or representation, either express or implied, is made with respect to such information. Terms of sale or lease and availability are subject to change or withdrawal without notice. No warranty or representation, expressed or implied, is made as to the accuracy of the information contained herein, and same is submitted subject to error and omissions.