

890

GROVELAND LANE
LINCOLN, CALIFORNIA



FOR LEASE

±2,155 SF AVAILABLE

SUSAN NELSON

916-367-6352

Susan.Nelson@nmrk.com

RE License #01413052

JOHN NEWTON

t 916.367.6360

John.Newton@nmrk.com

RE License #01360622

- Pad Building in Power Center Anchored by Target, TJ Maxx, Petsmart and Home Depot
- Adjacent to Flourishing Internal Medicine Practice
- One Block from Highway 65 and Ferrari Ranch Road
- Situated in an Area of Strong Residential Growth
- Excellent Demographics

NEWMARK

890

GROVELAND LANE
LINCOLN, CALIFORNIA

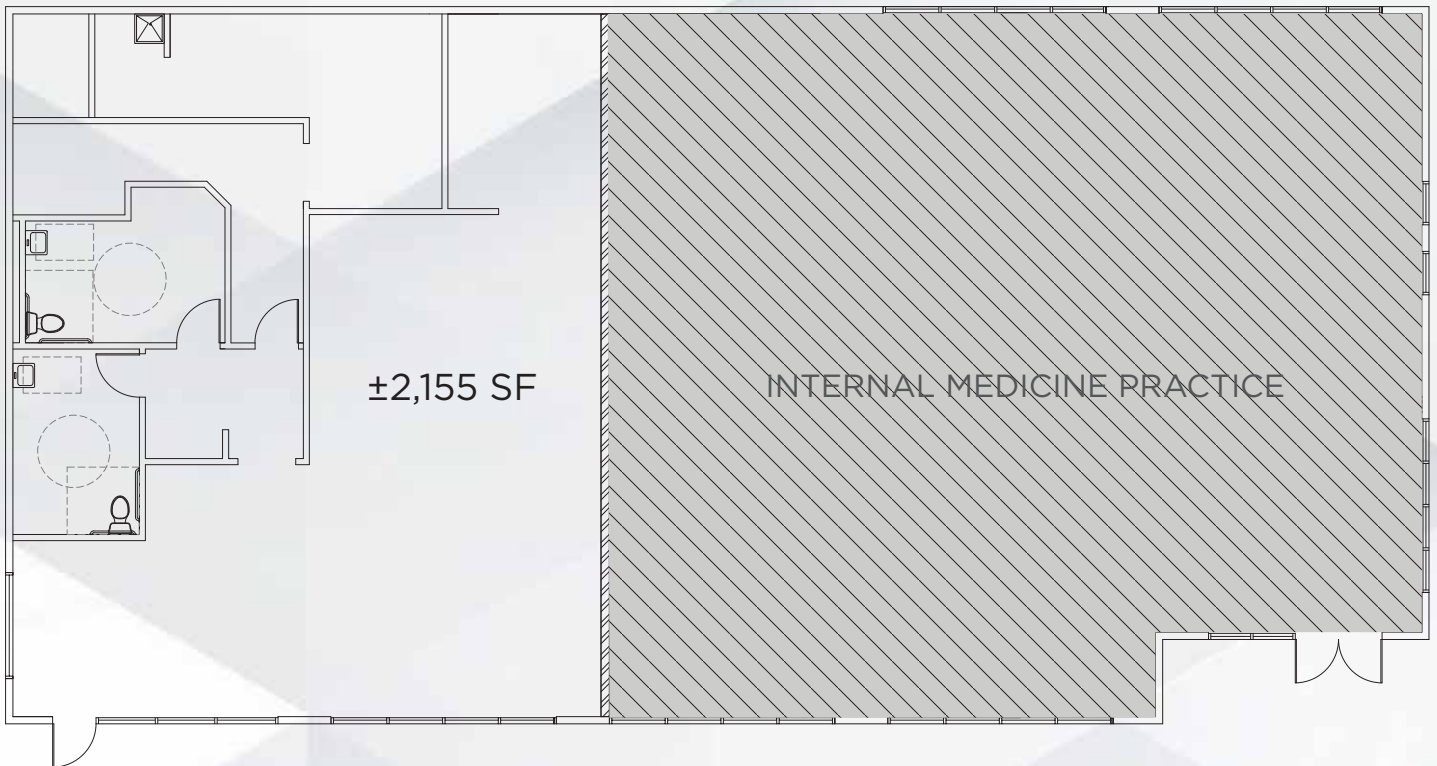

SUSAN NELSON

916-367-6352

Susan.Nelson@nmrk.com

RE License #01413052

JOHN NEWTON

t 916.367.6360

John.Newton@nmrk.com

RE License #01360622

890

GROVELAND LANE
LINCOLN, CALIFORNIA



2023 POPULATION

Within 1 mile: 13,358
Within 3 miles: 51,622
Within 5 miles: 91,368



AVERAGE HOUSEHOLD INCOME

Within 1 mile: \$140,132
Within 3 miles: \$118,770
Within 5 miles: \$133,494



BUSINESSES

296 within 1 mile



EMPLOYEES

1,999 within 1 mile



TRAFFIC COUNTS

At Ferrari Ranch Rd and Groveland Lane:
Avg Daily Volume: 20,888 vehicles

The distributor of this communication is performing acts for which a real estate license is required. The information contained herein has been obtained from sources deemed reliable but has not been verified and no guarantee, warranty or representation, either express or implied, is made with respect to such information. Terms of sale or lease and availability are subject to change or withdrawal without notice. 23-0448.02/24

SUSAN NELSON

916-367-6352

Susan.Nelson@nmrk.com

RE License #01413052

JOHN NEWTON

t 916.367.6360

John.Newton@nmrk.com

RE License #01360622