



## FOR LEASE – OFFICE SPACE

2651 Sagebrush Drive – Suite 116  
Flower Mound, TX

### LOCATION:

This office suite is located in a professional office park off FM 2499 (Long Prairie Road), on Sagebrush Drive.

An ideal location for convenient access to DFW Airport. Great opportunity to have your business in central Flower Mound near restaurants and shopping.

### SIZE:

- Suite 116 – 1,002 RSF

### RATE:

- \$18.75/SF/YR plus NNNs

### ABOUT THIS SPACE:

This suite features an efficient floor plan with a private entrance, four offices, reception area, break area with bar sink, and private restroom.

Monument signage available.

### AVAILABILITY:

- Immediately



### FOR INFORMATION:

Diana Pergande | Phyllis Garcia  
972.899.1851 | [Diana@BridgeRealtyTexas.com](mailto:Diana@BridgeRealtyTexas.com) | [Phyllis@BridgeRealtyTexas.com](mailto:Phyllis@BridgeRealtyTexas.com)  
[www.BridgeRealtyTexas.com](http://www.BridgeRealtyTexas.com)  
400 Parker Square, Suite 270H | Flower Mound, TX 75028

This information is believed to be accurate, but no representation or warranty, express or implied, as to its accuracy or completeness is made by any party. The presentation of this property is submitted subject to errors, omissions, change of price or prior sale or lease, or withdrawal without notice.





# FLOOR PLAN

2651 Sagebrush Drive – Suite 116  
Flower Mound, TX



2651 Sagebrush Drive, Suite 116  
Flower Mound, TX  
1,002 RSF

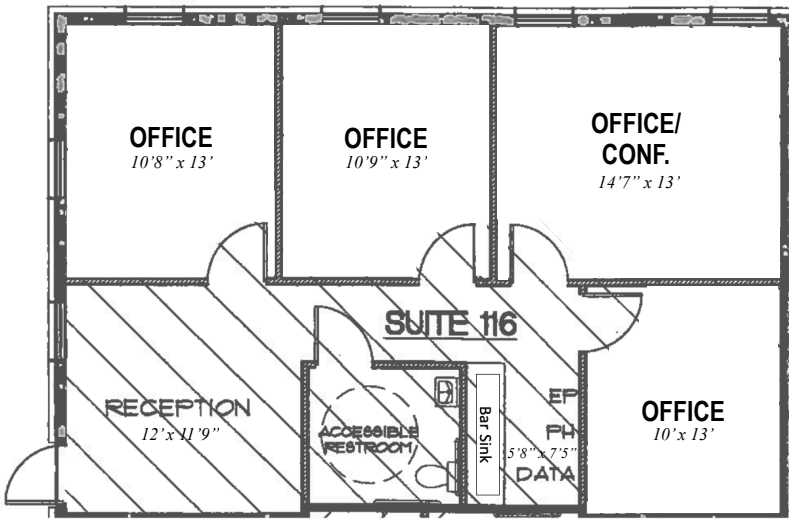

*\*Dimensions shown are approximate wall to wall dimensions*

