

6530 Seville Rd

ISLA VISTA, CA



Steps from
UCSB campus
High pedestrian traffic

For Lease | High-Profile Retail Space in Mixed-Use Building | 1,970 SF

Experience. Integrity. Trust.
Since 1993

Kristopher Roth
805.898.4361
kris@hayescommercial.com
lic. 01482732

Caitlin Hensel
805.898.4374
caitlin@hayescommercial.com
lic. 01893341





PROPERTY SUMMARY

Prominent retail or restaurant space near Spudnuts Donuts in ICON Gardens, a high-profile mixed-use project in the heart of Isla Vista housing 140 students. Located on one of the busiest bike and pedestrian routes to UCSB campus.

Size 1,970 SF

Rate \$2.50 NNN (.83)

Available Now

Term 5 years

Restrooms Yes

Parking Street and bike parking. (On-site parking spaces available for rent)

To Show Call listing agents

Experience. Integrity. Trust.
Since 1993

Kristopher Roth
805.898.4361
kris@hayescommercial.com
lic. 01482732

Caitlin Hensel
805.898.4374
caitlin@hayescommercial.com
lic. 01893341





Experience. Integrity. Trust.
Since 1993

Kristopher Roth
805.898.4361
kris@hayescommercial.com
lic. 01482732

Caitlin Hensel
805.898.4374
caitlin@hayescommercial.com
lic. 01893341



FLOOR PLAN

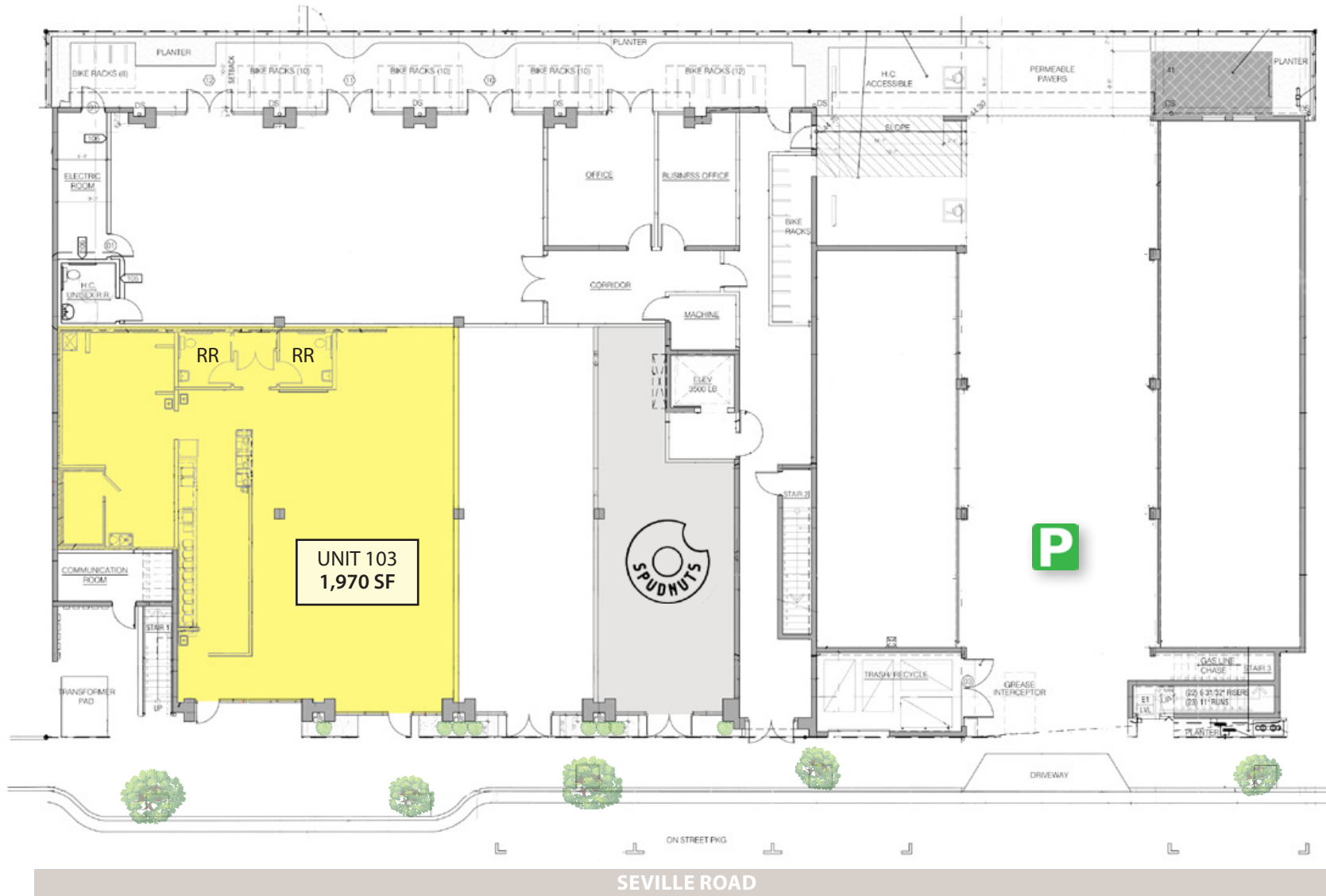

*Floorplan is not to scale

Experience. Integrity. Trust.
Since 1993

Kristopher Roth
805.898.4361
kris@hayescommercial.com
lic. 01482732

Caitlin Hensel
805.898.4374
caitlin@hayescommercial.com
lic. 01893341



Neighborhood Overview



- | | | | |
|---|--------------------|---------------------------|-------------------------|
| 1. 7-Eleven | 9. Super Cuca's | 18. Hummus Republic | 27. Isla Vista Market |
| 2. Amazon Hub, IV Pizza Pub, Sizzling Lunch | 10. Dublin's Grill | 19. Varsity Bike Shop | 28. Domino's Pizza |
| 3. The Loop Apartments | 11. Lao Wang | 20. Hana Kitchen | 29. Sushiya Express |
| 4. Isla Vista Theater | 12. The Habit | 21. I.V. Deli Mart | 30. On The Side |
| 5. Spudnuts Donuts | 13. Wingstop | 22. Blenders in the Grass | 31. Deja Vu |
| 6. Poke Theory | 14. Starbucks | 23. Kozy Coffee | 32. Red Pepper Chinese |
| 7. Cajé | 15. Freebirds | 24. Poke Ceviche | 33. Naan Stop |
| 8. Woodstock's Pizza | 16. Mojo's at ASIA | 25. Dank Bowl Kitchen | 34. IV Food Cooperative |
| | 17. Chase Bank | 26. Giovanni's | 35. IV Bagel Cafe |



Trade Area Demographics

Isla Vista

Population: 15,561

Median Age: 22.3

UCSB

Current Enrollment: 25,034

Source: ESRI 2024, UCSB 2023

Kristopher Roth

805.898.4361

kris@hayescommercial.com

lic. 01482732

Caitlin Hensel

805.898.4374

caitlin@hayescommercial.com

lic. 01893341



Experience. Integrity. Trust.
Since 1993



Ranked #12 in U.S. News & World Report's Top Public Universities

University of California, Santa Barbara (UCSB) is a public institution founded in 1909. It has a total **undergraduate enrollment of 25,034**, its setting is suburban, and the campus size is 989 acres.

Boasting six nobel laureates on faculty, **UCSB is integral to the Goleta community and its largest employer.** Students graduating with degrees in engineering and computer science frequently stay in the area to work for local businesses or start their own.

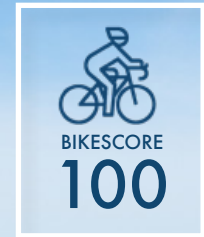

The UCSB campus sits on a south-facing shore and overlooking the Pacific Ocean.

Experience. Integrity. Trust.
Since 1993

Kristopher Roth
805.898.4361
kris@hayescommercial.com
lic. 01482732

Caitlin Hensel
805.898.4374
caitlin@hayescommercial.com
lic. 01893341

