

JOIN NORDSTROM RACK, SPROUTS MARKET, TOTAL WINE & ULTA COSMETICS

SOUTH BAY MARKETPLACE

REDONDO BEACH, CA



CBRE RETAIL SERVICES

Jamie Brooks

Senior Vice President
Lic. 01434718
+1 310 363 4881
jamie.brooks@cbre.com

Sam Aaron

Vice President
Lic. 01828428
+1 310 363 2571
sam.aaron@cbre.com

CBRE

PROPERTY HIGHLIGHTS

- + Located in the heart of The South Bay, Redondo Beach, California
- + Directly Adjacent to South Bay Galleria and Target
- + Anchored by Nordstrom Rack, Sprouts Market, Total Wine, ULTA and Living Spaces (shadow anchored)
- + Prominent monument signage on Hawthorne Blvd
- + Excellent visibility, parking and signaled access on Hawthorne Blvd (±68,900 CPD)
- + Strong daytime and evening population

SOUTH BAY MARKETPLACE

REDONDO BEACH, CA

PROPERTY DESCRIPTION

South Bay Marketplace is located in the Heart of the South Bay's very own Redondo Beach. The development fronts Hawthorne Blvd, one of the highest traveled north/south arterials in the south western region of Los Angeles County, and consists of approximately 117,858 square feet of retail/commercial space. South Bay Marketplace is a half a mile from the Hawthorne Boulevard interchange of Interstate 405, one of the most heavily traveled freeways in the nation. In addition to the property's anchors (Nordstrom Rack, Sprouts, Total Wine and ULTA), which represent 80% of the shopping center, South Bay Marketplace is shadowed by Living Spaces and adjacent to a Target and Ralph's grocer.



HAWTHORNE BLVD. BETWEEN 182ND ST. & ARTESIA BLVD. 68,900 CPD



2021 Estimations	1-Mile	3-Mile	5-Mile
Population	32,819	270,456	588,323
Avg. HH Income	\$120,308	\$132,389	\$122,528
Daytime Population	29,818	2858,851	643,370

SOUTH BAY GALLERIA

Adjacent to the Development is the South Bay Galleria a 955,000-square foot, three-level enclosed regional mall (anchored by Macy's, Kohl's and AMC).

This 30-acre property was recently acquired by Australian Investment Company QIC, and will feature a 150-room hotel, 300 apartments, and an additional 217,000 sq ft of office and retail scheduled to break ground in 2020.



AREA DESCRIPTION

South Bay Marketplace is situated in a part of the southwest region of Los Angeles County known as the South Bay. Located in North Redondo Beach, bordering such cities as Torrance, Manhattan Beach, Hermosa Beach, Lawndale and Hawthorne, South Bay Marketplace is surrounded by both the most affluent and culturally diverse neighborhoods in Los Angeles. The beach cities and the Palos Verdes Peninsula have strong demographics, with Manhattan Beach and Palos Verdes ranking as two of the wealthiest communities in the United States. Torrance is the sixth largest city in Los Angeles County and boasts a healthy and competitive commercial and economic presence in Los Angeles County.

SOUTH BAY MARKETPLACE AERIALS



SOUTH BAY MARKETPLACE AERIALS



SOUTH BAY MARKETPLACE SITE PLAN

SOUTH BAY MARKETPLACE

REDONDO BEACH, CA

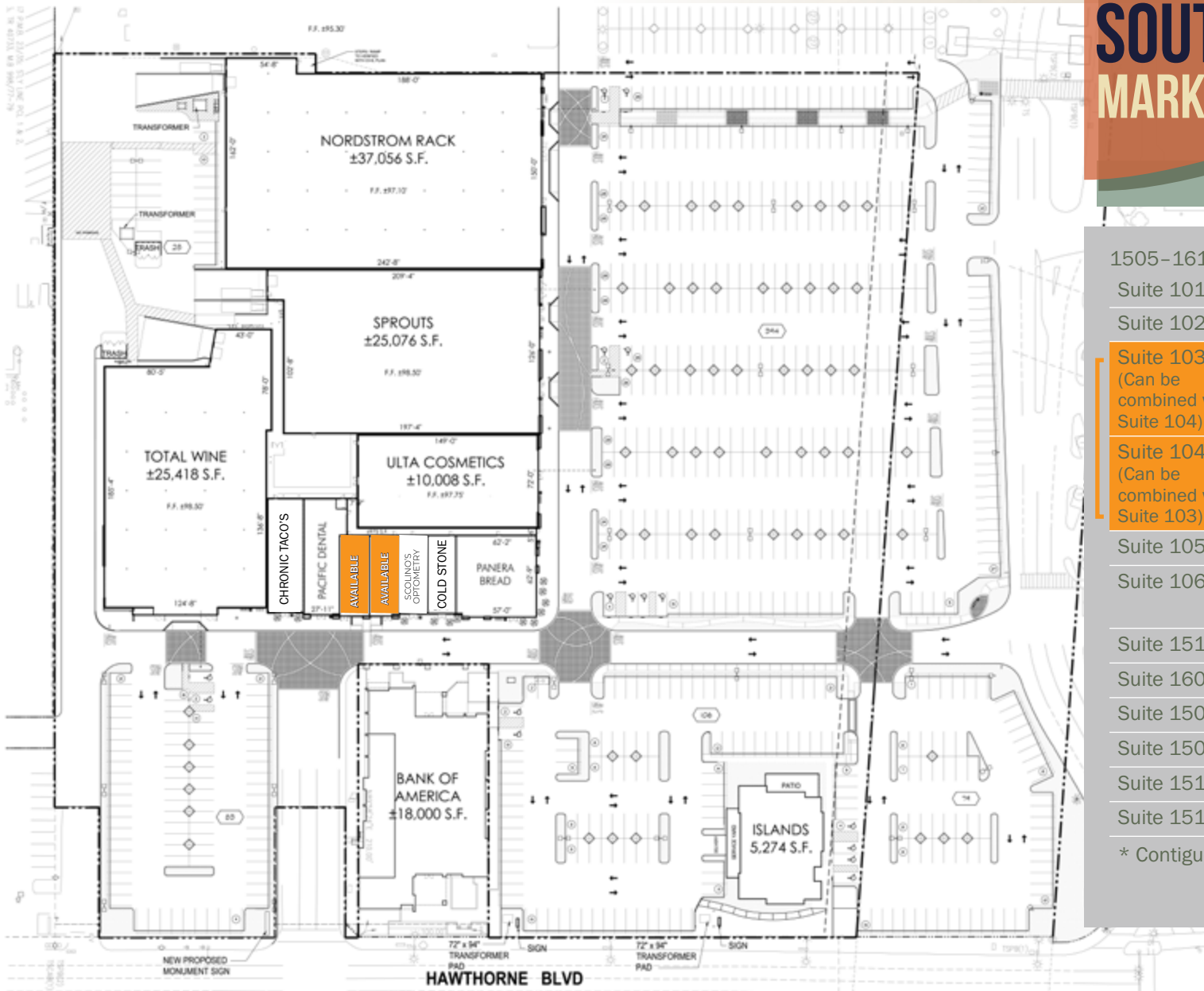

1505-1611 HAWTHORNE BLVD.

Suite 101	Chronic Taco's	±2,482 SF
Suite 102	Pacific Dental	±2,588 SF
Suite 103*	Available (Can be combined with Suite 104)	±1,426 SF
Suite 104*	Available (Can be combined with Suite 103)	±1,415 SF
Suite 105	Scolino's Optometry	±1,336 SF
Suite 106	Cold Stone Creamery	±1,332 SF
Suite 1511	Panera Bread	±3,895 SF
Suite 1609	Islands	±5,274 SF
Suite 1503	Ultra	±10,008 SF
Suite 1505	Total Wine	±25,418 SF
Suite 1515	Sprouts	±25,076 SF
Suite 1517	Nordstrom Rack	±37,056 SF

* Contiguous to ±2,841 SF

SOUTH BAY MARKETPLACE AVAILABILITIES

SOUTH BAY MARKETPLACE

REDONDO BEACH, CA



JOIN NORDSTROM RACK, SPROUTS MARKET, TOTAL WINE & ULTA COSMETICS

SOUTH BAY MARKETPLACE

REDONDO BEACH, CA

SPROUTS
FARMERS MARKET

CBRE RETAIL SERVICES

Jamie Brooks

Senior Vice President

Lic. 01434718

+1 310 363 4881

jamie.brooks@cbre.com

Sam Aaron

Vice President

Lic. 01828428

+1 310 363 2571

sam.aaron@cbre.com

© 2026 CBRE, Inc. All rights reserved. This information has been obtained from reliable sources but has not been verified for accuracy or completeness. CBRE, Inc. makes no guarantee, representation, or warranty and accepts no responsibility or liability for the accuracy, completeness, or reliability of the information contained herein. You should conduct a careful, independent investigation of the property and verify all information. Any reliance on this information is solely at your own risk. CBRE and the CBRE logo are service marks of CBRE, Inc. All other marks displayed on this document are the property of their respective owners, and the use of such marks does not imply any affiliation with or endorsement of CBRE. Photos herein are the property of their respective owners. Use of these images without the express written consent of the owner is prohibited.

CBRE