

851 Napa Valley Corporate Way, Napa

Suite A ~ ±4,900 SF ~ \$1.35/SF/Mo. NNN



- High Ceilings
- 5 Private Offices
- Open Space for Cubicles
- Conference Room
- Single-Story Office
- Very Generous Full-Height Windows
- Separately Metered
- Walking Distance to Dining Options
- Located in the City of Napa
- Bus Stop Nearby



A lease of five years or more will be granted a concession of three months free Base Rent if the lease is signed by the end of 2024. Some suites are divisible to a minimum of ±3,000 SF.

NOTE: Other office suites available of 13,304 SF & 14,245 SF which could be divisible to a minimum of ±3,000 SF. Divisions will affect the price, but will be reasonably negotiated.

Virtual Tour: <https://www.youtube.com/watch?v=LPh30-BTnMQ>

*For up to 5 Years, then 1.5% for any extended term.



Michael Moffett
License #00946472
707.479.1976
mmoffett@cnapavalley.com

1775 Lincoln Ave.
Napa, CA 94558

Cathy Holmes

License #01355085
707.304.3338

cholmes@cnapavalley.com





COLDWELL BANKER
COMMERCIAL
BROKERS
OF THE VALLEY

851 Napa Valley Corporate Way, Napa

Suite A ~ ±4,900 SF ~ \$1.35/SF/Mo. NNN



Michael Moffett
License #00946472
707.479.1976
mmoffett@cnapavalley.com

1775 Lincoln Ave.
Napa, CA 94558

Cathy Holmes

License #01355085
707.304.3338

cholmes@cnapavalley.com





**COLDWELL BANKER
COMMERCIAL**
BROKERS
OF THE VALLEY

851 Napa Valley Corporate Way, Napa

Suite A ~ ±4,900 SF ~ \$1.35/SF/Mo. NNN

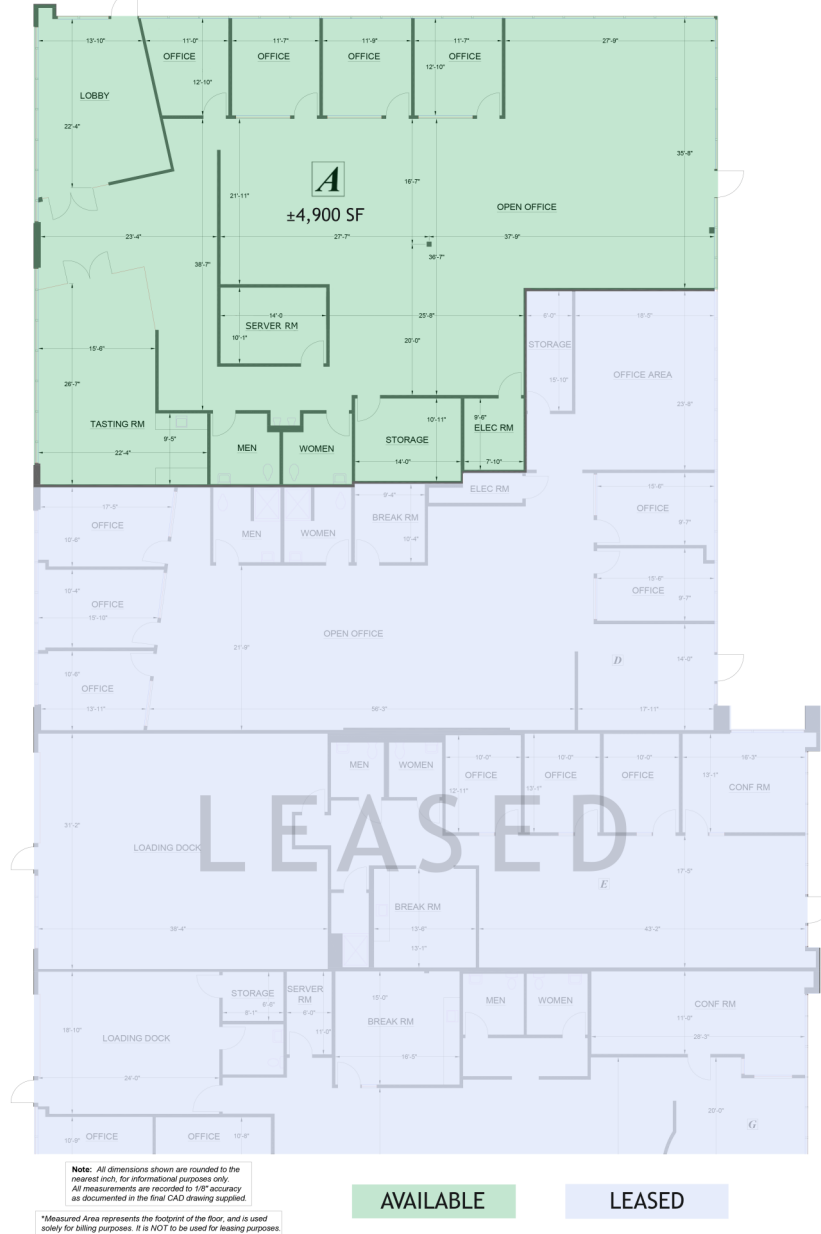

Michael Moffett
License #00946472
707.479.1976
mmoffett@cbnapavalley.com

1775 Lincoln Ave.
Napa, CA 94558

Cathy Holmes

License #01355085
707.304.3338

cholmes@cbnapavalley.com

