



## INDUSTRIAL WAREHOUSE AVAILABLE

**SPACE AVAILABLE**

**24,833 SF**

## 1911 Mountain Industrial Blvd.

Tucker, GA 30084 | Stone Mountain Industrial Park

### HIGHLIGHTS

- 24,833 SF | 2.4 acres
- 21% office
- 22' ceiling height
- 11 dock-high doors | 1 drive-in door
- Fenced and secure truck court with outdoor storage
- 400/480/3-Phase power
- 26 auto spaces
- Frontage on Mountain Industrial Blvd.
- 3 miles from I-285

DAVIS MORELAND

770.913.3919 | [dmoreland@ackermanco.net](mailto:dmoreland@ackermanco.net)

# 1911 Mountain Industrial Blvd.

Industrial Warehouse for Lease – 24,833 SF

Tucker, Georgia, 30084  
Stone Mountain Industrial Park

## SITE PLAN

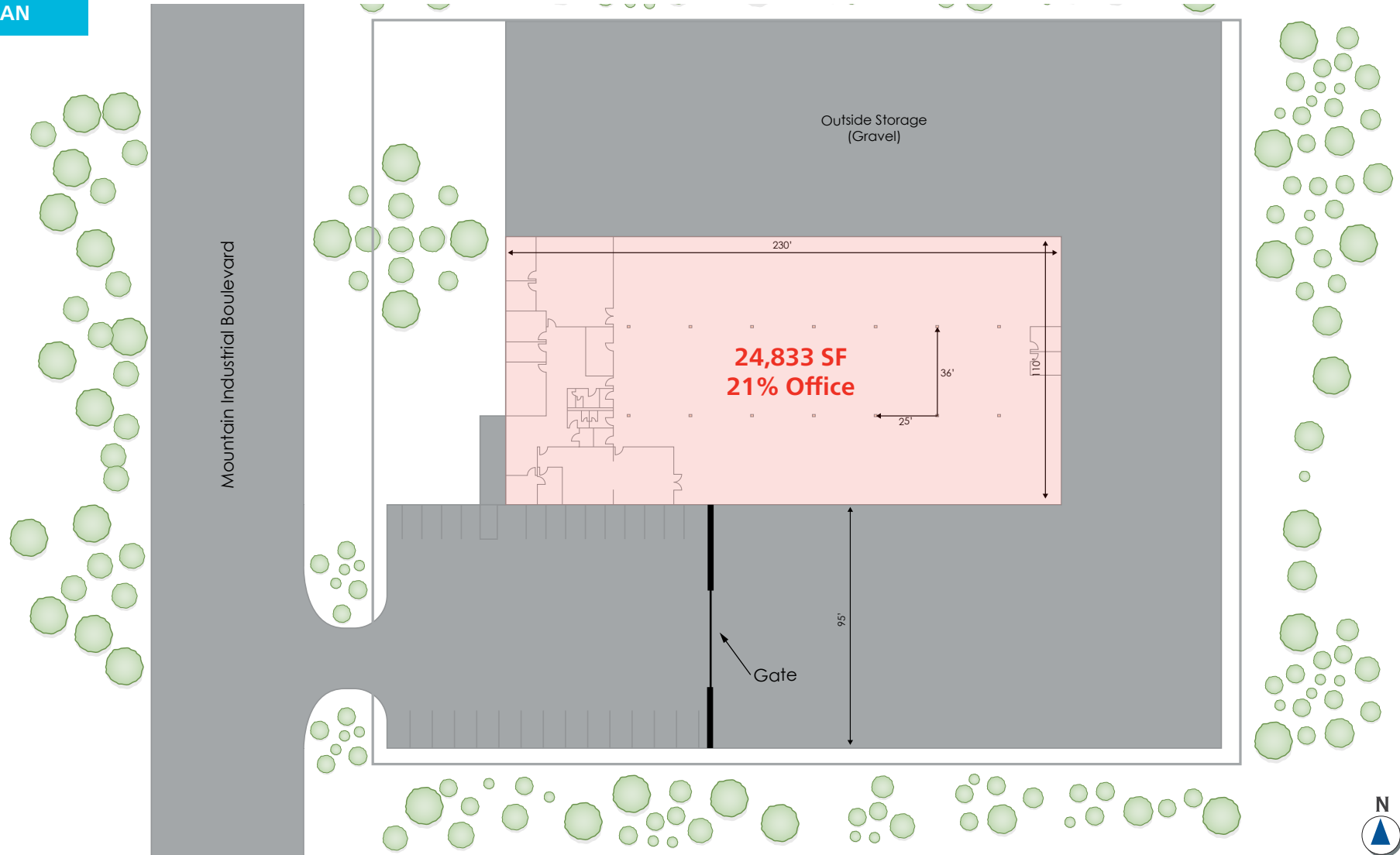

# 1911 Mountain Industrial Blvd.

Industrial Warehouse for Lease – 24,833 SF

Tucker, Georgia, 30084  
Stone Mountain Industrial Park



## Ackerman & Co.

DAVIS MORELAND  
770.913.3919 | [dmoreland@ackermanco.net](mailto:dmoreland@ackermanco.net)

©2026 Ackerman & Co. All rights reserved. While we have no reason to doubt the accuracy of the information provided from sources we deem reliable, we cannot guarantee it and therefore assume no liability for errors, omissions or changes to this content.