

RETAIL SPACE AVAILABLE FOR LEASE

LAST
SPACE
AVAILABLE



*Conceptual Storefront Design

1 YEAR FREE BASE RENT | WITH TEN YEAR LEASE
602.252.9300

DOUGLAS CENTER

204 5th Street | Douglas, AZ

SPACE AVAILABLE FOR LEASE:

Suite B ±5,791 SqFt

Rate: **\$8** SF/NNN

For more information please contact:

Jeremy Johnson

Senior Property Manager

602.252.9300

jj@casehuff.com

Professionally Managed & Leased by:



www.casehuff.com

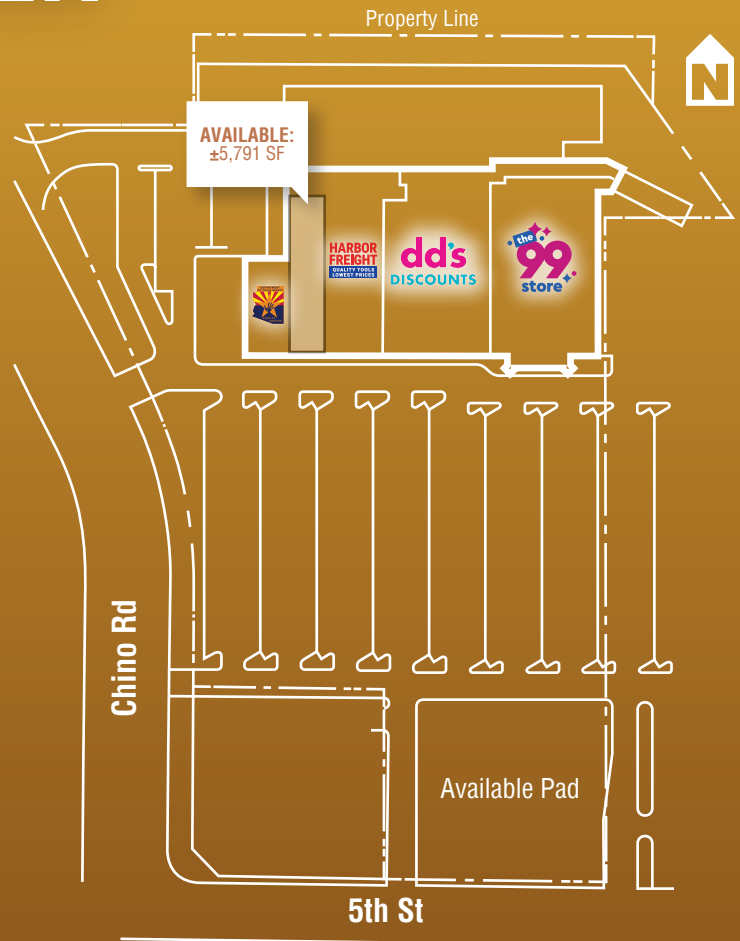

DOUGLAS CENTER

SUITE PLAN

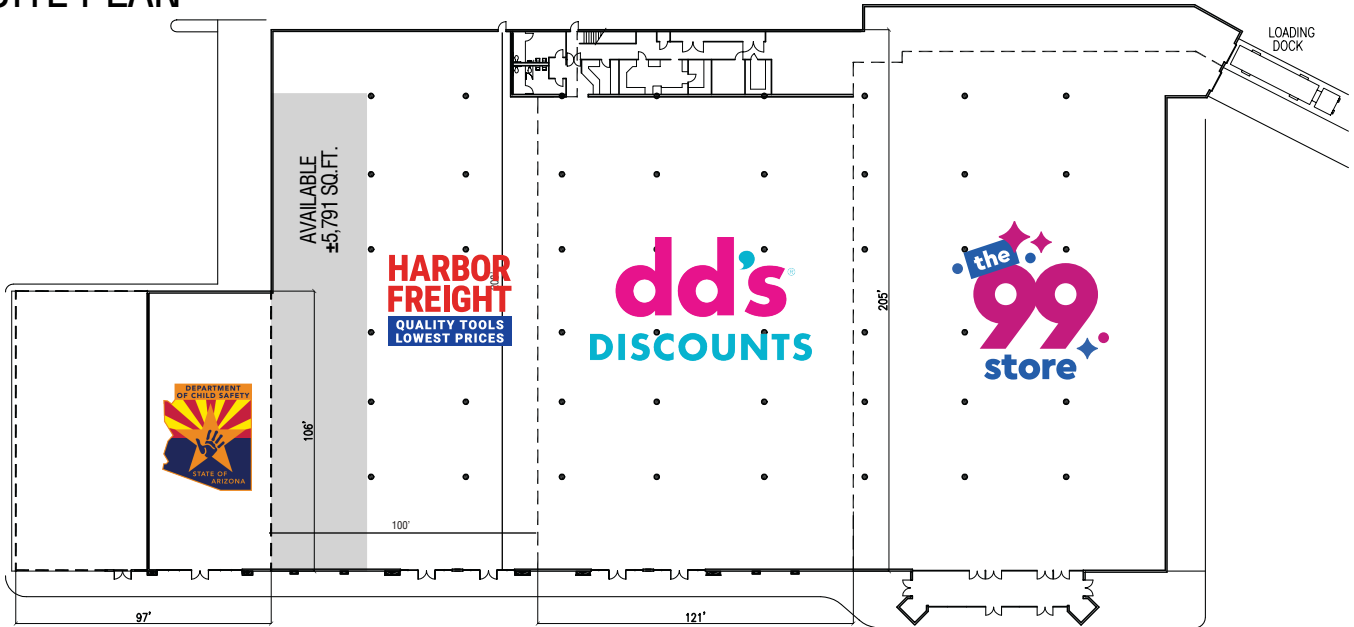

Includes:

- One large suite in a center occupied by DD's Discounts, 99 Cent Only, Harbor Freight and Arizona Department of Child Safety
- Great 7.88/1,000 parking ratio

LAST SPACE AVAILABLE

Space Available for Lease:

Suite B ±5,791 SqFt

1 YEAR FREE | WITH TEN YEAR LEASE
BASE RENT | 602.252.9300

Rate: **\$8** SF/NNN

For more information please contact:

Jeremy Johnson

Senior Property Manager

602.252.9300 | jj@casehuff.com

Professionally Managed & Leased by:



www.casehuff.com

DISCLAIMER: No warranty or representation, express or implied, is made to the accuracy of the information contained herein and same is submitted subject to errors, omissions, change of price, rental or other conditions, withdrawal without notice and to any special listing conditions imposed by our principals.

GARDEN CENTER

CONCEPTUAL DESIGN

END CAP SPACE



*Conceptual Storefront Design

This former Garden Center space can be converted to indoor retail space matching the rest of the center, as shown in the conceptual illustration above.



Existing Space Shown Here

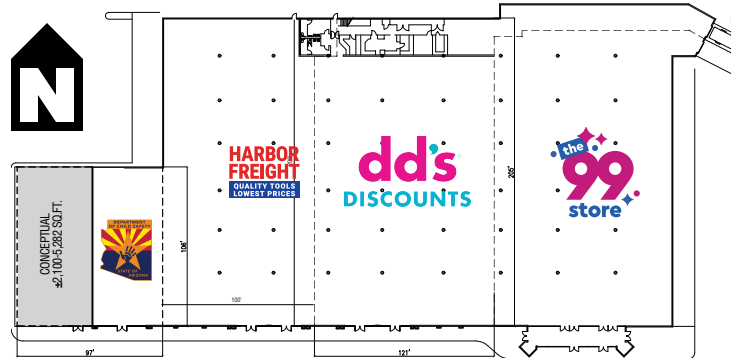

Includes:

- One or two potential suites in a center occupied by DD's Discounts, 99 Cent Only, Harbor Freight and Arizona Department of Child Safety
- Great 7.88/1,000 parking ratio

Space Available for Lease:

Conceptual +/- 2,100-5,282 SqFt

1 YEAR FREE | WITH TEN YEAR LEASE
BASE RENT | **602.252.9300**

For more information please contact:

Jeremy Johnson

Senior Property Manager

602.252.9300 | jj@casehuff.com

Rate: Negotiable

Professionally Managed & Leased by:



www.casehuff.com

DISCLAIMER: No warranty or representation, express or implied, is made to the accuracy of the information contained herein and same is submitted subject to errors, omissions, change of price, rental or other conditions, withdrawal without notice and to any special listing conditions imposed by our principals.

UNDEVELOPED PAD

AVAILABLE BUILD-TO-SUIT

PAD SPACE



This undeveloped pad space is offered build-to-suit with a drive thru option (shown below).

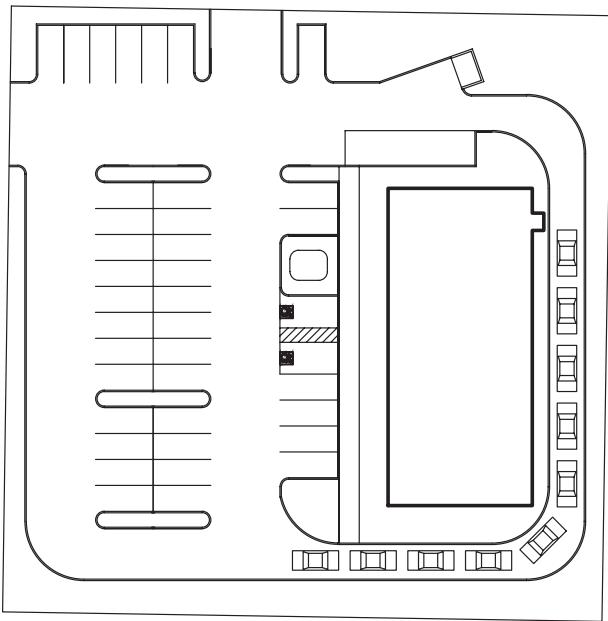

Space Available for Development:
Pad +/- 2,000-5,500 SqFt

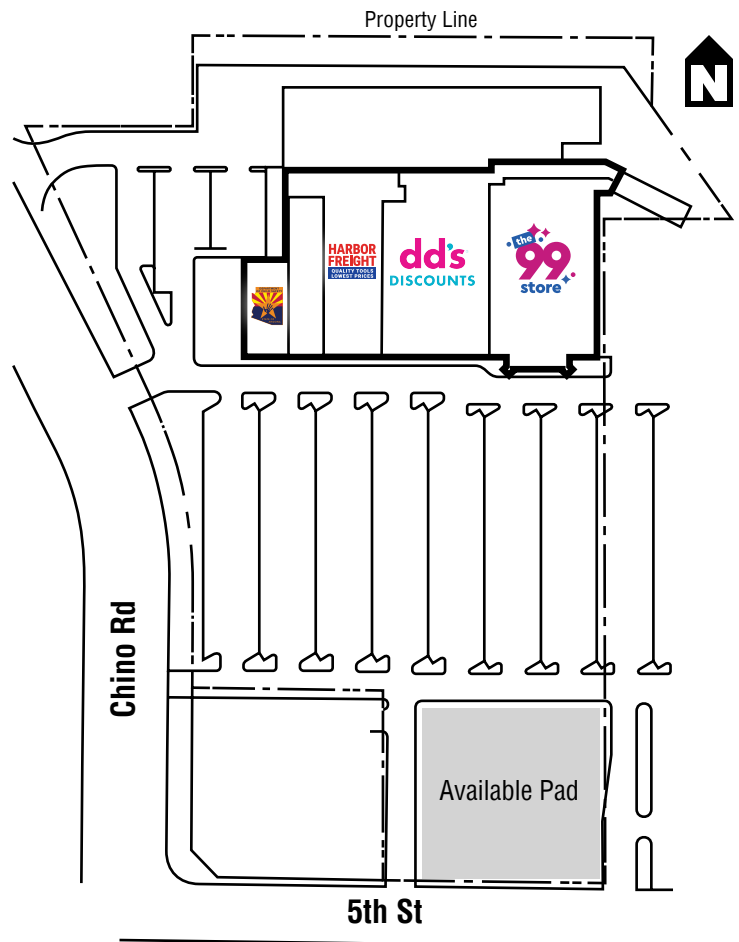

For more information please contact:

Jeremy Johnson
Senior Property Manager
602.252.9300 | jj@casehuff.com

Rate: Negotiable

Professionally Managed & Leased by:



www.casehuff.com

DISCLAIMER: No warranty or representation, express or implied, is made to the accuracy of the information contained herein and same is submitted subject to errors, omissions, change of price, rental or other conditions, withdrawal without notice and to any special listing conditions imposed by our principals.