



**UP TO 20,000 SF AVAILABLE FOR
SUBLEASE**

929 E. PARK AVENUE

LIBERTYVILLE, IL

929 E. PARK AVENUE LIBERTYVILLE, IL

Property Features

Space Available:	20,000 SF
Total Space Size:	52,377 SF
Office Area:	1,465 SF
Building Size:	220,542 SF
Clear Height:	32'
Docks:	5 exterior
Drive-in-doors:	1
Sprinkler:	ESFR
Lighting:	T-5
Sublease Rate:	Subject to Offer



929 E. PARK AVENUE
LIBERTYVILLE, IL

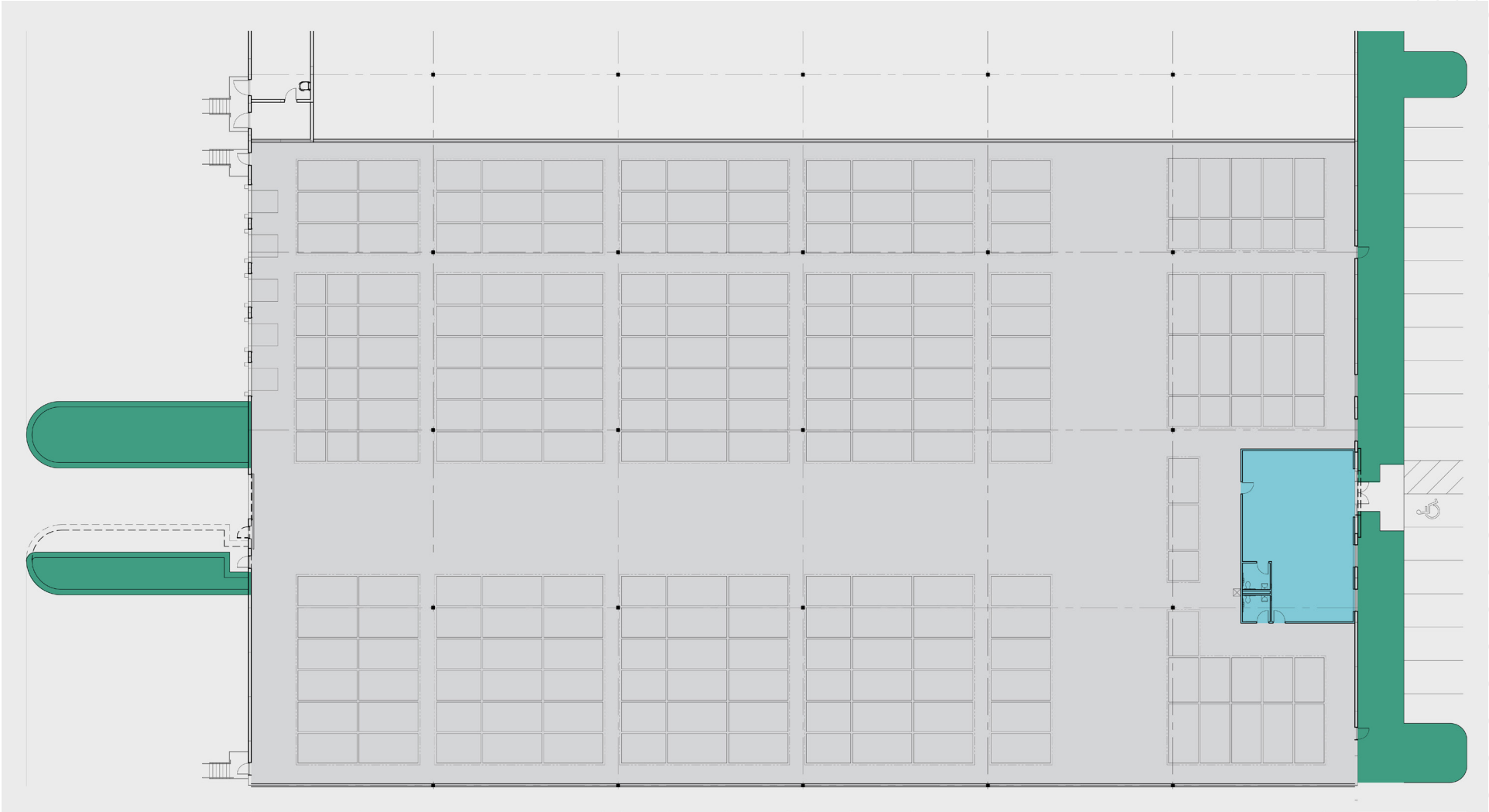

929 E. PARK AVENUE LIBERTYVILLE, IL



FOR MORE INFORMATION, CONTACT:

ERIC FISCHER

Executive Managing Director
+1 847 720 1369
eric.fischer@cushwake.com

KEITH PURITZ

Vice Chair
+1 847 720 1366
keith.puritz@cushwake.com

BRETT KRONER

Vice Chair
+1 847 720 1367
brett.kroner@cushwake.com

MARC SAMUELS

Director
+1 847 720 1368
marc.samuels@cushwake.com

©2024 Cushman & Wakefield. All rights reserved. The information contained in this communication is strictly confidential. This information has been obtained from sources believed to be reliable but has not been verified. NO WARRANTY OR REPRESENTATION, EXPRESS OR IMPLIED, IS MADE AS TO THE CONDITION OF THE PROPERTY (OR PROPERTIES) REFERENCED HEREIN OR AS TO THE ACCURACY OR COMPLETENESS OF THE INFORMATION CONTAINED HEREIN, AND SAME IS SUBMITTED SUBJECT TO ERRORS, OMISSIONS, CHANGE OF PRICE, RENTAL OR OTHER CONDITIONS, WITHDRAWAL WITHOUT NOTICE, AND TO ANY SPECIAL LISTING CONDITIONS IMPOSED BY THE PROPERTY OWNER(S). ANY PROJECTIONS, OPINIONS OR ESTIMATES ARE SUBJECT TO UNCERTAINTY AND DO NOT SIGNIFY CURRENT OR FUTURE PROPERTY PERFORMANCE.

