

# 511 North Elm Street

JENKS, OK 74037

FOR LEASE | 7,000± SF

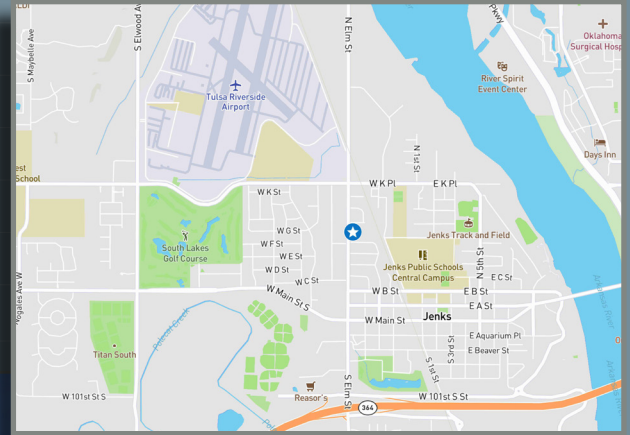

## Property Features

- 7,000± SF Total
- 750± SF Office Area
- (3) Private Offices
- Restrooms Include Showers
- Light Industrial or Storage Use
- (4) 14' x 14' Drive In Doors (w/Auto Openers)
- Located in Fenced Area with Gate Code Access
- 13'09" to 19' Clear Height
- Clear Span Building
- Gas Unit Heaters
- Central Jenks Location
- ±1 Mile to Riverside Airport
- ±1 Mile to Creek Turnpike
- Divisible for Storage Use

# Floor Plan

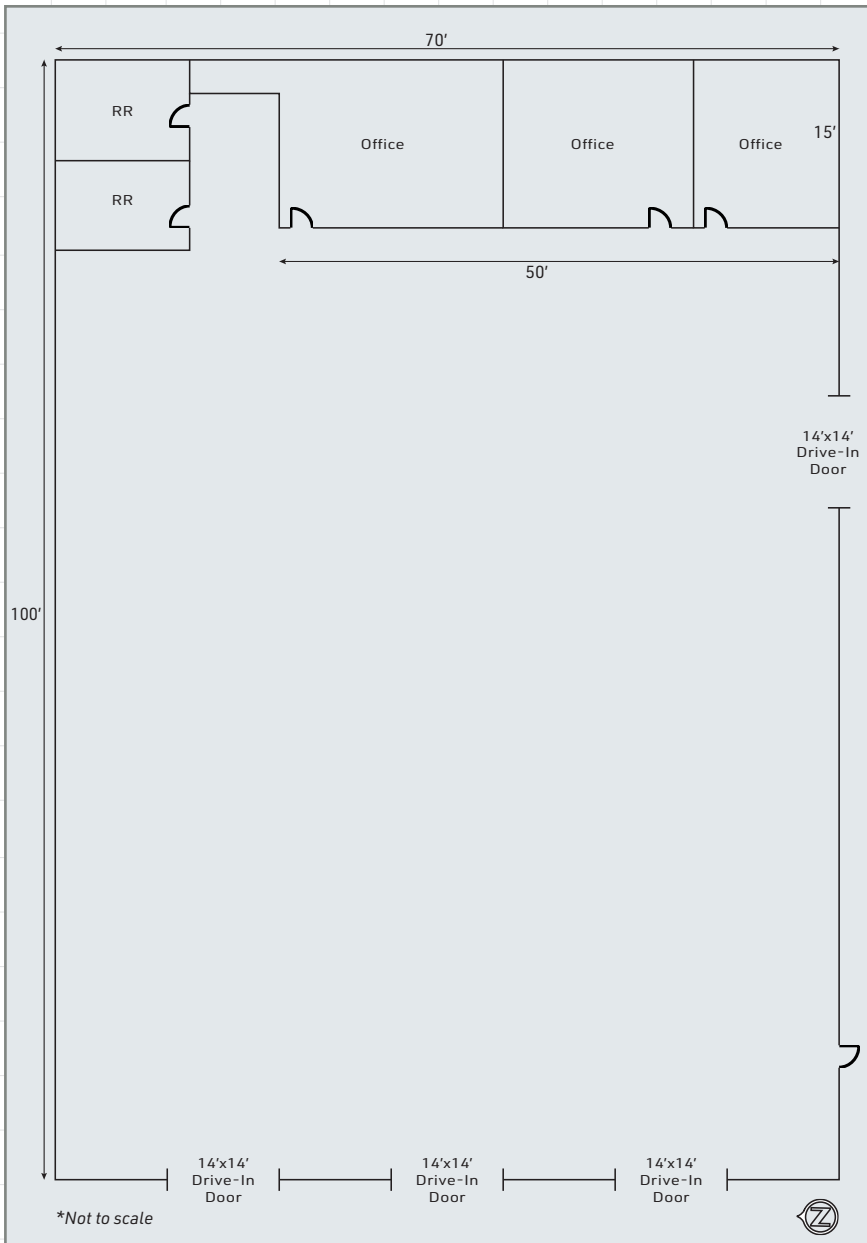

**Tony Aaronson**  
Senior Associate  
+1 918 392 7257  
tony.aaronson@cbre.com

**Dwayne Flynn, SIOR, CCIM**  
Senior Vice President  
+1 918 392 7249  
dwayne.flynn@cbre.com

**Ryan Shaffer, SIOR, CCIM**  
First Vice President  
+1 918 392 7203  
ryan.shaffer@cbre.com

© 2026 CBRE, Inc. All rights reserved. This information has been obtained from sources believed reliable but has not been verified for accuracy or completeness. CBRE, Inc. makes no guarantee, representation or warranty and accepts no responsibility or liability as to the accuracy, completeness, or reliability of the information contained herein. You should conduct a careful, independent investigation of the property and verify all information. Any reliance on this information is solely at your own risk. CBRE and the CBRE logo are service marks of CBRE, Inc. All other marks displayed on this document are the property of their respective owners, and the use of such marks does not imply any affiliation with or endorsement of CBRE. Photos herein are the property of their respective owners. Use of these images without the express written consent of the owner is prohibited.

**CBRE**