

PROPERTY FEATURES

FOR LEASE

914 E. HOLT BLVD. ONTARIO, CA 91761



LOT SIZE:
±35,640 sq.ft. (±0.81 Acres)



PARCELS
APN'S: 1049-131-02, 1049-131-03



ZONING
Industrial Park (IP) per the City of Ontario, CA

PROPERTY HIGHLIGHTS

- Frontage on E. Holt Blvd. (±23,000 Vehicles Daily)
- Various Industrial & Retail Uses Allowed by the City of Ontario, CA (Verify)
- Less Than a Mile from Downtown Ontario
- Centrally Located Between the I-210 & 60 Freeways, with Great Access to I-10 Freeway from the Holt Blvd. On/Off Ramps, and Minutes to I-15 Freeway



Rene Ramos, Jr.
909.980.6868
Rene.Ramos@kwcommercial.com
CalDRE Lic. #01836872

Jacob B. Bernardy
909.935.0935
Jacob.Bernardy@kwcommercial.com
CalDRE Lic. #02039512

Robert Bagley III
909.935.093
Aidan.Isaias@kwcie.com
CalDRE Lic. #02228061

Daniel W. Richards
909.980.6868
Daniel.Richards@kwcommercial.com
CalDRE Lic. #00803221



**INLAND
EMPIRE**

CAL DRE # 02120868

KW COMMERCIAL
3595-1 Inland Empire
Blvd. Suite 1250
Ontario, CA 91764
909.980.6868

WE OBTAINED THE INFORMATION ABOVE FROM SOURCES WE BELIEVE TO BE RELIABLE. HOWEVER, WE HAVE NOT VERIFIED ITS ACCURACY AND MAKE NO GUARANTEE, WARRANTY, OR REPRESENTATION ABOUT IT. IT IS SUBMITTED SUBJECT TO THE POSSIBILITY OF ERRORS, OMISSIONS, CHANGE OF PRICE, RENTAL OR OTHER CONDITIONS, PRIOR SALE, LEASE OR FINANCING, OR WITHDRAWAL WITHOUT NOTICE. WE INCLUDE PROJECTIONS, OPINIONS, ASSUMPTIONS OR ESTIMATES FOR EXAMPLE ONLY, AND THEY MAY NOT REPRESENT CURRENT OR FUTURE PERFORMANCE OF THE PROPERTY. YOU AND YOUR TAX AND LEGAL ADVISORS SHOULD CONDUCT YOUR OWN INVESTIGATION OF THE PROPERTY AND TRANSACTION.

AERIAL MAP



LOCAL MAP

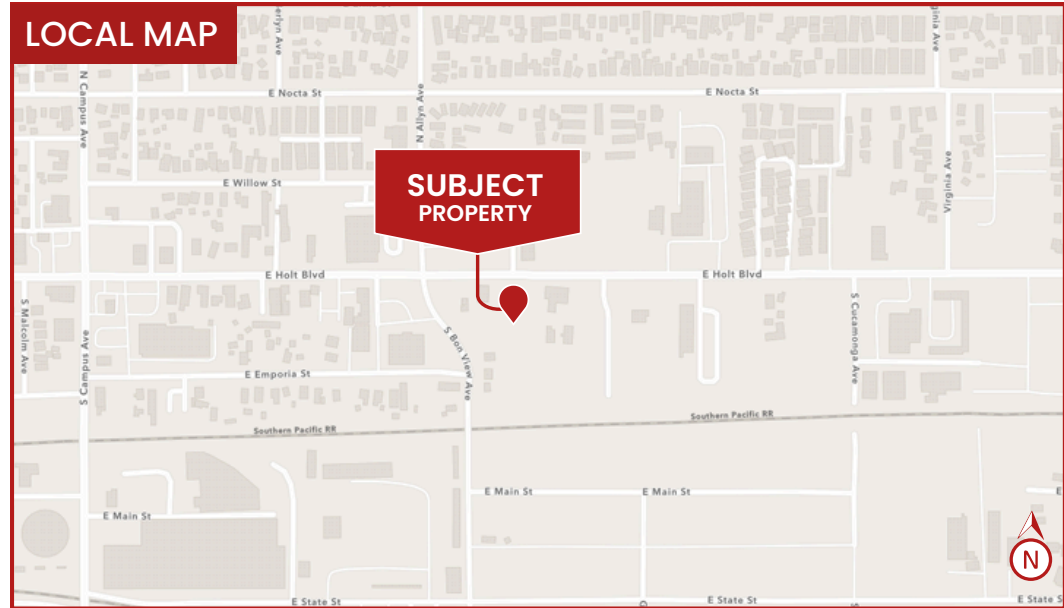

REGIONAL MAP

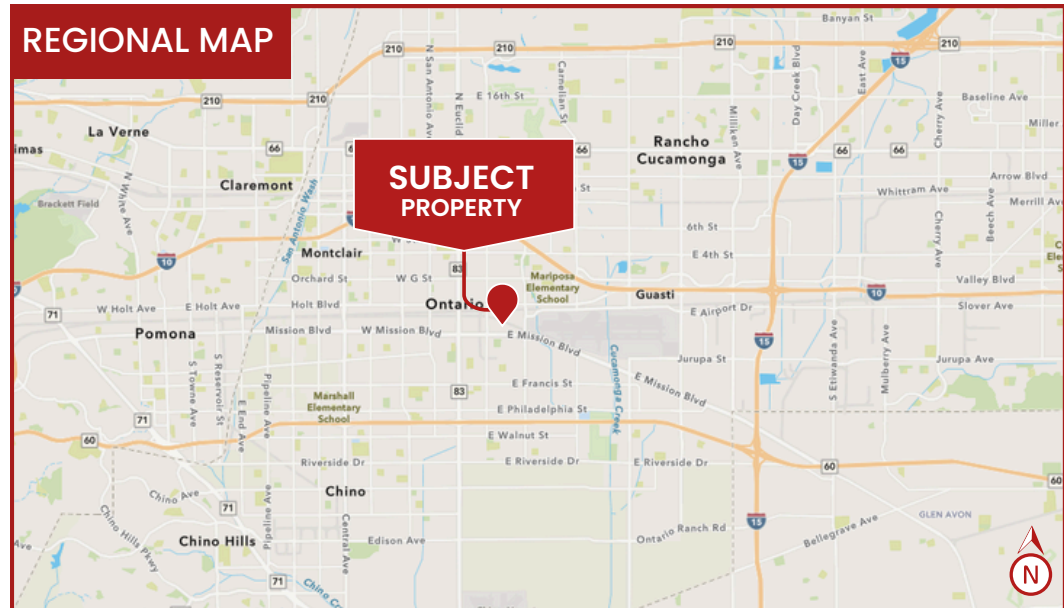

Rene Ramos, Jr.
909.980.6868
Rene.Ramos@kwcommercial.com
CalDRE Lic. #01836872

Jacob B. Bernardy
909.935.0935
Jacob.Bernardy@kwcommercial.com
CalDRE Lic. #02039512

Robert D. Bagley III
909.935.0938
Robert.Bagley@kwcommercial.com
CalDRE Lic. #02131874

Daniel W. Richards
909.980.6868
Daniel.Richards@kwcommercial.com
CalDRE Lic. #00803221



**INLAND
EMPIRE**

CAL DRE # 02120868



Rene Ramos, Jr.
909.980.6868
Rene.Ramos@kwcommercial.com
CalDRE Lic. #01836872

Jacob B. Bernardy
909.935.0935
Jacob.Bernardy@kwcommercial.com
CalDRE Lic. #02039512

Robert D. Bagley III
909.935.0938
Robert.Bagley@kwcommercial.com
CalDRE Lic. #02131874

Daniel W. Richards
909.980.6868
Daniel.Richards@kwcommercial.com
CalDRE Lic. #00803221



INLAND
EMPIRE

CAL DRE # 02120868



Holt Blvd.

S. Bon View Ave.

Rene Ramos, Jr.
909.980.6868
Rene.Ramos@kwcommercial.com
CalDRE Lic. #01836872

Jacob B. Bernardy
909.935.0935
Jacob.Bernardy@kwcommercial.com
CalDRE Lic. #02039512

Robert D. Bagley III
909.935.0938
Robert.Bagley@kwcommercial.com
CalDRE Lic. #02131874

Daniel W. Richards
909.980.6868
Daniel.Richards@kwcommercial.com
CalDRE Lic. #00803221



INLAND
EMPIRE

CAL DRE # 02120868