



RETAIL PROPERTY FOR LEASE

## RIGGS PLAZA

5735-5815 EASTERN AVE, HYATTSVILLE, MD 20782



# RIGGS PLAZA

5735-5815 EASTERN AVE, HYATTSVILLE, MD 20782

## PROPERTY OVERVIEW



## OFFERING SUMMARY

<b>Available SF:</b>	10,000 SF
<b>Lease Rate:</b>	Negotiable
<b>Lot Size:</b>	11.0 Acres
<b>Year Built:</b>	1968
<b>Building Size:</b>	95,531 SF
<b>Renovated:</b>	1996
<b>Zoning:</b>	CSC
<b>Market:</b>	Hyattsville
<b>Submarket:</b>	Chillum
<b>Traffic Count:</b>	20,511

## PROPERTY HIGHLIGHTS

- 10,000 square feet of retail space & pad site available.
- Landlord will install a new roll up door for access to the space.
- Tenants include Giant Foods & MetroPCS.
- Multiple points of access and strong visibility from Riggs Road (20,000 ADT).
- Densely populated area with 110,986 households within a 3-mile radius.
- Average household income of \$91,857 within a 3-mile radius.
- Abundant surface level parking.
- Located on the border of Maryland and Washington D.C.
- Strong PM side of the street traffic and access



# RIGGS PLAZA

5735-5815 EASTERN AVE, HYATTSVILLE, MD 20782

RETAILER MAP

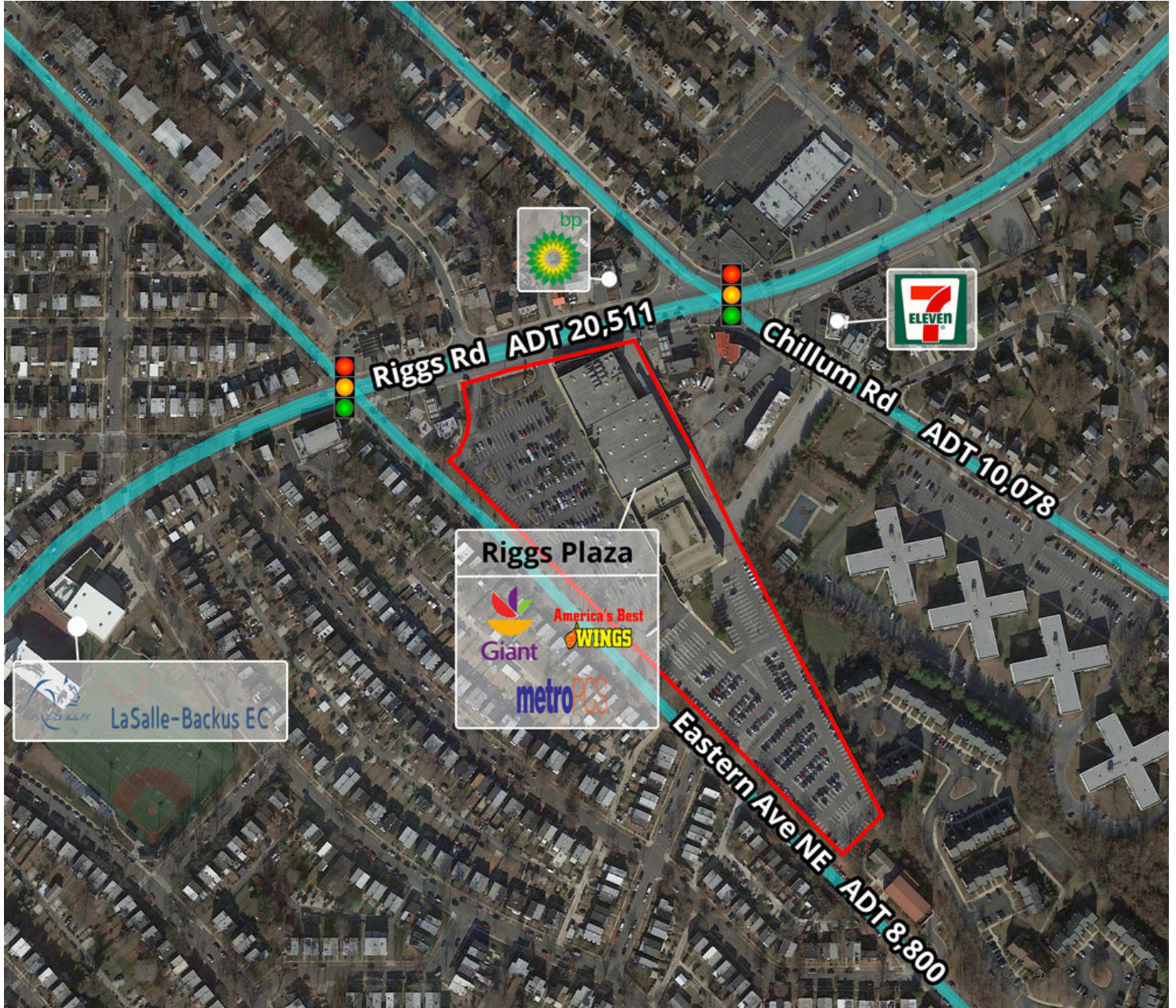



# RIGGS PLAZA

5735-5815 EASTERN AVE, HYATTSVILLE, MD 20782

## SITE PLAN



# RIGGS PLAZA

5735-5815 EASTERN AVE, HYATTSVILLE, MD 20782

UNIT 8 | LOWER LEVEL

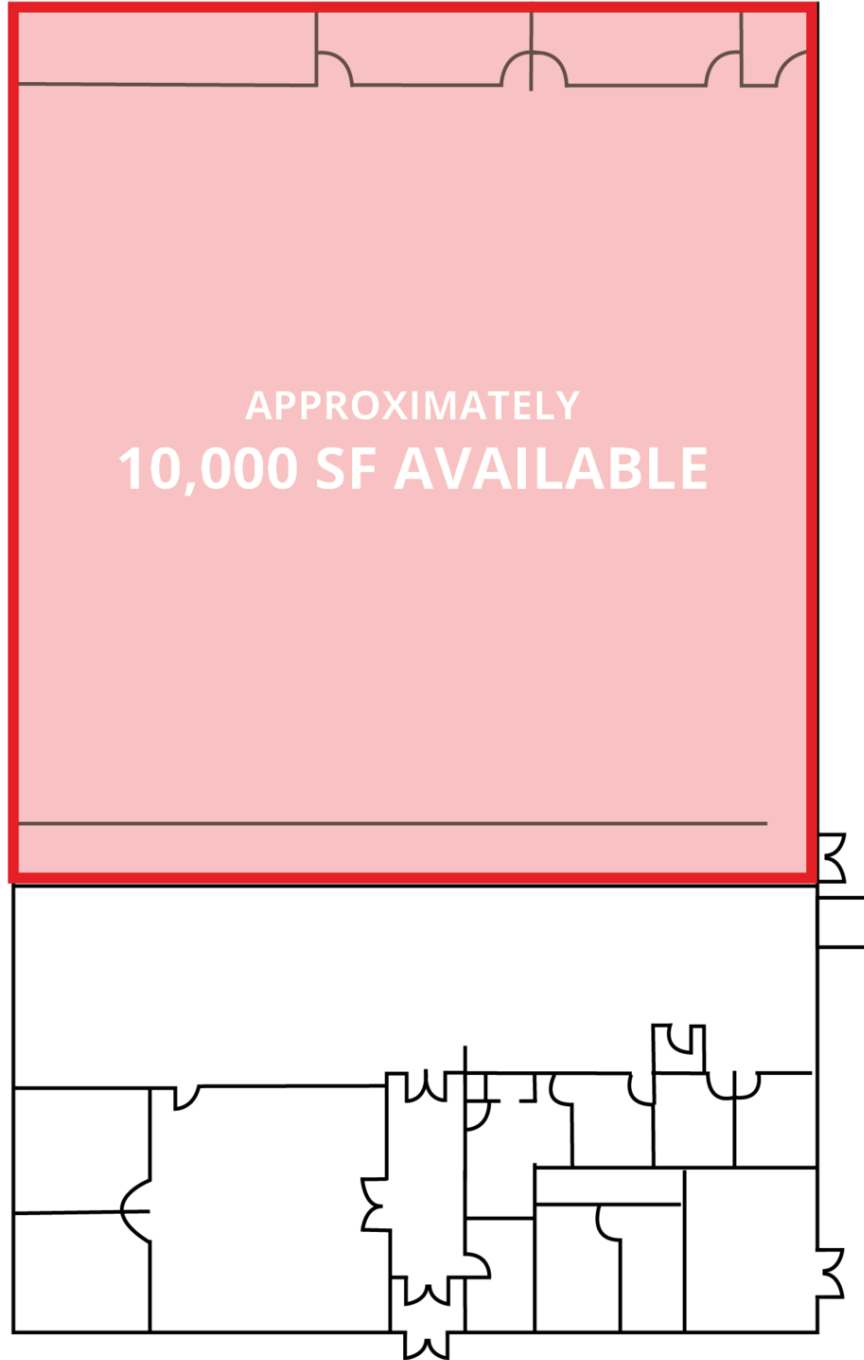

# RIGGS PLAZA

5735-5815 EASTERN AVE, HYATTSVILLE, MD 20782

## DEMOGRAPHICS MAP

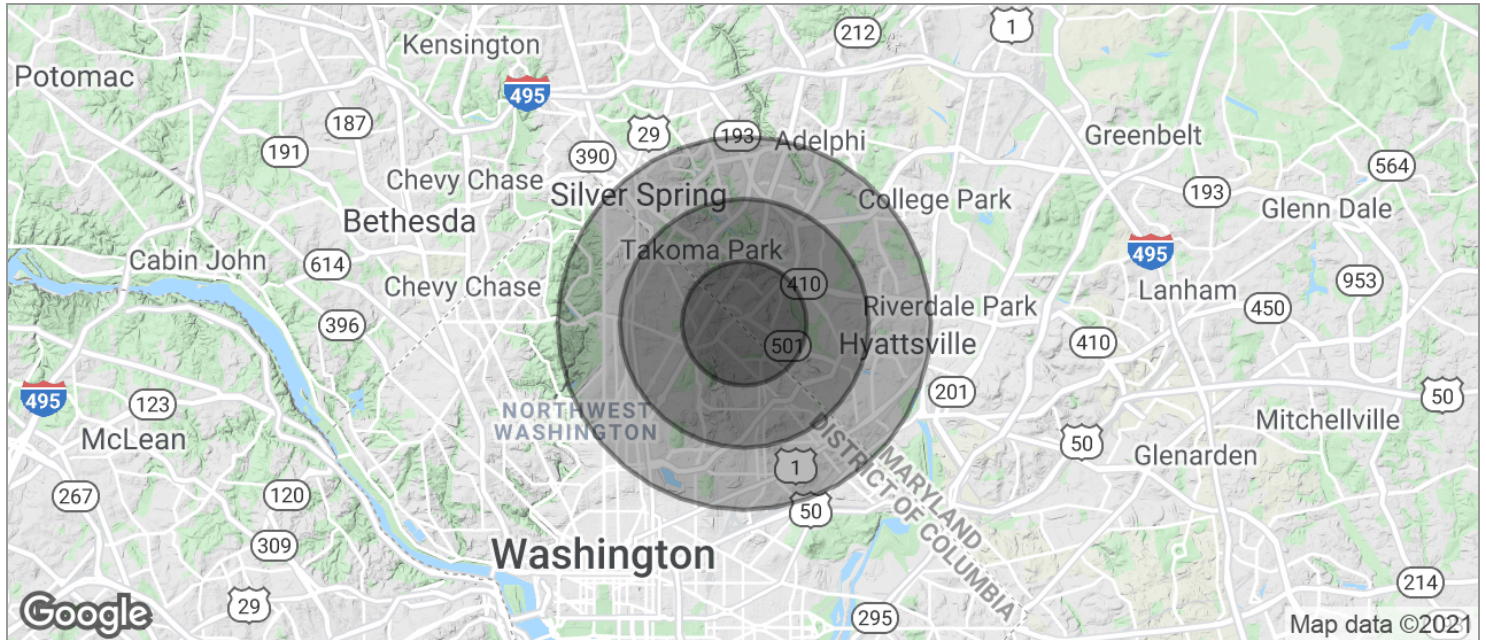

	1 MILE	2 MILES	3 MILES
<b>POPULATION</b>			
TOTAL POPULATION	32,646	135,770	300,009
MEDIAN AGE	39.5	37.7	36.4
MEDIAN AGE (MALE)	35.7	35.9	34.5
MEDIAN AGE (FEMALE)	41.7	38.6	37.6
<b>HOUSEHOLDS &amp; INCOME</b>			
TOTAL HOUSEHOLDS	12,632	50,287	110,986
# OF PERSONS PER HH	2.7	2.7	2.7
AVERAGE HH INCOME	\$78,373	\$87,943	\$91,857
AVERAGE HOUSE VALUE	\$357,690	\$423,363	\$415,881

\* Demographic data derived from 2010 US Census



**Joseph Farina**  
Principal  
571.620.5142  
jfarina@Divaris.Com

**Rob Gray**  
Vice President,  
Investment Sales &  
Leasing  
571.550.9042  
Robert.Gray@Divaris.Com

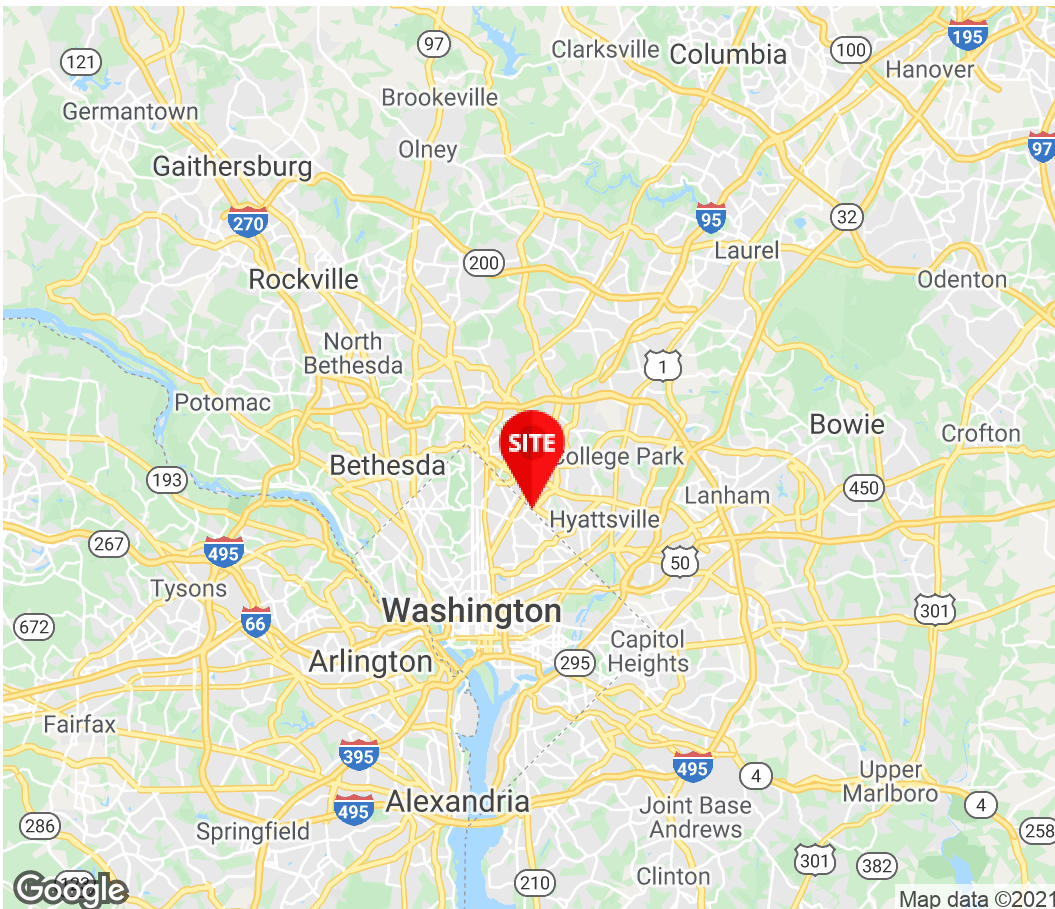

The information contained herein should be considered confidential and remains the sole property of Divaris Real Estate, Inc. at all times. Although every effort has been made to ensure accuracy, no liability will be accepted for any errors or omissions. Disclosure of any information contained herein is prohibited except with the express written permission of Divaris Real Estate, Inc.