

Keyplan

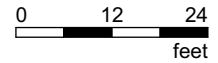
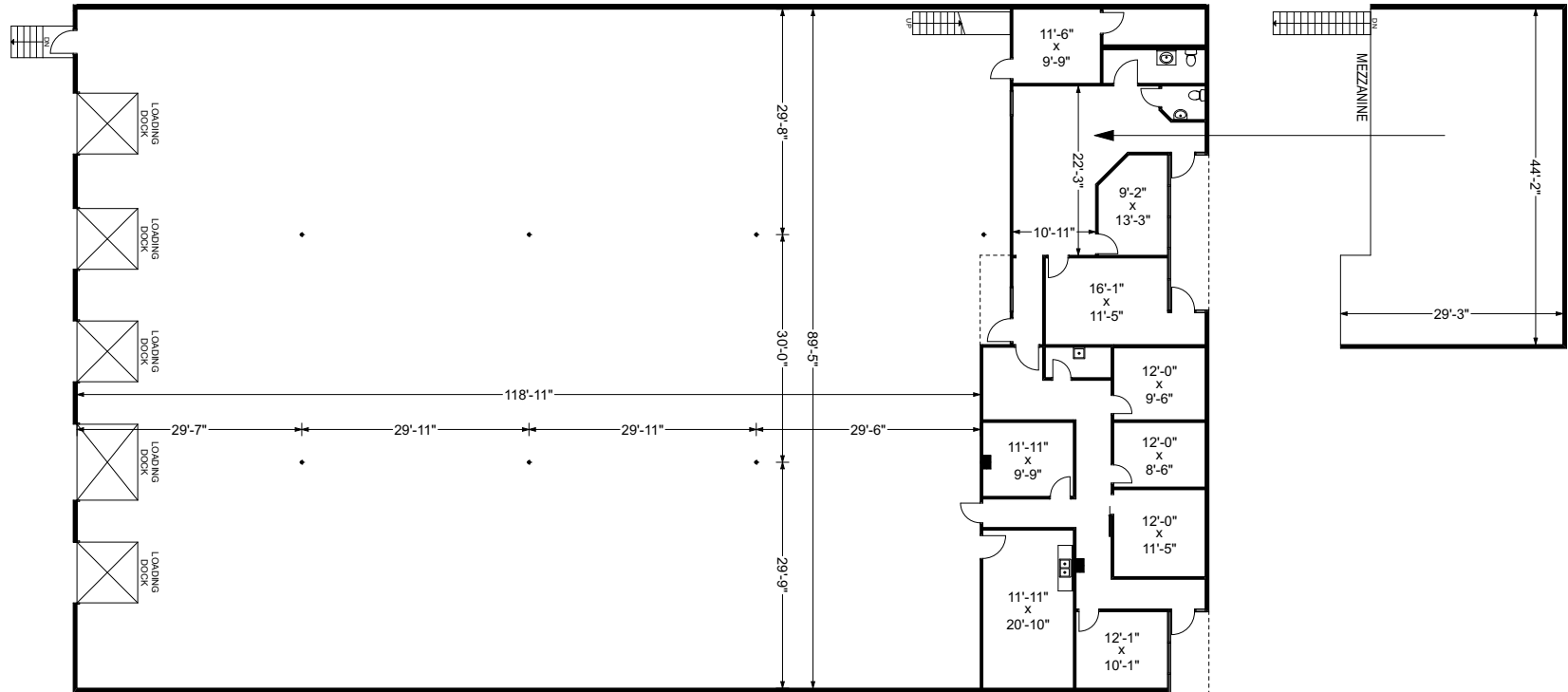

"Client"

Palm Leaf Holdings
1057 Ellis Road N
Jacksonville, Florida

Unit 12-14

Plan Version: V1
 Measured: 12/11/24
 Prepared: 1/9/25

phone: (305) 702-0590
www.floridameasures.com



This work product has been prepared by Florida Measures, LLC pursuant to a contract with the Client for the sole benefit of and use by the Client. No third party may rely on this work product without the receipt of a reliance letter from Florida Measures, LLC.