

For Lease



±26,596 SF

FOR LEASE * 5354 Irwindale Ave, Building B, Irwindale, CA

**Ashwill
Associates**
COMMERCIAL REAL ESTATE

For more information, contact:

Mitch Ashwill
mitch@ashwill.com
Lic. 00970525
(626) 363-7868

Sean Casey
seankc@ashwill.com
Lic. 01887121
(626) 363-7855



±26,596
Building Square Feet



24 – 26 FT
Minimum Clear Height



2
Dock Doors



Abundant Parking

The information contained herein has been obtained from sources we deem reliable. While we have no reason to doubt its accuracy, we do not guarantee it. The prospective buyer or lessee should independently verify all information contained herein. All measurements are approximate.

For Lease ±26,596 SF
5354 Irwindale Ave, Bldg B, Irwindale, CA

Building Highlights:

- Irwindale Business Park
- ±5,000 SF of Deluxe Office Space
- Two (2) Dock High Doors
- One (1) Grade Level Loading Door 12' x 14'
- 24' - 26' Clear Height
- ESFR Fire Sprinklers
- 400 Amps of 277/480 Volt Power
- Abundant Parking
- Direct 210 & 605 Freeway Access

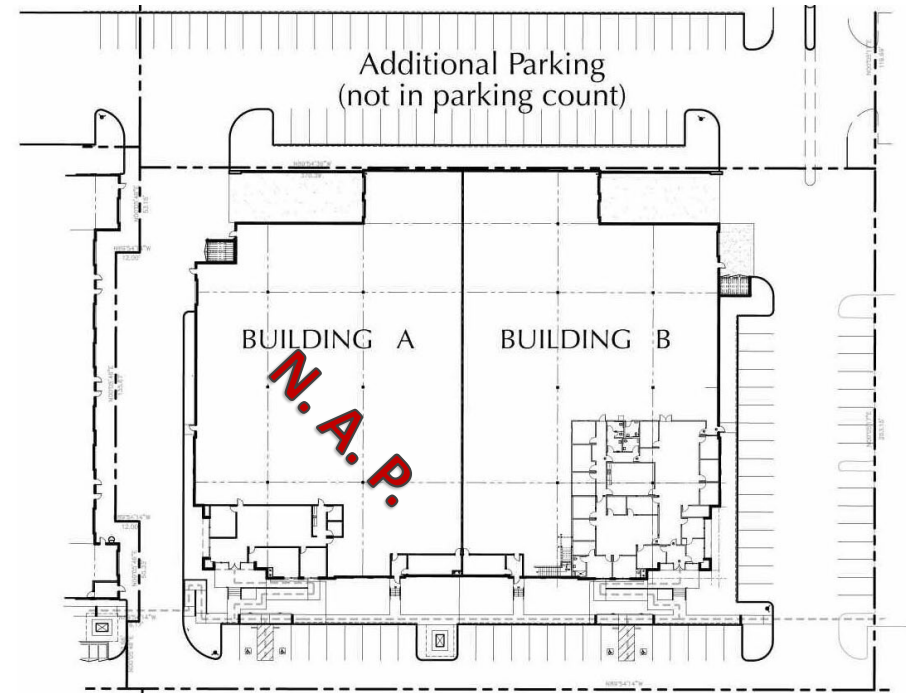

Ashwill
Associates
COMMERCIAL REAL ESTATE

For more information, contact:

Mitch Ashwill
mitch@ashwill.com
Lic. 00970525
(626) 363-7868

Sean Casey
seankc@ashwill.com
Lic. 01887121
(626) 363-7855